

## How to modify time zone, date and time on my WBOX Hybrid DVR?

Product Models: **0E-HD4C1TB**, **0E-HD8C2TB** and **0E-HD16C2TB**

### Modify Time zone

1. On the **System setting** screen, choose **Basic > Time zone** to access the time zone.

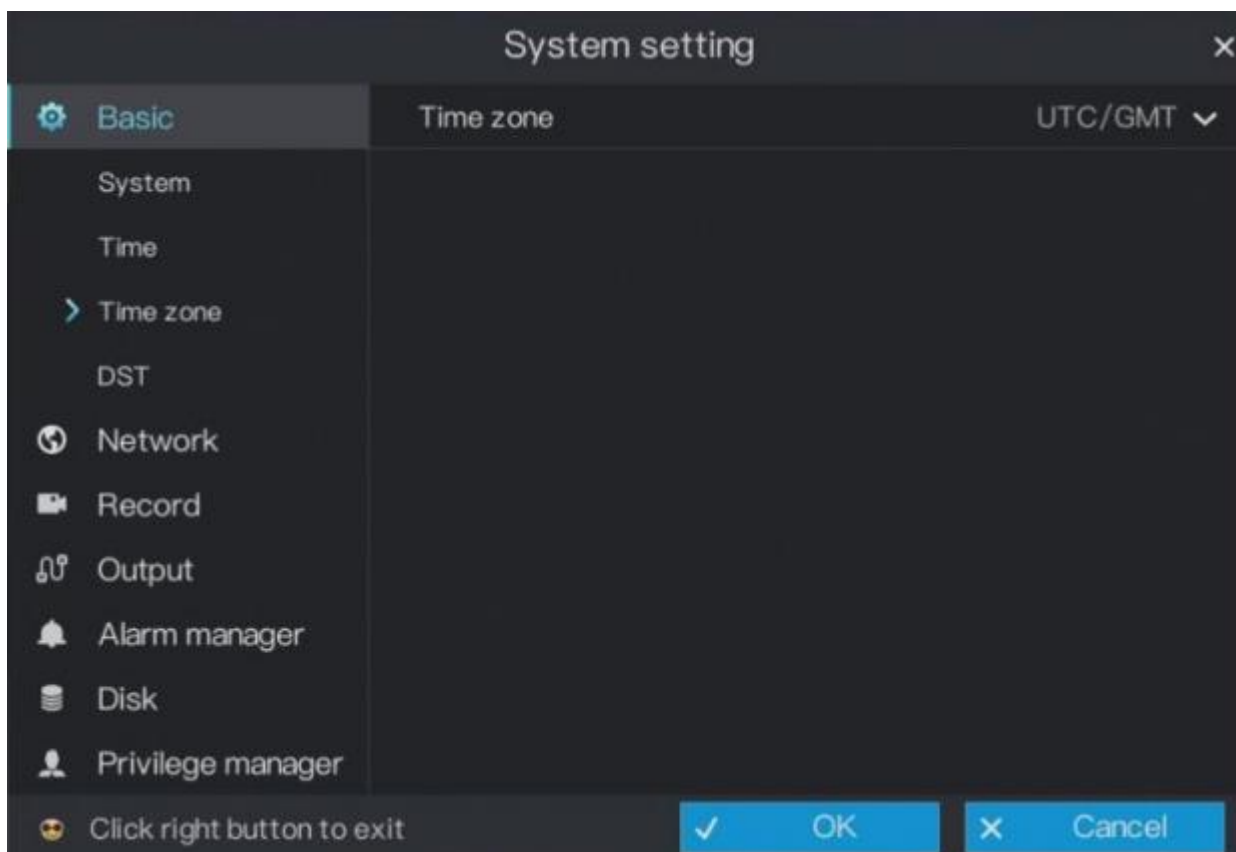



2. Select a required time zone from the **Time zone** drop-down list.
3. Click **OK** to save settings or click **Cancel** to cancel the changes.

## Modify Date and Time

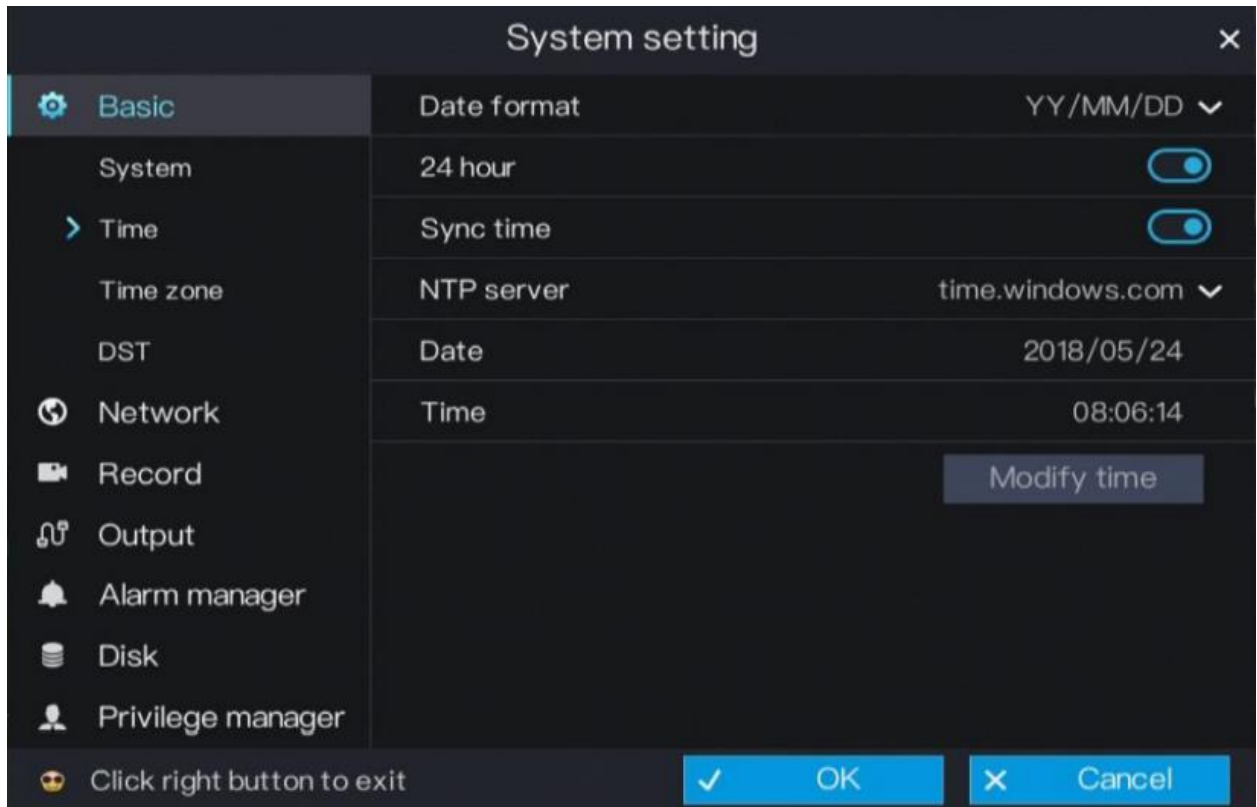
1. On the **System setting** screen, choose **Basic > Time**



2. Select a required date format from the **Date Format** drop-down list.
3. Click  next to **24 Hour** to disable the 24-hour system. Then, the 12-hour system is enabled. If 24 Hour is set to on, the 24-hour system is used and is enabled by default.
4. Click  next to **Sync Time** to disable time synchronization. Time synchronization is enabled by default. Time is synchronized with the PC time.
5. After **Sync Time** is disabled, you can manually set the system date and time.
  - a. Click **Date** and scroll the mouse scroll wheel to select the year, month, & date
  - b. Click **Time** and scroll the mouse scroll wheel to select the hour, minute, & second.
  - c. Click **Modify Time** to save the time settings.
6. Click **OK** to save settings or click **Cancel** to cancel the changes.