



Smart access control and
door entry systems

Product Selection Guide



Why work with us?



Easy to quote

- Build your system one door at a time
- A range of products to suit any site requirement
- Scalable system – add doors when the budget is available



Easy to install

- Plug and play solutions that connect directly to the network
- Mix and match Net2 products – they are all designed to work together seamlessly
- Clear instructions and colour coded wiring labels



Easy to work with

- Industry-leading technical support
- 5-year guarantee and three step returns policy
- Free software upgrades and no multiple licence fees



The Paxton Installer App



Paxton in Your Pocket – the Ultimate Installer Tool

The new Paxton Installer app gives you instant access to all the tools you need to install Paxton products. The free app, available for iOS and Android, provides quick and easy access to product specs and technical information, plus anything you could need on-site!



**Superfast access to
product information**



**Get answers to
your FAQs**



**Be the first to hear
Paxton news**



**Find your
distributors**



**Dial direct to Paxton
Technical Support**



Download on the
App Store



GET IT ON
Google Play

5 Networked Access Control

Our networked access control system, Net2, is administered using one or more PCs and can be monitored and managed from a central location. Our door controllers come as IP, wireless or battery powered.

- 6 Wired Controllers - Net2 Plus
- 8 Wireless Controllers - Net2 Nano
- 9 Wireless Controllers - Net2 PaxLock
- 10 Wireless Controllers - PaxLock Pro - Mortise & PaxLock Pro - Latch
- 12 Building Control - I/O Board
- 13 Net2 Readers
- 17 Net2 Tokens
- 19 Net2 Software
- 20 Accessories & Other Components
- 22 Demonstration Products

23 Access Control & Video Management

Our single platform solution combining access control and video management. Supporting a simple migration path from Net2, Paxton10 is an ideal solution to futureproof site security.

- 24 Paxton10
- 25 Integration
- 26 Cameras
- 28 Readers & Tokens
- 29 PaxLock Pro - Mortise & Latch
- 31 Software & Apps

32 Video Intercom

Our video intercom system, Entry, is an advanced one cable intercom system with built-in access control capabilities.

- 33 Entry System Components
- 36 Demo Cases

38 Standalone Access Control

Our standalone access control is a non-networked system made up of readers or simple door controllers located at each door. Standalone systems are administered via the use of tokens or card packs.

- 39 Switch2
- 40 Switch2 Readers
- 43 Compact
- 45 Standalone Tokens
- 46 Standalone Accessories

- 48 Additional Information

Welcome

This Product Selection Guide is designed to help you to choose the right products to build up an access control system.

Paxton produce a variety of security solutions to suit different site requirements. Our one door philosophy means doors can be added as required or when budget becomes available.

What's new?**Paxton10**

Paxton10 is a single platform solution combining access control and video management. It is a versatile solution that supports multi-site management and remote access. Scalable from 1 to 1000 doors, and 1 to 1000 cameras, Paxton10 is suitable for all building types and sizes.

- ▶ Easy to quote and configure, build a complete system with just five components
- ▶ Manage multiple sites on a single system remotely
- ▶ Web-based user interface with no configuration required
- ▶ Custom dashboards to suit any user requirements
- ▶ Built in **Bluetooth®** to use phone or smart watch smart credentials
- ▶ Works with Entry and PaxLock Pro

See page 23

Networked Access Control

Our networked access control system, Net2, is administered using one or more PCs and can be monitored and managed from a central location. Our door controllers come as IP, wireless or battery powered.

- ▶ Net2 is Paxton's flagship access control product
- ▶ A powerful networked system that addresses the needs of the mid-market
- ▶ Modular approach for simplicity and scalability
- ▶ Simple intuitive software
- ▶ Range of features that move beyond basic access control
- ▶ A complete solution that encompasses wireless and door entry

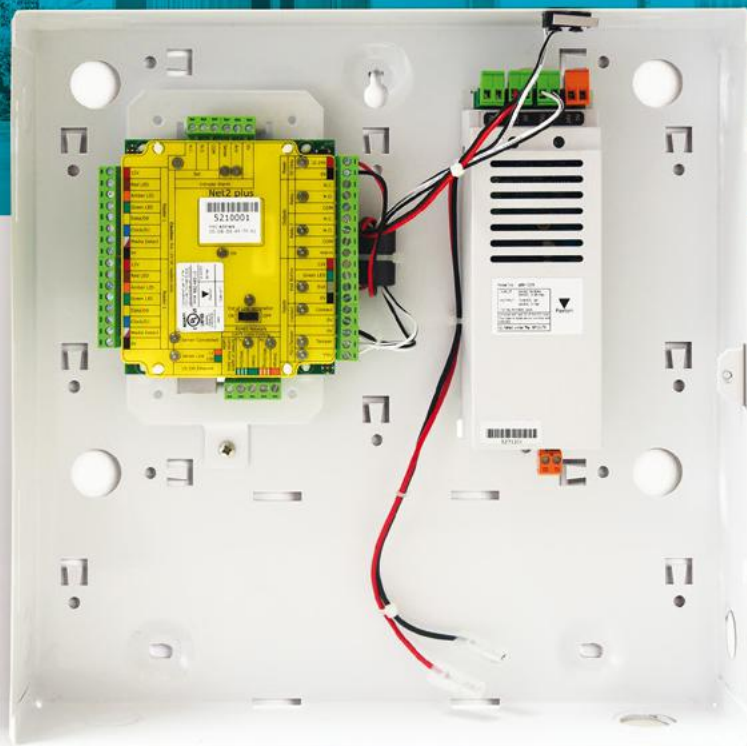

Networked Access Control

Net2 plus Wired Controller

- ▶ A networked IP ready single door controller
- ▶ On-board TCP/IP connection allows direct connection to a network
- ▶ Can connect together with dedicated RS485 network

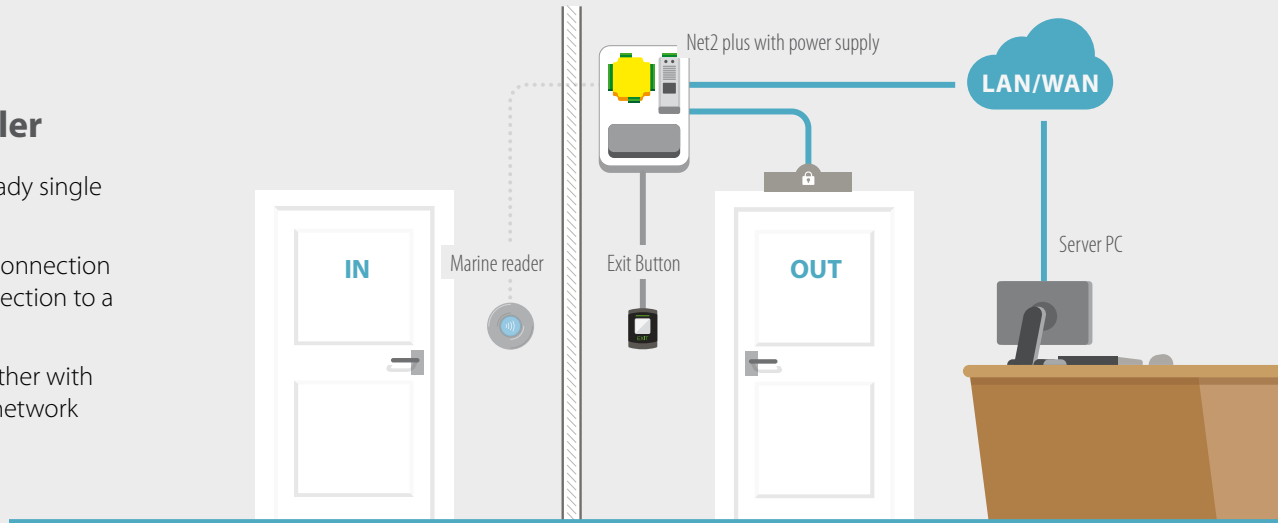

Net2 plus 1 door access control unit

BEST SELLER

Sales code
682-493-US

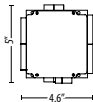

Net2 plus 1 door ACU in plastic housing

Sales code
682-528-US

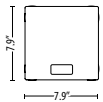

Net2 plus in US Metal Enclosure with 12/24V PSU

BEST SELLER

Sales code
682-610-US

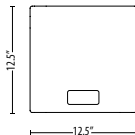

Net2 plus in US Metal Enclosure with PoE+ PSU

Sales code
682-630-US

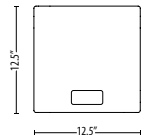

Net2 plus in US Metal Enclosure with 12V or 24V PSU with trigger disconnect

Sales code
682-620-US

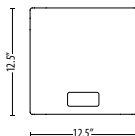

Net2 Plus is a suitable alternative to the Net2 Entry - Control Unit, when combined with any 802.3af or 802.3at (PoE+) compliant 3rd party PoE switch. We recommend the TP Link TL-SF1006P switch which has been thoroughly tested with the Entry system.



Net2 IP starter kit for 2 doors - Low Voltage PSU

Sales code
682-930-US

Net2 Plus starter kit for 2 doors - PoE+ PSU

Sales code
682-920-US

Includes:

2 x Net2 plus controller, metal cabinet	10 x Keyfobs & 10 cards
2 x P50M readers	1 x Net2 Pro software
1 x Enrollment reader USB	



Net2 Plus Single Door Expansion Kit - Low Voltage PSU

Sales code
682-960-US

Net2 Plus Single Door Expansion Kit - PoE+ PSU

Sales code
682-950-US

Includes:

1 x Net2 plus controller, metal cabinet
1 x Proximity reader - P50M

Networked Access Control

Net2 nano Wireless Controller

- ▶ A wireless single door controller
- ▶ Communicates to the server using Net2Air technology via a Net2Air bridge
- ▶ No cable required between Net2 nano and the server PC, reducing installation time

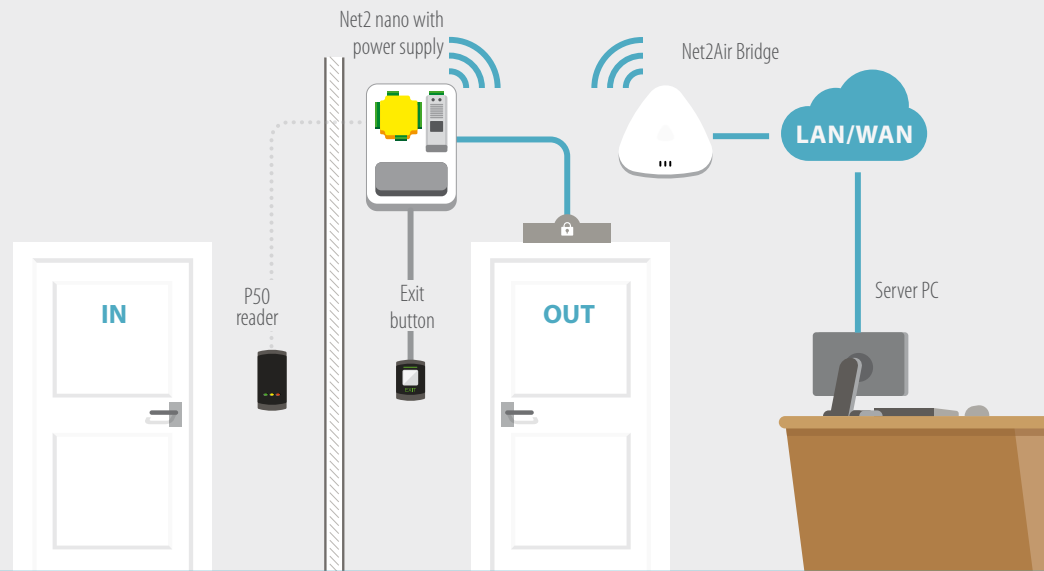

Net2 nano 1 door controller - 12/24V
2A AC/DC PSU, Plastic cabinet

Sales code
654-910-US

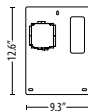

Net2Air Bridge

Sales code
477-600-US



Net2 PaxLock Wireless Controller

- ▶ Networked access control system in a wireless door handle
- ▶ Ready to install with a C Keyway core
- ▶ Integrates with Net2 access control
- ▶ Communicates using Net2Air technology

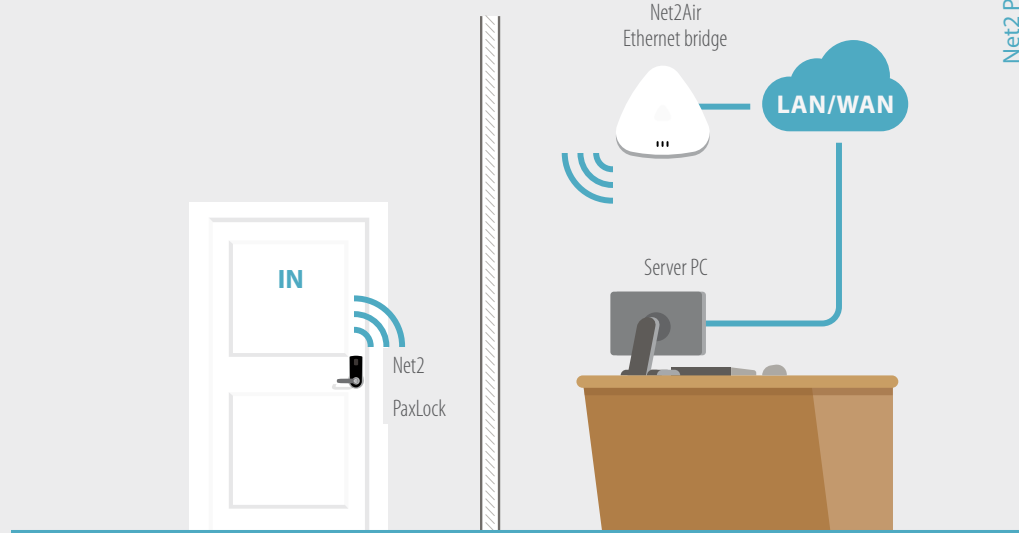

Net2 PaxLock US C Keyway - Galaxy

Sales code
921-130-US

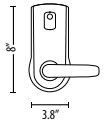

Net2 PaxLock US C Keyway - Eclipse

Sales code
921-131-US

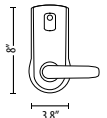

Net2 PaxLock US – Door installation jig

Sales code
921-200-US



Galaxy handle



Eclipse handle



C Keyway core

HID™ activation license required

PaxLock Pro Wireless Controllers

- ▶ PaxLock Pro - Mortise & PaxLock Pro - Latch versions available
- ▶ Standalone or networked
- ▶ Simple upgrade path from standalone to networked
- ▶ Dual-frequency proximity reader
- ▶ UL294 Certified
- ▶ UL10C Certified** for fire doors
- ▶ ANSI 156.25 Certified**

** PaxLock Pro - Mortise only

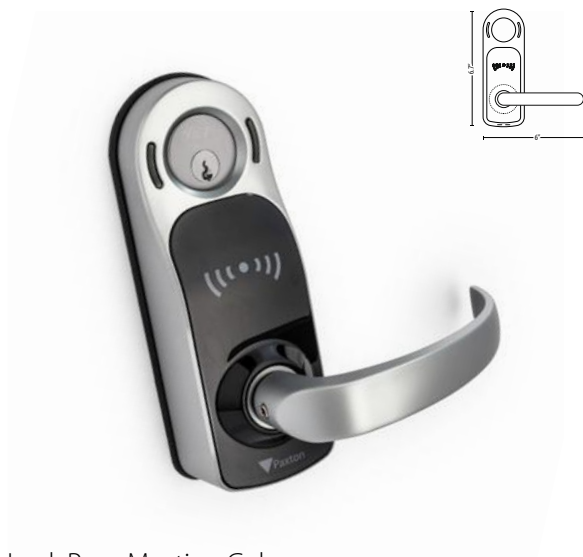
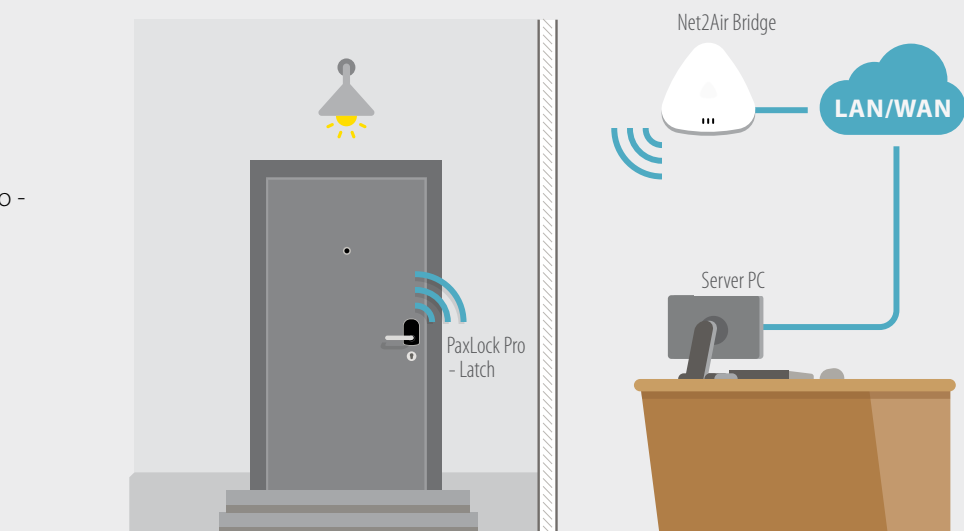

PaxLock Pro - Mortise, Galaxy

Sales code
900-140WT-US White

Sales code
900-140BL-US Black



PaxLock Pro - Latch, Galaxy

Sales code
900-120WT-US White

Sales code
900-120BL-US Black

▶ <http://paxton.info/2131>
For internal use only

PaxLock Pro - Mortise, Eclipse

Sales code
900-150WT-US White

Sales code
900-150BL-US Black

PaxLock Pro - Latch, Eclipse

Sales code
900-130WT-US White

Sales code
900-130BL-US Black

Please note: It is recommended that PaxLock Pro - Mortise is installed with a lockset with key override to ensure access can be gained in the rare event of a unit failure.**

PaxLock Pro Components

These products may be used with PaxLock Pro to aid installation on a variety of doors.



PaxLock Pro - Mortise, 2" door kit
Sales code
900-061-US



PaxLock Pro - Mortise, 2-1/4" door kit
Sales code
900-062-US



PaxLock Pro - Latch, 2" door kit
Sales code
900-059-US



PaxLock Pro - Latch, 2-1/4" door kit
Sales code
900-060-US





PaxLock Pro - Mortise door installation jig
Sales code
900-081-US



Yale® Latchbolt Mortise lock

Sales code
901-053-US



Yale® Deadbolt Mortise lock

Sales code
901-054-US



Yale® 1 1/2" lock cylinder

Sales code
901-058-US



PaxLock Pro - Latch door installation jig
Sales code
900-080-US

Demo case PaxLock Pro

The demo case comes with everything you need to show your customers the PaxLock Pro options in action.

- ▶ 2 x Demo Stands with PaxLock Pro - Mortise and Latch options
- ▶ Standalone Token pack (x2 Tokens)
- ▶ Batteries

Sales code
900-901-US





Building Control - I/O Board

When a valid fob is presented to the reader, the I/O board can be programmed to trigger the power to elevators, lighting, heating and electrical equipment.

The Net2 I/O board is a simple, yet powerful addition to the Net2 system. It can be wired alongside a Net2 door controller, to switch power on and off to electrical equipment to save money and energy. The Net2 I/O board can control power to elevators, lighting, heating, water and air-conditioning by using the Triggers and Actions application in the Net2 software. These actions can be programmed for a particular time, or in response to a specific Net2 event.

- ▶ Connect directly to a LAN/WAN only
- ▶ Enable integration with elevators, lighting, heating and more
- ▶ 4 inputs and 4 outputs on the Net2 I/O board



Please note, Net2 I/O boards work as part of the Net2 system. They are not door controllers.



Net2 I/O board

Sales code
489-710-US



Net2 I/O board in plastic housing

Sales code
385-710-US



Net2 I/O board with 2A PSU in plastic cabinet

Sales code
411-623-US

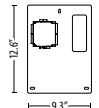

Net2 Readers Pre-Activated with Genuine HID Technology™

The pre-activated Net2 series of readers with Genuine HID Technology™ come pre-enabled with HID™ 125kHz Proximity out of the box. HID™ license activation is not required. These readers can also include an optional HID™ Wiegand output with a separate purchase of a Wiegand activation card.



Net2 Proximity Readers with Genuine HID Technology™

P38

Sales code
400-130-US



Mullion

Sales code
400-150-US

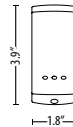

P75

Sales code
400-175-US

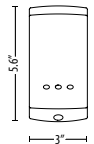

Proximity Keypad KP50 with Genuine HID Technology™

Sales code
400-250-US



Proximity Keypad KP75 with Genuine HID Technology™

Sales code
400-275-US

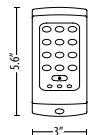

Proximity Marine Reader with Genuine HID Technology™

Sales code
400-190-US

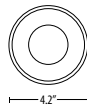

Proximity Architectural Reader Satin Chrome with Genuine HID Technology™

Sales code
400-195SC-US



Insert also required - see p.11



Proximity Architectural Reader Gun Metal Grey with Genuine HID Technology™

Sales code
400-195GG-US



Insert also required - see p.11

Networked Access Control

Net2 Readers

These readers are for use with Net2. Designed to fit in seamlessly in any environment, our wide range means you get the right choice for your site requirements.

* Indicates readers that have functionality to read HID™ 125kHz Proximity tokens, using Genuine HID Technology™ 125kHz. This is enabled using Genuine HID Technology™ Proximity activation licence cards or Wiegand activation licence cards (if the reader needs to provide a Wiegand output), both sold separately (see Tokens section, pg., [pg.18](#)).



PROXIMITY P38 reader

Sales code

333-110-US



BEST SELLER

Proximity P50 Mullion reader

Sales code

345-220-US

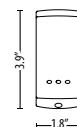

BEST SELLER

PROXIMITY P50 MIFARE® reader

Sales code

353-467-US

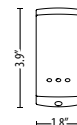

PROXIMITY P75 reader

Sales code

373-110-US



PROXIMITY P200 reader



Sales code
323-110-US



PROXIMITY P200 reader - Metal mount



Sales code
324-110-US



PROXIMITY metal reader, satin chrome

BEST SELLER



Sales code
390-747-US



PROXIMITY metal reader, chrome



Sales code
390-727-US





PROXIMITY vandal proof reader

Sales code
568-855-US

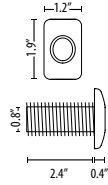

PROXIMITY panel mount reader

Sales code
390-135-US



PROXIMITY marine reader

Sales code
500-010-US

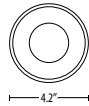

Energy saving reader

Sales code
595-248-US

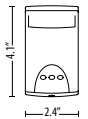

PROXIMITY architectural reader,
gunmetal grey

Sales code
360-864GG-US



Insert - stone

Sales code
361-002-US

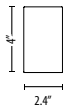

Insert - glass with logo

Sales code
361-003-US

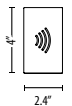

PROXIMITY architectural reader, satin
chrome

Sales code
360-864SC-US



Vandal resistant metal keypad

Sales code
521-715-US

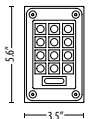

Long range reader

Sales code
313-110-US

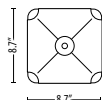

CARDLOCK reader, satin chrome

Sales code
409-711SC-US

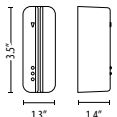

Networked Access Control



PROXIMITY KP50 keypad

Sales code
355-110-US



PROXIMITY KP75 keypad

Sales code
375-110-US

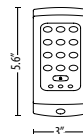

TOUCHLOCK K50 keypad

Sales code
351-110-US



TOUCHLOCK K75 keypad

Sales code
371-110-US

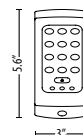

TOUCHLOCK K50 stainless steel keypad

Sales code
352-110-US



TOUCHLOCK K75 stainless steel keypad

Sales code
372-110-US

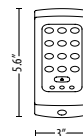

Proximity metal keypad, MIFARE® - KP75

Sales code
375-130-US

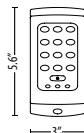

Net2 Tokens

These tokens are for use with Net2 systems.

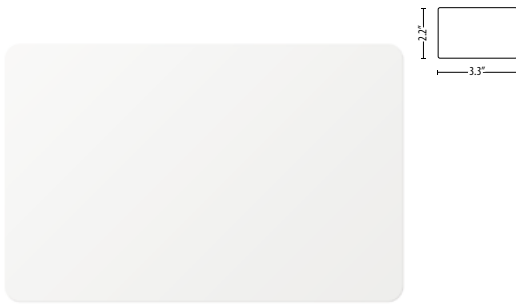

Net2 proximity ISO cards, Without magstripe

x10

Sales code
692-500-US

x500

Sales code
692-052-US

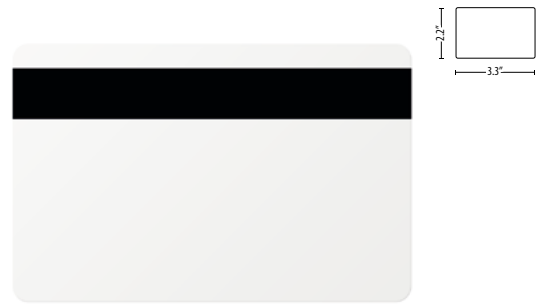

Net2 proximity ISO cards with magstripe

x10

Sales code
692-448-US

x500

Sales code
692-053-US



MIFARE® Classic 1k ISO card - Without magstripe

x10

Sales code
692-148-US

x500

Sales code
692-152-US



Net2 proximity keyfobs, box of 10

Sales code
695-644-US

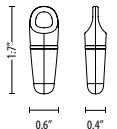

Net2 proximity self-adhesive disc, box of 10

Sales code
660-100-US



Networked Access Control



Net2 hands free keyfob

Sales code
690-222-US

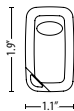

Net2 hands free keycard

Sales code
690-333-US

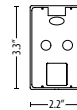

Genuine HID Technology™ License Activation Cards

125Khz ISO Proximity Card Licence x 1 with Genuine HID Technology™



Sales code
125-001-US

Wiegand Activation Card with Genuine HID Technology™



Sales code
125-201-US

Genuine HID Technology™ 125kHz Proximity activation license cards and Wiegand activation license cards are for use with Net2 readers indicated with the symbol ✨ (from pg. 14) to activate functionality to read HID™ 125kHz Proximity or HID™ Wiegand tokens.



Net2 Software

Net2 Pro has all the capabilities of Net2 Lite software with advanced features like timesheet and timeline, Landlord Tenant, security lockdown and anti-passback. Net2 Pro also includes a number of new features to support COVID-secure sites.

Net2 Lite contains all of the access control features to manage access privileges and report on users. Other features include multiple workstations, CCTV and intruder alarm integration and site graphics.

Feature	Lite	Pro
Multiple clients	•	•
Free upgrades	•	•
CCTV integration	•	•
Site graphics	•	•
Triggers and actions	•	•
Intruder alarm integration*	•	•
Entry compatible	•	•
Biometric integration	•	•
Card designer	•	•
Timesheet & Timeline*	•	•
Landlord/Tenant		•
Roll call and muster reporting*		•
Fire alarm integration*		•
Anti-passback*		•
Security lockdown*		•
Multi-zone intruder alarm integration*		•
Custom days*		•
Areas		•
Customizable welcome page		•
Paxton Connect app**		•
Net2Online***		•
Checkpoint Control		•
Occupancy Management		•

* Not available with wireless nano products

** Paxton Connect app only works with Net2 Pro v6.00 or above

*** Net2Online only works with Net2 Pro v6.01 or above

Watch our tutorial videos and learn how you can get the very best from the Net2 software and offer your customers more from their access control system.

<http://paxton.info/3142>



Net2 Pro Software

Sales code
930-010-US

Net2|Lite

Net2 Software - Lite

Download only



NEW Net2Online and Paxton Connect

Easy access to your Net2 system wherever you are – any location, any device. Flexible site management via a browser with Net2Online and from the Paxton Connect app.

Features include:

- ▶ User admin
- ▶ Viewing reports and events
- ▶ Managing roll call reports
- ▶ Free with Net2 Pro
- ▶ Open door functionality

Download the app now:



Net2 Accessories & Other Components



*

Net2 desktop reader, USB

Sales code

514-326-US

3"

0.7"

4.5"



Net2 desktop reader, proximity and magstripe USB

Sales code

350-910-US

3.5"

1.5"

5.7"



*

Desktop reader with Keyboard Output, USB

Sales code

214-326-US

3"

0.7"

4.5"



Hands free interface in plastic housing

Sales code

477-222-US

4.7"

0.8"



US Metal Enclosure Only

Sales code

857-600-US

12.5"

12.5"



PoE+ power supply in metal cabinet

Sales code

857-630-US

12.5"

12.5"



12/24V DC 2.5A power supply in metal cabinet

Sales code

857-610-US

12.5"

12.5"

*

 514-326-US has functionality to read HID™ 125kHz Proximity tokens, using Genuine HID Technology™ 125kHz. This is enabled using Genuine HID Technology™ Proximity activation licence cards (pg.16)



Single port midspan 802.3at PoE injector

Sales code
477-400-US

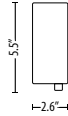

Exit button marine

Sales code
593-721-US



Exit button E50

Sales code
356-310-US



Exit button E75

Sales code
376-310-US

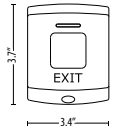

Hands free card holders with suckers, pack of 5

Sales code
696-100-US

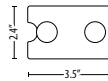

ISO card holder, clear, pack of 5

Sales code
696-400-US

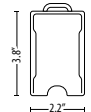

Networked Access Control

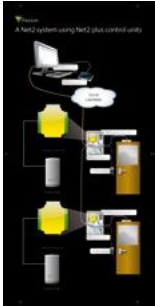

Net2 demo board - Net2 plus

Sales code
121-005-US

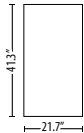

Demo case Net2 PaxLock US

The case Includes a Net2 PaxLock with override keys, Net2 Pro software, Net2 desktop reader and a Net2Air bridge.

Sales code
921-999-US

* one demo case per customer



Demo case Net2 Plus

The case includes a Net2 plus, Net2 Pro software, Net2 desktop reader and a sample pack of Net2 demonstration tokens.

Sales code
541-427-US

* one demo case per customer



Access Control and Video Management

Paxton10 is a single platform solution combining access control and video management. Scalable from 1 to 1000 doors, and 1 to 1000 cameras, Paxton10 is a versatile solution suitable for all building types and sizes.

- ▶ Easy to quote and configure, build a complete system with just five components
- ▶ Manage multiple sites on a single system from anywhere with an internet connection
- ▶ Web-based user interface with no configuration required
- ▶ A variety of cameras available as well as being compatible with third-party IP video cameras.
- ▶ Custom dashboards to suit any user requirements
- ▶ Built in **Bluetooth®** to use phone or smartwatch smart credentials.
- ▶ Works seamlessly with Entry and PaxLock Pro



Access Control and Video Management

Paxton10

Access control. Video management. One system

- ▶ Single door controller architecture for ease of install and flexibility
- ▶ Feature rich video management solution embedded in the cameras, no third-party integration required
- ▶ Built-in Bluetooth® wireless technology, supports free of charge smart credentials
- ▶ Fully compatible with Entry, our award-winning video and audio door entry solution
- ▶ Fully compatible with PaxLock, our wireless door handle line
- ▶ Distributed intelligence to increase reliability
- ▶ Powerful multifunction readers and keypad, reads Paxton, MIFARE®, HID™ Prox, EM, FeliCa, NFC and DESFire token technology

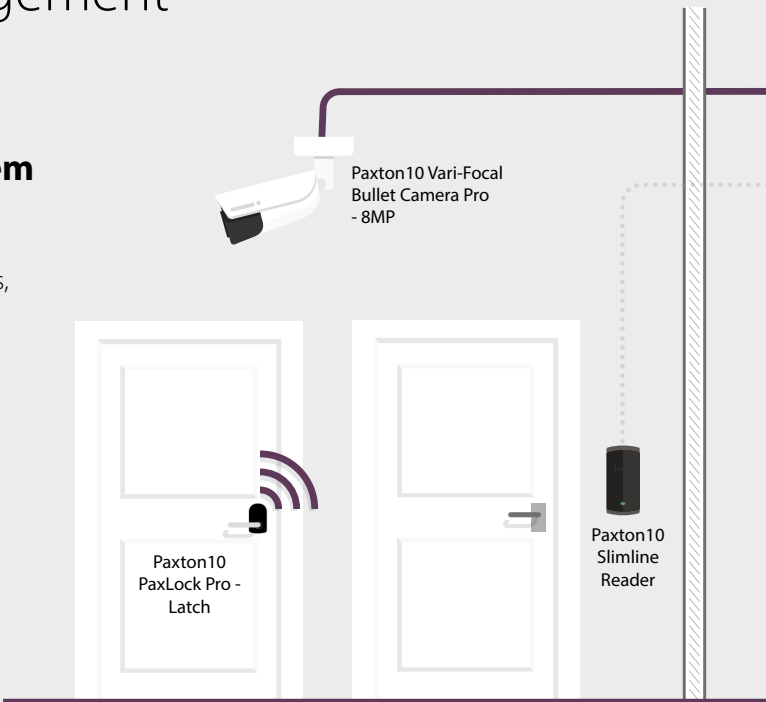

Paxton10
Door Controller

Sales code
010-403-US

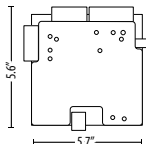

Paxton10
Door Controller - Plastic Enclosure

Sales code
010-315-US

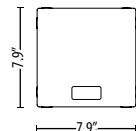

Paxton10
Door Controller - 12/24V 2A PSU

Sales code
010-522-US

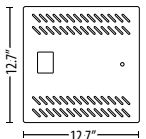

Paxton10
Video Controller - 12/24V 4A PSU

Sales code
010-803-US

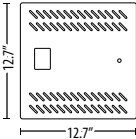

Paxton10
Door Controller - PoE+ PSU

Sales code
010-495-US

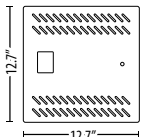

Paxton10
Video Controller - PoE+ PSU

Sales code
010-304-US

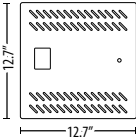

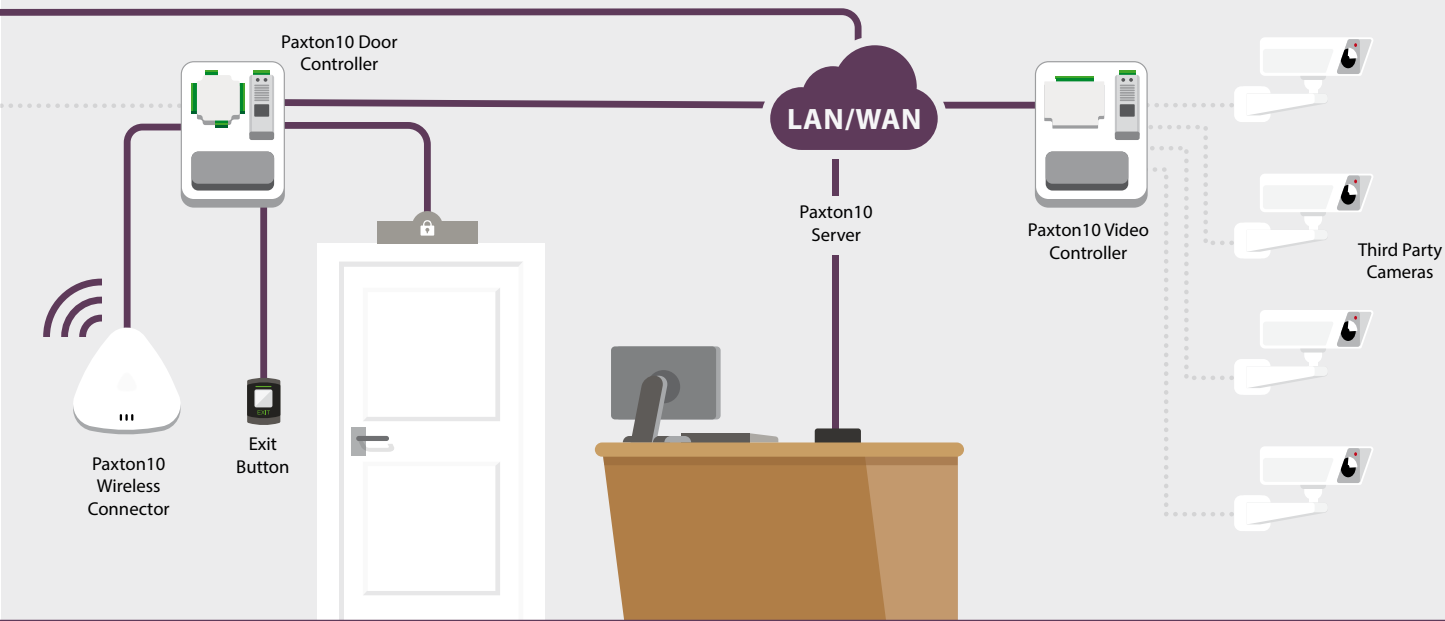

Integration



Paxton10 integrates with fire and intruder alarms to simplify building management.



Paxton10
Alarm Connector

Sales code
010-203-US



Paxton10 Server

Sales code
003-375-US

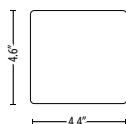

The Paxton10 Server is an Intel manufactured product and is therefore not covered by the Paxton 5-year guarantee. Paxton supports a 3-year warranty for this product, as supplied by Intel.

The Paxton10 Server comes in two variants, manufactured by Intel and Lenovo. The product you receive will depend on current stock availability.



Paxton10
Reader Converter

Sales code
010-552-US

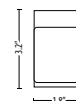

Paxton10
Wireless Connector

Sales code
010-592-US

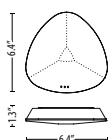

Paxton10
Desktop Reader

Sales code
010-387-US

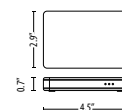

Access Control and Video Management

Paxton10 Cameras

Paxton10 includes Paxton's own video management solution and range of CORE & PRO cameras, providing a single point of management for system users. A Paxton10 system can manage up to 1000 cameras including integration with third party IP cameras.

- ▶ Industry leading low light performance (0.003 Lux)
- ▶ IP67 rated for internal and external use*
- ▶ IK10 rated robust metal construction**
- ▶ Edge and centralized recording capability
- ▶ Simple configuration

*010-924 is IP66 rated

**010-102 and 010-924 only

Paxton10 cameras come with a 256GB SD card (PRO Series) or 64GB SD card (CORE Series) as standard. Please note, the SD card is a consumable item and is therefore excluded from the guarantee.



NEW

High performance PRO series:

- ▶ 256GB surveillance quality on camera storage
- ▶ 8MP 4K resolution for crystal clear recording

PRO
series

NEW

High value CORE series:

- ▶ 64GB of in-built edge storage
- ▶ 4MP resolution

CORE
series



Paxton10 Mini Bullet
Camera - PRO Series

Sales code
010-158-US

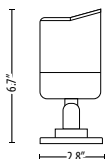

Paxton10 Mini Bullet
Camera - CORE Series

Sales code
010-911-US

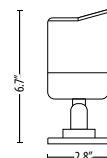

Paxton10 Vari-Focal Bullet
Camera - PRO Series

Sales code
010-924-US

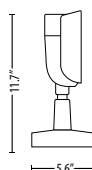

Paxton10 Mini Dome
Camera - CORE Series

Sales code
010-102-US

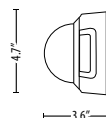

Paxton10 Turret
Camera - PRO Series

Sales code
010-480-US

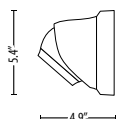

Paxton10 Turret Camera -
CORE Series

Sales code
010-705-US

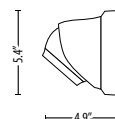

Paxton10 Mini Bullet
Camera Junction Box

Sales code
010-373-US

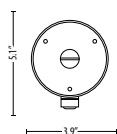

Paxton10 Mini Dome
Camera Junction Box

Sales code
010-799-US

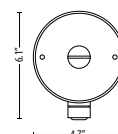

Paxton10 Turret
Camera Junction Box

Sales code
010-445-US

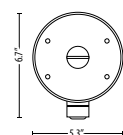

Access Control and Video Management



Paxton10 Reader Keypad

Sales code
010-721-US

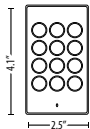

Paxton10 Keyfobs -
Pack of 10

Sales code
010-170-US

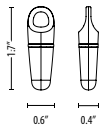

Paxton10 Vandal
Resistant Reader

Sales code
010-254-US

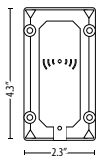

Paxton10 Bluetooth®
Hands Free Keyfob

Sales code
010-690-US



Paxton10 Slimline
Reader

Sales code
010-296-US

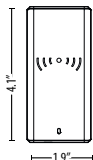

Paxton10 Cards -
Pack of 10

Sales code
010-427-US

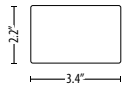



Paxton10 PaxLock Pro - Mortise,
Galaxy, black

Sales code
900-640BL-US

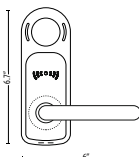

Paxton10 PaxLock Pro - Mortise,
Galaxy, white

Sales code
900-640WT-US

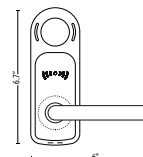

Paxton10 PaxLock Pro - Mortise,
Eclipse, black

Sales code
900-650BL-US

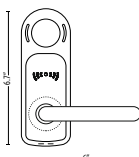

Paxton10 PaxLock Pro - Mortise,
Eclipse, White

Sales code
900-650WT-US

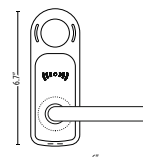

Paxton10 PaxLock Pro - Latch,
Galaxy, Internal, black

Sales code
900-620BL-US

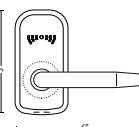

Paxton10 PaxLock Pro - Latch,
Galaxy, Internal, white

Sales code
900-620WT-US

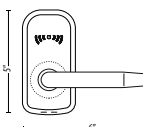

Paxton10 PaxLock Pro - Latch,
Eclipse, Internal, black

Sales code
900-630BL-US

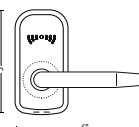

Paxton10 PaxLock Pro - Latch,
Eclipse, Internal, white

Sales code
900-630WT-US

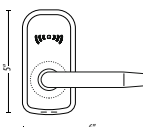

Please note: It is recommended that PaxLock Pro - Mortise is installed with a lockset with key override to ensure access can be gained in the rare event of a unit failure.**

Access Control and Video Management

PaxLock Pro Components

These products may be used with PaxLock Pro to aid installation on a variety of doors.

Yale® Latchbolt Mortise lock



Sales code
901-053-US

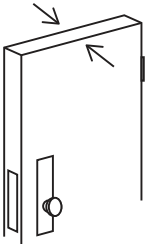

PaxLock Pro - Mortise, 2" door kit
Sales code
900-061-US

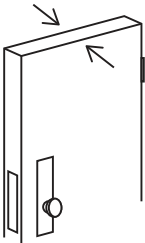
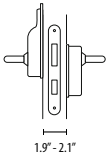

PaxLock Pro - Mortise, 2-1/4" door kit
Sales code
900-062-US

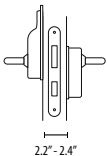

Yale® Deadbolt Mortise lock



Sales code
901-054-US



PaxLock Pro - Latch, 2" door kit
Sales code
900-059-US

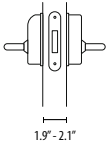

PaxLock Pro - Latch, 2-1/4" door kit
Sales code
900-060-US

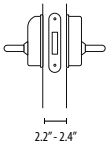

Yale® 1 1/2" lock cylinder



Sales code
901-058-US



PaxLock Pro - Mortise door installation jig
Sales code
900-081-US



PaxLock Pro - Latch door installation jig
Sales code
900-080-US



Paxton Connect

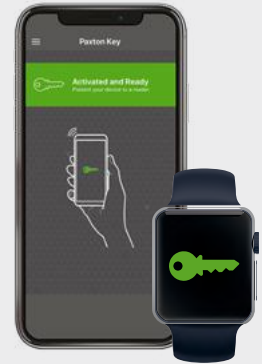

Paxton Key App

Paxton10 Software

A web-based user interface that is intuitive and easy to use.

Accessible from any device with an internet connection, the interface makes remote site management simple. The software comes as a native part of the system with a Paxton10 server. It has a range of intelligent features to maximise efficiency and optimize the combined access and video management solution.

- ▶ Web-based software – no installation, plug-ins or upgrading required
- ▶ Free of charge – simple online updates with no ongoing charges
- ▶ Suitable for touchscreen and desktop devices
- ▶ Optimised for use on PCs and tablets
- ▶ Low battery alerts, easy to monitor back up battery state
- ▶ Flexible and secure remote access

Features:

Dashboards - Customized dashboards to suit any user requirements

Reports - Powerful reporting engine where all system events and videos can be reviewed

Site plans - For the visual management of the system

Tutorial wizards - Support new and existing users to make full use of the software

People - Manage user permissions, credentials and information

Rules - Set permissions, time profiles, triggers and actions and much more

Devices - Configure and manage the devices in a building

Paxton10 Apps

Paxton Connect

Flexible site management

The Paxton Connect app provides easy and flexible site management for Paxton10. Containing easy to use features in one smart user interface, Paxton Connect enables you and your customers to manage multiple sites remotely from a smartphone.

Features:

People - Manage user permission, credentials and information

Reports - Access all system reports from your smart device or tablet

Devices - Configure and manage all devices on site

Dashboards - Access custom dashboards for personalized system overview

Paxton Key

Utilize smart devices as access tokens

The Paxton Key app allows system users to make use of their smartphone, smartwatch or tablet in place of traditional tokens. These are called smart credentials and can be issued free of charge. Utilizing the built-in Bluetooth® wireless technology in Paxton10 readers, the smart device can securely communicate with the Paxton10 system to grant or deny access. Paxton Key also enables the user to carry out predefined building management functionality – such as setting the intruder alarm.

Download the free apps from the **App Store** or **Google Play**



Video Intercom

Entry is a video intercom system that works standalone or alongside Net2 access control, combining door entry with key features of Net2.

Entry is a scalable solution, allowing expansion of up to a hundred panels and a thousand monitors.

- ▶ Just 3 components - monitor, panel and door controller
- ▶ Premium, standard, audio, and vandal resistant solutions available
- ▶ Intruder alarm integration - set the alarm in Net2 from the Entry panel for extra convenience
- ▶ Pan/tilt camera functionality to capture an angled view
- ▶ Low light sensitivity camera - ideal for use day or night
- ▶ SIP compatibility - the door can be answered from cell phone, tablet or PC
- ▶ Add a secondary IP camera for higher security sites



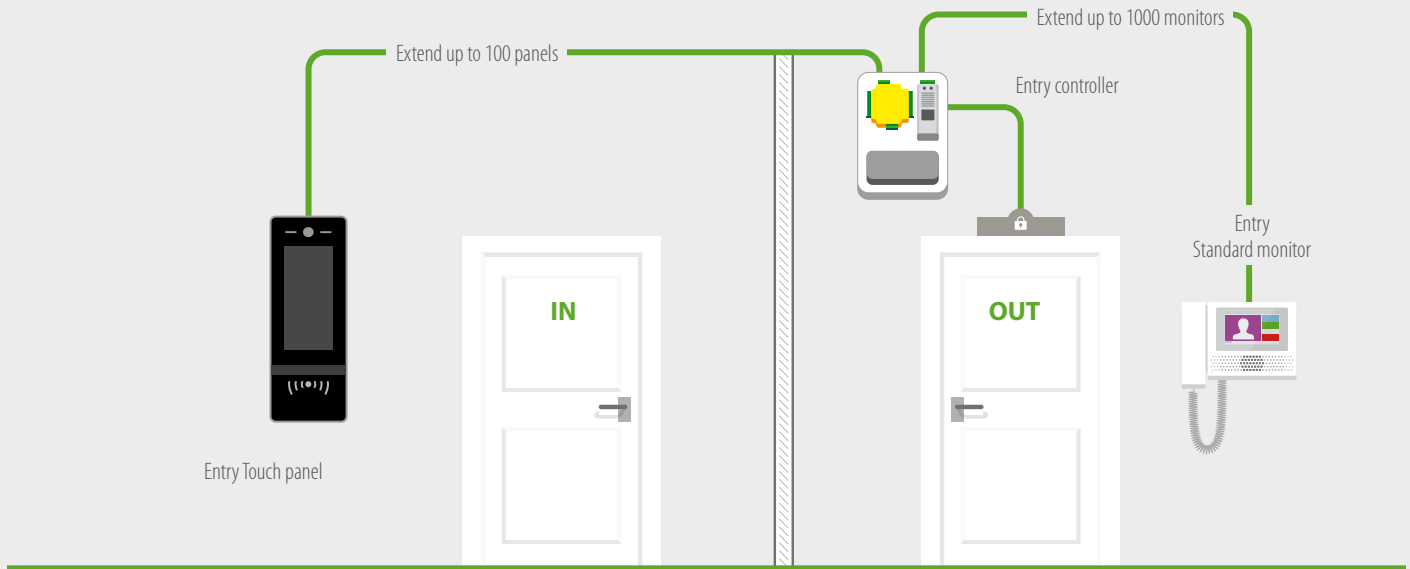

Entry

A smart, simple video intercom system.

- ▶ Panels available in three variants: the Entry Touch panel with an advanced 7-inch color touch screen, Entry Standard panel in anthracite grey and the Entry VR panel in super durable stainless steel
- ▶ All variants available in flush, surface and rain-hood versions - suitable for a range of environments
- ▶ Three monitors available, including premium, standard and audio, to create a custom solution for any site
- ▶ Personalize the Entry Touch panel, premium monitor and Standard monitor with multiple theme options and contact images for quick visual recognition
- ▶ Video voicemail, enables visitors to leave a video message
- ▶ Add a secondary IP camera for higher security sites
- ▶ Reads Paxton and MIFARE® token technology



* Indicates readers that have functionality to read HID™ 125kHz Proximity when enabled using Genuine HID Technology™ 125kHz. Proximity activation license cards, sold separately (see Tokens section, [pg.18](#)).



Entry - Touch panel, surface mount

Sales code
337-620-US

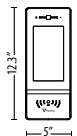

Entry - Touch panel, flush mount

Sales code
337-600-US

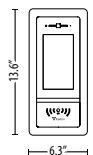

Entry - Touch panel, surface mount with rain hood

Sales code
337-610-US

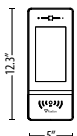

Video Intercom



Entry - VR panel, surface mount

Sales code
337-520-US

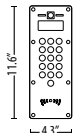

Entry - Standard panel, surface mount

Sales code
337-420-US

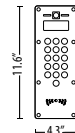

Entry - VR panel, flush mount

Sales code
337-500-US

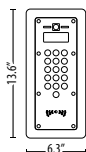

Entry - Standard panel, flush mount

Sales code
337-400-US

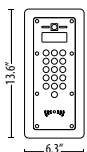

Entry - VR panel, surface mount with rain hood

Sales code
337-510-US

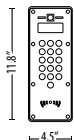

Entry - Standard panel, surface mount with rain hood

Sales code
337-410-US

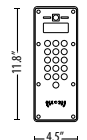

Entry Premium monitor

Sales code
337-290-US

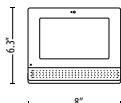

Entry Premium monitor - with handset

Sales code
337-292-US

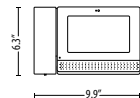

Entry monitor - desktop stand

Sales code
337-294-US

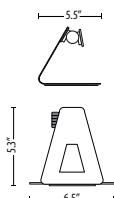



Entry Standard monitor

Sales code
337-280-US

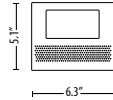
Entry Standard monitor -
with handset

Sales code
337-282-US

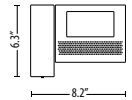

Entry Audio monitor

Sales code
337-270-US

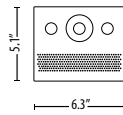

Entry Audio monitor - handset

Sales code
337-272-US

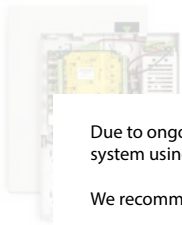
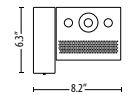

Net2 Entry - Control unit



Entry - Extension switch

Due to ongoing component supply issues, the Net2 Entry - Control Unit and Entry - Extension switch are temporarily unavailable. You can continue to install our Entry system using a Net2 Plus controller and any 802.3af or 802.3at (PoE+) compliant 3rd party PoE switch.

We recommend the TP Link TL-SF1006P switch which has been thoroughly tested with the Entry system.

Entry Standard Monitor

The latest addition to our video intercom range.

Introducing the next generation standard monitor, a versatile, feature rich and cost-effective solution.

- Excellent audio quality, full-duplex voice communication & easy read, high contrast screen
- Personalized experience with 14 theme designs. Premium user interface with call & event log
- Action buttons, call snapshot and compatibility with concierge management*
- Available with or without a handset. Universal wall or desk mounting
- Quick and easy installation, providing a true plug and play solution



*When used with the Entry Premium monitor.
The standard monitor cannot function as the concierge monitor.

Video Intercom

Demo Cases

Demo cases contain everything you need to demonstrate a one door system.

Additionally, show your customers the benefits of our simple video intercom solution in just two minutes, with the Entry video. Watch it here: <http://paxton.info/3143>

* Indicates readers that have functionality to read HID™ 125kHz Proximity when enabled using Genuine HID Technology™ 125kHz. Proximity activation license cards, sold separately (see Tokens section, [pg.18](#)).



Demo case * Entry - Touch panel

The case includes an Entry Touch panel, Entry Premium monitor and a sample pack of Net2 demonstration tokens.

Sales code
337-635-US



Demo case * Entry - Standard panel

The case includes an Entry Standard panel, Entry Standard monitor and a sample pack of Net2 demonstration tokens.

Sales code
337-430-US



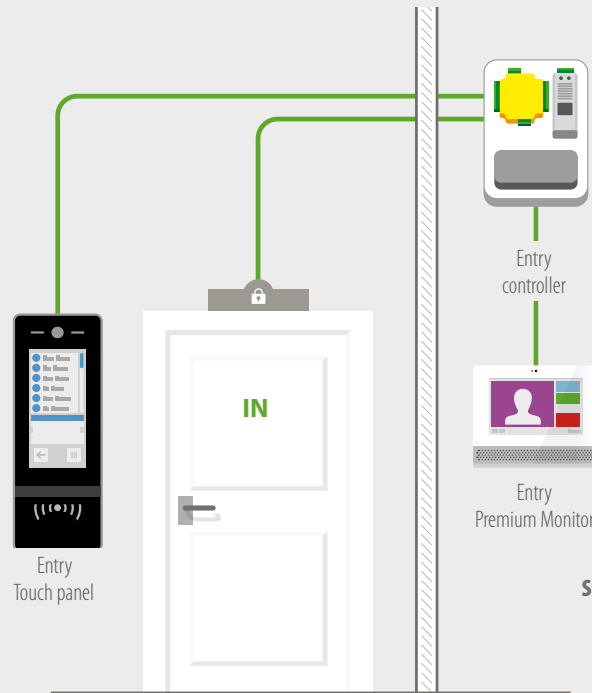

Standalone Entry system does not require connection to a network or server

Entry now works Standalone

Our standalone access control is a non-networked system that provides a simple and low maintenance solution made up of readers or door controllers.

- Quick system installation with no servers or PCs required
- Simple user management
- Combine with other Paxton standalone products
- Build an entire easy-to-use system supporting the same tokens across the site
- Easily expand and upgrade to an online Net2 solution with no hidden costs
- Enable offline token-based access control on any Entry site



We also have standalone colored keyfobs and function cards to make it even simpler to manage access control within the system

Watch the Entry Video



Show your customers the benefits of our simple video intercom solution in just two minutes, with the Entry video.

- ▶ Featuring the whole Entry range, including the touch panel and premium monitor
- ▶ Just 3 components that auto-detect on set up
- ▶ Discover a scalable solution that suits a variety of locations

Watch it here:

<http://paxton.info/3143>

Standalone Access Control

Standalone access control is the simplest way to secure and control access through doors around your building. If you're looking to step up security, protect your staff and assets and save money, then Standalone access control is for you.

- ▶ A non-networked access control solution
- ▶ Simple and unique card management system
- ▶ Internal (Compact)/external (Switch2)
- ▶ Suitable for small to medium sized premises, or any site looking to secure a small number of doors



Switch2

Switch2 is a standalone system that comes as a separate single door controller and reader. The door controller is fitted on the secure side of the door, with the reader fitted on the other side. Switch2 offers a secure solution for customers wishing to control door access, who do not need the reports on users' movements provided by a PC based access control system.

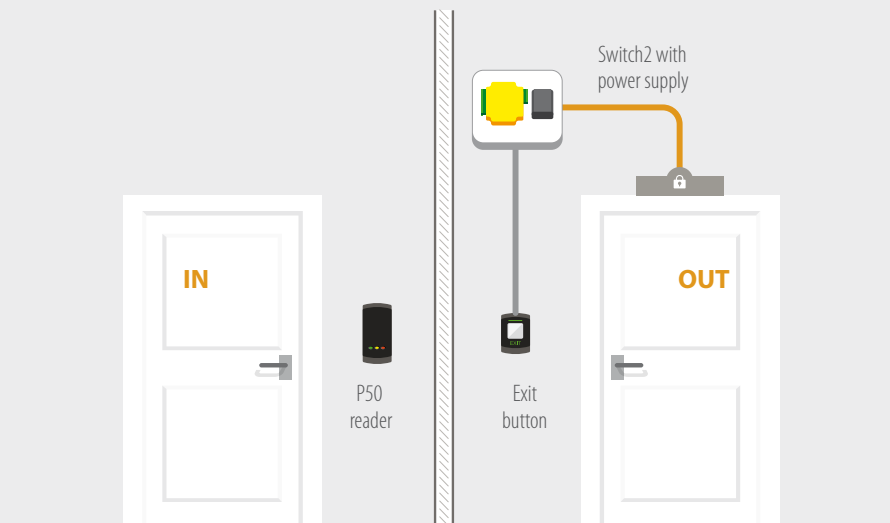

Switch2 control unit

Sales code
405-321-US

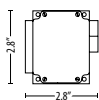

Switch2 ACU and 1A PSU in plastic housing

Sales code
242-166-US

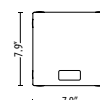

StandaloneAccess Control

Switch2 Readers

These readers are for use with Switch2. Designed to fit in seamlessly in any environment, our wide range means you get the right choice for your site requirements.



PROXIMITY P38 reader

Sales code
333-110-US



BEST SELLER

Proximity P50 Mullion reader

Sales code
345-220-US

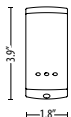

PROXIMITY P75 reader

Sales code
373-110-US

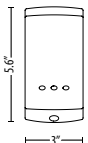

PROXIMITY P200 reader

Sales code
323-110-US



PROXIMITY P200 reader - Metal mount

Sales code
324-110-US



PROXIMITY metal reader, satin chrome

Sales code
390-747-US



PROXIMITY metal reader, chrome

Sales code
390-727-US





PROXIMITY vandal proof reader

Sales code
568-855-US

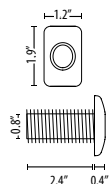

PROXIMITY panel mount reader

Sales code
390-135-US



PROXIMITY marine reader

Sales code
500-010-US

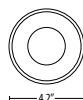

Energy saving reader

Sales code
595-248-US

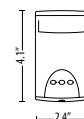

Long range reader

Sales code
313-110-US

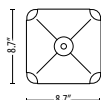

CARDLOCK reader, satin chrome

Sales code
409-711SC-US

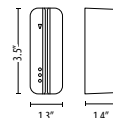

PROXIMITY architectural reader,
Gunmetal grey

Sales code
360-864GG-US



Insert - Stone
Sales code
361-002-US



Insert - Glass with logo
Sales code
361-003-US

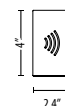

PROXIMITY architectural reader, satin
chrome

Sales code
360-864SC-US





PROXIMITY KP50 keypad

Sales code
355-110-US



PROXIMITY KP75 keypad

Sales code
375-110-US

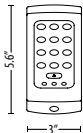

TOUCHLOCK K50 keypad

Sales code
351-110-US



TOUCHLOCK K75 keypad

Sales code
371-110-US

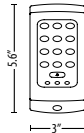

TOUCHLOCK K50 stainless steel keypad

Sales code
352-110-US



TOUCHLOCK K75 stainless steel keypad

Sales code
372-110-US

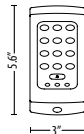

Vandal resistant metal keypad

Sales code
521-715-US

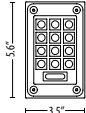

Compact

Compact is a standalone solution where all the electronics are housed within the reader. Compact is suitable for low security internal doors requiring a cost-effective solution.

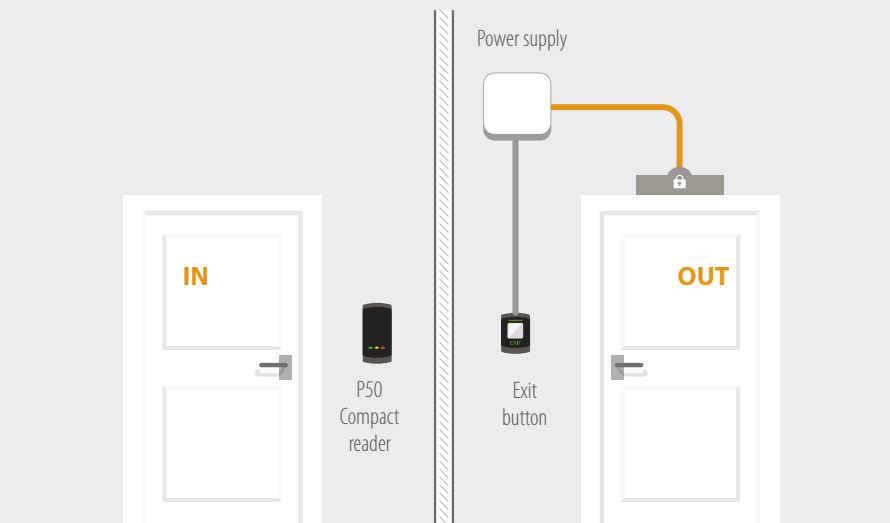

PROXIMITY P38 compact reader

Sales code
333-210-US

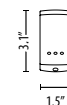

PROXIMITY P50 compact reader

Sales code
353-210-US

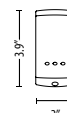

PROXIMITY P75 compact reader

Sales code
373-210-US



PROXIMITY compact vandal proof reader

Sales code
326-735-US

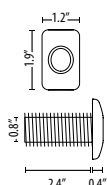

Vandal resistant compact metal keypad

Sales code
521-836-US

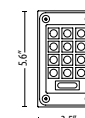

StandaloneAccess Control



TOUCHLOCK K50 compact keypad

Sales code
351-210-US



TOUCHLOCK K75 compact keypad

Sales code
371-210-US

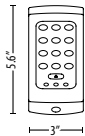

TOUCHLOCK K50 stainless steel compact keypad

Sales code
352-210-US



TOUCHLOCK K75 stainless steel compact keypad

Sales code
372-210-US

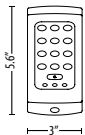

Standalone Tokens

These tokens are for use with Switch2 and Compact systems..



PROXIMITY 10 keyfob pack - Green, Amber or Red

Sales code
820-010G/A/R-US

BEST SELLER

PROXIMITY 50 keyfob pack - Green, Amber or Red

Sales code
820-050G/A/R-US



PROXIMITY 10 card pack - Green, Amber or Red

Sales code
830-010G/A/R-US

BEST SELLER

PROXIMITY 50 card pack - Green, Amber or Red

Sales code
830-050G/A/R-US



10 hands free keyfob pack for Switch2, green

Sales code
860-010G-US



Proximity function card pack

Sales code
820-000-US

Standalone Access Control

Standalone Accessories

These accessories are for use with Switch2 and Compact systems.



Exit button E50

Sales code
356-310-US



Exit button E75

Sales code
376-310-US

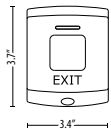

Exit button marine

Sales code
593-721-US



Hands free interface in plastic housing

Sales code
477-222-US



US Metal Enclosure Only

Sales code
857-600-US

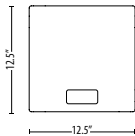

PoE+ power supply in metal cabinet

Sales code
857-630-US

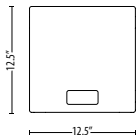

12/24V DC 2.5A power supply in metal cabinet

Sales code
857-610-US

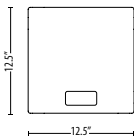



ISO card holder, clear, pack of 5

Sales code
696-400-US

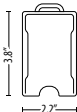

Hands free card holders with
suckers, pack of 5

Sales code
696-100-US

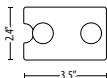

Additional Information

Dealer training

We offer practical hands-on training for our Net2 system. The BICSI CEC registered program is designed to provide you with the essential knowledge needed to install Paxton products.

- ▶ Ensure accurate installation
- ▶ Reduce time on site
- ▶ Courses are free of charge
- ▶ Materials and equipment provided

For more information and to book a session, go to <http://paxton.info/3139>.



Industry leading technical support

Call Paxton and you will be put straight through to our expert support team. Our friendly team is available from 2am-8pm EST Monday-Friday.

Call : 877.438.7298
E-mail : supportUS@paxton-access.com
Skype : USApaxton.support



Sales literature

We offer an extensive range of brochures and sales guides to support you every step of the way, from sales to specification. All documentation is available to download from our website at <http://paxton.info/1549>.

Case studies

Find out how the Net2 system can be adapted to meet a range of diverse requirements by reading our latest case studies. We have a range of examples covering education, healthcare, retail, leisure, commercial and public buildings.

See our latest case studies here:
<http://paxton.info/3140>

Net2 integration

We want to ensure that we are providing the most sophisticated solutions available. We do this by working with quality manufacturers to provide the best of breed solutions and making them available to you. You can see a map of our Net2 integration partners at <http://paxton.info/2958>.



Sign up to our newsletter

The Paxton Installer is your regular newsletter, containing the latest news, product information and updates from us. Your copy of the Paxton Installer will arrive in your inbox, full of useful information that will make your job easier and help you to win more business.

Sign up now:
<http://paxton.info/3141>

Notes

[illegible]

Notes

[illegible]

Notes

[illegible]



Paxton 5 year warranty and hassle free returns policy

We offer a five year guarantee on all our products.

If a problem arises, all you have to do is return your Paxton product to your local distributor.

We want to make life as easy as possible for installers of Paxton products. Our five year warranty and hassle-free returns policy helps us to do this successfully.



Product Selection Guide 2022

 **Paxton Access Inc.**
138 Commerce Center
Greenville
SC 29615
USA

 877.438.7298

 supportUS@paxton-access.com

 www.paxton-access.com/us

MIFARE® is a registered trademark of NXP B.V. and is used under license.

The Genuine HID Technology logo is a trademark of HID Global Corporation/ASSA ABLOY AB. Used with permission.

All information and specifications correct at the point of publication, but may be subject to change without notice.

All pictures shown are for illustration purpose only. Actual products may vary.