

# AL600X220 Series

## Power Supply/Chargers

Altronix AL600X220 series power supply/chargers convert a 220VAC (working range 198VAC - 256VAC), 50/60Hz input into a single, four (4), eight (8) or sixteen (16) fuse/PTC protected outputs. Outputs are selectable for 12VDC or 24VDC with a total of 6A max.



AL600PD8220

### Key Features

- Available with 1, 4, 8 or 16 outputs
- Fused or PTC protected outputs
- Supervision
  - AC Fail;
  - Battery Fail and Battery Presence
- Built-in charger for sealed lead acid or gel type batteries
- Instantaneous transfer to stand-by batteries
- Short circuit and overload protection
- AC input and DC output options
- CE European Conformity
- Lifetime Warranty
- All units are available in grey or red enclosure

### AL600X220 series Power Supply Configuration Reference Chart

Altronix Model Number	Total Output Rating (A)	Input Rating: 220VAC, 50/60Hz	Input Fuse Rating	Power Distribution Module(s)	Number of Outputs	Fused Outputs Ratings	PTC Auto-Resettable Outputs Ratings	Accommodates Batteries	
AL600X220	6A	1.5A	5A/250V	N/A	1	6A	-	Two (2) 7AH	
AL600XX220									Two (2) 12AH
AL600PD4220				PD4	4	3.5A	-	-	Two (2) 7AH
AL600XPD4220									Two (2) 12AH
AL600PD4CB220				PD4CB	-	-	2.5A	-	Two (2) 7AH
AL600XPD4CB220									Two (2) 12AH
AL600PD8220				PD8	8	3.5A	-	-	Two (2) 7AH
AL600XPD8220									Two (2) 12AH
AL600PD8CB220				PD8CB	-	-	2.5A	-	Two (2) 7AH
AL600XPD8CB220									Two (2) 12AH
AL600XPD16220				Two (2) PD8	16	3.5A	-	-	Two (2) 12AH
AL600XPD16CB220									Two (2) PD8CB

#### Lifetime Warranty



# AL600X220 Series

Power Supply/Chargers

## Specifications

### Input

Voltage 220VAC (working range 198VAC - 256VAC), 50/60Hz, 1.5A max.

Fusing 5A/250V

### Outputs

Voltage 12VDC or 24VDC selectable

Current 6A @ 12VDC or 24VDC continuous max

Protection Fused 3.5A / PTC 2.5A

Other Overvoltage protection  
Filtered and regulated

### Battery Charging

Capacity 7AH/12VDC (1 or 2 within enclosure)  
12AH/12VDC (requires larger "X" enclosure)  
40AH/65 AH (requires separate enclosure)

Type Sealed lead acid or gel type

Failover Upon AC loss, instantaneous

Batteries are sold separately

### Supervision

AC Failure Form "C" contacts

Battery Form "C" contacts

### Indicators (LED)

Input 220VAC is present

DC Output Powered

Battery Discharged or not connected

### Agency Listings

CE European Conformity

## Physical and Environmental

### Dimensions (H x W x D)

**AL600X220, AL600PD4(CB)220, AL600PD8(CB)220:**

Enclosure:

13.5" x 13" x 3.25" (342.9mm x 330.2mm x 82.55mm)

Shipping:

15" x 13.875" x 4.75" (381mm x 352.4mm x 120.6mm)

**AL600XX220, AL600XPD4(CB)220, AL600XPD8(CB)220,**

**AL600XPD16(CB)220:**

Enclosure:

15.5" x 12" x 4.5" (393.7mm x 304.8mm x 114.3mm)

Shipping:

16.5" x 13.5" x 6" (419.1mm x 342.9mm x 152.5mm)

### Weight (approx.)

Model	Product Weight	Shipping Weight
AL600X220	7.05 lb. (3.2 kg)	8.9 lb. (4.1 kg)
AL600XX220	8.65 lb. (3.92 kg)	10.95 lb. (4.97 kg)
AL600PD4(CB)220	7.2 lb. (3.27 kg)	9.05 lb. (4.1 kg)
AL600XPD4(CB)220	8.7 lb (3.95 kg)	11.1 lb. (5.03 kg)
AL600PD8(CB)220	7.3 lb. (3.31 kg)	9.15 lb (4.15 kg)
AL600XPD8(CB)220	8.8 lb. (4.0 kg)	11.2 lb. (5.08 kg)
AL600XPD16(CB)220	8.95 lb. (4.06 kg)	11.25 lb. (5.1 kg)

### Temperature

Operating: 0°C to 49°C (32°F to 120°F)

Storage: -20°C to 70°C (-4°F to 158°F)

Relative Humidity 85% +/- 5%

BTU/Hr (approx.) 12VDC: 37 BTU/Hr.

24VDC: 74 BTU/Hr.

### Lifetime Warranty

Altronix Corporation | 140 58th St | Brooklyn, NY 11220 USA

phone: +1 718.567.8181 | fax: +1 718.567.9056 | email: info@altronix.com | www.altronix.com

# AL600X220 Series

Power Supply/Chargers

## Dimensions and Drawing

AL600X220, AL600PD4(CB)220, AL600PD8(CB)220 Dimensions (H x W x D approximate)

13.5" x 13" x 3.25" (342.9mm x 330.2mm x 82.6mm)

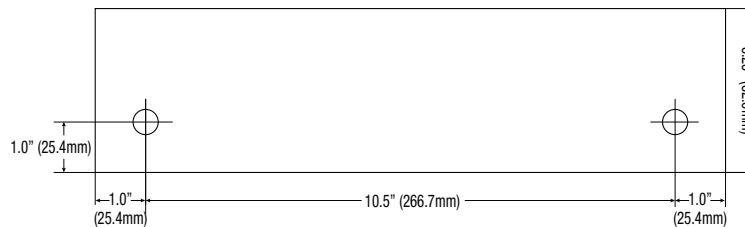
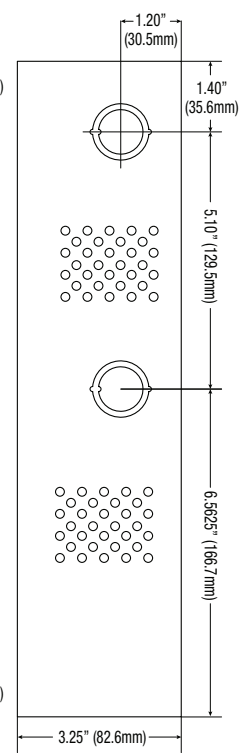
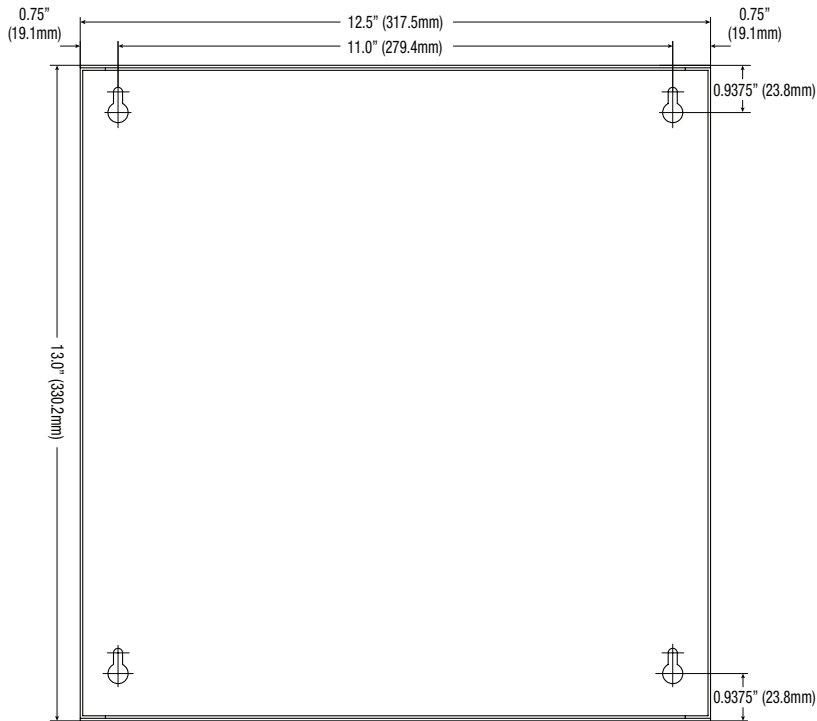
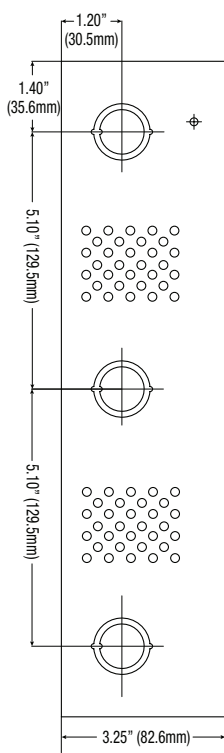
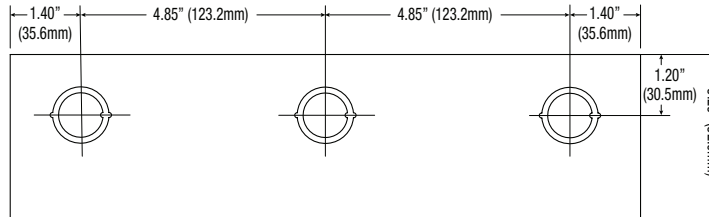

### Lifetime Warranty

Altronix Corporation | 140 58th St | Brooklyn, NY 11220 USA

phone: +1 718.567.8181 | fax: +1 718.567.9056 | email: info@altronix.com | www.altronix.com

# AL600X220 Series

Power Supply/Chargers

## Dimensions and Drawing

AL600XX220, AL600XPD4(CB)220, AL600XPD8(CB)220, AL600XPD16(CB)220 Dimensions (H x W x D approximate)  
15.5" x 12" x 4.5" (393.7mm x 304.8mm x 114.3mm)

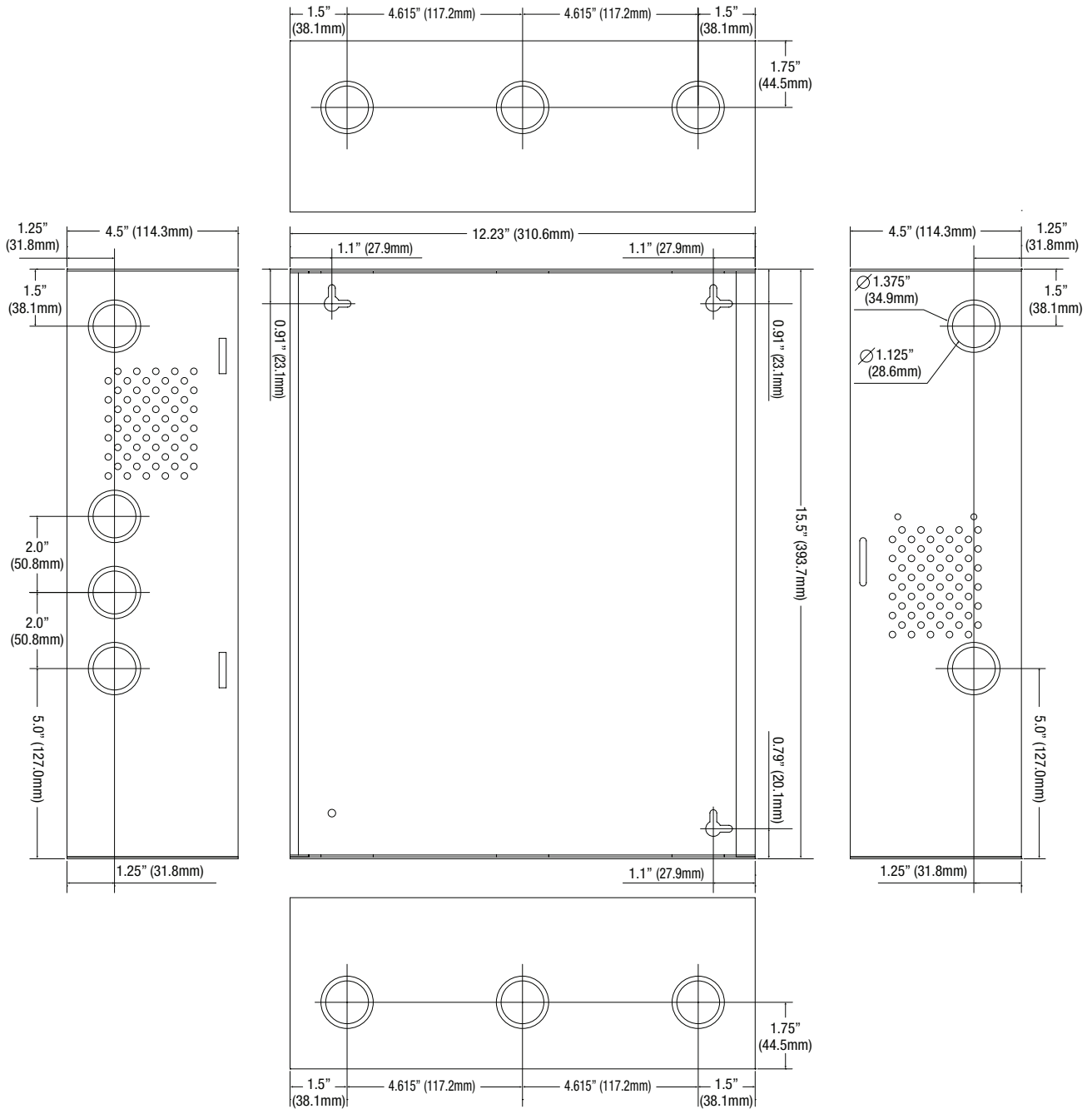

### Lifetime Warranty

Altronix Corporation | 140 58th St | Brooklyn, NY 11220 USA

phone: +1 718.567.8181 | fax: +1 718.567.9056 | email: info@altronix.com | www.altronix.com