

**Sonus**  
6205W  
6205B

**COMELIT**<sup>®</sup>  
WITH • YOU • ALWAYS

FULL TECHNICAL MANUAL

---

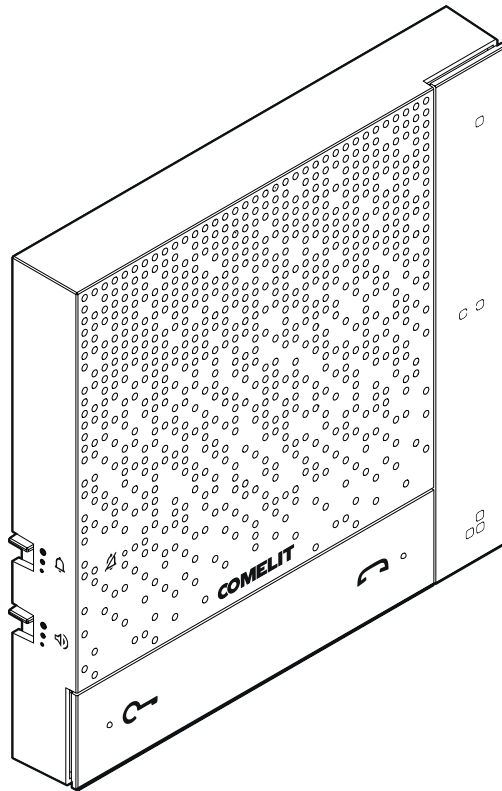

**Join us  
in taking care  
of our planet**

## Sonus Hands-free Door-entry phone for ViP system

*Design-led door-entry phone for ViP system, with hands-free and electronic call. It features 5 buttons at the front, of which 2 have backlit icons identifying their factory-set functions (lock-release and call management) and 3 are programmable buttons.*

*The buttons have touch guides for sight-impaired users. There are 2 switches on the left-hand side of the door-entry phone: the first sets the ringtone volume or silent mode (with indicator LED) and the second sets the audio volume.*

*It allows "Automatic lock-release on receipt of call (Doctor)", "Automatic answer (hands-free)", conversation privacy and floor door call management modes. Dimensions (L x H x D): 121 x 121 x 25 mm.*



**Think before  
you print  
and use the  
interactive links**



***Help us to save the planet.***

*Think of the planet before printing this document.*

***You are reading an interactive document:*** quickly access the content you are interested in via links.

## Table of contents

<b>Descrizione</b>	<b>4</b>
Descrizione pulsanti	5
LED di segnalazione	5
<b>Caratteristiche tecniche</b>	<b>6</b>
<b>Installazione</b>	<b>8</b>
Smontaggio	9
<b>Schema di collegamento</b>	<b>10</b>
<b>Procedure di reset</b>	<b>11</b>
Ripristino configurazione di rete	11
Ripristino delle impostazioni di fabbrica	11
<b>Programmazione</b>	<b>12</b>



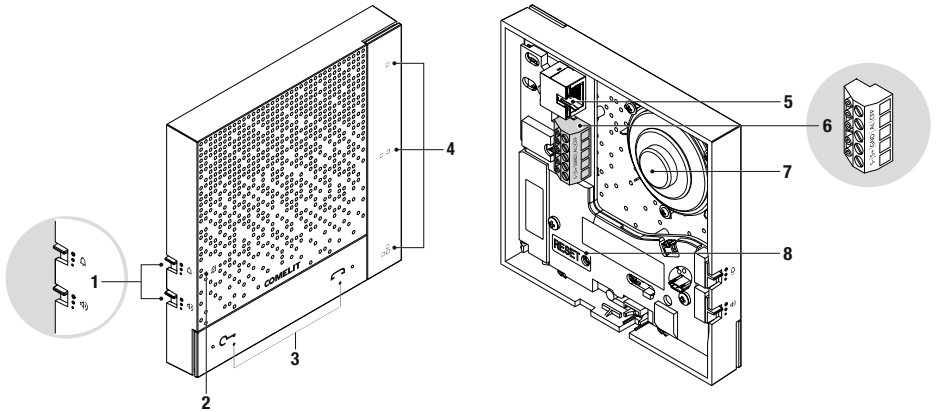

# Description



1. Two slide selectors, starting from the top:
  - 3-level selector switch for ringtone volume adjustment (high/medium/silent mode)
  - 3-level selector switch for audio volume adjustment (high/medium/low)
2. Status LED for "silent mode"
3. Two backlit call buttons
4. Three programmable buttons
5. RJ45 Ethernet port (default DHCP)
6. Removable terminal block:
  - S-** Output for door lock control
  - S+** Output for door lock control
  - GND** Common pole
  - AL** Input (programmable) Alarm input
  - CFP** Input (programmable) Floor door call input (Floor Door Call)
7. Loudspeaker
8. Reset key

## Description of buttons

---

	<b>Audio activation</b> ▶ Press the key to answer a call or end a call in progress
	<b>Lock-release control</b> ▶ Press the key to activate the corresponding door lock
	<b>Programmable key 1</b> ▶ Press the key to activate the corresponding control
	<b>Programmable key 2</b> ▶ Press the key to activate the corresponding control
	<b>Programmable key 3</b> ▶ Press the key to activate the corresponding control



---

## Indicator LED

Buttons with backlit icons help the user to understand the event taking place, for example: flashing for an incoming call or a steady green light when the “Automatic answer” function is enabled.

For a more detailed understanding, please refer to the legend below:

---

	<b>Green LED</b>	<b>Flashing:</b> incoming call <b>Steady:</b> the “Automatic answer” function is enabled
	<b>Red LED</b>	<b>Steady:</b> in communication during a call
	<b>White LED</b>	<b>Flashing slowly:</b> indicates that the corresponding door lock has been opened <b>Steady:</b> the “Automatic lock-release” function is enabled <b>Continuous flashing:</b> incoming call or call in progress
	<b>Red LED</b>	<b>Steady:</b> indicates that “Silent mode” has been activated

---

# Technical specifications

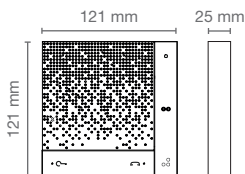

GENERAL DATA	
Product weight	188 grams
Surface mounting	Yes
Audio/video system	Yes
COMPATIBLE SYSTEMS	
VIP	Yes
AUDIO SPECIFICATIONS	
Type	Hands-free
Microphone	6 mm (Ø), Omnidirectional
Loudspeaker	50 mm (ø), 8 Ohm, 0.2 W
ELECTRICAL SPECIFICATIONS	
Type of power supply	PoE
Power supply voltage	37 to 57 VDC (ViP)
PoE power supply	Standard IEEE 802.3af (class 0), Comelit PoE (56 VDC)
Absorption in standby	1.1W
Absorption in standby in kit mode	1.1W
Maximum absorption	2.9 W
HARDWARE SPECIFICATIONS	
Type of buttons	Mechanical
No. of programmable buttons for additional functions	3
Terminals	GND AL CFP S+S
Removable terminals	Yes
Number of inputs (no.)	2
Ethernet ports (no.)	1
Total buttons (no.)	5
LED indicators (no.)	3
Network connection	RJ45
Video encoding	H.264
SETTINGS	
Loudspeaker volume	Yes
Ringtone volume	Yes

**NETWORK AND COMMUNICATION PROTOCOL**

<b>LAN type</b>	Ethernet 10/100 Mbit/s
<b>IP address assignment</b>	DHCP, AUTO IP, static IP
<b>Operating system</b>	Linux (v. )

**ENVIRONMENTAL AND CONFORMITY SPECIFICATIONS**

<b>IP protection rating</b>	IP30
<b>Operating temperature (°C)</b>	5 to 40
<b>Environmental class</b>	I (B1)
<b>CE certification</b>	RoHS II - 2011/65/UE (EN IEC 63000:2018), EMC 2014/30/UE (EN 61000-6-1:2007, EN 61000-6-3:2007+A1:2011), IEC/EN 62820-1-2

**GENERAL FEATURES**

<b>Automatic lock-release on receipt of call (Doctor)</b>	Yes
<b>Lock-release</b>	Yes
<b>IP assignment</b>	Auto IP, DHCP, Static
<b>Call to group addresses</b>	Yes
<b>Multiple address call</b>	Yes
<b>Switchboard call</b>	Yes
<b>Intercom calls</b>	Yes
<b>Panic call</b>	Yes
<b>Actuator control</b>	Yes
<b>Floor door call function</b>	Yes
<b>Privacy conversation function</b>	Yes
<b>Key button function</b>	Yes
<b>Hands-free function</b>	Yes
<b>Silent mode (Privacy)</b>	Yes
<b>Call repetition</b>	Yes
<b>Automatic answer (hands-free)</b>	Yes
<b>Acoustic indications</b>	Yes
<b>Visual indications</b>	Yes
<b>VIP system</b>	Yes
<b>Electronic ringtone</b>	Yes
<b>Customisable ringtone</b>	Yes

# Installation

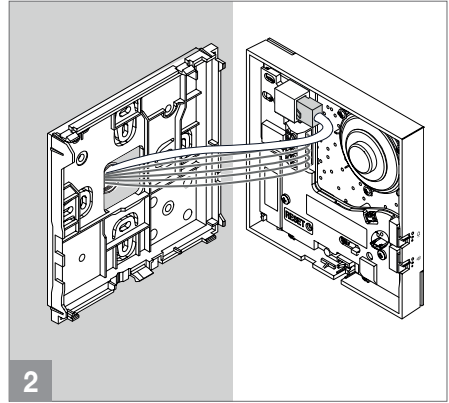
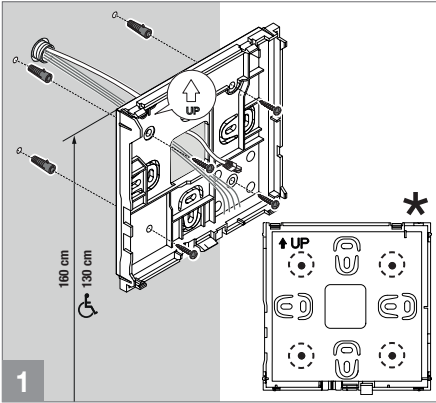

\* Fixing points for use when installing in compatible boxes

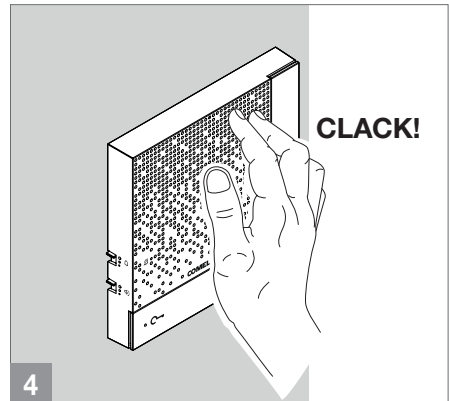
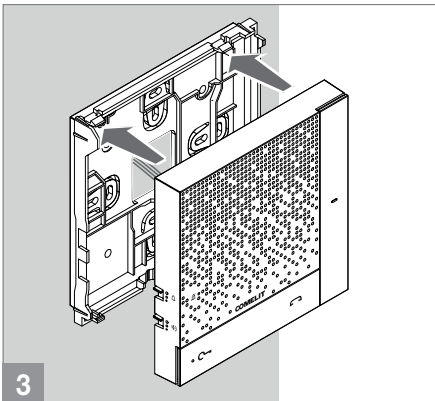
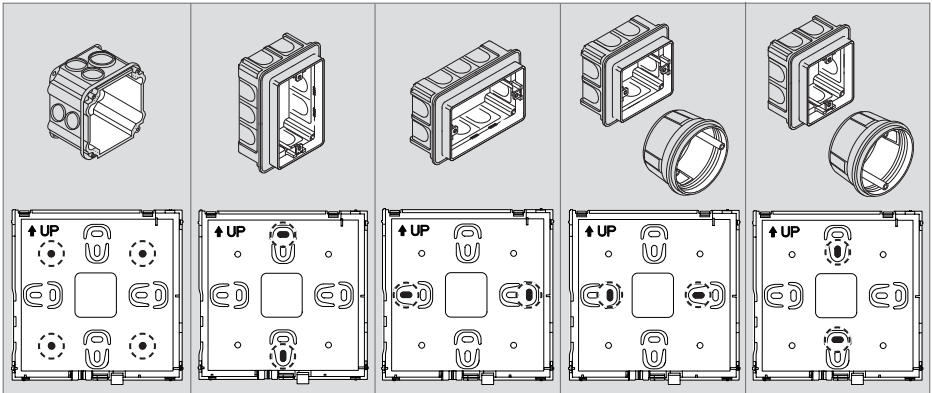



## Disassembly

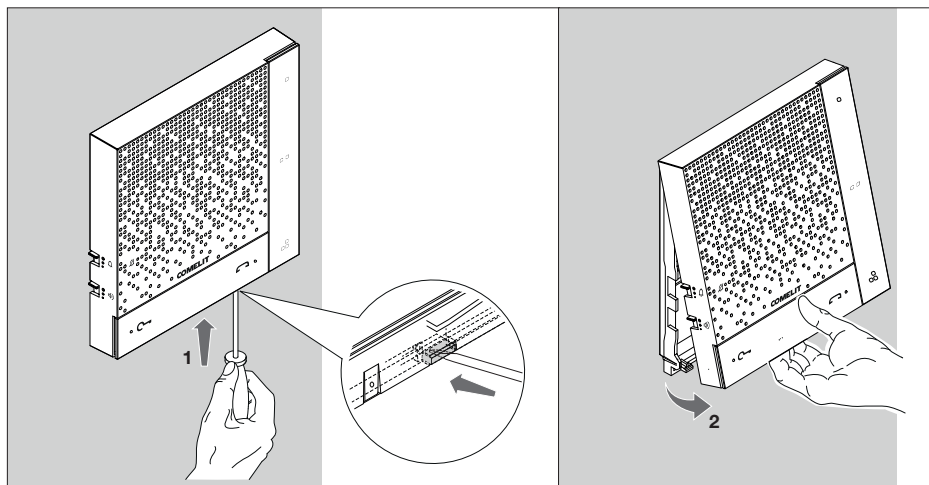

# Wiring diagram



The device is configured in DHCP mode by default, i.e. the DHCP server on the local network dynamically assigns an IP address.

If a DHCP server is not detected, the device will automatically set an IP address using the Auto IP mode.

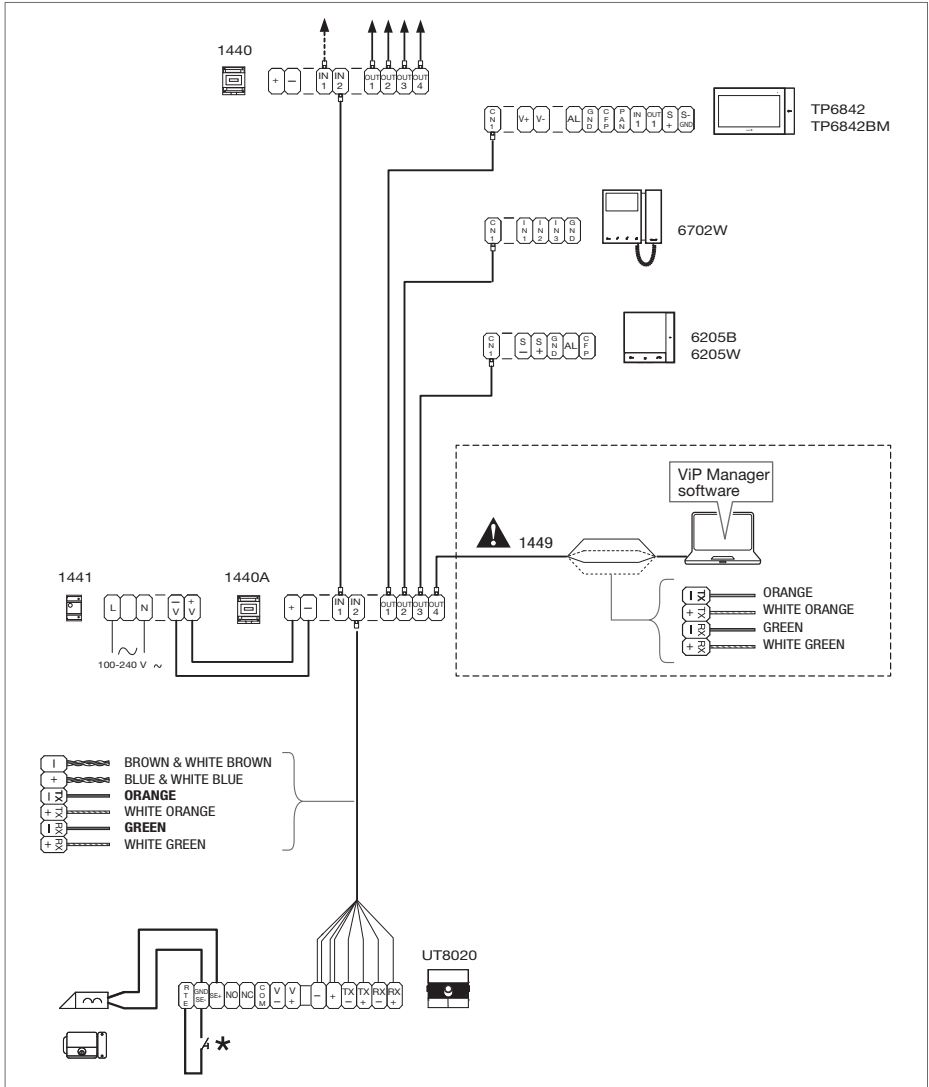

★ Max 20 m Local door-opener button.

# Reset procedure

## Restore network settings

*The device resets the network configuration to factory settings (DHCP + fallback in Auto Ip) and starts up.*

1. Disconnect the power supply to the device.
2. Press and hold the reset button.
3. Reconnect the power supply
  - » *The device will switch on.*
4. Wait for the indicator LED to slowly flash GREEN/RED.
  - » *You will hear the device say "Release now for network reset".*
5. Release the reset button within 10 seconds (\*)
  - » *To confirm the start of the reset procedure, the indicator LED flashes GREEN 5 times.*
  - » *You will hear a confirmation tone.*
6. Wait for the device to complete the startup process.
  - » *The LED will turn YELLOW and then WHITE to confirm that the reset procedure has been completed.*

### CAUTION:

- **(\*) If you do not release the button within 10 seconds, you will be taken to the "Restore factory settings" procedure. (See next paragraph).**
- **If no changes have been made to the network parameters, the previously saved parameters will be restored the next time the device is restarted.**

## Restore factory settings

*The device resets all parameters to factory settings and starts up.*

1. Disconnect the power supply to the device.
2. Press and hold the reset button.
3. Reconnect the power supply.
  - » *The device will switch on.*
4. Wait for the indicator LED to slowly flash GREEN/RED.
5. Press and hold the reset button until the indicator LED flashes rapidly GREEN/RED.
  - » *You will hear the device say "Release now for factory reset".*
6. Release the reset button.
  - » *To confirm the start of the reset procedure, the indicator LED flashes RED 5 times.*
  - » *You will hear a confirmation tone.*
7. Wait for the device to complete the startup process.
  - » *The LED will turn YELLOW and then WHITE to confirm that the reset procedure has been completed.*

**CAUTION: If the reset button is pressed for more than 20 seconds, the device will start up normally without any changes to the settings (the indicator LED will turn YELLOW and then go out), in which case you will hear the device say "Reset aborted, the device is starting".**

# Programming

The door-entry phone can be programmed via **ViP Manager** software.

For programming details, please refer to the full programming manual, which is available at the following link: <https://pro.comelitgroup.com/manuals/23676>



CERTIFIED



MANAGEMENT



SYSTEMS



[www.comelitgroup.com](http://www.comelitgroup.com)

Via Don Arrigoni, 5 - 24020 Rovetta (BG) - Italy

1st edition 09/2024  
code 2G40003292