

90° Connectors with Insulated Throat

Zinc die-cast. For aluminum and steel Flex • AC • AC90 • MC • MCI-A cable.

CATALOG NUMBER	UPC/DCI/NAED MFG #018997	TRADE SIZE	KO SIZE	UNIT PKG	STD PKG	DIM A	DIM B	DIM C	CABLE RANGE
850A†	85010	3/8	1/2	50	500	1.432	.402	1.800	.440-.750
851A†	85110	1/2	1/2	25	250	1.842	.472	2.140	.635-1.085
852A	85210	3/4	3/4	15	150	2.096	.531	2.325	.830-1.380
853A	85310	1	1	10	50	2.622	.687	2.510	1.330-1.570
854A	85410	1-1/4	1-1/4	5	25	2.875	.687	3.080	1.625-1.940
855A	85510	1-1/2	1-1/2	1	10	4.968	.843	6.050	1.400-2.400
856A	85610	2	2	1	10	4.968	.843	6.050	1.400-2.400
857A	08571	2-1/2	2-1/2	1	1	6.218	.968	7.187	2.600-3.100
858A	08581	3	3	1	1	6.793	1.125	7.875	3.100-3.640
859A	08591	3-1/2	3-1/2	1	1	8.810	1.125	9.400	3.380-4.220
8510A	85101	4	4	1	1	8.793	1.125	10.200	3.730-4.550

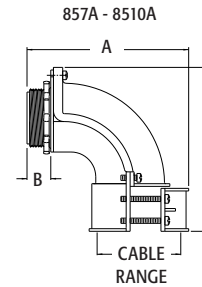
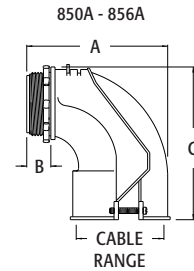

†Also for MCI-A cable. See page E-30 and E-31 for MCI-A cable ranges.
Refer to chart on page E-27 for list of cable types.
Concrete tight when taped.