

## SNAP<sup>2</sup>IT<sup>®</sup> Cable Connectors with Built-In Ground for Retrofit or New Work

FLEX • AC • MC

Zinc die-cast. For AC, MC, HCF, MC Continuous corrugated aluminum cable, MCI-A cables (steel and aluminum), AC90 ACG90 and FLEX.

### FEATURES AND BENEFITS

- Widest total cable ranges—accommodates cables from 14/2 to 10/3
- Widest variety of cables
- Super-secure installation—No pullout!
- Fully assembled one-piece design with insulated throat



38RASTG



40RASTG

CATALOG NUMBER	UPC/DCI/NAED MFG #018997	TRADE SIZE	KO SIZE	UNIT PKG	STD PKG	DIM A	DIM B	DIM C	DIM D	CABLE RANGE
38RASTG	13588	3/8	1/2	25	25	1.780	1.000	1.046	.500	.405 - .610
40RASTG	22091	3/8	1/2	25	25	1.780	1.000	1.046	.500	.480 - .610

Red-tinted inside.

CSA Listed with anti-short bushing ONLY.  
Refer to chart on page E-27 for list of cable types.  
See page E-30 and E-31 for MCI-A cable ranges.

**PATENTED.**



Quick and Easy Installation.  
**No Tools Required!**

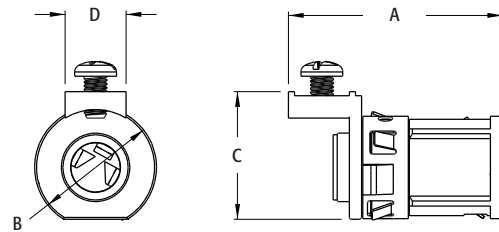

### INSTALLATION SHOTS

