

9" Post/Deck Mount Support for Outdoor Light Fixtures

GARD-N-POST™



Two-piece. Mounts most light fixtures and/or a GFCI wiring device on a 4x4 post or deck. UV rated plastic for long outdoor life. Four non-chipping colors.

FEATURES AND BENEFITS

- Molded-in color is permanent—unlike painted posts where lawn equipment chips the color off
- (2) 1/2" KOs for a UL Listed enclosure
- Metal grounding bushing assembly included

| CATALOG NUMBER | UPC/DCI/NAED MFG #018997 | DESCRIPTION | UNIT PKG | STD PKG | DIM A | DIM B | DIM C | DIM D |
|----------------|--------------------------|-------------|----------|---------|-------|-------|-------|-------|
| GPD9B | 76161 | Black | 1 | 6 | 3.375 | 3.375 | 9.000 | 1.750 |
| GPD9BR | 76162 | Bronze | 1 | 6 | 3.375 | 3.375 | 9.000 | 1.750 |
| GPD9G | 76164 | Green | 1 | 6 | 3.375 | 3.375 | 9.000 | 1.750 |
| GPD9W | 76163 | White | 1 | 6 | 3.375 | 3.375 | 9.000 | 1.750 |

Add suffix "GC" to Catalog # when ordering in Canada, for example GPD9BGC. CSA listed with grounding lug.

PATENTED.



Comes complete with...

Installed 3/4" x 1/2" NPT metal reducing bushing, locknut with copper ground wire for fixture installation, blank device plate, gasket & screws, plug for top hole (when fixture is not installed), removable KO plate, and mounting base.

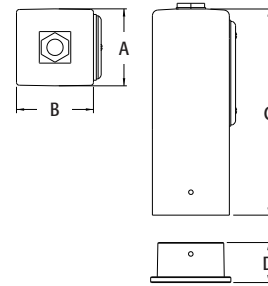

GPD9B shown with light fixture
Install on a 4x4 post... or a dock!