

# HJS Series, Cat6 & Cat6A Shielded Jack

## Mounting Instructions

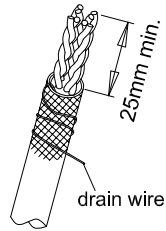

**Step 1:**  
Strip off at least 25mm of jacket from end of cable.

**NOTES:** IDC is suitable for 22~24 AWG wires.

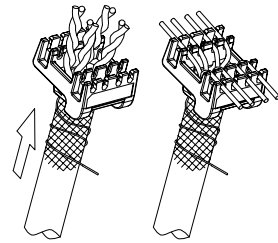

**Step 2:**  
Insert the wires into the cap through the holes. Lay the wires to the correct positions based on the color code. (T568A/T568B)

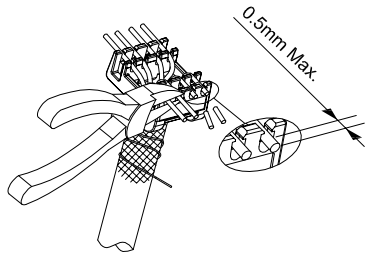

**Step 3:**  
Cut the excess wires off. The tips of the wires should protrude no more than 0.5mm.

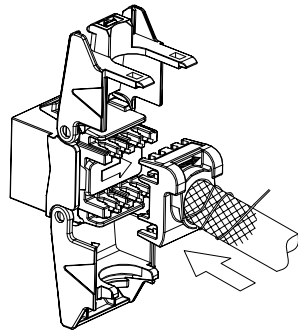

**Step 4:**  
Put the cap on the IDC tower. The arrows on the jack and the cap should face the same direction. Put the cap into position.

HWS77202401 3. 05. 2019 © Hubbell Premise Wiring • Printing errors and technical changes reserved

# HJS Series, Cat6 & Cat6A Shielded Jack

## Mounting Instructions

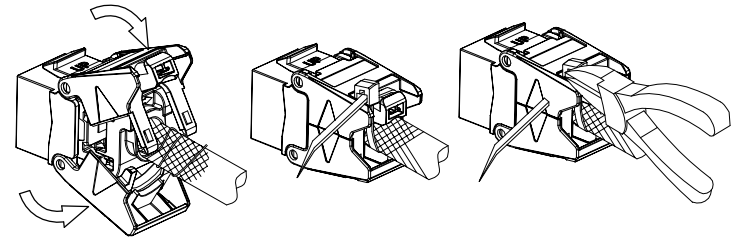

**Step 5:**  
Close the jaws until fixed.

**Step 6:**  
Fix the cable tie to the shielding lug.

**Step 7:**  
Cut the excess tie wrap off as close to the strain relief ring as possible. Ensure that the end of tie wrap is positioned upward.

### Disassembly Instruction:

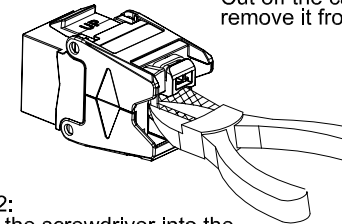

**Step 2:**  
Insert the screwdriver into the slot and rotate it to open the jaw.

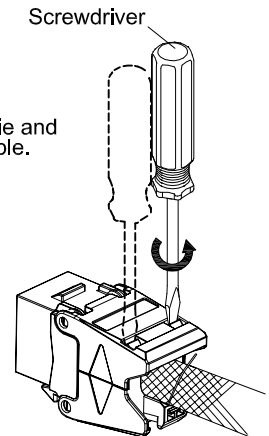

**Step 1:**  
Cut off the cable tie and remove it from cable.

HWS77202401 3. 05. 2019 © Hubbell Premise Wiring • Printing errors and technical changes reserved