

Match
your decor
seamlessly.



P&S Screwless Wall Plates bring wall-to-wall style.

P&S Screwless Wall Plates add a distinctive accent to any decor. Not only do they offer a wide variety of finishes; they hide the fasteners that attach them to the wall for a stylishly seamless look.

For Decorator, toggle, and duplex openings you have all the rich, handsome standard colors to choose from. And for Decorator opening plates you also have a full choice of decorative finishes like stainless steel to match appliances in the kitchen, rich woods like walnut and maple to go with furniture, floors, and cabinets. They're all here in three beautifully designed lines, all up to a four-gang. Installation is seamless, too. Simply loosen the mounting screws and click the subplate into place. This provides a tight, snug fit against the wall with no edge or channel to collect dust and dirt.

For a solution that fits perfectly with today's trends in home decorating, P&S Screwless Wall Plates are the answer.

Unbreakable, flexible polycarbonate construction — conforms to uneven drywall.

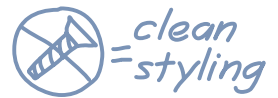

A full range of sleek, smooth looks that hide the screws and highlight the style.

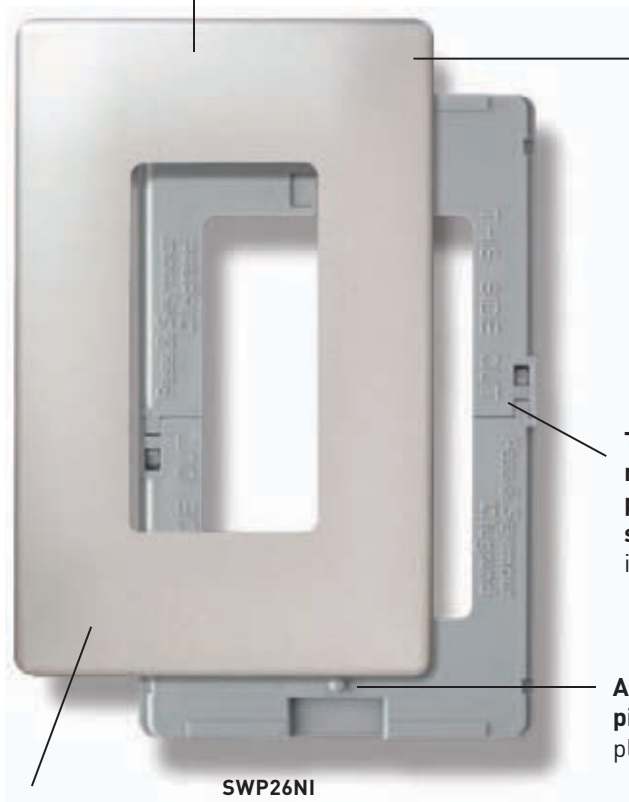

Two-piece, non-conductive polycarbonate subplate speeds installation.

Automatic alignment pins ensure wall plates fit perfectly.

SWP26NI

Smooth perimeter eliminates channel that can catch dirt.

Premium metallic and wood finishes available in Decorator style in One- to Four-Gang Openings.

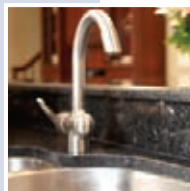

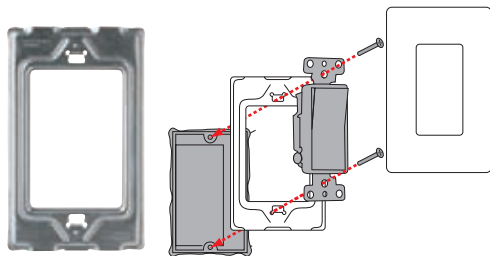

The P&S Decorator opening offers a metal subplate for commercial applications (SW26 series).

Three lines fit multiple openings and up to four-gang configurations.

Standard Colors

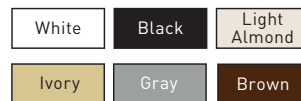

P&S Screwless Wall Plate installation is this simple!

Because the subplate secures with the wiring device mounting screws, no additional fasteners are necessary — and there's no need to remove devices. Simply loosen the device mounting screws and snap the two-piece sub-base in place behind the device straps. Then retighten the screws.

The wall plate simply snaps in place over the subplate, and automatically conforms to the surface of the wall. The plate can be easily released from the subplate with a screwdriver.



P&S Screwless Wall Plates

P&S Screwless Wall Plates	
Cat. No.	Description
Decorator Opening with Plastic Subplate	
SWP26**	One-Gang
SWP262**	Two-Gang
SWP263**	Three-Gang
SWP264**	Four-Gang
Decorator Opening with Metal Subplate	
SW26**	One-Gang
SW262**	Two-Gang
SW263**	Three-Gang
SW264**	Four-Gang
SW265*	Five-Gang
SW266*	Six-Gang
Toggle Opening with Plastic Subplate	
SWP1*	One-Gang
SWP2*	Two-Gang
SWP3*	Three-Gang
SWP4*	Four-Gang
Duplex Opening with Plastic Subplate	
SWP8*	One-Gang
SWP82*	Two-Gang

Premium metallic and wood finishes†



†Only available in One- to Four-Gang Decorator Openings

Standard Colors

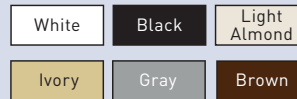

*Color Designation			
NI	Nickel	I	Ivory
BC	Brushed Copper	W	White
SS	Stainless Steel	-	Brown
BR	Brushed Brass	GRY	Gray
BB	Brushed Bronze	BK	Black
MA	Maple	LA	Light Almond
MH	Mahogany		
WA	Walnut		

designed to be better.™

For additional technical or application-specific information, call 800-223-4185 or visit our website at www.legrand.us/PassandSeymour. We're eager to put our expertise to work for you.

Distributed by:



Pass & Seymour

P.O. Box 4822
Syracuse, NY 13221-4822
800-776-4035
www.legrand.us/PassandSeymour

Legrand Canada
570 Applewood Crescent
Vaughan, ON, L4K 4B4
Phone: 905.738.9195
www.legrand.ca