

## Versatile Box for Power or Low Voltage

Mount security cameras, fixtures, detectors, and more inside or out.

### FEATURES AND BENEFITS

- Non-metallic, UV rated for long outdoor life
- OPTION For cameras with base diameter smaller than 4.5" use Arlington's SC5 CAM-KIT™ camera mounting kit on top of the box.
- Mounts security cameras, electrical accessories and fixtures indoors or outdoors
- Screw pattern matches standard 4" fixture box
- Box includes 3/4" to 1/2" reducing bushing



8161BR



8161CB



8161BP



8161BPBL



8161TR

Scan For Video



CATALOG NUMBER	UPC/DCI/NAED MFG #018997	DESCRIPTION	WEIGHT RATING	UNIT PKG	STD PKG	DIM A	DIM B	DIM C
8161BR	08881	Box w/ built-in bracket	50 lb/wall	1	10	7.148	6.031	-
8161BP	08880	Box w/ built-in base plate	50 lb/down rod	1	10	7.046	.844	3.500
8161BPBL	12785	Box w/ built-in base plate (black)	50 lb/down rod	1	10	7.046	.844	3.500
8161CB	01530	Box w/ corner-mount bracket	50 lb/corner	1	10	10.851	6.450	-
8161TR	00878	Box w/ threaded openings	50 lb/ceiling; 10 lb/wall	1	10	6.720	1.343	-

\*Add suffix "GC" to Catalog # when ordering in Canada to include grounding clip, for example 8161BRGC.  
**PATENTED.**

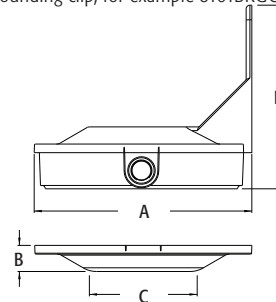

### INSTALLATION SHOTS



8161BP



8161BR



8161CB



8161BPBL