

# Installation Guide

## Shielded KeyConnect Patch Panel



Mounting on 19" racks

Doc # PX105408 Release A

1 of 2 pages

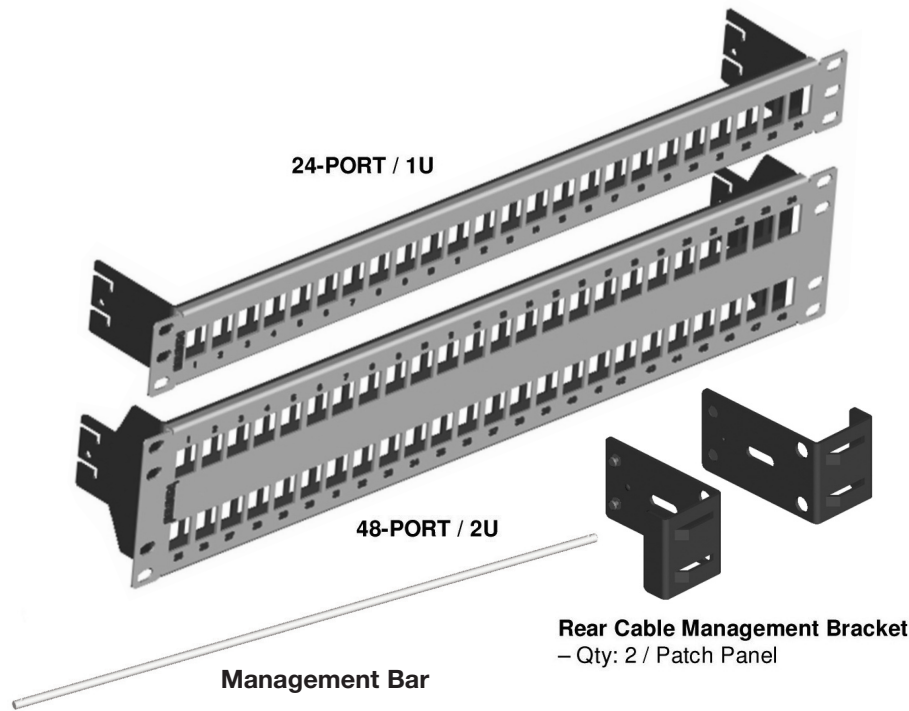

### Reference Documents

#### Belden Tools

- AX101852 - Termination Station
- AX100749 - GigaFlex connecting tool

#### Standard Tools

- Phillips screwdriver.
- Cable stripper
- Key 5/16"



Label Holder

#### Velcro® Ties

- Qty: 2 / Patch Panel
- Qty: 4 / Patch Panel for 72P/2U

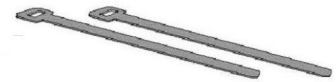

#### Machine Screws:

- 10 x 32 Qty: 4
- 12 x 24 Qty: 4



#### Ground Wire Kit



- Nut 6-32 Qty: 2
- Tooth Washer #6 Qty: 2

- Screw 10-32
- Tooth Washer #10

Part #	Description	
AX104563	Shielded KeyConnect PP 24 PORT / 1U, Titanium	EMPTY
AX104564	Shielded KeyConnect PP 48 PORT / 2U, Titanium	visit <a href="http://www.belden.com">www.belden.com</a> for Keystone Style Modular Jack selection

**1.** Using the appropriate screws, attach the Patch Panel into the rack.

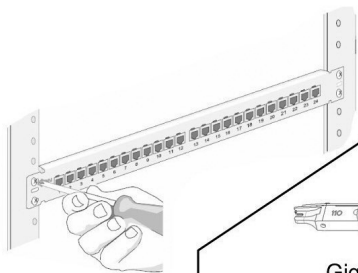

**2. (not applicable for Coupler and toolless connectors)**

Jack could be terminated directly in the Patch Panel or in the Termination Station with the GigaFlex Connecting Tool (components supplied separately).

-Refer to Jack Installation Guide.

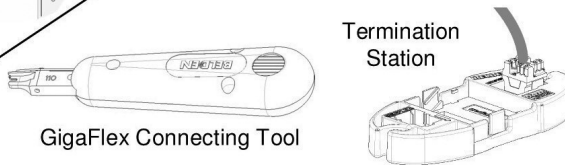

### Assembly

Good ✓

Bad

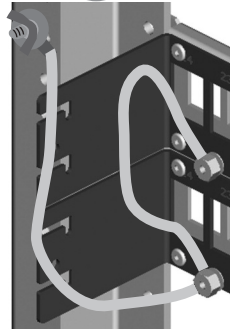
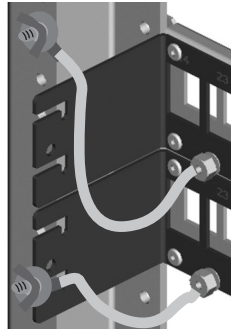
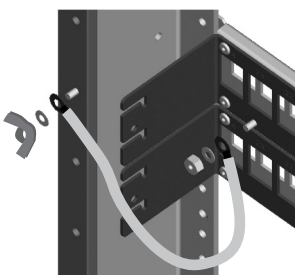

**3.** To insert a Jack in a Patch Panel engage the bottom of the jack in the opening and pivot the top latch as shown.

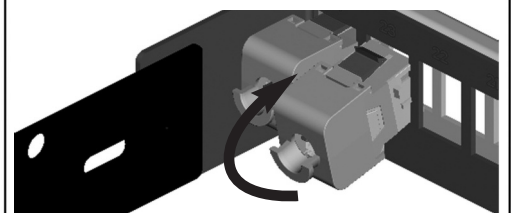

**4.** Rear Cable Management Bracket installation.

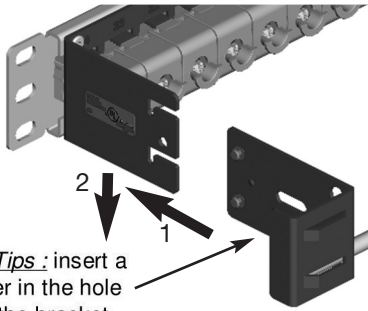

*Installer's Tips* : insert a screw driver in the hole to remove the bracket

**5.** Continue assembling cables in this sequence method with the Cable Management Bracket initially installed to get the appropriate length for each cables . The bracket could be removed after to ease the installation.

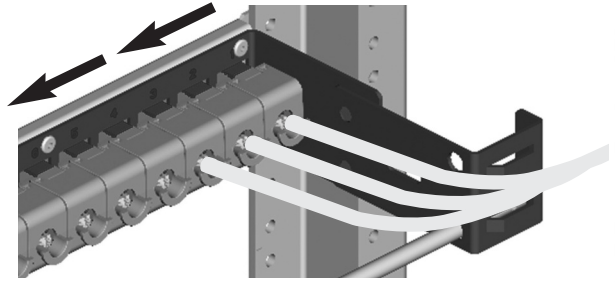

Note: Patch Panel AX103253 shown

**6.** Secure cables over the brackets with Velcro® Ties provided in the kit.

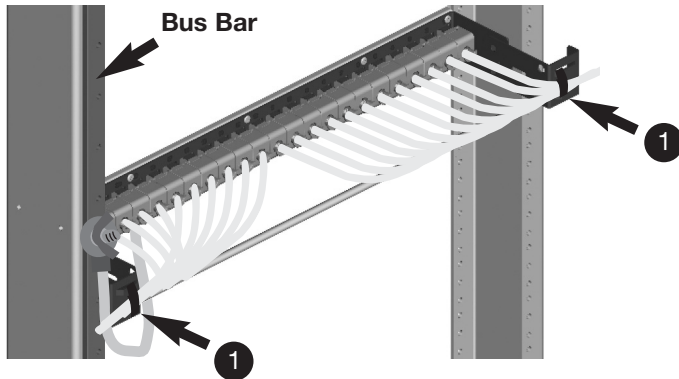

**BI-DIRECTIONAL CABLE ROUTING**

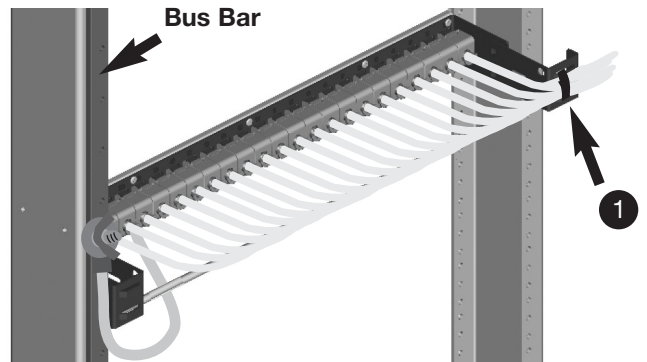

**UNI-DIRECTIONAL CABLE ROUTING**

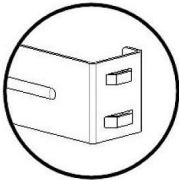

Attach the Velcro® Ties **1** on the bridge of the rear bracket.

**7.** Affix the label holder centered on the patch panel on top of the jacks

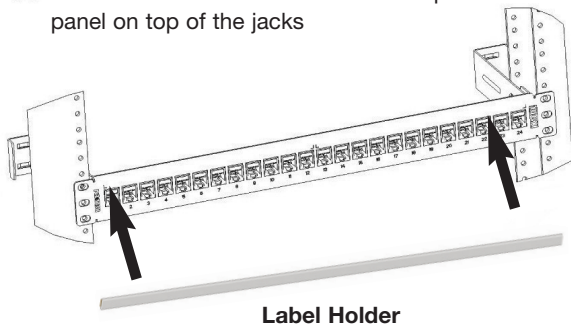

**Label Holder**

Pull the label outside the holder to print the port information. Insert the label back into the holder

