

REVISIONS				
ZONE	REV	DESCRIPTION	DATE	DRAWN
	A	CAT 6A UNSCREENED FIELD-INSTALLABLE MODULAR PLUG	04/22'15	NICK

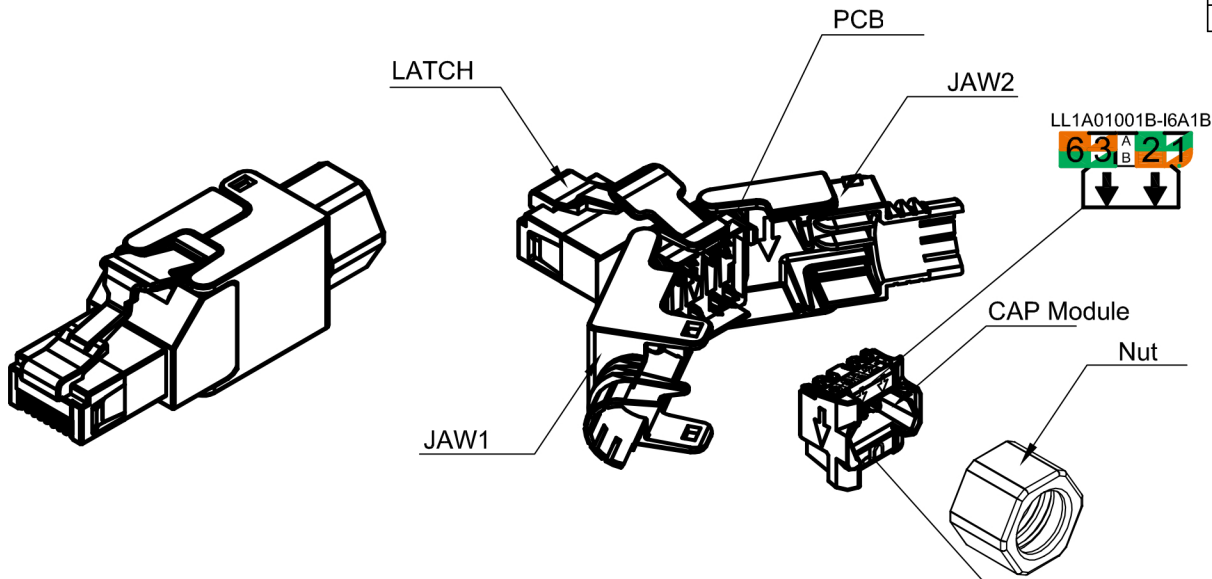

COMPONENTS			
ITEM	PART NAME	MATERIAL	Q'TY
1	PCB Module	_____	1
2	LATCH	PC 94V-0	1
3	JAW-1	Nylon+30%GF	1
4	JAW-2	Nylon+30%GF	1
5	CAP	PC 94V-0	1
6	Nut	Copper	1
7	Wiring Lable-UP	Lable	1
8	Wiring Lable-DOWN	Lable	1

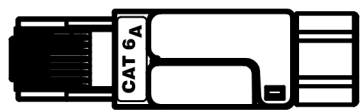
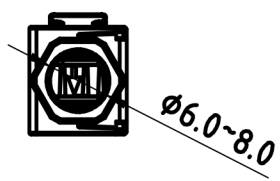
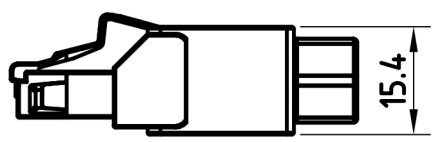
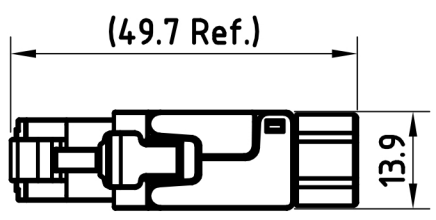

**TRANSMISSION PERFORMANCE**  
 Meet all requirements specified in Patch Cord requirement of ISO/IEC 11801, Category 6<sub>A</sub> ANSI/TIA-568-C.2, Category 6A

**ELECTRICAL**  
 Electrical Insulation Resistance : 500MΩ min. @100V d.c  
 Dielectric Withstanding Voltage : 1000V D.C or A.C Peak, Contact to Contact; 1500V D.C or A.C Peak, Contact to Shield @ 60Hz for 1 Minute.

**MECHANICAL**  
 IDC Wire Gauge : 23 ~ 26 AWG

**PHYSICAL**  
 Housing : High-Impact, Flame-Retardant Plastic, UL 94V-0  
 Contact pin : Phosphor Bronze Alloy Plated With 50 micro-inch of Gold  
 IDC : Phosphor Bronze Alloy With 100 micro-inch 100% Sn Alloy

UNLESS OTHERWISE SPECIFIED: TOLERANCES		PROJECT ID 1001-I6A1B-223			
INCH X ± .018 XX ± .008 XXX ± .004	MM X ± 0.2 XX ± 0.1 X ± .5	ANGULAR X ± 1° X ± .5°	FILE KRJ45FT-C6AC		
MATERIAL		DRAWN NICK		SIZE A4	DRAWING NUMBER KRJ45FT-C6AC
SURFACE		CHECK		PART NUMBER	REV A
FINISH		APPROVED		SCALE 1:1	UNIT mm
				SHEET 1 OF 1	