



Middle Atlantic Products

middleatlantic.com

ViewPoint™ Monitoring Console System



Flexible, scalable system has been designed for optimum operator effectiveness.

Features

- Fully welded bays provide a heavy-duty structure that can be assembled quickly
- Available with an 18" deep work surface or 34" desktop
- A large variety of standard finishes available
- Most configurations ship in 3 weeks or less
- Custom finishes and work surfaces available upon request
- UL Listed in the US and Canada
- GREENGUARD IAQ certified
- LCD monitors can be mounted using optional monitor arms



Architects' and Engineers' Specifications

ViewPoint™ Series monitoring console system shall be Middle Atlantic Products model # VC-_____. Overall dimensions of the console bays shall be ___"W x 30"H x 19"D. Console system shall feature welded steel bays of Uni-Frame™ construction and extensible design that provides optimal structural integrity, and unrestricted cable management and access. Console system shall have exterior support foot placement that provides support and unimpeded chair/operator movement. Work surface/ Desktop shall have cantilevered supports that provide unimpeded leg movement. Each 24" width bay shall accept rackrail or a slide-out CPU tray. Each 24" bay shall have a 250 lb. weight capacity. Shall include 2 horizontal, segregated raceways in each bay and wedge, configurable for upper or lower bay installation. Shall include a minimum of one 15 amp duplex per 24" bay (work surface only). Work surfaces shall have a 3 position height selection. ViewPoint shall be available with an 18" deep work surface or 34" deep desktop, available in a Wenge, Dark Cherry, Dark Pecan, Aged Cherry, Honey Maple, Light Walnut, Maple, Shark Gray, Pepperstone, Graystone or Darkstone RTF thermolaminate finish and constructed of 1-1/8" thick triple-refined MDF. Connecting wedges shall be available with 15°, 22°, 30°, 45° and 90° (forward) and 15°, 22°, and 30° (reverse) angles. Extender bays shall be available to provide a total of 33" or 39" of

useable depth. Bays shall be constructed of 11 and 14 gauge steel and finished in a fingerprint resistant black textured powdercoat. ViewPoint shall have 3" and 4" cable pass-throughs trimmed with plastic bushings to create a smooth internal surface. ViewPoint shall include all tools needed for the assembly of the console. Grounding and bonding stud shall be 1/4-20 threaded, installed in base of the bay, 2 per bay. ViewPoint shall satisfy the 1997 UBC and 2001 CBC Seismic Zone 4 and the 2007 CBC, 2000, 2003 & 2006 IBC, 2002 & 2005 ASCE Standard 7 and 2003 & 2005 Ed. NFPA 5000 Seismic Use Group III lateral force requirements for protecting 200 lbs. per 24" section of essential equipment in high importance, upper floor installations with an Ip value of 1.5. ViewPoint system shall meet ANSI-BIFMA, BSR/HFES 100, and VESA guidelines and requirements. ViewPoint shall be UL Listed in the US and Canada. ViewPoint shall be GREENGUARD Indoor Air Quality Certified. ViewPoint enclosure shall be RoHS EU Directive 2002 / 95 / EC compliant. Steel components shall be warranted to be free from defects in material or workmanship under normal use and conditions for the lifetime of the product. Thermolaminate components shall be warranted to be free from defects in material or workmanship under normal use and conditions for a period of 7 years. ViewPoint shall be manufactured in an ISO 9001 facility.

customizable specification clips available at middleatlantic.com

Exceptional Support & Protection Products™

US: New Jersey ▪ California ▪ Illinois ▪ Voice: 973-839-1011 Fax: 973-839-1976 ▪ middleatlantic.com
Canada: Ontario ▪ British Columbia ▪ Voice: 613-836-2501 Fax: 613-836-2690 ▪ middleatlantic.ca

OPTIONS

Monitor Mounts – shall be available to accommodate 1, 2, 3, 4 or 6 monitors. Shall mount to the rear top of 12", 24", 36", 48" or 72" console bays. Shall tilt and pivot. Shall be hinged, articulating or counter-balanced. Shall be constructed of cast aluminum with steel fittings. Shall be VESA compliant. Shall have a weight capacity of, by model:

Part #	Weight capacity per monitor	Total weight capacity
VC-MM1X1	28 lbs.	28 lbs.
VC-MM2X1	25 lbs.	50 lbs.
VC-MM1X2	25 lbs.	50 lbs.
VC-MM1X2PL	21 lbs.	42 lbs.
VC-MM2X2	22 lbs.	88 lbs.
VC-MM3X1	25 lbs.	75 lbs.
VC-MM3X2	25 lbs.	150 lbs.

Rackrail – 10 space rackrail shall be available for horizontal equipment mounting in the front/rear of any 24" section of a 24", 36", 48" or 72" bay and shall be part # VC-B24-RR10. 6 Space rackrail for vertical equipment mounting in the top of any 24" section of a 24", 36", 48" or 72" bay, for use with work surface only, and shall be part # VC-TRK. Rackrail shall conform to EIA standards. Rackrail shall be constructed of 11-gauge steel. Shall be infinitely adjustable front-to-rear.

CPU Tray – Slide-out CPU tray shall mount in any 24" section of a 24", 36", 48" or 72" bay, and shall configure to slide out of the front or rear. Slide-out CPU tray shall have useable dimensions of 19"W x 14.25"D, extend 13" and have a weight capacity of 75 lbs. Slide out CPU tray shall be part # VC-2419ST.

Extender Bay - Extender Bay shall mount to the front of any 24" section of a 24", 36", 48" or 72" bay. Extender bay shall have 12 space front rackrail and 10 space rear rackrail. Extender bays shall be available in the following depths and configurations:

Part #	Door type	Useable Depth	Total Useable Depth
VC-2418X-PD	Plexiglass	18"	33"
VC-2418X-VD	Vented	18"	33"
VC-2424X-PD	Plexiglass	24"	39"
VC-2424X-VD	Vented	24"	39"

Rear fan door – Rear fan door shall replace standard rear console door on any 24" wide bay. Rear fan door shall provide 100 CFM of air extraction, generate less than 27 db, and be thermostatically switched. Part# shall be VC-B24-FD.

Storage Cabinet – Storage cabinet shall be constructed of constructed of 1" thick high pressure laminate on particle core. Dimensions shall be 23-1/2"W X 36"D. Storage cabinet shall have positionable glass doors and rear covers. Storage cabinet shall mounts to the front of any 24" section of a 24", 36", 48" or 72" bay and have a matching surface. Storage cabinet part # shall be VC-3624-GD.

Peninsula – Peninsula shall be constructed of 1-1/8" thick triple-refined MDF. With an Impact resistant to RTF thermolamine finish. Peninsula dimensions shall be 24"W x 36"D. Peninsula shall mount to the front of any 24" section of a 24", 36", 48" or 72" bay. Peninsula shall be part # VC-PEN-3624.

Side Panels – Side panels shall be available in 3 styles, and be constructed of 1" thick triple-refined MDF. Side panels shall consist of a left and right side and mount to any 12", 24", 36", 48" or 72" bay.

File Cabinet – File cabinet shall have 3 drawers and be constructed of 16 and 18 gauge steel. File cabinet dimensions shall be 18"D x 27" H. File cabinet shall fit underneath a peninsula, and have swivel casters for ease of movement. File cabinet shall be part # VC-FC-3.

Articulating Task Light – Articulating task light shall mount to the top rear of the console and be part # VC-LCM.

Articulating Keyboard Shelf – Articulating keyboard shelf shall mount underneath the work surface/desktop. Shelf shall slide underneath the work surface/desktop when not in use. Shelf shall be adjustable in height and have a useable area of 31" W x 10-1/2"D. Shelf shall be part # VC-KBS.

Top Mount Turret Racks – To mount turret racks shall be available with 4 or 9 rackspace, have a minimum 8-1/2" useable depth, and work with consoles with an 18" deep work surface only. Top mount turret racks shall mount to any 24" section of a 24", 36", 48" or 72" bay.

Part#	# of rackspace	Mounts to
VC-TR2419-4	4	24", 48", 72" bay
VC-TR3619-4	4	36" bay
VC-TR2419-9	9	24", 48", 72" bay
VC-TR3619-9	9	36" bay

Chair – Fully adjustable, ergonomically designed professional use monitoring chair shall have a 15 year warranty, and shall be part # CHAIR-CF1-B.

ViewPoint™ 18" Work Surface

All dimensions in inches unless otherwise noted [All dimensions in brackets are in millimeters]

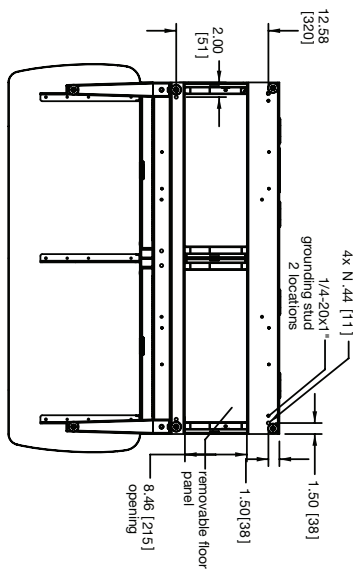
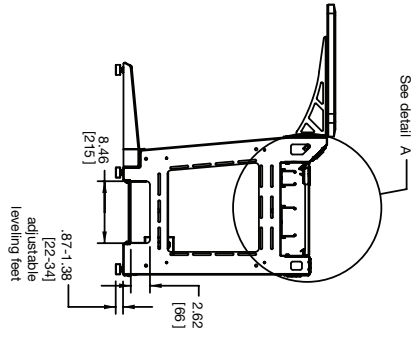
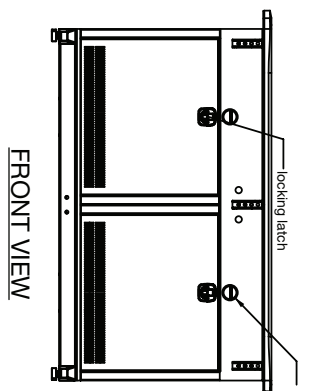
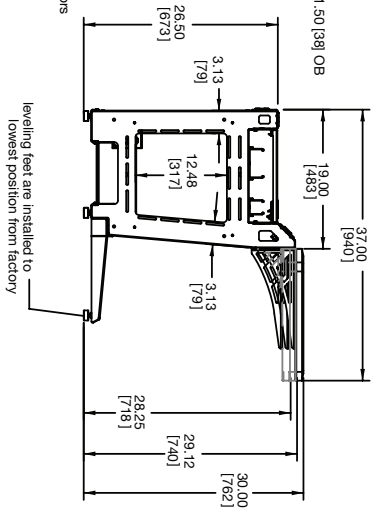
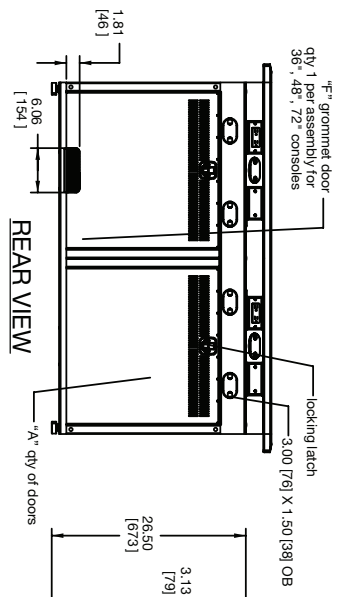
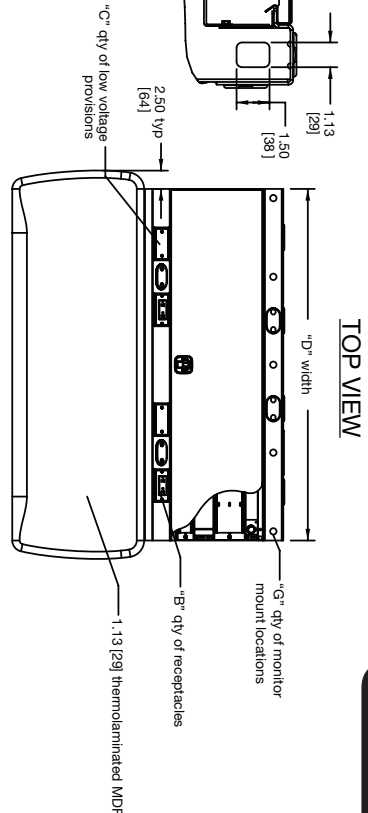
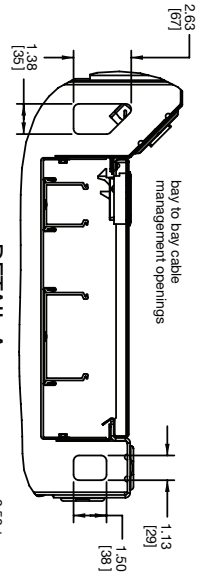
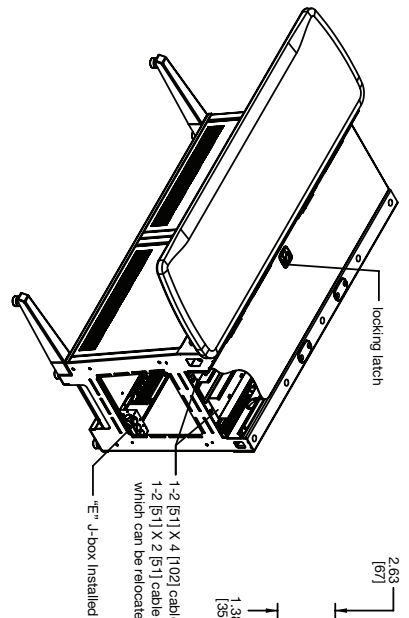

Part #	"A" Quantity of Doors	"B" Quantity of Receptacles	"C" Quantity of Low Voltage Provisions	"D" Width	"E" Grommet Doors	"F" J-Box	"G" Quantity Monitor Mount Locations
VC-619-WS18	N/A	N/A	N/A	6.00 [152]	NO	NO	N/A
VC-1219-WS18	2	N/A	N/A	12.00 [305]	NO	NO	1
VC-2419-WS18	2	1	1	24.00 [610]	NO	NO	3
VC-3619-WS18	4	2	2	36.00 [914]	YES	YES	5
VC-4819-WS18	4	2	2	48.00 [1219]	YES	YES	5
VC-7219-WS18	6	3	3	72.00 [1829]	YES	YES	7



ViewPoint™ 34" Work Surface

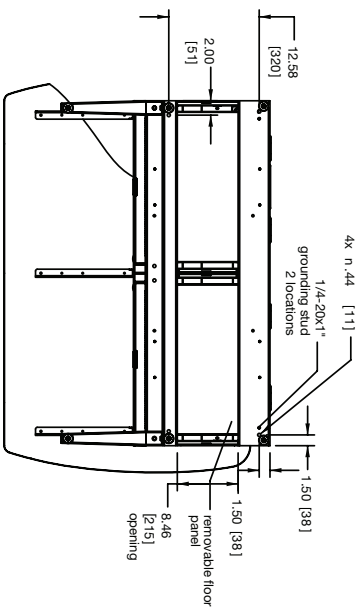
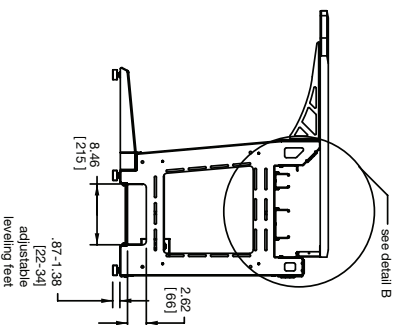
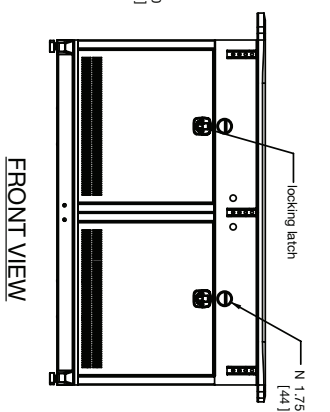
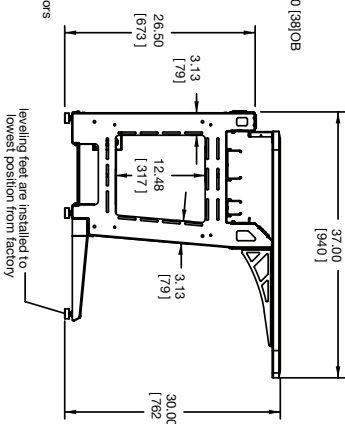
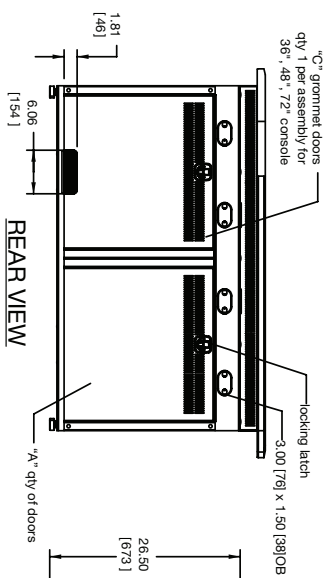
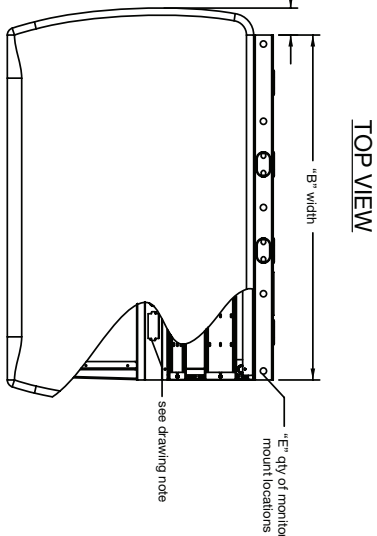
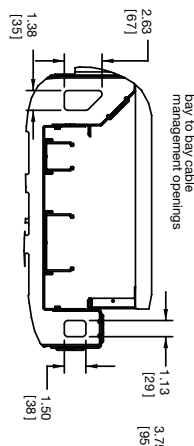
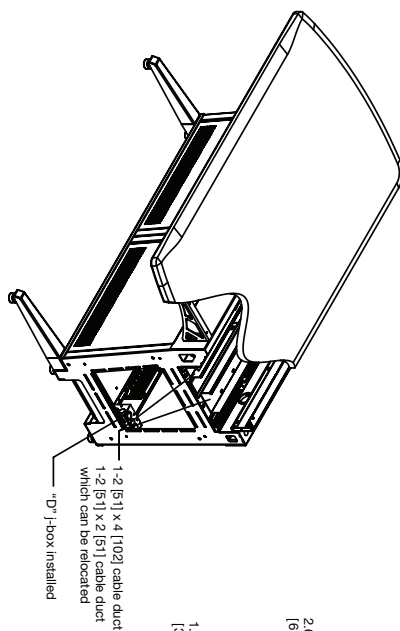

Part#	"A" Quantity of Doors	"B" Width	"C" Grommet Doors	"D" Grommet Doors	"E" Quantity Monitor Mount Locations
VC-619-D134	N/A	6.00 [152]	NO	NO	N/A
VC-1219-D134	2	12.00 [305]	NO	NO	1
VC-2419-D134	2	24.00 [610]	NO	NO	3
VC-3619-D134	4	36.00 [914]	YES	YES	5
VC-4819-D134	4	48.00 [1219]	YES	YES	5
VC-7219-D134	6	72.00 [1829]	YES	YES	7

All dimensions in inches unless otherwise noted [All dimensions in brackets are in millimeters]

