

eFlow104NV Series

Power Supply/Chargers



Altronix eFlow104NV series power supply/chargers convert a 220VAC (working range 198VAC - 256VAC), 50/60Hz input into a single fused, eight (8) or sixteen (16) fuse/PTC protected 24VDC outputs with a total of 10A max. They also offer a suite of features that includes fire alarm disconnect, overvoltage protection, and low power disconnect which prevents deep discharge of stand-by batteries.



eFlow104N8V

Key Features

- Available with 1, 8 or 16 outputs
- Fused or PTC protected outputs
- Additional Aux. Output rated @ 1A
- Overvoltage protection
- Fire alarm disconnect
- Supervision
 - AC Fail
 - Battery Fail and Battery Presence
 - Low power shutdown
- Built-in charger for sealed lead acid or gel type batteries
- Instantaneous transfer to stand-by batteries
- Short circuit and overload protection
- AC input and DC output LED indicators
- CE European Conformity
- Lifetime Warranty

eFlow104NV series Power Supply Configuration Reference Chart

Altronix Model Number	Input Rating: 220VAC, 50/60Hz	Input Fuse Rating	Battery Fuse Rating	Nominal DC Outputs		Maximum Supply Current for Main and Aux. Outputs (A)	Ripple Voltage (mV) Under low battery condition	Power Distribution Module	Number of Outputs	Fused Output Ratings	Auto-Resettable PTC Output Ratings	Accommodates up to 7AH Batteries	Accommodates up to 12AH Batteries
				[DC] 24VDC Output Range (V)	[AUX] 24VDC Output Range (V)								
eFlow104NV	2.7A	6.3A/250V	15A/32V	20.17-26.4	20.28-26.4	10A	700	N/A	1	-	-	✓	-
eFlow104NXV										-	-	-	✓
eFlow104N8V	2.7A	6.3A/250V	15A/32V	20.17-26.4	20.28-26.4	10A	700	PD8	8	2.5A	-	✓	-
eFlow104NX8V										2.5A	-	-	✓
eFlow104N8DV	2.7A	6.3A/250V	15A/32V	20.0-26.4	20.28-26.4	10A	700	PD8CB	8	-	2A	✓	-
eFlow104NX8DV										-	2A	-	✓
eFlow104N16V	2.7A	6.3A/250V	15A/32V	20.17-26.4	20.28-26.4	10A	700	PD16W	16	2.5A	-	✓	-
eFlow104NX16V								2 - PD8		2.5A	-	-	✓
eFlow104N16DV	2.7A	6.3A/250V	15A/32V	20.0-26.4	20.28-26.4	10A	700	PD16WCB	16	-	2A	✓	-
eFlow104NX16DV								2 - PD8CB		-	2A	-	✓

Lifetime Warranty

Specifications

Input

Voltage 220VAC (working range 198VAC - 256VAC),
50/60Hz, 2.7A max.
Fusing 6.3A/250V

Outputs

Voltage 24VDC
Current 10A continuous max.
Protection Fused 2.5A / PTC 2A
Auxiliary Power-limited @ 1A (unswitched)
Other Overvoltage protection. Filtered and regulated

Battery Charging

Capacity 7AH/12VDC (2 within enclosure)
12AH/12VDC (requires larger "X" enclosure)
40AH/65AH (requires separate enclosure)
Type Sealed lead acid or gel type
Fuse Rating 15A/32V
Failover Upon AC loss, instantaneous
Batteries are sold separately

Fire Alarm Disconnect

Supervised Latching or non-latching
EOL 10K Resistor

Supervision

AC Failure Form "C" contacts
Battery Form "C" contacts

Low DC Power Shutdown

Shuts down DC output terminals if battery voltage drops
below 70-75% for 24V units (depending on the power supply)
Prevents deep battery discharge

Indicators (LED)

Input 220VAC is present
DC Output Powered

Agency Listings

CE European Conformity

Physical and Environmental

Dimensions (H x W x D)

eFlow104NV, eFlow104N8(D)V, eFlow104N16(D)V:

Enclosure: 13.5" x 13" x 3.25" (342.9mm x 330.2mm x 82.55mm)
Shipping: 15" x 13.875" x 4.75" (381mm x 352.4mm x 120.6mm)

eFlow104NXV, eFlow104NX8(D)V, eFlow104NX16(D)V:

Enclosure: 15.5" x 12" x 4.5" (393.7mm x 304.8mm x 114.3mm)
Shipping: 16.5" x 13.5" x 6" (419.1mm x 342.9mm x 152.5mm)

Weight (approx.)

Model	Product Weight	Shipping Weight
eFlow104NV	6.8 lb. (3.08 kg)	7.7 lb. (3.49 kg)
eFlow104NXV	8.65 lb. (3.92 kg)	9.75 lb. (4.42 kg)
eFlow104N8(D)V	6.95 lb. (3.15 kg)	7.85 lb. (3.56 kg)
eFlow104NX8(D)V	8.8 lb. (3.99 kg)	9.9 lb. (4.49 kg)
eFlow104N16(D)V	7.1 lb. (3.22 kg)	8 lb. (3.63 kg)
eFlow104NX16(D)V	8.95 lb. (4.06 kg)	10.05 lb. (4.56 kg)

Temperature

Operating: 0°C to 49°C (32°F to 120°F)
Storage: -20°C to 70°C (-4°F to 158°F)

Relative Humidity

85% +/- 5%

BTU/Hr (approx.)

123 BTU/Hr.

Accessories (order separately)

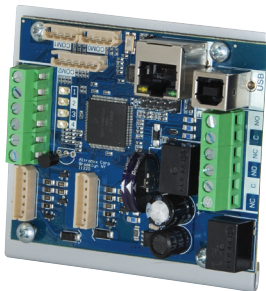

LINQ2

LINQ2 - Network Supervision

Altronix LINQ2 Network Communication Module provides remote supervision, control and monitoring over LAN/WAN

- Remotely reports accurate power diagnostics
- Controls power and resets devices
- Reports system diagnostics via Email



Lifetime Warranty

Dimensions and Drawing

eFlow104NV, eFlow104N8(D)V, eFlow104N16(D)V Dimensions (H x W x D approximate)

13.5" x 13" x 3.25" (342.9mm x 330.2mm x 82.55mm)

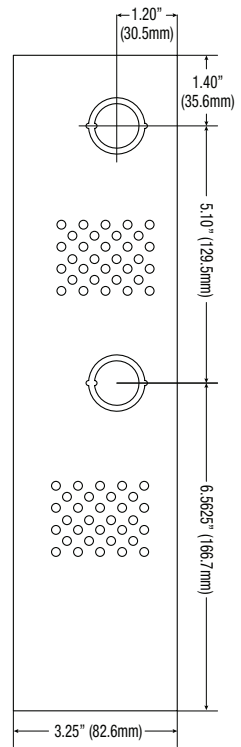
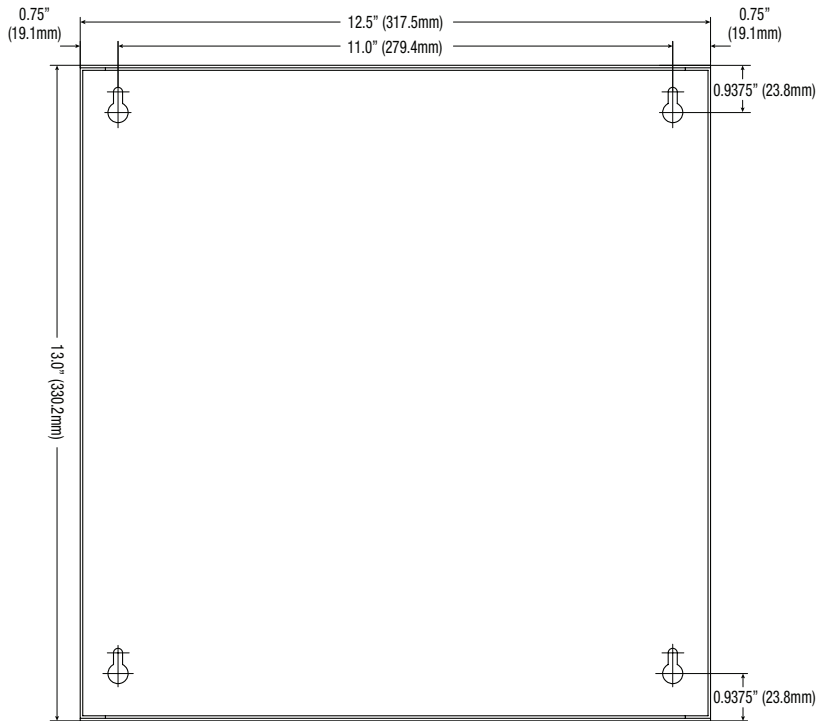
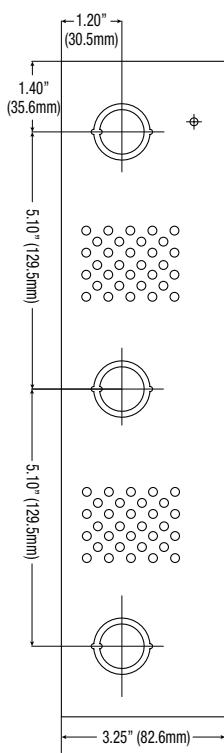
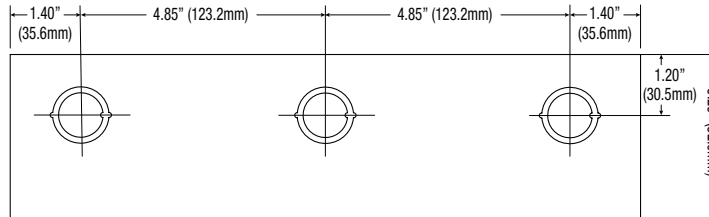

Lifetime Warranty

Altronix Corporation | 140 58th St | Brooklyn, NY 11220 USA

phone: +1 718.567.8181 | fax: +1 718.567.9056 | email: info@altronix.com | www.altronix.com

Dimensions and Drawing

eFlow104NXV, eFlow104NX8(D)V, eFlow104NX16(D)V Dimensions (H x W x D approximate)
 15.5" x 12" x 4.5" (393.7mm x 304.8mm x 114.3mm)

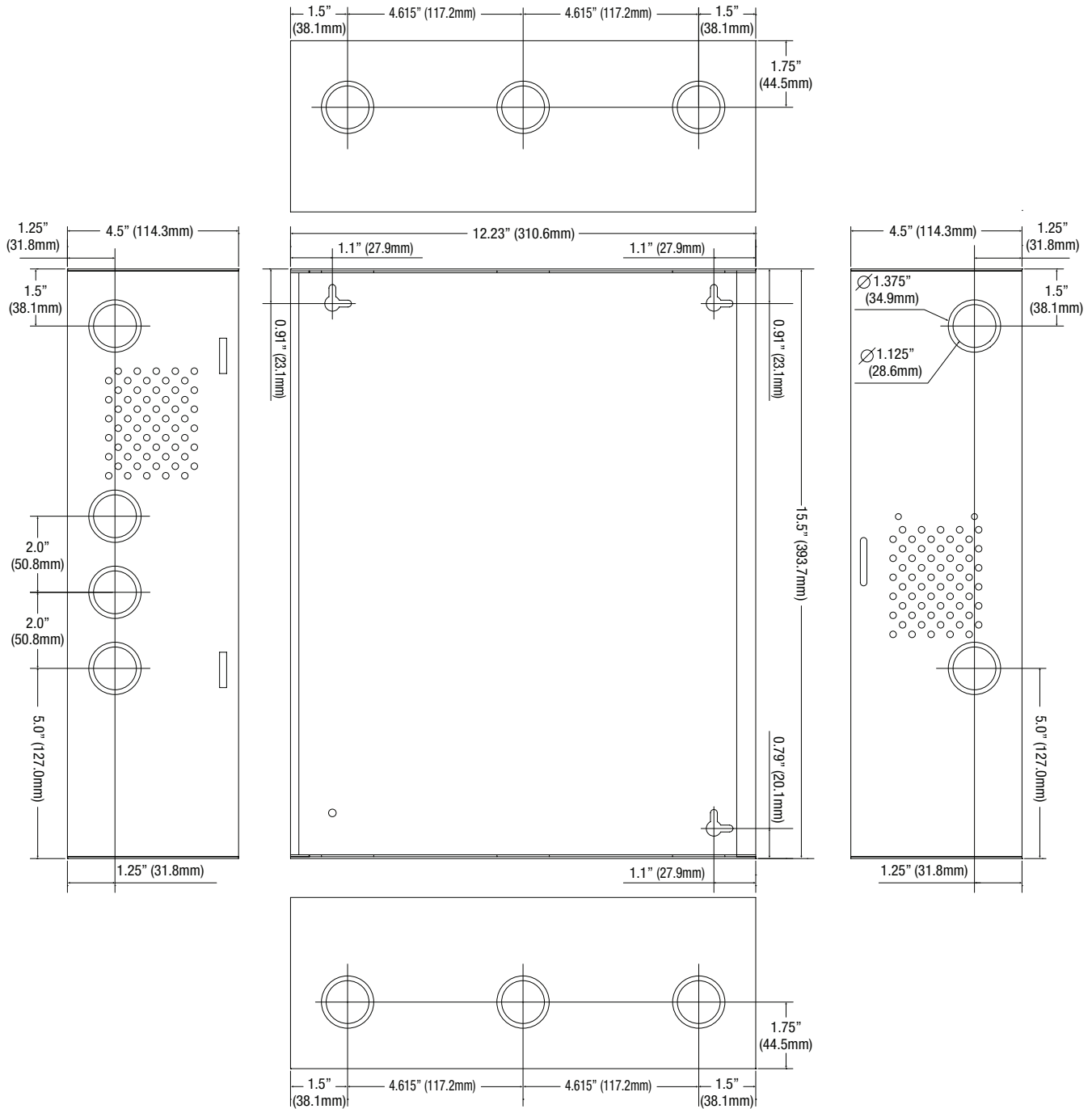

Lifetime Warranty