

# SNAP<sup>2</sup>IT<sup>®</sup> MC Cable Connectors

**NEW!**

**NEW!**  
more on reverse

3/4" KO • Easy Snap-in Cable Insertion • NO TOOLS!



**407AST**  
Snap on to cable,  
Snap in to box

**Easy installation into box!**  
**Snap in or Locknut...**

**387AST, 407AST**  
SNAP assembly into box



**387A** with locknut removed threaded onto 'LB' conduit body

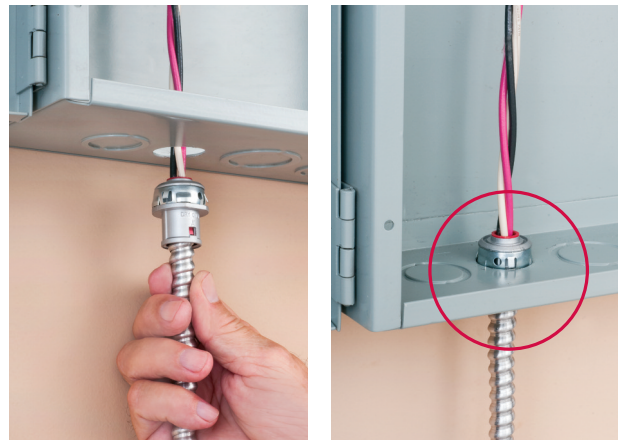

**387A, 407A** Installation of assembly with LOCKNUT

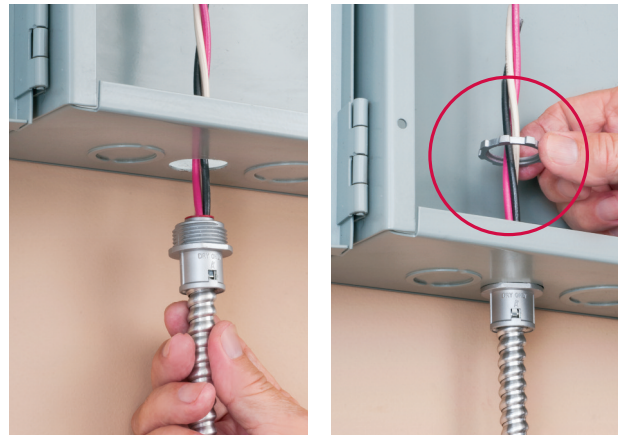

Patented

Arlington's new one-piece **SNAP<sup>2</sup>IT<sup>®</sup>** fittings for 3/4" knockouts make fitting-on-cable installations easier than ever.

**NO TOOLS!** Save time with easy snap-in installation. Snap the fitting onto the cable and twist clockwise.

To SNAP the assembly into the box, use a 387AST or 407AST fitting.



If you prefer a LOCKNUT for installing the assembly into the box, use the 387A or 407A.

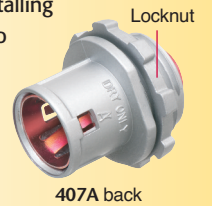

The red tinting in the 407A and 407AST indicates our 'OPEN TANG' design, meaning there's more room inside the fitting for easy insertion of wires.

- **Widest total cable ranges**  
14/2 to 10/3
- **Widest variety of cables**  
For AC, MC, HCF, MC continuous corrugated aluminum cable, MCI-A cables (steel and aluminum), AC90 and ACG90
- **Secure installation** No pullout
- **Easy, screwdriver removal** from box  
Connector is reusable
- **Fully assembled – Ready to use**  
Insulated throat included

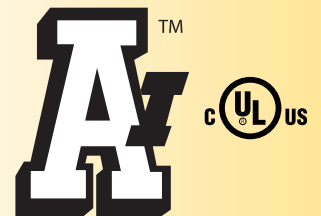

**Arlington<sup>®</sup>**

1 Stauffer Industrial Park  
Scranton, PA 18517  
**800/233.4717 • Fax 570/562.0646**  
[www.aifittings.com](http://www.aifittings.com)

# SNAP2IT® MC Cable Connectors

## SNAP Assembly into Box or Install with Locknut

CATALOG NUMBER	UPC/DCI/NAED MFG. #018997	DESCRIPTION SNAP IN FITTINGS	CABLE TRADE SIZE	KO SIZE	CABLE (OD) OUTSIDE DIA.	UNIT PKG	STD PKG
<b>SNAP2IT® snaps onto cable • LOCKNUT ATTACHMENT</b>							
387A	11430	SILVER TINT inside	3/8"	3/4"	.405 to .605	50	500
407A	11432	RED TINT Open Tang Design	3/8"	3/4"	.480 to .605	50	500



### PRODUCT COMPARISON



387A, 387AST  
SILVER TINT inside

### RED TINT inside means OPEN TANG Design

...meaning there's more room inside for easy insertion of wires. And it's easier than ever to snap the fitting into the box.

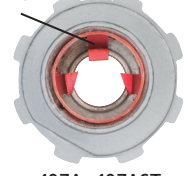

407A, 407AST

<b>SNAP2IT® at both ends of fitting • SNAP ONTO CABLE, SNAP INTO BOX</b>							
387AST	11431	SILVER TINT inside	3/8"	3/4"	.405 to .605	50	500
407AST	11433	RED TINT Open Tang Design	3/8"	3/4"	.480 to .605	50	500



### CABLE SIZES

#### 387A, 387AST

14/2 and 12/2 w/ and w/o ground,  
14/3, 14/4, 12/3, 12/4, 10/2, 10/3

#### 407A, 407AST

14/3, 12/2 and 12/3 w/ and w/o ground,  
14/4, 12/4, 10/2, 10/3



407A with locknut removed threaded into a pull elbow



387A with locknut removed threaded into a 'T' conduit body

### EASY SCREWDRIVER REMOVAL

Using a screwdriver lift the ring and twist off. It's easy! And the fitting is reusable.

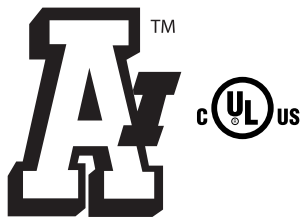
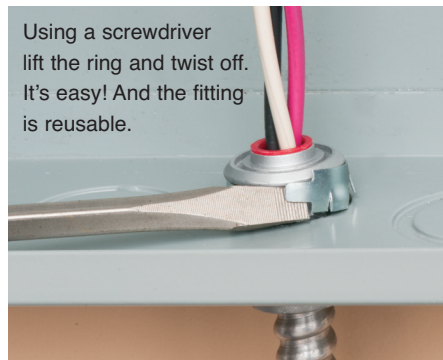

**Arlington®**

1 Stauffer Industrial Park  
Scranton, PA 18517  
800/233.4717 • Fax 570/562.0646  
www.aifittings.com

Distributed by