



The RFBA floor box is built for multiple applications and environments

### Recessed Floor Boxes for Concrete

RFBA2R, RFBA4R, RFBA6R, RFBA10R

RFBA Series of Floor Boxes are versatile recessed activation solutions that provide power, communication and/or audio/video services to open space areas, or directly to workstations. The floor boxes come in various sizes and depths, including 2, 4, 6 and 10-gangs to best fit your specific application. The boxes utilize FloorPort series covers and can be installed in carpet, wood, tile and polished concrete floor coverings. An optional terrazzo ring is available for the 2 and 4-gang boxes for use with bare concrete and terrazzo applications. The RFBA series is designed with improved wire and cable routing, allowing for easier wire pulling in adjacent compartments and around corners.

### Features & Benefits

- **Suitable for Various Applications.** Steel and on-grade (epoxy coated) to meet your specific installation requirements with support for installation in carpet, wood flooring, tile, terrazzo and polished concrete.
- **Various Gang and Depth Options Available.** Various Gang and Depth Options Available. Choose from either 2, 4, 6 or 10-gang boxes to fit your application. The 2 and 4-gang options are available in either a shallow (2.5") depth or standard (3.0") depth box.
- **Common Mounting Plates.** All models share the same mounting plates, allowing for easier configuration and specification.
- **Numerous Conduit Knockouts.** Features knockouts on all sides and bottom of box to allow for greater installation flexibility to work within your environment.
- **FloorPort Activation Covers.** Provides TopGuard protection from water, dirt and debris plus added strength and durability. Available in brushed aluminum and five decorative powder coat finishes: Black, Brass, Nickel, Gray and Bronze.
- **Improved Cable Management.** Internal compartments feature improved wire and cable routing for easier wire pulling in adjacent compartments and around corners.
- **Post-Pour Features:** Allows for adjustment post-pour and features removable dividers that can be installed or removed before or after the concrete pour.

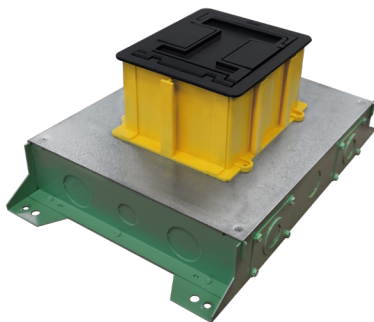

Rectangular extension ring can be used to extend height of box up to 4 inches

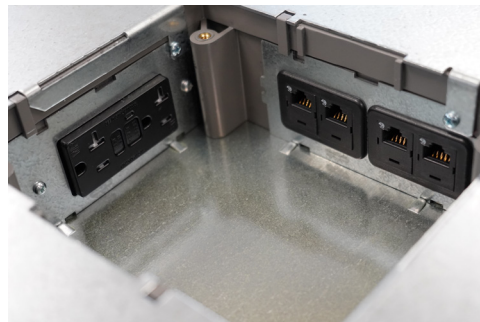

All models share eight (8) common device plates, allowing for data and power within the same box



Interior compartment of box features rounded corners for improved cable routing

### Compliance

 **cULus Listed:** Metallic Outlet Boxes for tile, terrazzo, carpet and wood floors.  
File E2961 Guide QCIT

## RFBA Series Floor Boxes with Rectangular Activations Selection Guide

Box Model	Box Type	Box Capacity	Box Depth	Conduit Size	Cover Type
RFBA2R25	Above Grade	2-Gang	2.5"	¾" – 1 ¼"	FloorPort
RFBA2R25OG	On-Grade	2-Gang	2.5"	¾" – 1 ¼"	FloorPort
RFBA2R30	Above Grade	2-Gang	3.0"	¾" – 2"*	FloorPort
RFBA2R30OG	On-Grade	2-Gang	3.0"	¾" – 2"*	FloorPort
RFBA4R25	Above Grade	4-Gang	2.5"	¾" – 1 ½"	FloorPort
RFBA4R25OG	On-Grade	4-Gang	2.5"	¾" – 1 ½"	FloorPort
RFBA4R30	Above Grade	4-Gang	3.0"	¾" – 2"*	FloorPort
RFBA4R30OG	On-Grade	4-Gang	3.0"	¾" – 2"*	FloorPort
RFBA6R30	Above Grade	6-Gang	3.0"	¾" – 2"*	Large FloorPort
RFBA6R30OG	On-Grade	6-Gang	3.0"	¾" – 2"*	Large FloorPort
RFBA10R55	Above Grade	10-Gang	5.5"	¾" – 2"	Large FloorPort
RFBA10R55OG	On-Grade	10-Gang	5.5"	¾" – 2"	Large FloorPort

\* Additional 2HUB accessory is needed on the 2, 4 and 6-gang boxes if using a 2" conduit feed to the box. Largest knockout without the 2HUB accessory on the 2, 4 and 6-gang boxes is 1 ¼".

## Resource RFBA Series Floor Boxes with Rectangular Activations Ordering Information

### RFBA2R25

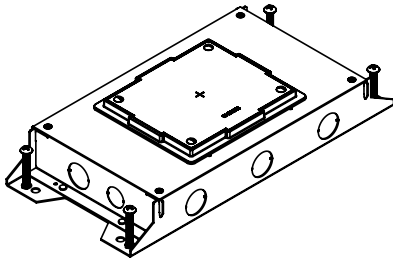

**2-Gang RFBA Floor Box, Shallow 2.5" Depth** – Steel floor box designed for above grade installations. Features 2-gangs of box capacity with 3" available behind plates. When ordering device plates for box, 2 blank device plates (Cat. No. RFBAB) must also be ordered to seal off wire and cable routing passageways. Fully adjustable before and after concrete pour. Designed for carpet, wood flooring, tile, terrazzo and polished concrete applications.

**Concrete Pour:** Minimum concrete pour without collar is 2.5". If using the collar, pour should be 3".

Sold Separately:

- FloorPort Covers
- Device Plates

### RFBA2R25OG

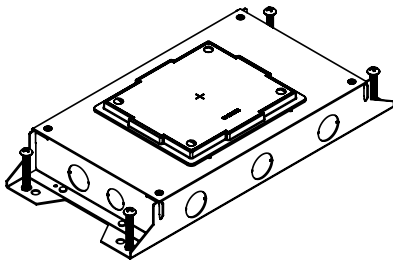

**2-Gang RFBA On-Grade Floor Box, Shallow 2.5" Depth** – Steel floor box designed for on-grade installations with a fusion-bonded epoxy for use on metal reinforcement bar and related accessories before encapsulating in concrete. Features 2-gangs of box capacity with 3" available behind plates. When ordering device plates for box, 2 blank device plates (Cat. No. RFBAB) must also be ordered to seal off wire and cable routing passageways. Fully adjustable before and after concrete pour. Designed for carpet, wood flooring, tile, terrazzo, and polished concrete applications.

**Concrete Pour:** Minimum concrete pour without collar is 2.5". If using the collar, pour should be 3".

Sold Separately:

- FloorPort Covers
- Device Plates

## Dimensions:

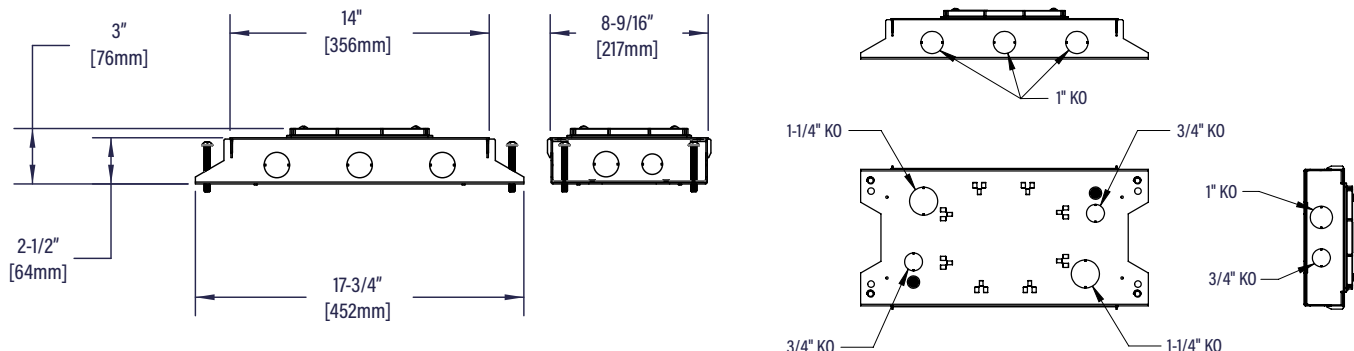

## Resource RFBA Series Floor Boxes with Rectangular Activations Ordering Information

### RFBA2R30

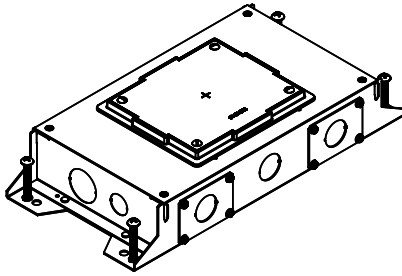

**2-Gang RFBA Floor Box, Standard 3.0" Depth** – Steel floor box designed for above grade installations. Features 2-gangs of box capacity with 3" available behind plates. When ordering device plates for box, 2 blank device plates (Cat. No. RFBAB) must also be ordered to seal off wire and cable routing passageways. Fully adjustable before and after concrete pour. Designed for carpet, wood flooring, tile, terrazzo and polished concrete applications.

**Concrete Pour:** Minimum concrete pour without collar is 3". If using the collar, pour should be 3.5".

Sold Separately:

- FloorPort Covers
- Device Plates

**Country of Origin: Mexico**

### RFBA2R30OG

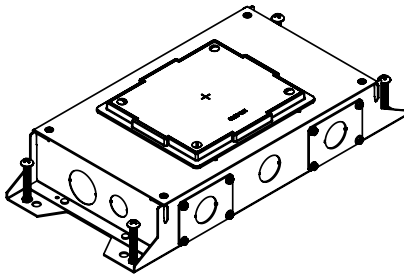

**2-Gang RFBA On-Grade Floor Box, Standard 3.0" Depth** – Steel floor box designed for on- grade installations with a fusion-bonded epoxy for use on metal reinforcement bar and related accessories before encapsulating in concrete. When ordering device plates for box, 2 blank device plates (Cat. No. RFBAB) must also be ordered to seal off wire and cable routing passageways. Features 2-gangs of box capacity with 3" available behind plates. Fully adjustable before and after concrete pour. Designed for carpet, wood flooring, tile, terrazzo, and polished concrete applications.

**Concrete Pour:** Minimum concrete pour without collar is 3". If using the collar, pour should be 3.5".

Sold Separately:

- FloorPort Covers
- Device Plates

**Country of Origin: Mexico**

### Dimensions:

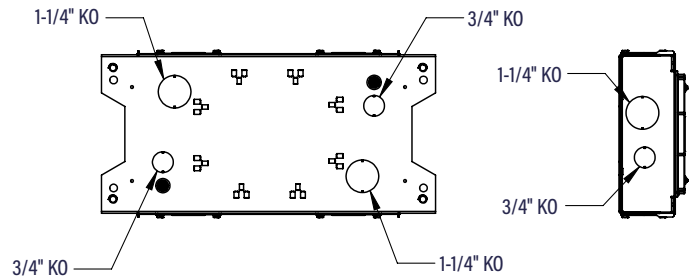
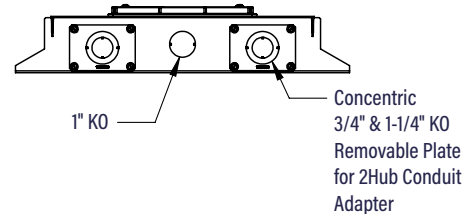
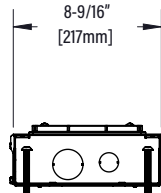
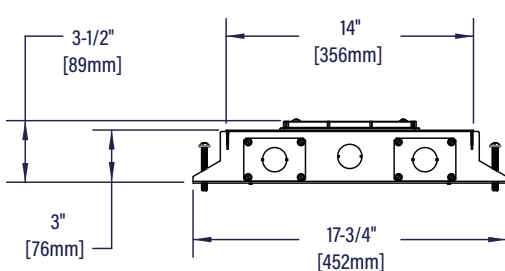

## Resource RFBA Series Floor Boxes with Rectangular Activations Ordering Information

### RFBA4R25

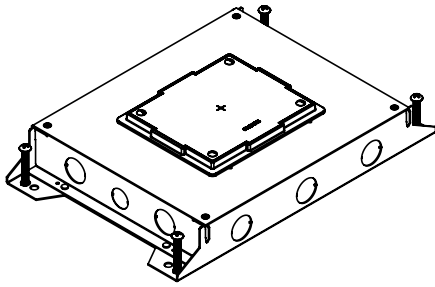

**4-Gang RFBA Floor Box, Shallow 2.5" Depth** – Steel floor box designed for above grade installations. Features 4-gangs of box capacity with at least 2 ¾" available behind device plates. Fully adjustable before and after concrete pour. Designed for carpet, wood flooring, tile, terrazzo and polished concrete applications.

**Concrete Pour:** Minimum concrete pour without collar is 2.5". If using the collar, pour should be 3".

- Sold Separately:
- FloorPort Covers
  - Device Plates

**Country of Origin: Mexico**

### RFBA4R25OG

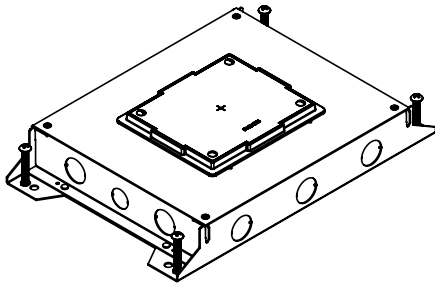

**4-Gang RFBA On-Grade Floor Box, Shallow, 2.5" Depth** – Steel floor box designed for on- grade installations with a fusion-bonded epoxy for use on metal reinforcement bar and related accessories before encapsulating in concrete. Features 4-gangs of box capacity with at least 2 ¾" available behind device plates. Fully adjustable before and after concrete pour. Designed for carpet, wood flooring, tile, terrazzo, and polished concrete applications.

**Concrete Pour:** Minimum concrete pour without collar is 2.5". If using the collar, pour should be 3".

- Sold Separately:
- FloorPort Covers
  - Device Plates

**Country of Origin: Mexico**

### Dimensions:

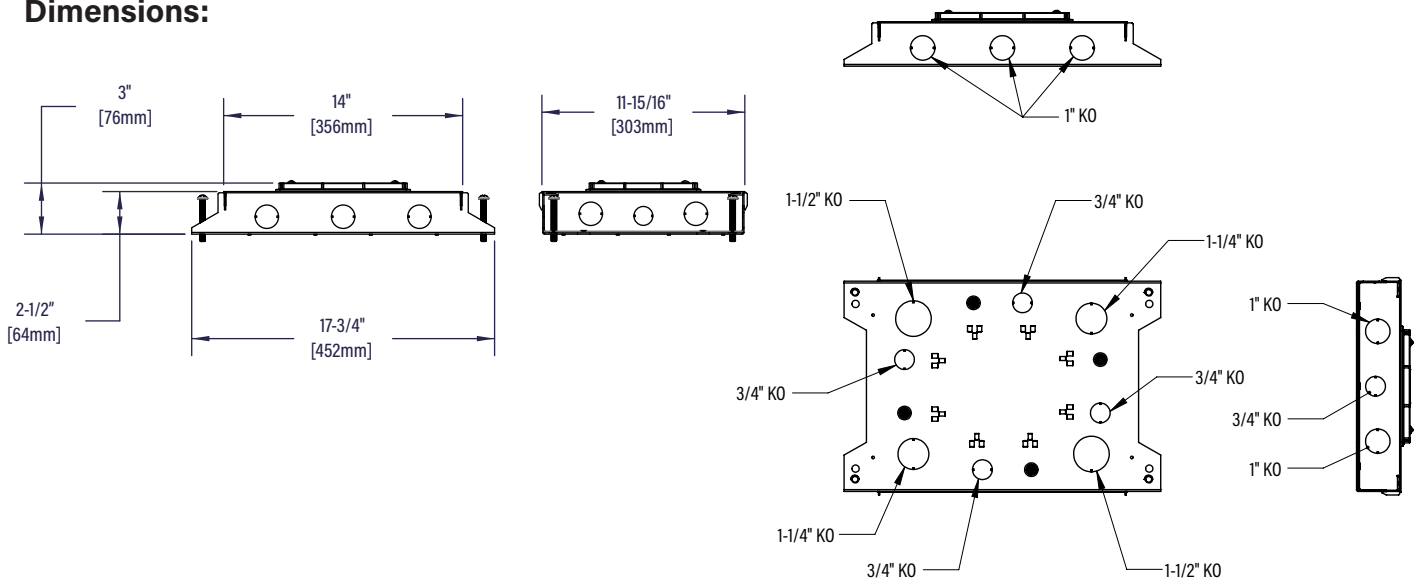

## Resource RFBA Series Floor Boxes with Rectangular Activations Ordering Information

### RFBA4R30

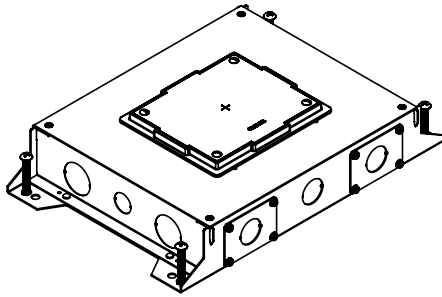

**4-Gang RFBA Floor Box, Standard 3.0" Depth** – Steel floor box designed for above grade installations. Features 4-gangs of box capacity with at least 2 3/4" available behind device plates. Fully adjustable before and after concrete pour. Designed for carpet, wood flooring, tile, terrazzo and polished concrete applications.

**Concrete Pour:** Minimum concrete pour without collar is 3". If using the collar, pour should be 3.5".

- Sold Separately:
- FloorPort Covers
  - Device Plates

**Country of Origin: Mexico**

### RFBA4R30OG

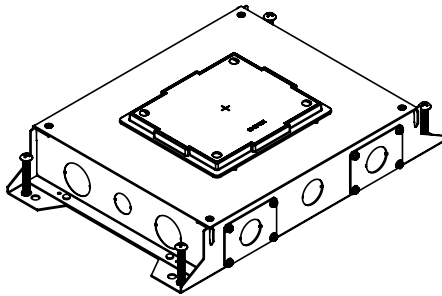

**4-Gang RFBA On-Grade Floor Box, Standard 3.0" Depth** – Steel floor box designed for on-grade installations with a fusion-bonded epoxy for use on metal reinforcement bar and related accessories before encapsulating in concrete. Features 4-gangs of box capacity with at least 2 3/4" available behind device plates. Fully adjustable before and after concrete pour. Designed for carpet, wood flooring, tile, terrazzo, and polished concrete applications.

**Concrete Pour:** Minimum concrete pour without collar is 3". If using the collar, pour should be 3.5".

- Sold Separately:
- FloorPort Covers
  - Device Plates

**Country of Origin: Mexico**

### Dimensions:

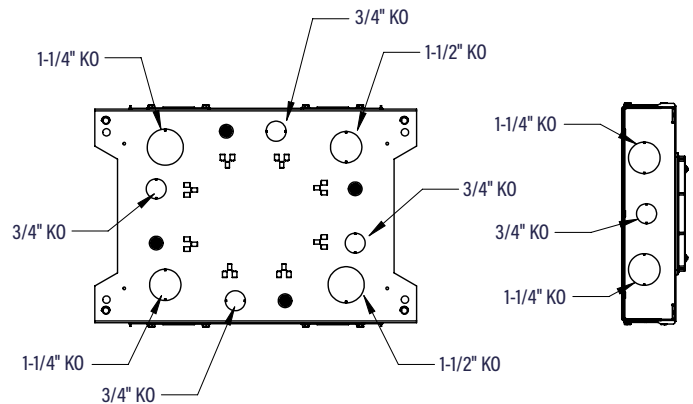
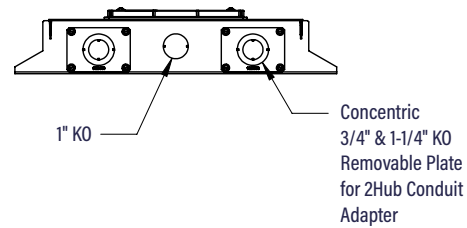
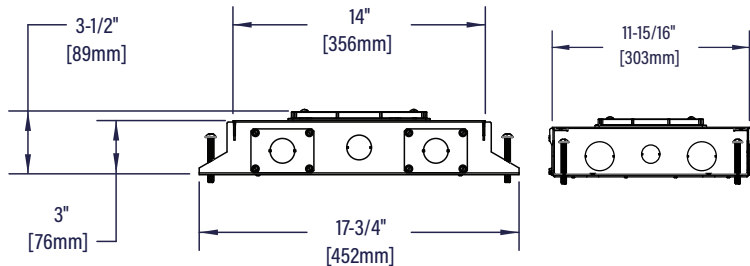

**Resource RFBA Series Floor Boxes with Rectangular Activations Ordering Information**

**RFBA6R30**

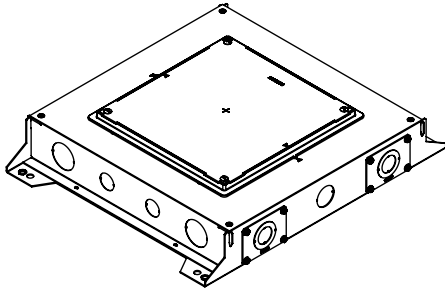

**6-Gang RFBA Floor Box, 3.0" Depth** - Steel floor box designed for above grade installations. Features 6-gangs of box capacity with at least 2 9/16" available behind device plates. Fully adjustable before and after concrete pour. Designed for carpet, tile, and wood flooring. Terrazzo and bare concrete kit not available.

**Concrete Pour:** minimum concrete pour without collar is 3". If using the collar, pour should be 3.5".

Sold separately:

- Device Plates
- Large FloorPort Covers

**Country of Origin: USA**

**RFBA6R30OG**

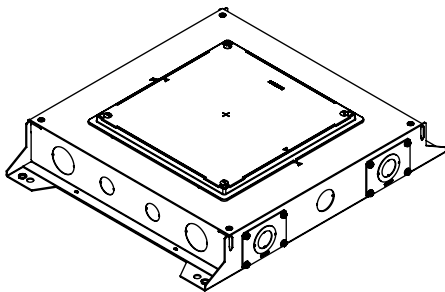

**6-Gang RFBA On-Grade Floor Box, Standard 3.0" Depth** - Steel floor box designed for on-grade installations with a fusion-bonded epoxy for use on metal reinforcement bar and related accessories before encapsulating in concrete. Features 6-gangs of box capacity with at least 2 9/16" available behind device plates. Fully adjustable before and after concrete pour. Designed for carpet, tile, and wood floor applications. Terrazzo and bare concrete kit not available.

**Concrete Pour:** minimum concrete pour without collar is 3". If using the collar, pour should be 3.5".

Sold separately:

- Device Plates
- Large FloorPort Covers

**Country of Origin: USA**

**Dimensions:**

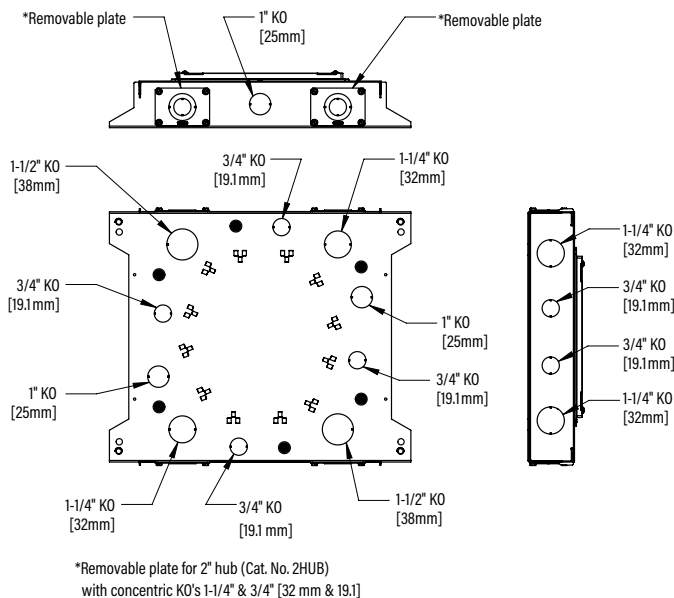
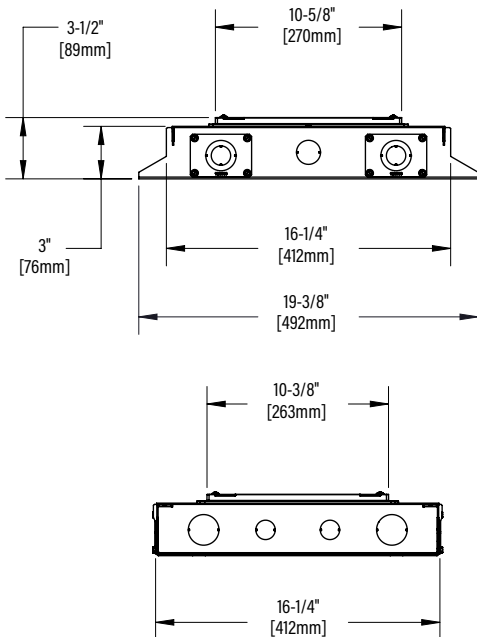



## Resource RFBA Series Floor Boxes with Rectangular Activations Ordering Information

### RFBA10R55

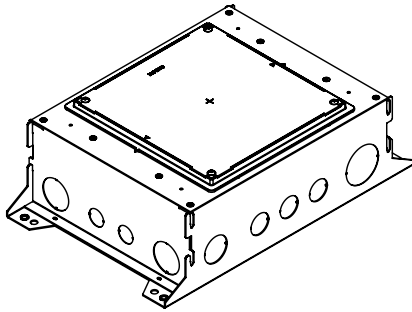

**10-Gang RFBA Floor Box, 5.5" Depth** - Steel floor box designed for above grade installations. Features 10-gangs of box capacity with at least 2 1/2" available behind device plates. Fully adjustable before and after concrete pour. Designed for carpet, tile, and wood flooring. Terrazzo and bare concrete kit not available.

**Concrete Pour:** minimum concrete pour without collar is 5.5". If using the collar, pour should be 6".

Sold separately:

- Device Plates
- Large FloorPort Covers

**Country of Origin: USA**

### RFBA10R55OG

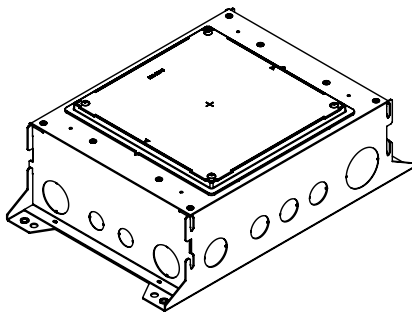

**10-Gang RFBA On-Grade Floor Box, 5.5" Depth** - Steel floor box designed for on-grade installations with a fusion-bonded epoxy for use on metal reinforcement bar and related accessories before encapsulating in concrete. Features 10-gangs of box capacity with at least 2 1/2" available behind device plates. Fully adjustable before and after concrete pour. Designed for carpet, tile, and wood flooring. Terrazzo and bare concrete kit not available.

**Concrete Pour:** minimum concrete pour without collar is 5.5". If using the collar, pour should be 6".

Sold separately:

- Device Plates
- Large FloorPort Covers

**Country of Origin: USA**

### Dimensions:

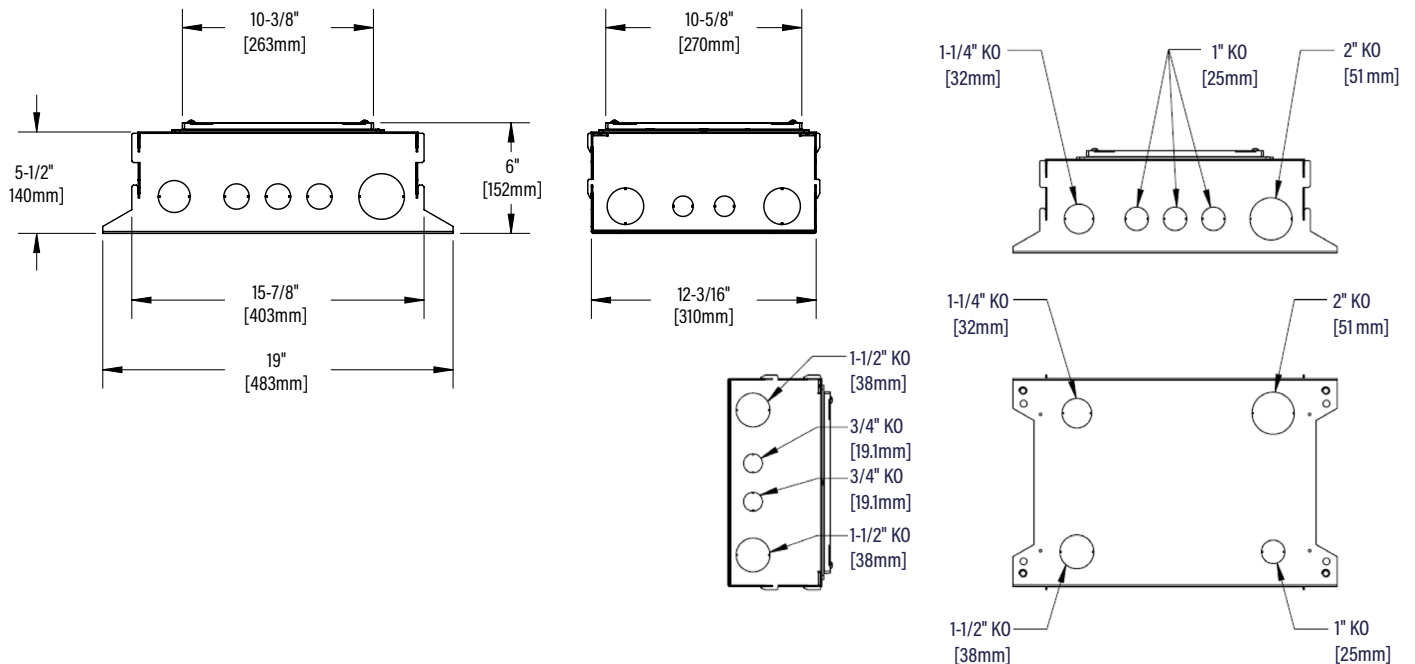

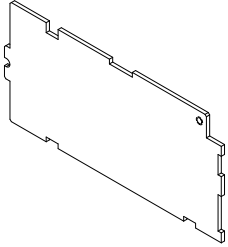
**Resource RFBA Series Floor Boxes Accessories Ordering Information****RFBAB**

**Blank Device Plate** - Closes off unused gangs.

**Country of Origin: USA**

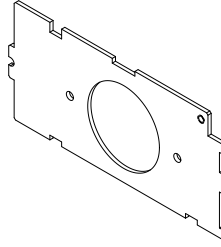
**RFBAS2**

**1.59" Single Device Plate** - Receptacle opening 1 9/16" (40mm)

**Country of Origin: USA**

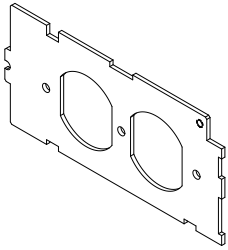
**RFBADP**

**Duplex Device Plate** - Accepts standard 15 Amp & 20 Amp Duplex Receptacles.

**Country of Origin: USA**

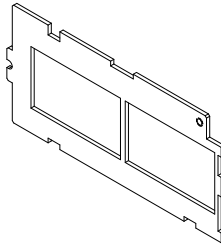
**RFBA6A**

**Communications Plate** - Accepts bezels for common communications devices. Including TracJack, Series II, Keystone, Lucent

**Country of Origin: USA**

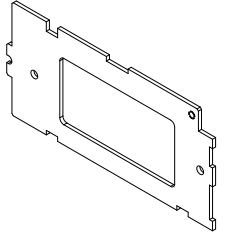
**RFBADEC**

**Decorator Device Plate** - Accepts Decorator Style Receptacles, Communication or A/V Devices.

**Country of Origin: USA**

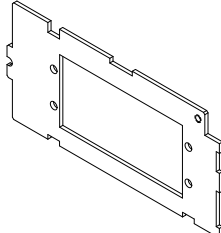
**RFBAAAP**

**AAP Device Plate** - Accepts Extron® Electronics AAP devices (sold separately)

**Country of Origin: USA**

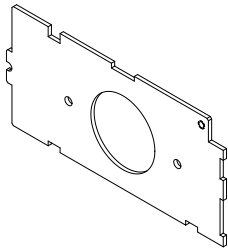
**RFBAS1**

**1.39" Single Device Plate** - Receptacle opening 1 3/8" (35mm)

**Country of Origin: USA**

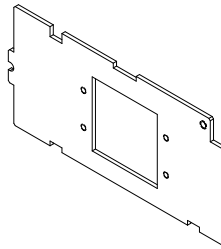
**RFBAMAAP**

**MAAP Device Plate** - Accepts two (2) Legrand AVIP or Extron® Electronics MAAP Series Devices (sold separately)

**Country of Origin: USA**

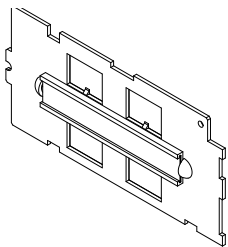
**RFBADJ4LB**

**Device Mounting Plate** - Accepts 4 jacks of data and includes removable label holder and labels

**Country of Origin: USA**



## Resource RFBA Series Floor Boxes Accessories Ordering Information

### RFBA24R4EXT

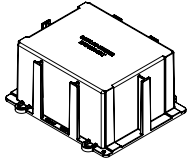

**Rectangular Extension Ring for 2 and 4-Gang Boxes** - Used to extend height of floor box. Cut to desired level after concrete pour. To be used with flanged FloorPort covers only.

**Country of Origin: USA**

### RFBA24FF

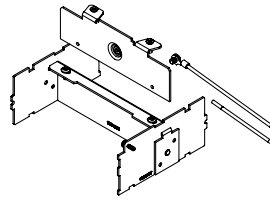

**Furniture Feed Barrier Kit for 2 and 4-Gang Boxes** - Used to separate power and communication services. Used in combination with FloorPort Furniture Feed Covers (FPFFTC). Covers sold separately

**Country of Origin: USA**

### RFBA24R05EXT

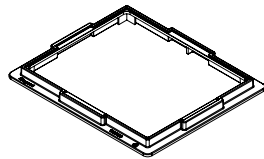

**Rectangular 1/2" Collar** - Extends 0.5" above surface of box.

**Country of Origin: USA**

### FPCKIT

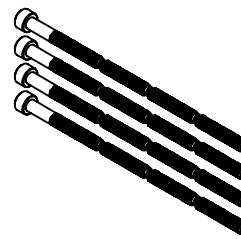

**Break-Away Screw** - Four (4) break-away screws used to mount flanged FloorPort covers on deeper pours

**Country of Origin: USA**

### RFBA610R4EXT

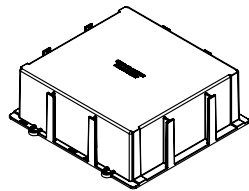

**4" Rectangular Extension Ring for 6/10-Gang Boxes** - Used to extend height of floor box. Cut to desired level after concrete pour. To be used with flanged FloorPort covers only.

**Country of Origin: USA**

### 2HUB

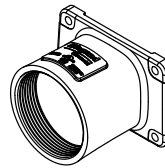

**2" Conduit Transition Hub** - Trade size 2" die cast zinc conduit fitting allows for 2" conduit to transition into a shallow box design. Includes: die cast fitting, gasket, and mounting screws.

**Country of Origin: USA**

### FP-CTR

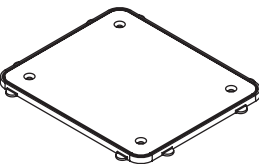

**Bare Concrete & Terrazzo Ring** - Nonmetallic ring for use on bare polished concrete and terrazzo floor applications.

**Note:** FP-CTR is compatible with 2 and 4-gang boxes only.

**Country of Origin: USA**

## FloorPort Series Covers for 2 and 4-gang RFBA Floor Boxes

FLOORPORT PART NUMBER CONFIGURATOR								
FP	B		TC		NK			
FloorPort Cover	Blank Top	B	Tile (Flangeless)	T	Nickel	NK	Bronze	BZ
	Cutout Top	C	Tile/Carpet (Flanged)	TC	Brass	BS	Gray	GY
	Furniture Feed	FF			Black	BK	Brushed Aluminum	AL

NOTE: Add "TR" to end of part number to indicate tamper-resistant cover. Not available with Furniture Feed cover.

## FloorPort Series Flanged Cover Assemblies Ordering Information

FPCTCBK  
FPCTCBZ  
FPCTCBS  
FPCTCNK  
FPCTCAL  
FPCTCGY

### Cutout Cover Assembly -

Flanged cover for use in tile or carpet installation. Die-cast aluminum assembly available in black (BK), bronze (BZ), brass (BS), nickel (NK), gray (GY), or brushed aluminum (AL). Insert in lid allows for carpet or tile cutouts to match finished floor.

Country of Origin: India

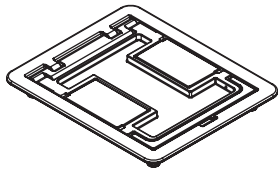

FPCTCBKTR  
FPCTCBZTR  
FPCTCBSTR  
FPCTCNKTR  
FPCTCALTR  
FPCTCGYTR

### Cutout Tamper-Resistant Cover Assembly -

Flanged cover for use in tile or carpet installation. Features tamper-resistant screw to limit unauthorized personnel. Die-cast aluminum assembly available in black (BK), bronze (BZ), brass (BS), nickel (NK), gray (GY) or brushed aluminum (AL). Insert in lid allows for carpet or tile cutouts to match finished floor.

Country of Origin: India

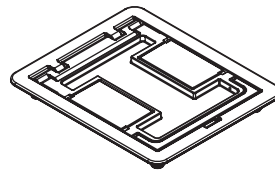

FPBTCBK  
FPBTCBZ  
FPBTCBS  
FPBTCNK  
FPBTCAL  
FPBTCGY

### Blank Cover Assembly -

Flanged cover for use in tile or carpet installation. Die-cast aluminum assembly available in black (BK), bronze (BZ), brass (BS), nickel (NK), gray (GY), or brushed aluminum (AL). Lid area is flush with the finished floor, no cutouts provided.

Country of Origin: India

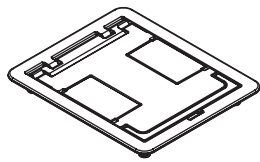

FPBTCBKTR  
FPBTCBZTR  
FPBTCBSTR  
FPBTCNKTR  
FPBTCALTR  
FPBTCGYTR

### Blank Tamper-Resistant Cover Assembly -

Flanged cover for use in tile or carpet installation. Features tamper-resistant screw to limit unauthorized personnel. Die-cast aluminum assembly available in black (BK), bronze (BZ), brass (BS), nickel (NK), gray (GY) or brushed aluminum (AL). Lid area is flush with the finished floor, no cutouts provided.

Country of Origin: India

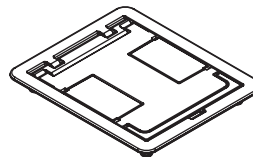

FPFFTCBK  
FPFFTCBZ  
FPFFTCBS  
FPFFTCNK  
FPFFTCAL  
FPFFTCGY

### Furniture Feed Cover Assembly -

Flanged cover for use in tile or carpet installation. Die-cast aluminum assembly available in black (BK), bronze (BZ), brass (BS), nickel (NK), gray (GY), or brushed aluminum (AL). Provided with one 1" trade size screw plug for power or communication type cabling and one combination 1 1/4" and 2" trade size screw plug for communication type cabling. Allows for feeding both power and communication cabling.

Country of Origin: China

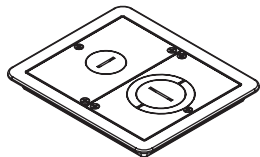

NOTE: Pricing varies depending on country of origin. Consult your local sales representative for more information.

## FloorPort Series Covers for 2 and 4-gang RFBA Floor Boxes

FLOORPORT PART NUMBER CONFIGURATOR								
FP	B		TC		NK			
FloorPort Cover	Blank Top	B	Tile (Flangeless)	T	Nickel	NK	Bronze	BZ
	Cutout Top	C	Tile/Carpet (Flanged)	TC	Brass	BS	Gray	GY
	Furniture Feed	FF			Black	BK	Brushed Aluminum	AL

NOTE: Add "TR" to end of part number to indicate tamper-resistant cover. Not available with Furniture Feed cover.

## FloorPort Series Flangeless Cover Assemblies Ordering Information

FPCTBK  
FPCTBZ  
FPCTBS  
FPCTNK  
FPCTAL  
FPCTGY

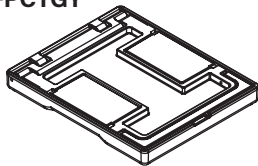

**Cutout Cover Assembly -** Flangeless cover for use in tile installations. Die-cast aluminum assembly available in black (BK), bronze (BZ), brass (BS), nickel (NK), gray (GY), or brushed aluminum (AL). Insert in lid allows for tile cutouts to match finished floor.

**Country of Origin: India**

FPCTBKTR  
FPCTBZTR  
FPCTBSTTR  
FPCTNKTR  
FPCTALTR  
FPCTGYTR

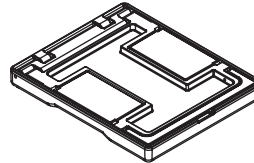

**Cutout Tamper-Resistant Cover Assembly -** Flangeless cover for use in tile installations. Features tamper-resistant screw to limit unauthorized personnel. Die-cast aluminum assembly available in black (BK), bronze (BZ), brass (BS), nickel (NK), gray (GY) or brushed aluminum (AL). Insert in lid allows for tile cutouts to match finished floor.

**Country of Origin: India**

FPBTBK  
FPBTBZ  
FPBTBS  
FPBTNK  
FPBTAL  
FPBTGY

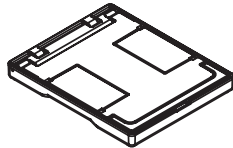

**Blank Cover Assembly -** Flangeless cover for use in tile installations. Die-cast aluminum assembly available in black (BK), bronze (BZ), brass (BS), nickel (NK), gray (GY), or brushed aluminum (AL). Lid area is flush with the finished floor, no cutouts provided.

**Country of Origin: India**

FPBTBKTR  
FPBTBZTR  
FPBTBSTTR  
FPBTNKTR  
FPBTALTR  
FPBTGYTR

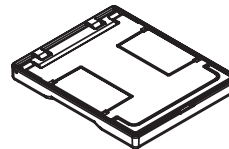

**Blank Tamper-Resistant Cover Assembly -** Flangeless cover for use in tile installations. Features tamper-resistant screw to limit unauthorized personnel. Die-cast aluminum assembly available in black (BK), bronze (BZ), brass (BS), nickel (NK), gray (GY) or brushed aluminum (AL). Lid area is flush with the finished floor, no cutouts provided.

**Country of Origin: India**

FPFFTBK  
FPFFTBZ  
FPFFTBS  
FPFFTNK  
FPFFTAL  
FPFFTGY

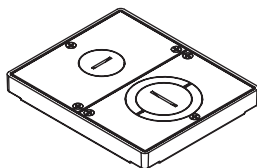

**Furniture Feed Cover Assembly -** Flangeless cover for use in tile installations. Die-cast aluminum assembly available in black (BK), bronze (BZ), brass (BS), nickel (NK), gray (GY), or brushed aluminum (AL). Provided with one 1" trade size screw plug for power or communication type cabling and one combination 1 1/4" and 2" trade size screw plug for communication type cabling. Allows for feeding both power and communication cabling.

**Country of Origin: China**

NOTE: Pricing varies depending on country of origin. Consult your local sales representative for more information.

## North America Made FloorPort Series Covers for 2 and 4-gang RFBA Floor Boxes

FLOORPORT PART NUMBER CONFIGURATOR										
FP	B		TC		NK			NA		
FloorPort Cover	Blank Top	B	Tile (Flangeless)	T	Nickel	NK	Bronze	BZ	North America Made	NA
	Cutout Top	C	Tile/Carpet (Flanged)	TC	Brass	BS	Gray	GY		
	Furniture Feed	FF			Black	BK	Brushed Aluminum	AL		

NOTE: Add "TR" to end of part number to indicate tamper-resistant cover. Not available with Furniture Feed cover.

## North America Made FloorPort Series Flanged Cover Assemblies Ordering Information

FPCTCBK-NA  
 FPCTCBZ-NA  
 FPCTCBS-NA  
 FPCTCNK-NA  
 FPCTCGY-NA

**Cutout Cover Assembly -**  
 Flanged cover for use in tile or carpet installation. Die-cast aluminum assembly available in black (BK), bronze (BZ), brass (BS), nickel (NK) or gray (GY). Insert in lid allows for carpet or tile cutouts to match finished floor.

**Country of Origin: USA**

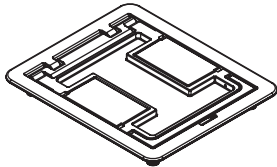

FPCTCBKTR-NA  
 FPCTCBZTR-NA  
 FPCTCBSTR-NA  
 FPCTCNKTR-NA  
 FPCTCALTR-NA  
 FPCTCGYTR-NA

**Cutout Tamper-Resistant Cover Assembly -** Flanged cover for use in tile or carpet installation. Features tamper-resistant screw to limit unauthorized personnel. Die-cast aluminum assembly available in black (BK), bronze (BZ), brass (BS), nickel (NK), gray (GY) or brushed aluminum (AL). Insert in lid allows for carpet or tile cutouts to match finished floor.

**Country of Origin: USA**

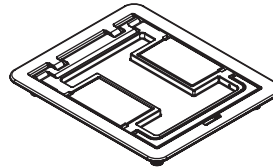

FPBTCBK-NA  
 FPBTCBZ-NA  
 FPBTCBS-NA  
 FPBTCNK-NA  
 FPBTCGY-NA

**Blank Cover Assembly -**  
 Flanged cover for use in tile or carpet installation. Die-cast aluminum assembly available in black (BK), bronze (BZ), brass (BS), nickel (NK) or gray (GY). Lid area is flush with the finished floor, no cutouts provided.

**Country of Origin: USA**

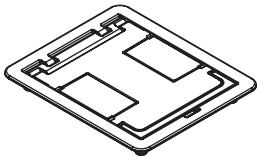

FPBTCBKTR-NA  
 FPBTCBZTR-NA  
 FPBTCBSTR-NA  
 FPBTCNKTR-NA  
 FPBTCALTR-NA  
 FPBTCGYTR-NA

**Blank Tamper-Resistant Cover Assembly -** Flanged cover for use in tile or carpet installation. Features tamper-resistant screw to limit unauthorized personnel. Die-cast aluminum assembly available in black (BK), bronze (BZ), brass (BS), nickel (NK), gray (GY) or brushed aluminum (AL). Lid area is flush with the finished floor, no cutouts provided.

**Country of Origin: USA**

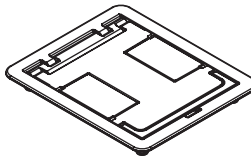

NOTE: Pricing varies depending on country of origin. Consult your local sales representative for more information.

## Large FloorPort Series Covers for 6 and 10-gang RFBA Floor Boxes

FLOORPORT PART NUMBER CONFIGURATOR								
FPL	B		TC		NK			
Large FloorPort Cover	Blank Top	B	Tile/Carpet (Flanged)	TC	Nickel	NK	Bronze	BZ
	Cutout Top	C			Brass	BS	Gray	GY
					Black	BK	Brushed Aluminum	AL

Note: Add "TR" to end of part number to indicate tamper-resistant cover.

## Large FloorPort Series Flanged Covers Ordering Information

FPLCTCBK  
FPLCTCBZ  
FPLCTCBS  
FPLCTCNK  
FPLCTCAL  
FPLCTCGY

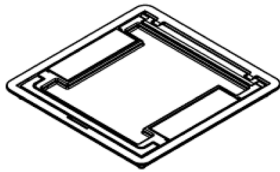

**Large Cutout Cover Assembly -** Flanged cover for use in tile or carpet installation. Die-cast aluminum assembly available in black (BK), bronze (BZ), brass (BS), nickel (NK), gray (GY), or brushed aluminum (AL). Insert in lid allows for carpet or tile cutouts to match finished floor. For use with 6 and 10-gang RFBA floor boxes.

**Country of Origin: India**

FPLCTCBKTR  
FPLCTCBZTR  
FPLCTCBSTR  
FPLCTCNKTR  
FPLCTCALTR  
FPLCTCGYTR

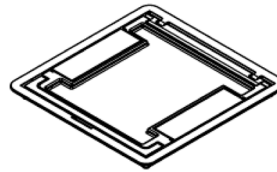

**Large Tamper-Resistant Cutout Cover Assembly -** Flanged tamper-resistant cover for use in tile or carpet installation. Die-cast aluminum assembly available in black (BK), bronze (BZ), brass (BS), nickel (NK), gray (GY), or brushed aluminum (AL). Insert in lid allows for carpet or tile cutouts to match finished floor. For use with 6 and 10-gang RFBA floor boxes.

**Country of Origin: India**

FPLBTCBK  
FPLBTCBZ  
FPLBTCBS  
FPLBTCNK  
FPLBTCAL  
FPLBTCGY

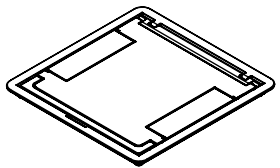

**Large Blank Cover Assembly -** Flanged cover for use in tile or carpet installation. Die-cast aluminum assembly available in black (BK), bronze (BZ), brass (BS), nickel (NK), gray (GY), or brushed aluminum (AL). Lid area is flush with the finished floor, no cutouts provided. For use with 6 and 10-gang RFBA floor boxes.

**Country of Origin: India**

FPLBTCBKTR  
FPLBTCBZTR  
FPLBTCBSTR  
FPLBTCNKTR  
FPLBTCALTR  
FPLBTCGYTR

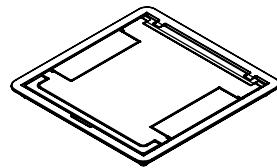

**Large Tamper-Resistant Blank Cover Assembly -** Flanged tamper-resistant cover for use in tile or carpet installation. Die-cast aluminum assembly available in black (BK), bronze (BZ), brass (BS), nickel (NK), gray (GY), or brushed aluminum (AL). Lid area is flush with the finished floor, no cutouts provided. For use with 6 and 10-gang RFBA floor boxes.

**Country of Origin: India**

**NOTE:** All brand and product names referenced in this document are registered trademarks or trademarks of their respective holders.



**Legrand, North America**  
60 Woodlawn Street  
West Hartford, CT 06110  
1.877.BY.LEGRAND (295.3472)  
www.legrand.us

**Canada**  
905.738.9195  
www.legrand.ca

FOLLOW US

