

Passive Video Splitters and Splitter Modules

APPLICATION

6- and 8-way 2 GHz Passive Video Splitters and Passive Video Splitter Modules are ideal for splitting digital cable, quality cable TV, and off-air signals to six or eight televisions throughout a home or office. Passive Video Splitter Modules are designed for easy installation in any Leviton 14", 21", 28", or 42" Structured Media® Center. Passive Video Splitters are easily installed in Leviton MDU Enclosures or used in any application where a passive video splitter is needed. These units feature die-cast housings and printed circuit board construction.



SPECIFICATION

Passive Video Splitter Modules shall be mounted in any Leviton 14", 21", 28", or 42" Structured Media Center, used in any application where a passive video splitter is required.

FEATURES

- Split video signals with outputs for six or eight televisions
- Provide digital cable, cable TV, and other video services via coaxial cable to any room in a house or office
- Durable gold-plated 360-degree insert pin resists oxidation, maintaining a distortion-free signal for digital data transmission
- Weather sealed F-ports up to 30 PSI
- 75 Ohm termination caps with splitter modules
- 6kV surge protection
- Built-in capacitors on all ports block DC or low-frequency AC and also prevent current from flowing through splitter's ferrite core windings that cause hum modulation
- High-quality plating passes 1200-hour salt spray test
- Maintains low temperature stability from -40°C to 85° C both in isolation and return loss

DESIGN CONSIDERATIONS

- Passive Video Splitter Modules come with mounting bracket for easy installation in any Leviton 14", 21", 28", or 42" Structured Media Center
- Passive splitters without a bracket are easily installed in Leviton MDU Enclosures (47605-MDU)
- Can be used with a video amplifier for increased signal quality
- High-precision machined, SCTE-compliant threaded ports spaced at intervals of one inch, center to center
- Printed circuit board construction
- Shielded for -130 dB RFI

STANDARDS COMPLIANCE

- SCTE
- ATIC listed
- MoCA compatible

PHYSICAL SPECIFICATIONS

Dimensions: See page two

Materials: Splitter: Nickel-plated F-connector, tin-plated zinc die-cast housing, and glass-printed circuit board with micro-strip design
Bracket: White powder-coated 18-gauge sheet metal

COUNTRY OF ORIGIN

China

WARRANTY INFORMATION

For a copy of Leviton product warranties, visit www.leviton.com/warranty.

Leviton Network Solutions

2222 - 222nd St. SE
Bothell, WA 98021-4416

tel 1-800-824-3005
tel +1-425-486-2222
appeng@leviton.com
www.leviton.com

Asia / Pacific

T +1.631.812.6228
E infoasean@leviton.com

Europe

T +44.0.1592.772124
E customerservice@brand-rex.com

Canada

T +1.514.954.1840
E pcservice@leviton.com

India / SAARC

T +971.4.886.4722
E infoindia@leviton.com

Caribbean

T +1.954.593.1896
E infocaribbean@leviton.com

Mexico

T +52.55.5082.1040
E lsamarketing@leviton.com

China

T +852.2774.9876
E infochina@leviton.com

Middle East & Africa

T +971.4.886.4722
E lmeinfo@leviton.com

Colombia

T +57.1.743.6045
E infocolombia@leviton.com

South Korea

T +82.2.3273.9963
E infokorea@leviton.com

PRODUCT SPECIFICATIONS
47690-xC2, 47690-0Gx



ELECTRONIC FILES

For CAD files, typical specs, or technical drawings (.DXF, .DWG), visit www.leviton.com.

47690-6C2

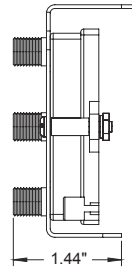
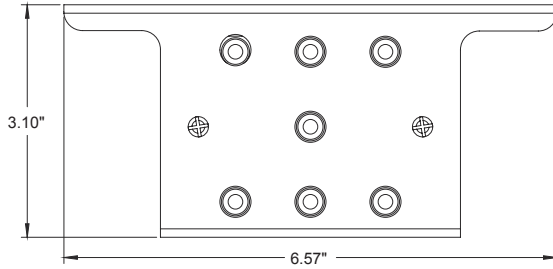

47690-8C2

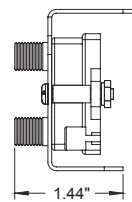
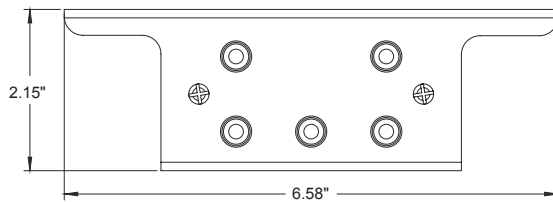

47690-0G6

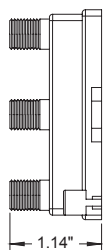
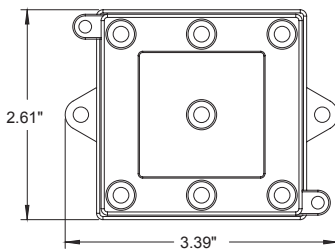

47690-0G8

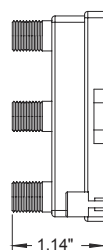
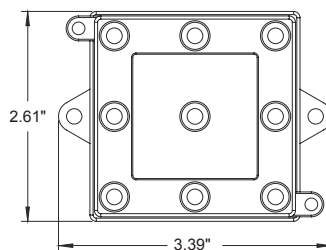

47690-xC2, 47690-0Gx

Leviton Network Solutions

2222 - 222nd St. SE
 Bothell, WA 98021-4416

tel 1-800-824-3005
 tel +1-425-486-2222
appeng@leviton.com
www.leviton.com

Asia / Pacific
 T +1.631.812.6228
 E infoasean@leviton.com

Europe
 T +44.0.1592.772124
 E customerservice@brand-rex.com

Canada
 T +1.514.954.1840
 E pcservice@leviton.com

India / SAARC
 T +971.4.886.4722
 E infoindia@leviton.com

Caribbean
 T +1.954.593.1896
 E infocaribbean@leviton.com

Mexico
 T +52.55.5082.1040
 E lsamarketing@leviton.com

China
 T +852.2774.9876
 E infochina@leviton.com

Middle East & Africa
 T +971.4.886.4722
 E lmeinfo@leviton.com

Colombia
 T +57.1.743.6045
 E infocolombia@leviton.com

South Korea
 T +82.2.3273.9963
 E infokorea@leviton.com

PERFORMANCE SPECIFICATIONS		
Insertion Loss	1x6	1x8
5 MHz – 47 MHz	-10.5 dB	-13.0 dB
47 MHz – 950 MHz	-12.5 dB	-13.0 dB
950 MHz – 1450 MHz	-13.0 dB	-14.0 dB
1450 MHz – 2050 MHz	-14.5 dB	-15.5 dB
2050 MHz – 2150 MHz	-16.0 dB	-16.5 dB
Input Return Loss	1x6	1x8
5 MHz – 47 MHz	-11.0 dB	-8.5 dB
47 MHz – 950 MHz	-13.0 dB	-13.0 dB
950 MHz – 1450 MHz	-13.0 dB	-13.0 dB
1450 MHz – 2050 MHz	-13.0 dB	-13.0 dB
2050 MHz – 2150 MHz	-13.0 dB	-13.0 dB
Isolation Loss	1x6	1x8
5 MHz – 47 MHz	-21.0 dB	-21.0 dB
47 MHz – 950 MHz	-21.0 dB	-21.0 dB
950 MHz – 1450 MHz	-20.0 dB	-21.0 dB
1450 MHz – 2050 MHz	-20.0 dB	-21.0 dB
2050 MHz – 2150 MHz	-20.0 dB	-20.0 dB

PART NUMBERS	
Description	Part No.
6-Way Passive Video Splitter Module (2 GHz)	47690-6C2
8-Way Passive Video Splitter Module (2 GHz)	47690-8C2
6-Way Passive Video Splitter (2 GHz)	47690-0G6
8-Way Passive Video Splitter (2 GHz)	47690-0G8

Leviton Network Solutions 2222 - 222nd St. SE Bothell, WA 98021-4416 tel 1-800-824-3005 tel +1-425-486-2222 appeng@leviton.com www.leviton.com	Asia / Pacific T +1.631.812.6228 E infoasean@leviton.com	Canada T +1.514.954.1840 E pcservice@leviton.com	Caribbean T +1.954.593.1896 E infocaribbean@leviton.com	China T +852.2774.9876 E infochina@leviton.com	Colombia T +57.1.743.6045 E infocolombia@leviton.com
	Europe T +44.0.1592.772124 E customerservice@brand-rex.com	India / SAARC T +971.4.886.4722 E infoindia@leviton.com	Mexico T +52.55.5082.1040 E lsamarketing@leviton.com	Middle East & Africa T +971.4.886.4722 E lmeinfo@leviton.com	South Korea T +82.2.3273.9963 E infokorea@leviton.com