

decora smart<sup>®</sup>



LEVITON<sup>®</sup>

# Make Every Home a Smart Home



# A Solution for Every Room and Home



My Leviton and Decora Smart Wi-Fi offers a full portfolio of connected lighting and load control devices so any home, new or old, can be a smart home. The collection includes dimmers, switches, smart plugs, fan controller, outlet, motion sensor, and options for homes that may not have neutral wiring.

Start small with a smart switch to automate your porch light so you never come home to a dark house, or go larger and outfit a room or your entire home. Expand the system at any time, making this the ideal solution to meet your smart home lighting and load control needs.



1



**15A  
TR  
Outlet**

2



**Voice Dimmer  
with Amazon  
Alexa Built-in**

3



**Fan Speed  
Controller**

4



**Leviton Load  
Center**

5



**Scene  
Controller  
Switch**

6



**600W  
Dimmer**

7



**Anywhere  
Dimmer  
and Switch  
Companion**

8



**Mini Plug-in  
Switch or Dimmer**

9



**Motion  
Sensing  
Dimmer**

10



**15A  
Switch**



**My Leviton  
App**



Connectivity

# Connectivity Options

Decora Smart Wi-Fi lighting can be connected to your favorite smart products, services and voice assistants.

## Choice of Voice

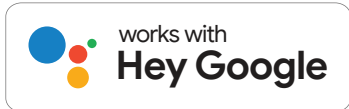

## We Play Well with Others





Flexible Control

# My Leviton App

Manage your whole home – capture room scenes, customize lighting settings such as fade rates, and enjoy convenient remote control of devices and activities.

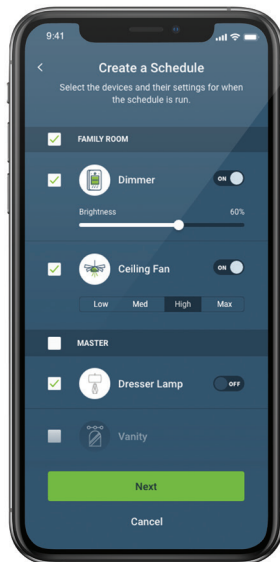

## Set Schedules

- Use the app to easily create schedules that turn lights on and off throughout the day

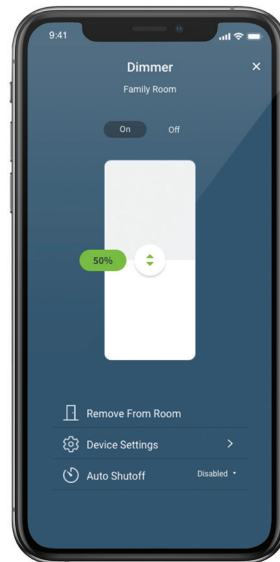

## Control Individual Devices or Rooms

- Control lights, fans, and plug loads from anywhere
- Brighten a light fixture or quickly turn on an entire room



## Simplify Automation

- Activities like “Movie Time” or “Game Night” make adjusting home lighting quick and easy
- Use your Voice, App, or Scene Controller Switch to control devices and lighting scenes





Complete Lighting Solution

# Custom Lighting

Simplify lighting control with a smart dimmer to set the lights the way you want to match your lifestyle.

My Leviton plus Decora Smart equals best-in-class dimming options for both newer and older homes.

- Full range dimming performance with custom settings in the My Leviton app for preset lighting levels, fade rates, bulb types and more
- Schedule lights to dim/brighten or turn on/off at specific times or based on sunrise/sunset; use vacation mode to randomize lighting for a lived-in look when away from home



**D26HD**  
600W Dimmer  
(2nd Gen)



**DWVAA**  
Voice Dimmer with  
Amazon Alexa Built-in



**DN6HD\***  
600W No-Neutral  
Dimmer

\*Requires a MLWSB Decora Smart Wi-Fi Bridge to enable smart features

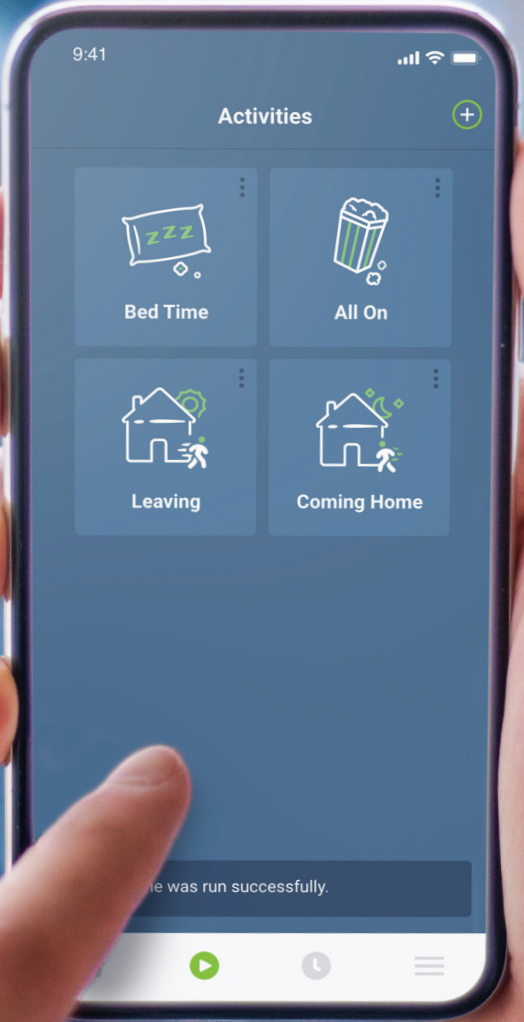

9:41



Activities



Bed Time



All On



Leaving



Coming Home

... was run successfully.







One-Touch Control

## Scenes and Activities

Set the perfect mood by easily capturing a scene for one-touch recall. Make sure all lights are off when leaving your home.

Multi-button control is perfect for entryways and bedrooms to control room scenes or whole house lighting activities with the press of a button.

- Replace an existing switch to add three scene control buttons and a built-in smart switch for connected lights
- Create scenes and activities to control Decora Smart Wi-Fi devices such as “All Off”, “Movie Time”, “Party Mode”, “Game Night”, and more with simple app configuration of button functions
- Use with an Apple Home Hub to control HomeKit scenes and accessories
- Use with IFTTT for expanded automation across 3rd party services
- Engraved buttons available in all 6 color options can be designed and ordered through the My Leviton app\*



### D2SCS

Decora Smart Wi-Fi Scene Controller Switch shown with optional engraved buttons\*

\*Custom engraved buttons are available in the U.S. only





Hands-Free Control

## Motion Controlled Lighting

The Motion Sensing Dimmer automatically turns connected lights on and off based on motion. At night, lights can be set to come on at a lower level, such as in a kitchen, or you can use the built-in Guide Light feature to provide soft illumination in the dark, perfect for bathrooms and walk-in closets.

- Motion control features are easily configured through the My Leviton app with no complex programming
- Full range dimming performance with custom settings for preset light levels, fade rates, and bulb types
- Supports both Occupancy and Vacancy modes of operation
- Use Room Occupancy Response to turn ON/OFF multiple Decora Smart Wi-Fi devices in a room based on motion
- Motion Snooze temporarily pauses motion detection for a selected amount of time
- Built-in ambient light sensing can prevent lights from turning on if there is already enough sunlight in the room



**D2MSD**  
Motion Sensing Dimmer







## Wired and Wire-Free Companions

# Control Where You Need It

Dimmer and Switch Companions are for use in 3-way or multi-way applications where the same set of lights are being controlled from two or more different locations such as the top and bottom of a staircase, a long hallway, or open areas with multiple entrances. Wired and wire-free options are available.

- Pair one or multiple wired or wire-free companions with a primary Decora Smart device such as a switch, dimmer, or fan speed controller
- No app required for installation
- Wired Companions can be used in areas where there is already 3-way wiring in place
- Wire-Free Anywhere Companions can be placed anywhere additional control is needed. They can also be used to control devices plugged into Wi-Fi plug-ins or outlets



**DD00R and DD0SR**  
Wired Dimmer and Switch Companions



**DAWDC and DAWSC**  
Wire-Free Anywhere Dimmer and Switch Companions

See chart on pages 14-15 for product compatibility

# Product Guide

Decora Smart products are designed, supported and engineered by Leviton in the USA.

## For newer homes with a neutral wire



	<b>DWVAA</b> Voice Dimmer with Amazon Alexa Built-in	<b>D26HD</b> 600W Dimmer (2nd Gen)	<b>D215S</b> 15A Switch (2nd Gen)	<b>D24SF</b> Fan Speed Controller (2nd Gen)	<b>D2MSD</b> Motion Sensing Dimmer (2nd Gen)	<b>D2SCS</b> Scene Controller Switch (2nd Gen)
Supported Loads	300W LED/CFL, 300W Incand/Halogen	300W LED/CFL, 600W Incand/Halogen, 600VA MLV	15A Gen Use, 5A LED/CFL/Electronic Ballast, 1500W Incand/Halogen, 15A Magnetic Ballast, 3/4 HP Motor	1.5A Fan	300W LED/CFL, 450W Incand/Halogen, 450VA MLV	15A Gen Use, 5A LED/CFL/Electronic Ballast, 1500W Incand/Halogen, 15A Magnetic Ballast, 3/4 HP Motor
Compatible Companion Devices	DD00R, DD0SR	DAWDC, DAWSC, DD00R, DD0SR	DAWSC, DD0SR	DAWDC, DAWSC, DD00R, DD0SR	DAWDC, DAWSC, DD00R, DD0SR	DAWSC, DD0SR

## Faceplate Color Change Kits for In-Wall Devices

Device Part #	Color Change Kit Part #
D26HD, DN6HD, D24SF	DDKIT
D215S, DN15S	DDKIT-S
D2SCS	DS4KT
D215R	DSRKT



White



Ivory



Light Almond



Gray



Black



Brown

### For older homes that may not have a neutral wire



	<b>DN6HD</b> 600W No-Neutral Dimmer	<b>DN15S</b> 15A No-Neutral Switch	<b>MLWSB</b> Wi-Fi Bridge
Supported Loads	300W LED/CFL, 600W Incand/Halogen, 600VA MLV	5A LED/CFL/Electronic Ballast, 1500W Incand/Halogen, 15A Magnetic Ballast, 3/4 HP Motor	Plug-in device does not control a load, but is required for use with DN6HD and DN15S
Compatible Companion Devices	DAWDC, DAWSC	DAWSC	-

### Plug load control for any home



	<b>D215R</b> 15A Outlet (2nd Gen)	<b>D23LP</b> Mini Plug-in Dimmer (2nd Gen)	<b>D215P</b> Mini Plug-in Switch (2nd Gen)
Supported Loads	5A LED/CFL, 1500W Incand/Halogen, 15A Magnetic Ballast, 3/4 HP Motor	100W LED/CFL, 300W Incand/Halogen	15A Gen Use, 5A LED/CFL/Electronic Ballast, 1500W Incand/Halogen, 15A Magnetic Ballast, 3/4 HP Motor
Compatible Companion Devices	DAWSC	DAWDC, DAWSC	DAWSC

**Not sure if you have a neutral wire or not?  
Scan for video on how to identify a neutral wire.**





**Leviton Manufacturing Co., Inc.**

Tech Line: 1-800-824-3005

Mon-Fri 8am-10pm EST, Saturday 9am-7pm EST, Sunday 9am-5pm EST

For 24/7 product support visit [www.leviton.com/support](http://www.leviton.com/support)

**Visit our Website at: [www.leviton.com/decorasmart](http://www.leviton.com/decorasmart)**

© 2022 Leviton Manufacturing Co., Inc. All rights reserved.

All trademarks are the property of their respective owners.



JA-031122  
REV MAY 22