

PARTS REQUIRED

Instructions	1
Blank cover plate with screws	1
Jumper wire	1

CONVERSION INSTRUCTIONS

This instruction manual describes the steps necessary to convert Mega Arm, Mega Arm Sprint, Mega Arm Tower, Mega Arm Sprint Tower, Mega Slide, Mega Slide X, and Mega Swing operators from 115Vac to 230Vac operation. Depending on the model, it may be necessary to temporarily remove some system components in order to access some components.

REWIRE SWITCH AND REMOVE OUTLET

1. Shut down the AC power to the operator at the main breaker.
2. Remove the cover of the operator.
3. Disconnect the batteries by removing the red wire from the positive battery terminal.
4. Verify that the power is off and the operator is completely disabled before proceeding.
5. Remove the cover plate for both the convenience outlet and the main AC power switch.
6. Remove the white wires from the convenience outlet and move them to the two available screws on the main AC switch through the knockouts of the single gang boxes (Figure 1).
7. Remove the black wire that connects the convenience outlet to the main AC switch (Figure 2).
8. Move the remaining black wire on the convenience outlet to the newly available screw on the main AC switch (Figure 2).
9. Remove the green ground wire between the convenience outlet and the chassis (Figure 3).

NOTE: For older models that do not have a line filter, the incoming green ground wire on the convenience outlet should be moved and secured to the chassis screw.

10. Discard the convenience outlet. Place all wires and the main AC switch within single gang box. Secure light switch cover and the blank cover plate (included).

NOTE: It is important to completely remove and discard this convenience outlet when the operator is converted to 230Vac operation. If 120Vac accessories (such as heaters) are used, they must be powered separately.

WARNING

To prevent possible **SERIOUS INJURY** or **DEATH** from electrocution, disconnect electric power to operator **BEFORE** installing.

ALL electrical connections **MUST** be made by a qualified individual.

FIGURE 1

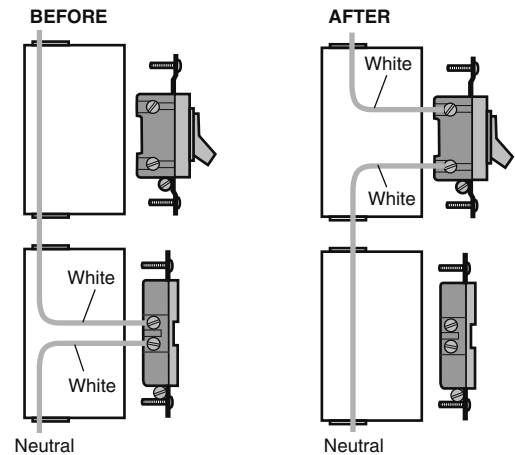

FIGURE 2

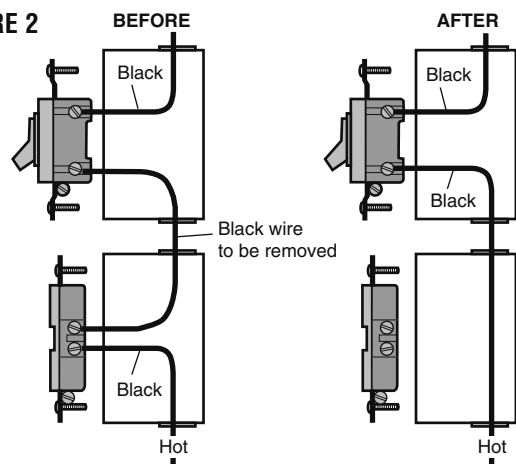
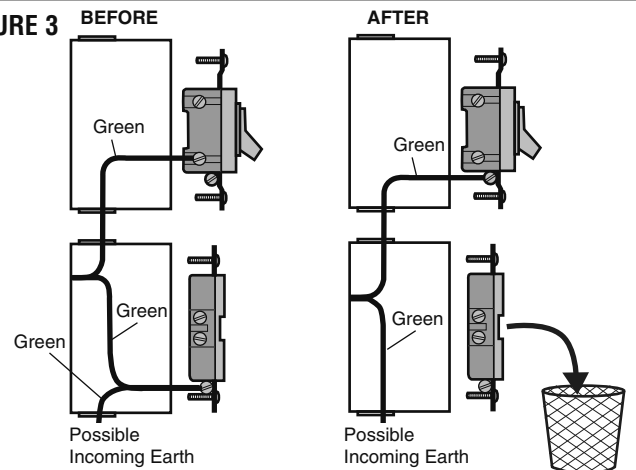

FIGURE 3



REWIRE THE TRANSFORMER

Slide and Swing Gate Operators (MSL, MSLX, MSW)

1. Move the black wire from the center terminal of the transformer to the end terminal of the transformer (Figure 4).

Barrier Gate Operators (MA, MAS, MAT, MAST)

1. Remove the black wire that connects terminals 2 and 6 on the transformer (Figure 5).
2. Remove the white wire that connects terminals 1 and 5 on the transformer (Figure 5).
3. Move the white wire from terminal 5 to terminal 1 on the transformer (Figure 5).
4. Using the included jumper wire, connect terminal 2 to terminal 5 on the transformer (Figure 5).

FINISHING UP

1. Remove tools and debris from the operator enclosure.
2. Turn the 230Vac power on to the unit. Flip the main AC switch to the "ON" position and verify the circuit board powers up.
3. Using a multi-meter set to Vac, measure approximately 24Vac at the input of the control board (J4-5, 6). If the voltage reads 12Vac or 0Vac, the transformer is incorrectly wired or a connection was not properly made to the switch.
4. Reconnect the batteries to the operator and make sure the operator opens and closes properly and that all safety devices are functioning properly.
5. Replace the cover of the operator.

If the operator fails to power up or operate correctly, contact technical support at 1-800-528-2806.

