

polk®

# OWNER'S MANUAL

GUIDE DU PROPRIÉTAIRE | MANUAL DEL PROPIETARIO

---

Signature Elite Series™

ES10, ES15, ES20, ES30, ES35, ES50, ES55, ES60



## CONTENTS

Safety Instructions.....	3
What's In The Box.....	4
How to Connect Your System.....	4
Signature Elite Series Speaker Positioning.....	5
Specifications .....	7

## EXPECT GREAT SOUND

Thank you for choosing the Polk Signature Elite Series of loudspeakers. This new line is bold, stylish and quality-built for performance. The high efficiency Signature Elite Series speakers feature Polk patented Dynamic Balance® tuned drivers and tweeters for clearer highs and more realistic mid-range. Power Port® technology creates bigger, more musical, deep bass impact. The Polk Signature Elite speakers are equipped with an expanded array of high performance state-of-the-art audio technologies that elevate home theater and music with incredible detail. And with their American modern styling, each speaker features gorgeous curves and aggressive accents that fits any décor. Pure and simple, the Polk Signature Elite Series speakers are American HiFi engineered and designed with your entertainment in mind.

Having built our reputation as "The Speaker Specialists" for more than 45 years, we take pride in our superior sound and build quality, which features many patented and award-winning audio innovations. For the people of Polk, building audio products is not just a job—it's a passion. And if you're going to remember one thing, remember this: We live by the truest principle of what audio should deliver—great sound at an affordable price for everyone!

## Technical Assistance or Service

Thank you for your Polk® purchase! If you have a question or comment, please feel free to contact us. Please visit [polk.custhelp.com](http://polk.custhelp.com) for support contact information.

## WARNING: Listen Carefully

Polk Audio loudspeakers and subwoofers are capable of playing at extremely high volume levels, which could cause serious or permanent hearing damage. Polk Audio, Inc. accepts no liability for hearing loss, bodily injury or property damage resulting from the misuse of its products. Keep these guidelines in mind and always use your own good judgment when controlling volume:

- Limit prolonged exposure to volumes that exceed 85 decibels (dB). For more about safe volume levels, go to the Occupational Health and Safety Administration (OSHA) guidelines at <http://www.osha.gov/>

## Product Disposal

Certain international, national and/or local laws and/or regulations may apply regarding the disposal of this product. For more information, please contact the retailer where you purchased this product or the Polk Importer/Distributor in your country. More information is also available at [www.polkaudio.com](http://www.polkaudio.com) or by contacting Polk Audio at 5541 Fermi Court, Carlsbad, California 92008, USA. Phone: 1-800-377-7655.

This symbol on our electrical products or their packaging indicates that it is forbidden in Europe to discard the product in question as domestic waste. In order to ensure that you dispose of the products correctly, please dispose of the products according to local laws and regulations on the disposal of electrical and electronic equipment. In doing so you are contributing to the retention of natural resources and to the promotion of environmental protection by the treatment and disposal of electronic waste.



**IMPORTANT SAFETY INSTRUCTIONS**

1. Read these instructions.
2. Keep these instructions.
3. Heed all warnings.
4. Follow all instructions.
5. Do not use this apparatus near water.
6. Clean only with dry cloth.
7. Do not block any ventilation openings. Install in accordance with the manufacturer's instructions.
8. Do not install near any heat sources such as radiators, heat registers, stoves, or other apparatus (including amplifiers) that produce heat.
9. Only use attachments/accessories specified by the manufacturer.
10. Use only with the cart, stand, tripod, bracket, or table specified by the manufacturer, or sold with the apparatus. When a cart is used, use caution when moving the cart/apparatus combination to avoid injury from tip-over. 
11. Refer all servicing to qualified service personnel. Servicing is required when the apparatus has been damaged in any way, such as power supply cord or plug is damaged, liquid has been spilled, or objects have fallen into the apparatus, the apparatus has been exposed to rain or moisture, does not operate normally, or has been dropped.

**Notes On Use****WARNINGS**

- Avoid high temperatures. Allow for sufficient heat dispersion when installed in a rack.
- Keep the unit free from moisture, water, and dust.
- Do not obstruct the ventilation holes.
- Do not let foreign objects into the unit.
- Do not let insecticides, benzene, and thinner come in contact with the unit.
- Never disassemble or modify the unit in any way.
- Ventilation should not be impeded by covering the ventilation openings with items, such as newspapers, tablecloths or curtains.
- Naked flame sources such as lighted candles should not be placed on the unit.

- Do not expose the unit to dripping or splashing fluids.
- Do not place objects filled with liquids, such as vases, on the unit.

**A Note About Recycling:**

This product's packaging materials are recyclable and can be reused. Please dispose of any materials in accordance with the local recycling regulations. When discarding the unit, comply with local rules or regulations.

**EU Declaration of Conformity**

Hereby, Sound United, LLC declares that our product is in compliance with the following EU/EC Directives:

- RoHS: 2011/65/EU and amendment Directive (EU) 2015/863

5541 Fermi Court  
Carlsbad, CA 92008

EU contact:  
Sound United Europe,  
A division of D&M Europe B.V.  
Beemdstraat 11,  
5653 MA Eindhoven,  
The Netherlands

**UKCA Declaration of Conformity**

Hereby, Sound United, LLC declares that our product is in compliance with the following UK regulations.

- The Restriction of the Use of Certain Hazardous Substances in Electrical and Electronic Equipment Regulations 2012

UK importer: D&M Audiovisual Ltd  
Cells 1 & 2 Kopshop  
6 Old London Road  
Kingston Upon Thames  
KT2 6QF UK



## WHAT'S IN THE BOX

Each box contains:

1. Loudspeaker(s)
2. Owner's manual
3. Registration card
4. Adhesive-backed rubber pads (eight for bookshelf speakers or four for center channel speakers)
5. Wall mount template (for ES35, ES15 and ES10 only)  
(Speaker cable not included)

## HOW TO CONNECT YOUR SYSTEM

To get the best sound quality, it's important to wire your speakers correctly.

### Wire Preparation

Follow the hookup directions included with your receiver/ amplifier. Strip 1/2" (12.7mm) of insulation from each of the two conductors of the wire to expose the bare metal and twist each of the individual conductors into single unfrayed strands. Note that one of the terminals on the rear of each speaker is red (+) and the other is black (-). Make certain that you connect the wire from the positive (+) terminal of your amplifier or receiver to the red (+) terminal on your speaker and the wire from the negative (-) terminal of your amplifier or receiver to the black (-) terminal on your speaker. Most wire has some indicator (such as color-coding, ribbing or writing) on one of the two conductors to help you maintain consistency.

These recommendations are for all connections from the amplifier/receiver to each speaker:

Runs	Gauge	mm <sup>2</sup>
Lengths up to 25' (5 m)	16 or better	1,5 or better
Lengths greater than 25' (5 m) but less than 50' (15 m)	14	2,5 or better
Lengths greater than 50' (15 m) but less than 75' (25 m)	12	4,0 or better
Lengths greater than 75' (25 m)	10	6,0 or better

### Binding Posts

To connect wire to the binding post, unscrew the binding post cap and insert the bare wire into the hole near the base of the binding post. Do not insert the insulated part of the wire into the hole as this will not give you a good connection. Tighten the binding post cap until it seats firmly with the wire, but do not over tighten.

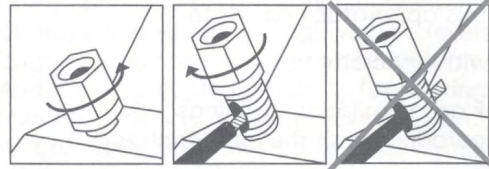

### Connectors

You have several options when choosing connectors for your speaker wires, and it's really a matter of personal preference. Three of the more commonly used are banana plugs, spade lugs and bare wire. If you know where you want to locate your speakers and plan to set up your system and leave them there, then bare wire will work fine. Just make sure there are not stray strands of wire that could come into contact. If you like to experiment with different speaker locations, spade lugs or banana plugs offer more convenient options when it comes to disconnecting and reconnecting wires.

### Banana Plugs

Signature Elite binding posts have openings in the ends of their caps to accept individual and dual banana plugs. To use banana plugs, carefully pry out the binding post plugs to expose banana plug holes. The binding posts can accept dual banana plugs.

### Basic Tower, Center, Bookshelf and Satellite Surround Speaker Hookup (ES60, ES55, ES50, ES35, ES30, ES20, ES15, ES10)

Make sure that the red (+) and black (-) connectors on your amplifier or receiver connect to the red (+) and black (-) connectors on your speakers. If your speakers sound "thin," with little bass and little or no center image, odds are that one of the speaker wires is connected backwards. Double check all connections.

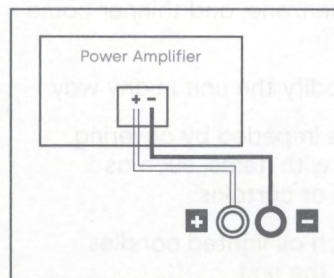



**Bi-Wiring** (ES60, ES55 and ES50 Towers)

Bi-wiring can provide noticeable improvements in the overall transparency of your loudspeakers. After removing the jumpers, run separate speaker wires to the low and high frequency drivers from a single amplifier (the upper set of binding posts are for the high frequency drivers, the lower set of binding posts are for the low frequency drivers). Connect one set of speaker wires to the upper terminals on each speaker and one set of wires to the lower terminals. Connect the other ends of both wire sets to the same amplifier outputs. See Amplifier/AVR's user manual for configuration instructions.

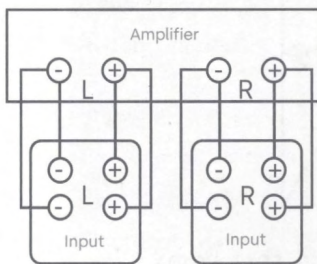
**Bi-Amping** (ES60, ES55 and ES50 Towers)

Bi-amping allows you to use separate amplifiers for the high and low frequency sections of your loudspeaker for greater dynamic range and lower distortion. We recommend that your separate amplifiers have identical gain to preserve the speaker's voicing balance. After removing the jumpers, connect the speaker wires from the high frequency amplifier outputs to the upper set of terminal posts on each speaker. Follow the same procedure for connecting the low frequency amplifier outputs to the lower set of terminals. Remember to maintain correct wiring polarity (+ to +, - to -) in all connections. See Amplifier/AVR's user manual for configuration instructions.

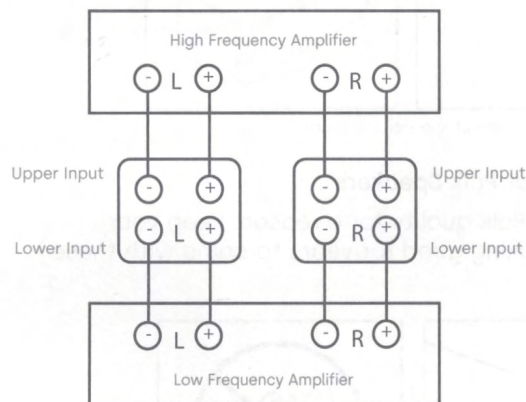
**Placement Recommendations for the ES35 and ES30 Center Channel Speaker**

The most popular placement for your ES35 or ES30 center channel speaker is on a shelf below your flat screen TV (if you have an older box TV, a popular option is to place your center channel speaker on top of it, anchoring the dialogue and effects to the screen). Note: For older TV's, the ES35 and ES30 are NOT magnetically shielded.

Also compatible as a left, center or right speaker (L/C/R), the ES35 center channel speaker includes built in keyhole slots for easy wall-mounting (see instructions on wall mount template for more information).

**Processor Mode**

Note: Set these speakers (ES35, ES30, ES20, ES15, ES10) to "small" in your receiver's Bass Management Settings. Set to "large" for tower speakers (ES60, ES55, ES50).

The "bass management" or "speaker configuration" menus of most surround receivers offer the choice of "normal" or "wide" modes for smaller speaker operation. In discrete channel digital processors, these modes are referred to as "small" and "large." Normal (small) mode filters bass frequencies from center channel, bookshelf and satellite surround speakers, and sends them instead to the front left and right main speakers or to the subwoofer output (LFE) jack. Wide (large) mode sends an unfiltered, full-range signal to these speakers. Use the Small (normal) mode for optimum center and surround channel performance and reliability.

**SIGNATURE ELITE SERIES SPEAKER POSITIONING**

To maximize the sound quality of your speaker system—whether you've purchased tower speakers, a center channel speaker, bookshelf speakers, or satellite surround speakers—correct placement is everything. Take a look at the following examples and give them a try based on the Signature Elite Series speakers you've purchased.

Note: Your Signature Elite Series speakers are compatible with 2.0, 2.1, 3.1, 5.1, 7.1 and 9.1 setups (optional subwoofer shown in graphics).



### Listening in 2.1 System

Get the most realistic stereo image by placing speakers as far apart as the listeners are sitting from them. If room conditions require that you place the speakers farther apart, you may choose to angle the speakers toward the middle to support a more solid center image.

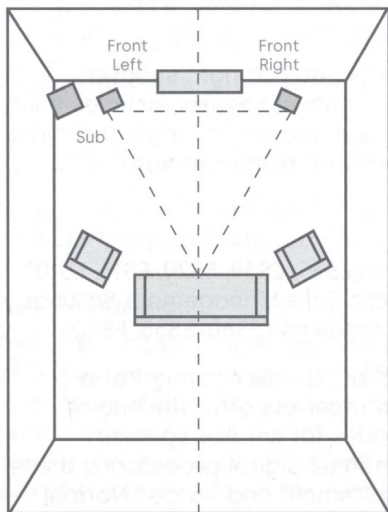

### Listening in 5.1 Surround

You can use the Signature Elite Series speakers as rear surround speakers in a Polk Audio home theater surround system. Ideal rear channel surround speaker placement is on a side wall, slightly behind and above the listening position.

Note: If you cannot place rear surrounds on the side walls, position them on the rear wall above the listening position.

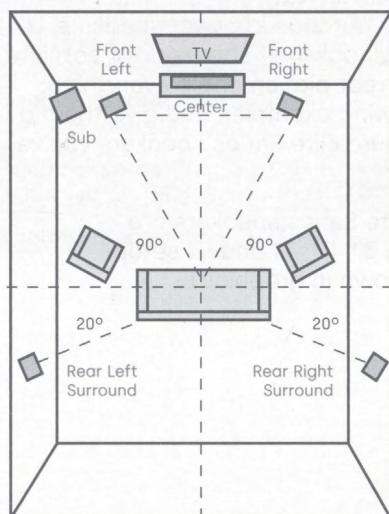

### Listening in 7.1 Surround

Enjoy added depth to your surround sound experience with four rear surround speakers instead of two.

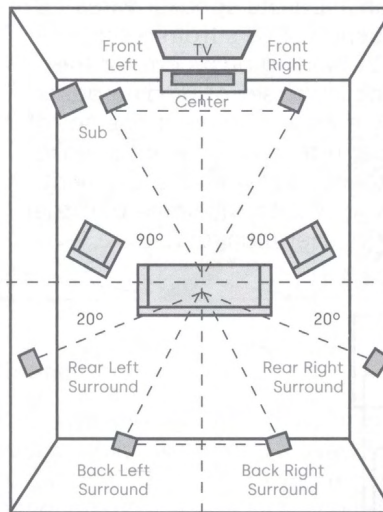

### Wall Mountable Speakers (ES35, ES15, ES10)

These speakers feature built-in keyhole slots and a threaded screw insert (ES10 only) for easy wall mounting. Use included wall mount template to safely wall mount these speakers.

### Adding Adhesive-Backed Rubber Feet (ES30, ES35, ES20, ES15, ES10)

To keep your Signature Elite Series speakers firmly in place and prevent damage to floors or furniture, it's a smart idea to attach the included adhesive-backed rubber feet to the bottom of your speaker.

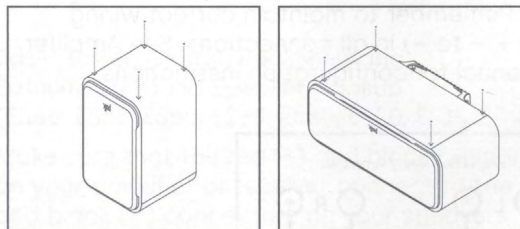

Peel and stick in corners of speaker enclosure

### Cleaning Your Polk Speakers

You bought Polk quality for a reason. Keep your speakers looking good for years to come with these simple tips.

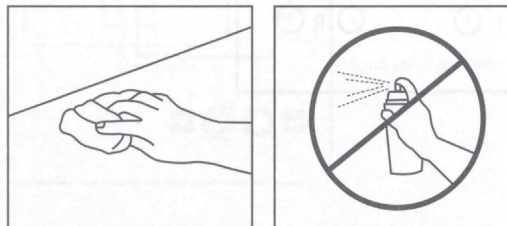

Clean cabinet with a damp cloth. Do not use furniture polish on veneer.



Signature Elite Series Specifications			
	ES60	ES55	ES50
	Full Range Passive Floorstanding Loudspeaker	Full Range Passive Floorstanding Loudspeaker	Full Range Passive Floorstanding Loudspeaker
<b>Transducers</b>			
Tweeter	1—1 in Terylene High-Res Dome Tweeter	1—1 in Terylene High-Res Dome Tweeter	1—1 in Terylene High-Res Dome Tweeter
Mid-Bass Woofers	3—6.5 in Dynamic Balance Mica Reinforced Polypropylene Drivers	2—6.5 in Dynamic Balance Mica Reinforced Polypropylene Drivers	2—5.25 in Dynamic Balance Mica Reinforced Polypropylene Drivers
Crossover Frequency	2.0 kHz	2.4 kHz	2.3 kHz
<b>General</b>			
Recommended Amplification (wpc)	50–300	40–200	40–200
Impedance	Compatible with 8Ω AV Receivers and Amplifiers		
Overall Frequency Response	32 Hz–40 kHz	34 Hz–40 kHz	38 Hz–40 kHz
Sensitivity (2.83V/1m)	90 dB	89 dB	88 dB
Electrical Inputs	Dual gold-plated 5-way binding posts	Dual gold-plated 5-way binding posts	Dual gold-plated 5-way binding posts
<b>Weights and Dimensions</b>			
Height (inches)	44.5	41.5	37.4
Width (inches)	8.5	8.5	7.5
Depth (inches)	15.7	12.3	10.9
Width including feet (inches)	11.7	11.7	10.3
Weight	52 lbs.	44 lbs.	32 lbs.



Signature Elite Series Specifications					
	ES35	ES30	ES20	ES15	ES10
	Left/Center/Right (L/C/R) Loudspeaker	Dedicated Center Center Loudspeaker	Full Range Passive Bookshelf Loudspeaker	Full Range Passive Bookshelf Loudspeaker	Uni-Pole Surround Loudspeaker
<b>Transducers</b>					
Tweeter	1—1 in Terylene High-Res Dome Tweeter	1—1 in Terylene High-Res Dome Tweeter	1—1 in Terylene High-Res Dome Tweeter	1—1 in Terylene High-Res Dome Tweeter	1—1 in Terylene High-Res Dome Tweeter
Mid-Bass Woofer	6—3 in Dynamic Balance Mica Reinforced Polypropylene Drivers	2—5.25 in Dynamic Balance Mica Reinforced Polypropylene Drivers	1—6.5 in Dynamic Balance Mica Reinforced Polypropylene Driver	1—5.25 in Dynamic Balance Mica Reinforced Polypropylene Driver	1—4 in Dynamic Balance Mica Reinforced Polypropylene Driver
Crossover Frequency	2.7 kHz	2.8 kHz	2.4 kHz	2.4 kHz	2.1 kHz
Wall Mounting Option—Key Hole slot	Yes	No	No	Yes	Yes
Wall Mounting Option—1/4"-20 Threaded Insert	No	No	No	No	Yes
<b>General</b>					
Recommended Amplification (wpc)	20—150	20—125	20—125	20—100	20—100
Impedance	Compatible with 8Ω AV Receivers and Amplifiers				
Overall Frequency Response	66 Hz—40 kHz	55 Hz—40 kHz	41 Hz—40 kHz	44 Hz—40 kHz	78 Hz—40 kHz
Sensitivity	89 dB	89 dB	86 dB	85 dB	84 dB
Electrical Inputs	Single gold-plated 5-way binding posts	Single gold-plated 5-way binding posts	Single gold-plated 5-way binding posts	Single gold-plated 5-way binding posts	Single gold-plated 5-way binding posts
<b>Weights and Dimensions</b>					
Height (inches)	4.1	7.5	14.8	12	8.4
Width (inches)	24.4	20	8.5	7.5	5.4
Depth (inches)	6.1	10.6	13.8	10.2	6.1
Weight	14 lbs	19 lbs	17 lbs	13 lbs	6 lbs



## LIMITED 5-YEAR WARRANTY

Polk Audio, Inc. warrants to the original purchaser only that this Polk Audio Loudspeaker Product (the "Product") will be free from defects in materials and workmanship for a period of five (5) years from the date of original retail purchase from a Polk Audio Authorized Dealer. However, this Warranty will automatically terminate prior to the expiration of the five (5) years if the original retail purchaser sells or otherwise transfers the Product to any other party. The original retail purchaser shall hereinafter be referred to as "you." To allow Polk Audio to offer the best possible warranty service, please fill out the Product Registration Card(s) and send it to the Factory, at the address provided on the Product Cards(s) within ten (10) days of the date of purchase.

Defective Products must be shipped, together with proof of purchase, prepaid insured to the Polk Audio Authorized Dealer from whom you purchased the Product, or an authorized service center. Products must be shipped in the original shipping container or its equivalent; in any case the risk of loss or damage in transit is to be borne by you. If upon examination at the Factory or Polk Audio Authorized Dealer it is determined that the unit was defective in materials or workmanship at any time during this Warranty period, Polk Audio or the Polk Audio Authorized Dealer will, at its option, repair or replace this Product at no additional charge, except as set forth below. All replaced parts and Products become the property of Polk Audio. Products replaced or repaired under this warranty will be returned to you, within a reasonable time, freight prepaid.

This warranty does not include service or parts to repair damage caused by accident, disaster, misuse, abuse, negligence, inadequate packing or shipping procedures, commercial use, voltage inputs in excess of the rated maximum of the unit, cosmetic appearance of cabinetry not directly attributable to defect in materials or workmanship, or service, repair, or modification of the Product which has not been authorized or approved by Polk Audio. This warranty shall terminate if the Serial number on the Product has been removed, tampered with or defaced. This warranty is in lieu of all other expressed Warranties. If this Product is defective in materials or workmanship as warranted above, your sole remedy shall be repair or replacement as provided above. In no event will Polk Audio, Inc. be liable to you for any incidental or consequential damages arising out of the use or inability to use the Product, even if Polk Audio, Inc. or a Polk Audio Authorized Dealer has been advised of the possibility of such damages, or for any claim by any other party. Some states do not allow the exclusion or limitation of consequential damages, so the above limitation and exclusion may not apply to you. All implied warranties on this Product are limited to the

duration of this expressed Warranty. Some states do not allow limitation on how long an implied Warranty lasts, so the above limitations may not apply to you. This Warranty gives you specific legal rights, and you also may have other rights which vary from state to state.

This Warranty applies only to Products purchased in the United States of America, its possessions, and U.S. and NATO armed forces exchanges. The Warranty terms and conditions applicable to Products purchased in other countries are available from the Polk Audio Authorized Distributors in such countries.

Polk Audio, Polk, Power Port and Dynamic Balance are registered trademarks of Polk Audio, LLC. All other trademarks are the property of their respective owners.

Designed and Engineered in U.S.A. Made in China.



**polk**

5541 Fermi Court  
Carlsbad, CA 92008  
800-638-7276

[www.polkaudio.com](http://www.polkaudio.com)

email: [polkes@polkaudio.com](mailto:polkes@polkaudio.com)  
twitter: @polkaudio

HBP4490R02



polk

# SIGNATURE ELITE ES10™

AMERICAN HI-FI

## WALL MOUNT TEMPLATE MODÈLE POUR MONTAGE MURAL



**NOTE: FOR BEST RESULTS USE A LEVEL**  
*REMARQUE : POUR OBTENIR DE MEILLEURS  
RÉSULTATS, UTILISEZ UN NIVEAU*

**WARNING! DO NOT MOUNT ON CEILING**  
*AVERTISSEMENT ! NE PAS FIXER AU PLAFOND*

212.7"  
8.38mm

7.85"  
199.4mm

CENTER OF SPEAKER  
CENTRE DE L'ENCEINTE

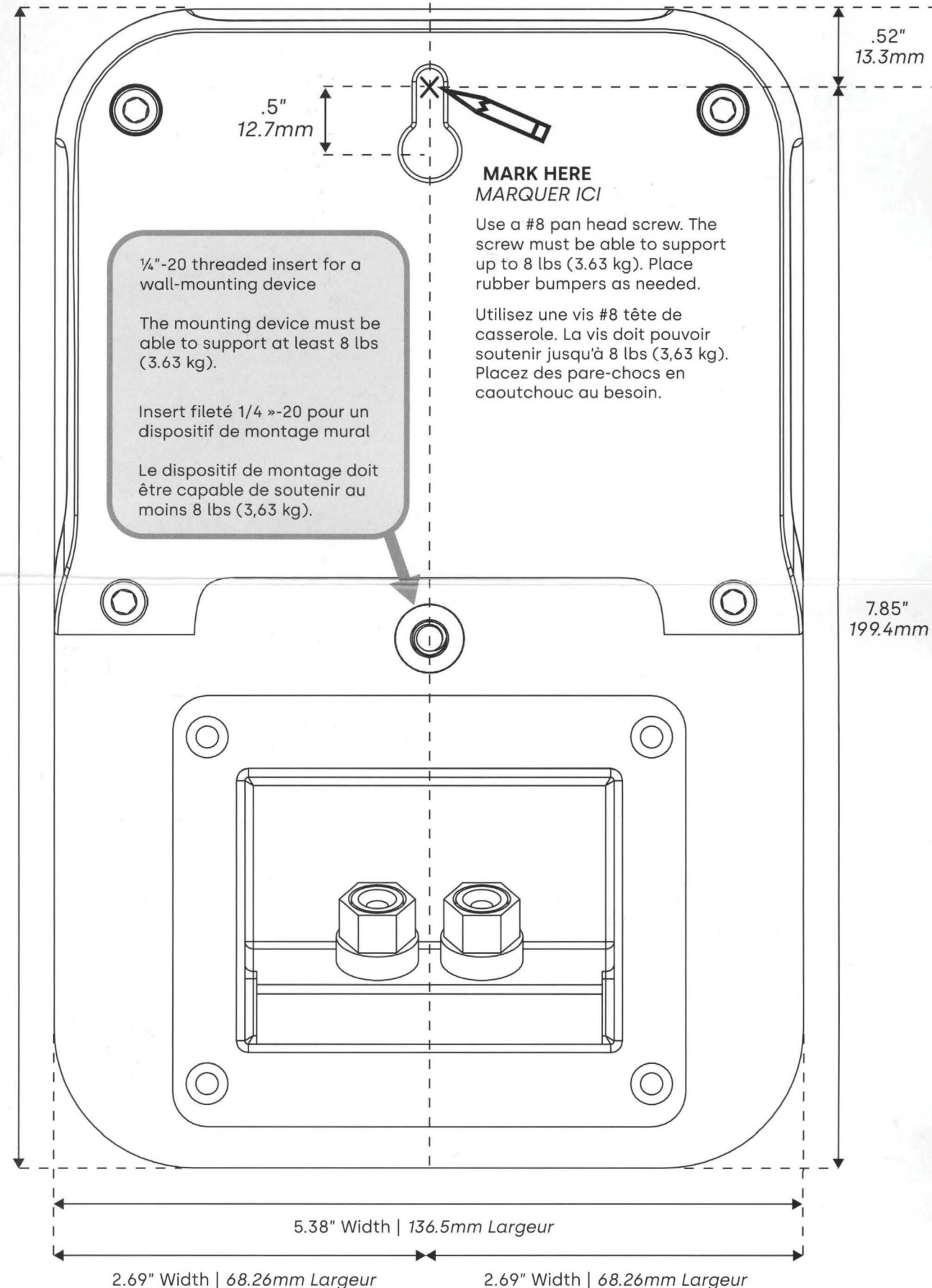



polk®

# SIGNATURE ELITE

ES10 SURROUND LOUDSPEAKERS

Compact Satellite Surround Loudspeakers For Home Theater



**POLK. EXPECT GREAT SOUND.®**

[www.polkaudio.com](http://www.polkaudio.com)





# ES10 SURROUND SPEAKERS



## Signature Elite ES10 Compact High-Resolution Satellite Surround Speakers for Home Theaters

High-performance compact loudspeakers for High-Resolution Audio Certified cinematic surround sound.

### SPECIFICATIONS

<b>Tweeter</b>	1"/2.54cm high-resolution Terylene dome tweeter
<b>Mid-Bass</b>	4"/10.16cm low distortion mica-fortified polypropylene drivers
<b>Crossover Frequency</b>	2.5kHz
<b>Recommended Amplification (wpc)</b>	20–100W
<b>Impedance</b>	Compatible with 4- and 8-ohm outputs
<b>Overall Frequency Response</b>	75Hz–40kHz
<b>Sensitivity</b>	87dB
<b>Inputs</b>	Single gold-plated five-way binding posts
<b>Wall Mounting Option</b>	Keyhole slot and 1/4"-20 threaded insert
<b>Dimensions and Weight</b>	(W)13.7cm x (H)21.3cm x (D)15.5cm (W)5.4" x (H)8.4" x (D)6.1" 6lbs/2.7kg

### Consumer Benefits

#### Make Your Entire Home Theater the Sweet Spot

Whether you use ES10 as side, rear, or elevation surround speakers (or all three), you'll experience a seamless, lifelike soundstage no matter where you're seated thanks to Signature Elite ES10's Dynamically Balanced acoustic array with phase-optimized precision crossovers and timbre-matched components.

#### Hear More Detail in Music and Movies You Love

ES10's Hi-Res Audio Certified, Terylene dome tweeter provides crystalline highs (40kHz+) ideal for high-resolution sound found in ultra-HD movies, multi-channel concert videos, and spatial audio mixed for Apple Music, Dolby Atmos or DTS:X.

#### Experience Full-Range Surround Sound with Polk Power Port

A common shortcoming of conventional satellite and elevation speakers is thin sound. We take your home theater experience seriously and have put the same Polk-patented Power Port bass-enhancing technology in the ES10 that you will find in Signature Elite's top-of-the-line SE60 floor-standing tower loudspeakers. Now in movies, when rockets fly overhead or special effects swirl around the room, you'll not only hear it, but feel it too.

#### High Sensitivity for Maximum Compatibility

With high sensitivity and 4- and 8-ohm compatibility, the ES10 delivers spacious, clear, enveloping and realistic sound reproduction from nearly any amplifier or receiver—including the latest Dolby Atmos and DTS:X surround sound AVRs.

### Features

- Premium Hi-Fi Home Theater Surround/Satellite/Height Loudspeaker
- Powerful and Immersive Hi-Res Audio for Movies, TV, Games and Spatial Music
- Polk Dynamically Balanced Acoustic Array with Precision Crossovers for a Spacious, Lifelike Soundstage
- 1" High-Resolution Terylene Tweeter for Crystalline High Frequencies (40kHz+)
- 4" Mica-Fortified Polypropylene Woofer for Articulate and Dynamic Mids and Bass
- Patented Polk Power Port Technology for Effortless Bass (<75Hz)
- High-Sensitivity for Compatibility with Most Amplifiers and AV Receivers (4Ω & 8Ω)
- High-Resolution Audio Certified and Dolby Atmos and DTS:X Compatible
- Easy Wall Mounting Via Built-In Threaded Screw Inserts and Keyhole Slots
- Gold-Plated Binding Posts, Damped Cabinet and Anti-Diffraction Grille for Pure Sound
- Patented Quality Testing Process Backed by a Limited Five-Year Warranty
- Culmination of Five Decades of American Loudspeaker Engineering (Est. 1972)
- Sold in pairs







Register your new Polk product online:

**[www.polkaudio.com/registration/](http://www.polkaudio.com/registration/)**

Registering your product creates a permanent record of your purchase and ensures you are notified of important product information and updates.

We take privacy seriously and do not share or sell registration information (see privacy policy for more details):

**[www.polkaudio.com/privacy-policy](http://www.polkaudio.com/privacy-policy)**

Need help registering your product or just have questions?

Visit our support page and FAQs:

**<https://polk.custhelp.com/>**



MODEL SIGNATURE ELITE ES10  
SERIAL PBKN062101485





Enregistrez en ligne votre nouveau produit Polk :

**[www.polkaudio.com/registration/](http://www.polkaudio.com/registration/)**

L'enregistrement de votre produit crée un enregistrement permanent de votre achat et garantit que vous êtes informé des informations importantes et des mises à jour du produit.

Nous prenons très au sérieux la confidentialité et nous ne partageons pas les données d'enregistrement (voir la politique de confidentialité pour plus de détails) :

**[www.polkaudio.com/privacy-policy](http://www.polkaudio.com/privacy-policy)**

Vous avez besoin d'aide pour enregistrer votre produit ou vous avez des questions?

Visitez notre page d'assistance et notre FAQ:

**<https://polk.custhelp.com/>**