

Unscreened High-Density MT-Series Keystone Jacks

INSTALLATION INSTRUCTIONS

The following installation instructions are intended to be used when installing the following Signamax connecting hardware:

- KJ458MT-C6AC-xx (xx: WH, BK, BU, GN, GY, OR, RD, YE)
- KJ458MT-C6C-xx (xx: WH, BK, BU, GN, GY, OR, RD, YE)
- KJ458MT-C5E-xx (xx: WH, BK, BU, GN, GY, OR, RD, YE)
- KJ126MT-C3U-xx (xx: WH, BK, BU, GN, GY, OR, RD, YE)

NOTES:

1. Keystone jacks shown in these instructions used for example purposes only; actual product may be slightly different in dimensions and design details.
2. Pictures of tools other than KJMT-8600 used for example purposes only; actual tools may differ from those shown.

- 1** Make sure you have all necessary tools for that job:
1. Electrician's scissors (or other cable cutting tool)
 2. Cable jacket stripping tool
 3. Standard 110 single-position termination tool
 4. KJMT-8600 four-pair termination tool

If you are using a 110 single-position termination tool, proceed to and complete steps:

- 2 3 4 9**

If you are using a KJMT-8600 termination tool, proceed to and complete steps:

- 2 3 5 6 7 8 9**



- 2** Strip back at least 25 mm (1 in) of cable jacket (the more, the easier that will be to handle the conductors).

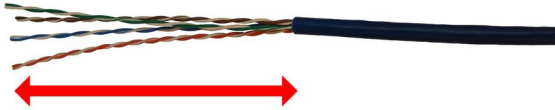

- 5** Open the KJMT-8600 shifting the lock into OPEN position **1**.



When not used, the tool may be stowed again by clamping the handles and pushing the lock into LOCK position **2**.

- 3** Place cable conductors into corresponding keystone module's contact slots **1** according to required wiring scheme (follow wiring scheme label **2** on module's back).

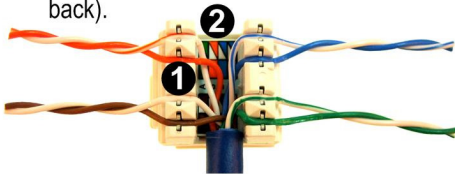

- 6** Insert the keystone jack into the KJMT-8600 receptacle with its 110 IDC contacts **1** facing up toward corresponding tool's termination forks **2**, and jack's latch **3** facing outward. In order to facilitate the process, the excess of twisted-pair conductors may be either cut off before insertion, or guided into the tool's opening **4**.

Align two jack's guides located on its sides **5** with corresponding tool's guides. Push the jack into the receptacle up to the stop. Finally, the jack's 110 IDC contacts shall be located exactly under the tool's corresponding termination forks **6**.

- 4** Terminate cable conductors **1** using a 110 termination tool equipped with a cutting blade to trim excess conductors **2**.

Signamax recommends using a keystone jack termination fixture (PN KJ-TF) **3** when terminating with a 110 single-position tool.

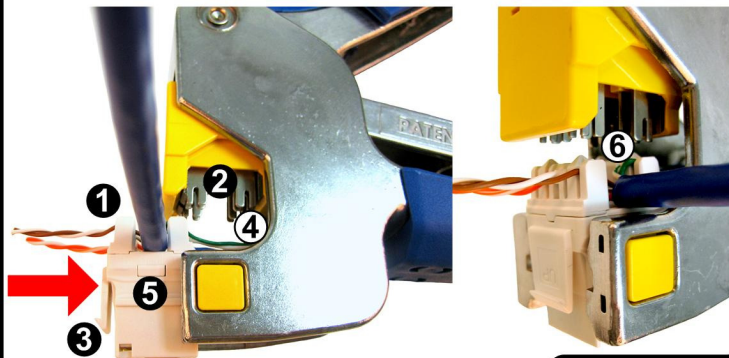
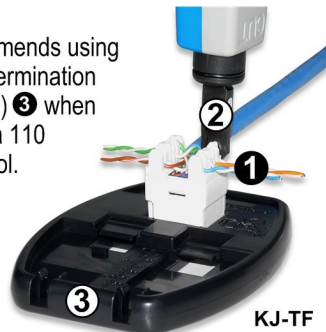

Continued on other side

Unscreened High-Density MT-Series Keystone Jacks

INSTALLATION INSTRUCTIONS

7 Start clasping the tool's handles making sure that the termination forks are aligned with with the corresponding 110 IDC contact slots on the jack **1**. Keep clasping the tool's handles up to the stop. Twisted-pair conductor excess will be trimmed before the stop **2**. Do not force the handles further beyond that point.



8 Remove the jack from the tool's receptacle. Visually inspect the proper position of all conductors in the 110 IDC contacts - they should sit at the same levels and there should be no conductor bends or kinks in the contact area. All conductor excess should be trimmed flush with the surface of the 110 IDC contact plastic block.

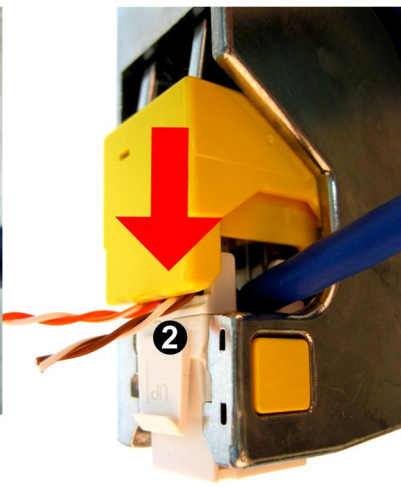
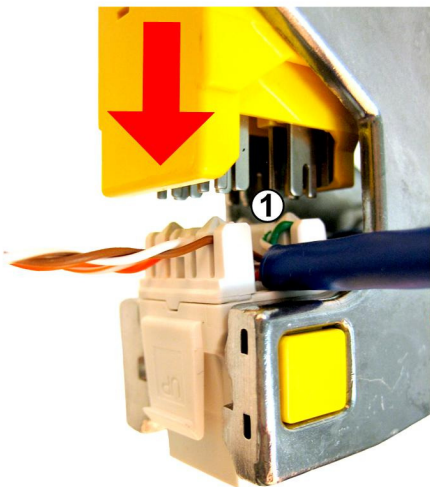
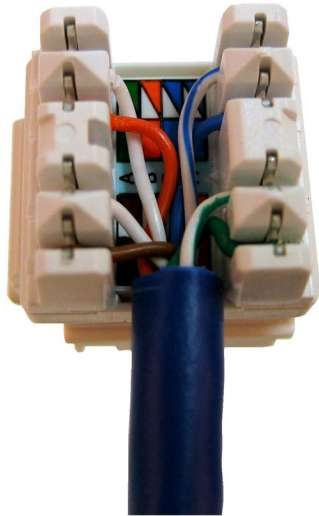

9 Place protection cap on module and press firmly to make sure it is fully seated. Install module in planned position in patch panel or work area outlet according to installation instructions provided for those products.

