

## Single Presenter

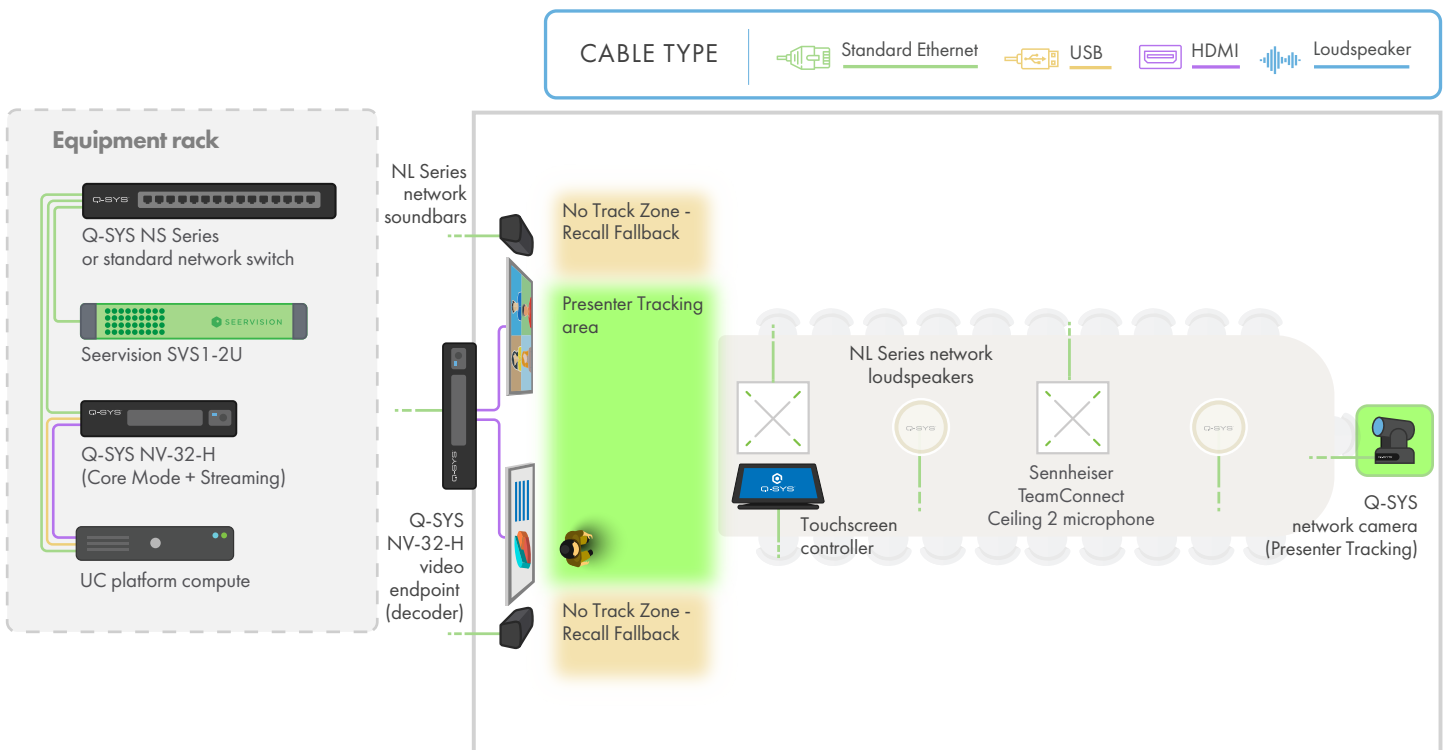

Diagram example: Boardroom



## User Experience

- Presenter camera starts in a user-defined default position and automatically tracks presenter in "Presenter Tracking area"
- When presenter leaves "Presenter Tracking area", Presenter camera moves to user-defined fallback position (such as wide view of room)

# Single Presenter + Static View

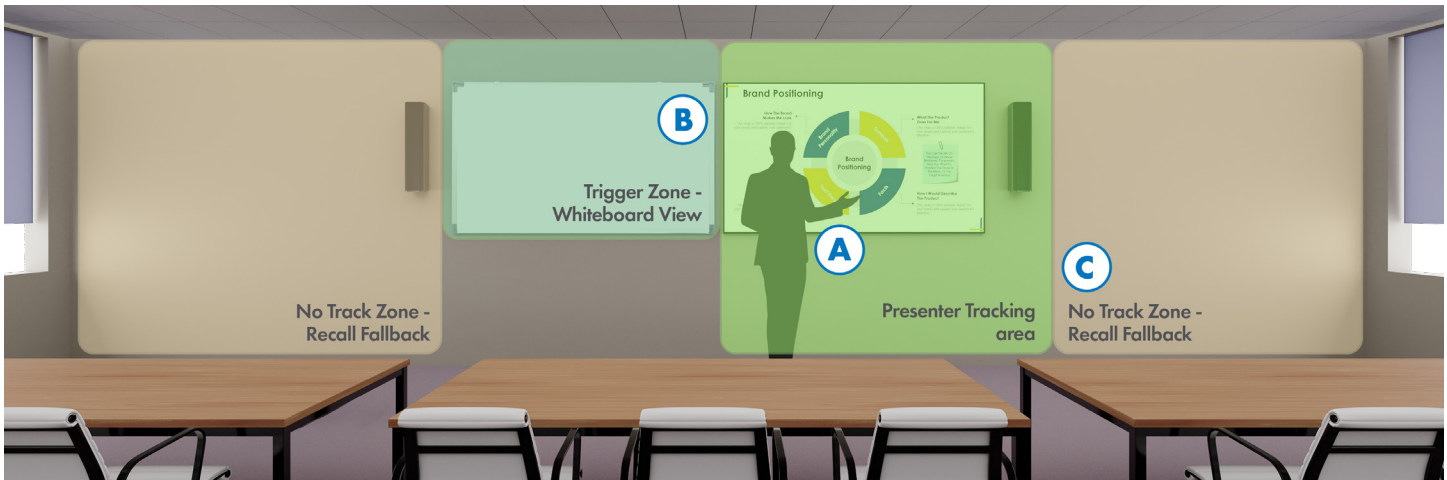
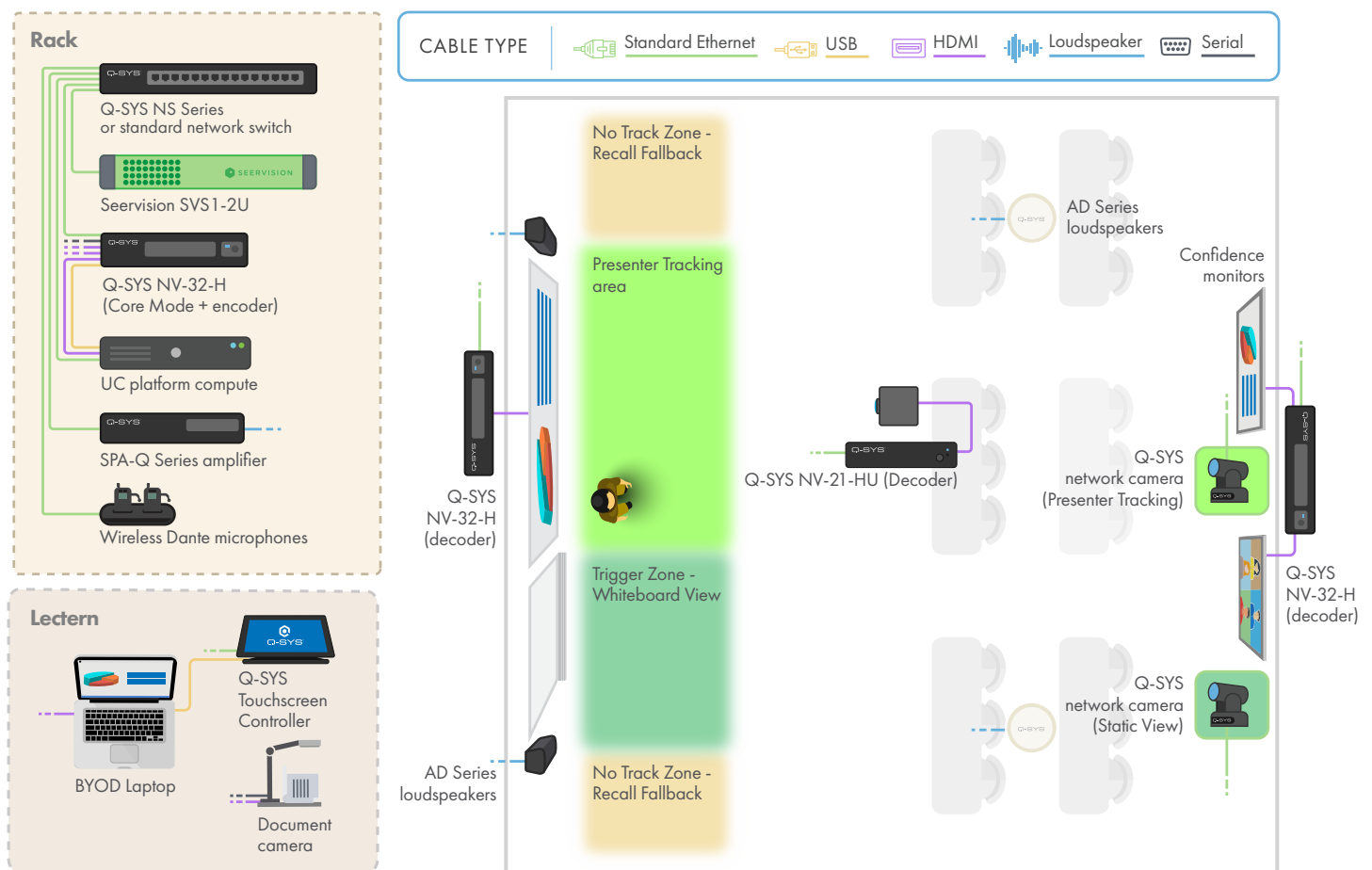

Diagram example: Training Room/Classroom



## User Experience

- Presenter camera starts in a user-defined default position and automatically tracks presenter in "Presenter Tracking area"
- Static View camera provides a cropped, stationary view of whiteboard when presenter enters "Trigger Zone – Whiteboard View"
- If there is no presenter in "Presenter Tracking area" or "Trigger Zone – Whiteboard View", Presenter camera returns to user-defined fallback position (such as wide view of room)

# Single Presenter + Static View + ACPR

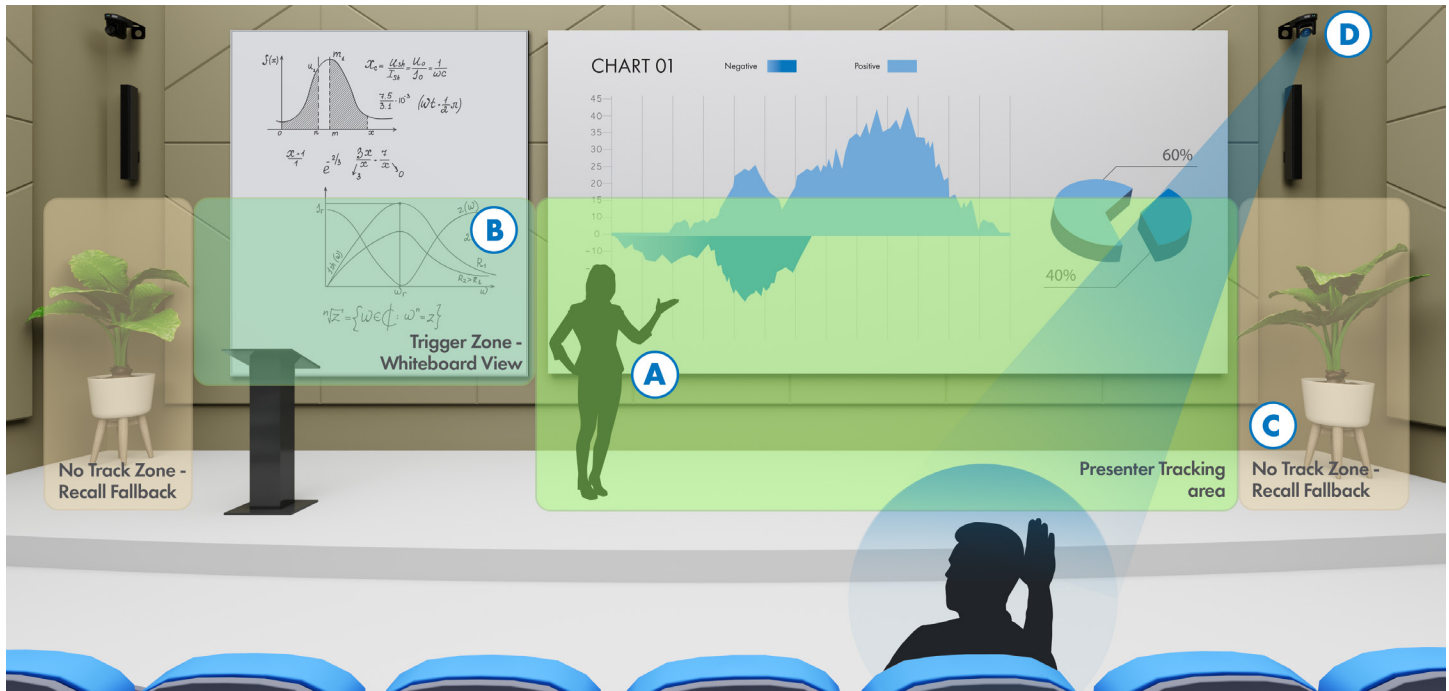
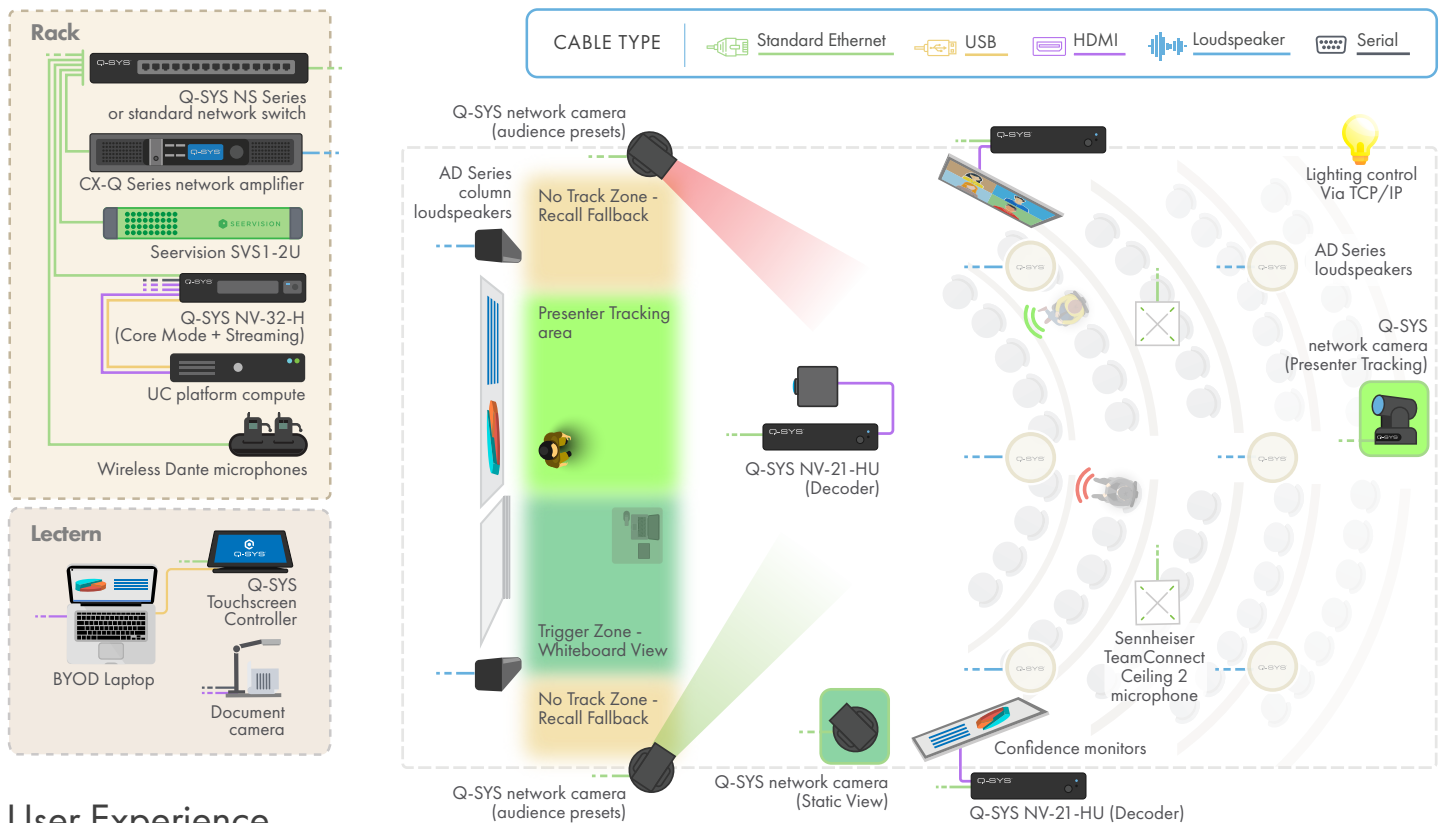

Diagram example: Lecture Hall



## User Experience

- Presenter camera automatically tracks presenter in "Presenter Tracking area"
- Static View camera provides a cropped, stationary view of whiteboard when presenter enters "Trigger Zone – Whiteboard View"
- If there is no presenter in "Presenter Tracking area" or "Trigger Zone – Whiteboard View" Presenter camera returns to user-defined fallback position (such as wide view of room)
- When a meeting participant speaks, Q-SYS uses in-room microphone data to recall user-defined camera presets and switch the live feed to show who is speaking

# Multi-Presenter



Diagram example: Lecture Hall

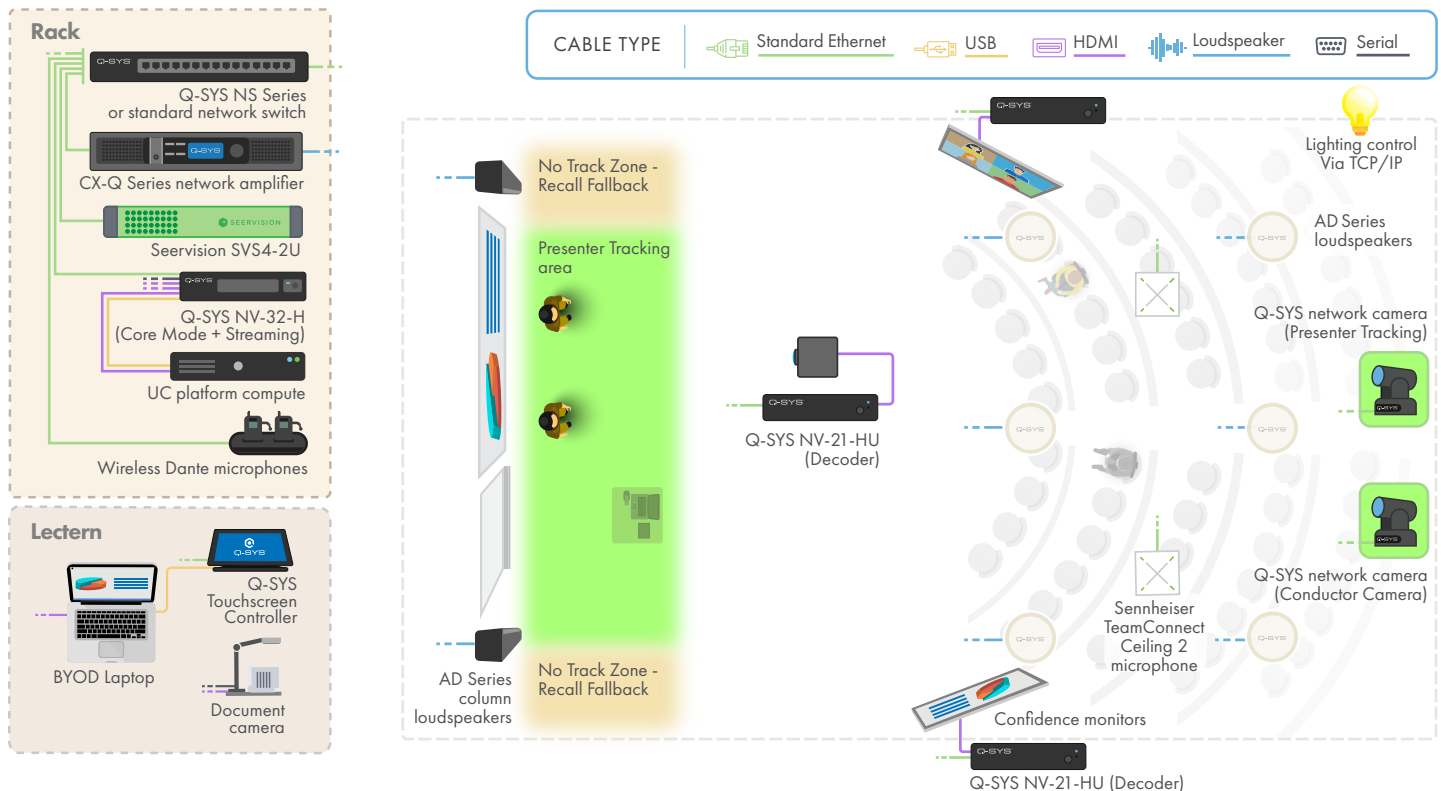

## User Experience

- A.** Presenter camera starts in a user-defined default position and automatically tracks presenter in "Presenter Tracking area"
- B.** When a second presenter is detected in "Presenter Tracking area", live feed switches to Conductor camera for a wider field-of-view of both people, while the Presenter camera frames the second presenter
- C.** Live feed remains on Conductor camera until one presenter leaves the "Presenter Tracking area"