



\* All images in this datasheet are for illustrative purposes only.

### Indoor LED LSBB Value Series

# LG LED Fine-pitch Value Series

Signal Detection Status Indicator

Easy Alignment in Z-direction

Front Serviceability

Easy-handling Lightweight Cabinet

Signal / Power Redundancy

Compatibility with LG Software Solutions

#### LSBB Value Series

Pixel Pitch	0.94 / 1.25 / 1.56 / 1.88 mm
Brightness	600 nits
Weight per Cabinet	6.0 kg / 13.2 lbs
Serviceability	Front
IP Rating	IP5X

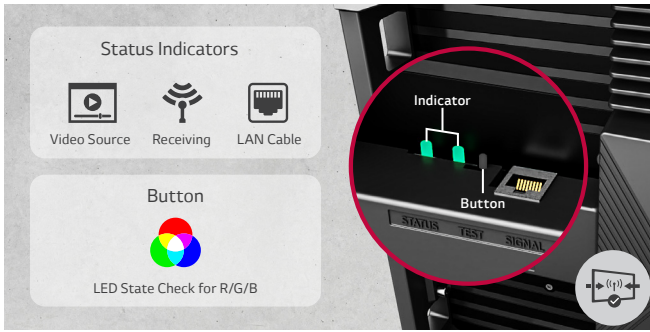

### Signal Detection Status Indicator

Status indicators and a check button are located in the main frame of the cabinet structure and can be conveniently accessed from both the front and back of the unit.

\* Refer to the LSBB user manual for more detail regarding the status indicators and check button.

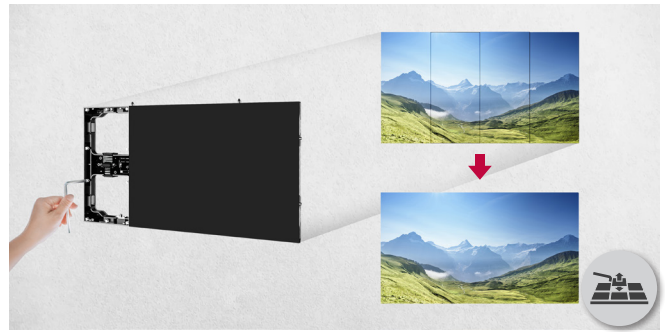

### Easy Alignment in Z-direction

A uniform tool can be used for X/Y/Z 6-axis adjustment between the panels. Modules can be easily adjusted in Z-direction to deliver a distortion-free image.

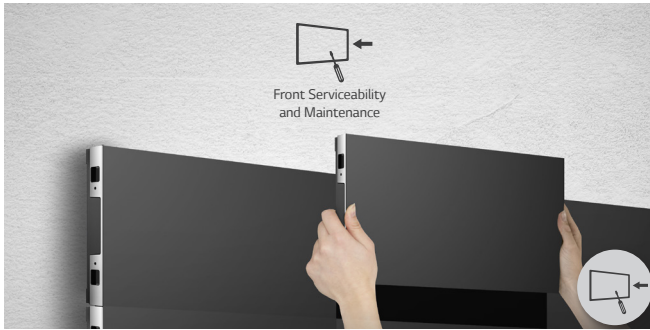

### Front Serviceability

Front access provides more convenient maintenance and reduces the need for additional space behind the unit.

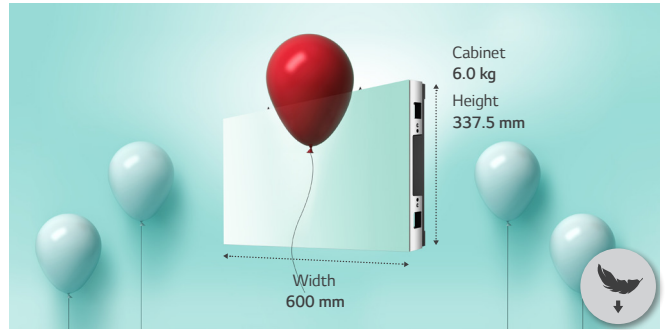

### Easy-handling Lightweight Cabinet

The lightweight design of the LSBB Value Series makes it a breeze to install, which can also lower the risk of damage during installation and reduce any strain on the installation structure.

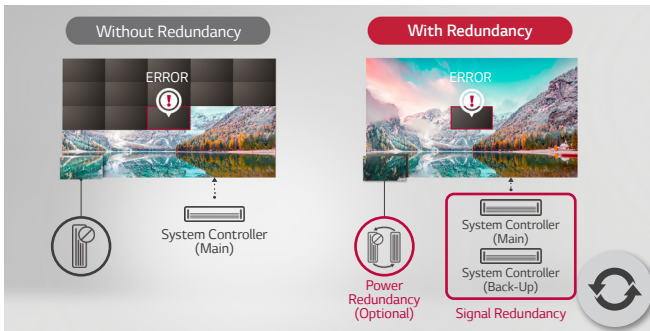

### Signal / Power Redundancy

To prevent screen blackout errors, should a signal transmission error occur, an additional controller and power unit can be deployed as a backup controller (Signal Redundancy). The product also offers Power Redundancy as an option,\* which provides two power units in a single LED cabinet to provide power should the primary power unit fail.

\* Additional options are available as add-ons for Power Redundancy at an additional cost.



### Compatibility with LG Software Solutions

Thanks to LG's high-performance system controller, the LSBB Value Series is compatible with a wide variety of LG software solutions, including SuperSign CMS, LED Assistant, and ConnectedCare, all designed to assist users with their business operations.

\*The availability of the 'LG ConnectedCare' service differs by region, and it needs to be purchased separately. So please contact the LG sales representative in your region for more details.

\*The items that can be monitored by LG ConnectedCare: Main Board (Temp, Signal Status, FPGA Ver, Ethernet Connection Status), Receiving Card (Temp, LED Power)

## SPECIFICATIONS

		LSBB009-GF	LSBB012-GD	LSBB015-GD	LSBB018-GD
<b>PHYSICAL PARAMETERS</b>	Pixel Configuration	3 in 1 SMD	3 in 1 SMD	3 in 1 SMD	3 in 1 SMD
	Pixel Pitch	0.938 mm	1.250 mm	1.563 mm	1.875 mm
	Connector Type	Gold	Copper	Copper	Copper
	Module Resolution (W x H)	160 x 360 pixels	120 x 270 pixels	96 x 216 pixels	80 x 180 pixels
	Module Dimensions (W x H)	150 x 337.5 mm / 5.9 x 13.3 in	150 x 337.5 mm / 5.9 x 13.3 in	150 x 337.5 mm / 5.9 x 13.3 in	150 x 337.5 mm / 5.9 x 13.3 in
	Weight per Module	0.50 kg / 1.1 lbs	0.50 kg / 1.1 lbs	0.50 kg / 1.1 lbs	0.50 kg / 1.1 lbs
	No. of Modules per Cabinet (W x H)	4 x 1	4 x 1	4 x 1	4 x 1
	Unit Case Resolution (W x H)	640 x 360 pixels	480 x 270 pixels	384 x 216 pixels	320 x 180 pixels
	Unit Case Dimensions (W x H x D)	600 x 337.5 x 56 mm / 23.6 x 13.3 x 2.2 in	600 x 337.5 x 56 mm / 23.6 x 13.3 x 2.2 in	600 x 337.5 x 56 mm / 23.6 x 13.3 x 2.2 in	600 x 337.5 x 56 mm / 23.6 x 13.3 x 2.2 in
	Unit Case Surface Area (m <sup>2</sup> )	0.203 m <sup>2</sup> / 2.2 ft <sup>2</sup>	0.203 m <sup>2</sup> / 2.2 ft <sup>2</sup>	0.203 m <sup>2</sup> / 2.2 ft <sup>2</sup>	0.203 m <sup>2</sup> / 2.2 ft <sup>2</sup>
	Weight per Cabinet	6.0 kg / 13.2 lbs	6.0 kg / 13.2 lbs	6.0 kg / 13.2 lbs	6.0 kg / 13.2 lbs
	Weight per Square Meter	30.0 kg/m <sup>2</sup> / 6.1 lb/ft <sup>2</sup>	30.0 kg/m <sup>2</sup> / 6.1 lb/ft <sup>2</sup>	30.0 kg/m <sup>2</sup> / 6.1 lb/ft <sup>2</sup>	30.0 kg/m <sup>2</sup> / 6.1 lb/ft <sup>2</sup>
	Physical Pixel Density	1,137,777 pixels/m <sup>2</sup> 12,246,930 pixels/ft <sup>2</sup>	640,000 pixels/m <sup>2</sup> 6,888,903 pixels/ft <sup>2</sup>	409,600 pixels/m <sup>2</sup> 4,408,898 pixels/ft <sup>2</sup>	284,444 pixels/m <sup>2</sup> 3,061,730 pixels/ft <sup>2</sup>
	Flatness of Cabinet	0.5 mm	0.5 mm	0.5 mm	0.5 mm
	Cabinet Material	Die Cast Aluminum	Die Cast Aluminum	Die Cast Aluminum	Die Cast Aluminum
	Service Access	Front	Front	Front	Front
<b>OPTICAL SPECIFICATIONS</b>	Max Brightness (After Calibration)	600 nits	600 nits	600 nits	600 nits
	Color Temperature	3200 ~ 9300 K	3200 ~ 9300 K	3200 ~ 9300 K	3200 ~ 9300 K
	Visual Viewing Angle (Horizontal)	160°	160°	160°	160°
	Visual Viewing Angle (Vertical)	140°	140°	140°	140°
	Brightness Uniformity	97%	97%	97%	97%
	Color Uniformity	±0.003Cx,Cy	±0.003Cx,Cy	±0.003Cx,Cy	±0.003Cx,Cy
	Contrast Ratio	5000:1	5000:1	5000:1	5000:1
	Processing Depth	16 bit (HDR10, HDR10 Pro)	16 bit (HDR10, HDR10 Pro)	16 bit (HDR10, HDR10 Pro)	16 bit (HDR10, HDR10 Pro)
<b>ELECTRICAL SPECIFICATIONS</b>	Max Power Consumption	120 W/Cabinet	120 W/Cabinet	120 W/Cabinet	120 W/Cabinet
	Avg. Power Consumption	40 W/Cabinet	40 W/Cabinet	40 W/Cabinet	40 W/Cabinet
	Max Power Consumption per Unit Area	600 W/m <sup>2</sup>	600 W/m <sup>2</sup>	600 W/m <sup>2</sup>	600 W/m <sup>2</sup>
	Max Heat Dissipation	409 BTU/h/Cabinet	409 BTU/h/Cabinet	409 BTU/h/Cabinet	409 BTU/h/Cabinet
	Avg. Heat Dissipation	136 BTU/h/Cabinet	136 BTU/h/Cabinet	136 BTU/h/Cabinet	136 BTU/h/Cabinet
	Max Heat Dissipation per Unit Area	2047 BTU/h/m <sup>2</sup>	2047 BTU/h/m <sup>2</sup>	2047 BTU/h/m <sup>2</sup>	2047 BTU/h/m <sup>2</sup>
	Power Supply	100 to 240 V	100 to 240 V	100 to 240 V	100 to 240 V
	Frame Rate	50 / 60 Hz	50 / 60 Hz	50 / 60 Hz	50 / 60 Hz
	Refresh Rate	3840 Hz	3840 Hz	3840 Hz	3840 Hz
<b>OPERATION SPECIFICATIONS</b>	LED Lifetime (Half brightness)	100,000 Hours	100,000 Hours	100,000 Hours	100,000 Hours
	Operating Temperature	-20° to 40°C / -4° to 104°F	-20° to 40°C / -4° to 104°F	-20° to 40°C / -4° to 104°F	-20° to 40°C / -4° to 104°F
	Operating Humidity	10-80%RH	10-80%RH	10-80%RH	10-80%RH
	IP Rating Front	IP5X	IP5X	IP5X	IP5X
	IP Rating Rear	IP5X	IP5X	IP5X	IP5X
<b>REGULATORY &amp; CERTIFICATIONS</b>	FCC / CE / TUV / RoHS / REACH / WEEE	FCC / CE / TUV / RoHS / REACH / WEEE	FCC / CE / TUV / RoHS / REACH / WEEE	FCC / CE / TUV / RoHS / REACH / WEEE	
<b>CONTROLLER</b>	CVBA	CVBA	CVBA	CVBA	

\* Specifications are subject to change without notice, so please contact LG sales team to verify before ordering.

## CONTROLLER SPECIFICATIONS

		LCLY006HD	LCLY006	CVBA
<b>MAX OUTPUT RANGE</b>	Loading Capacity	1920 x 1200 @ 60Hz	1920 x 1200 @ 60Hz	3840 x 2160 @ 60Hz
	Max Width	4096 pixels	3840 pixels	-
	Max Height	2560 pixels	2560 pixels	-
	Output Resolution	2.304 Million Pixels	2.304 Million Pixels	8.2944 Million Pixels
<b>INPUT</b>	HDMI	HDMI 1.4	HDMI 1.3	HDMI 2.0
	HDCP	HDCP 1.4	HDCP 1.4	HDCP 2.2
	DP	No	No	DP 1.2 / HDCP 2.2
	DVI	Yes	Yes	No
	OPS	No	No	Yes
<b>OUTPUT</b>	HDMI	Yes (LOOP)	No / Yes (LOOP)	No
	Ethernet (To LED Screen)	Yes (4-channel)	Yes (4-channel)	Yes (16-channel)
<b>CONTROL</b>	LAN	No	No	Yes
	USB	Yes	Yes	No
	RS-232C	No	No	Yes (LOOP)
<b>SENSOR</b>	Ambient Light	Yes	Yes	No
	Temperature	No	No	Yes
<b>VIDEO PROCESSING</b>	Brightness Adjustment	Yes	Yes	Yes
	Chroma Adjustment	Yes	Yes	Yes
	Improved Grayscale at Low Brightness	Yes	No	Yes
	Scaling	No	No	Yes
	HDR	No	No	HDR10 Pro
	EDID Custom	Yes	Yes	No
<b>APPLICATION</b>	CMS	No	No	SuperSign CMS
	webOS API	No	No	Yes
	LG ConnectedCare	No	No	Yes
	Configuration SW	Leadshow 5G Control Manager 4k	NovaLCT	LED Assistant
<b>MECHANICAL</b>	Size (W x H x D)	19.0 x 1.7 x 10.3 in / 482.6 x 44 x 262 mm	19.0 x 1.7 x 9.8 in / 482 x 44.4 x 250 mm	17.4 x 2.5 x 12.1 in / 443 x 63 x 307.5 mm
	Weight	5.5 lbs / 2.5 kg	7.9 lbs / 3.6 kg	10.8 lbs / 4.9 kg