

# B Series Control Panel

## Installer Quick Start Guide

Use this guide to quickly install a Bosch B6512/B5512/B4512/B3512 security system. Additional information is found in the Control Panels Installation Manual.

 When you see this icon, use your smart phone with a QR code reader app to view helpful videos.

### Control panel component layout

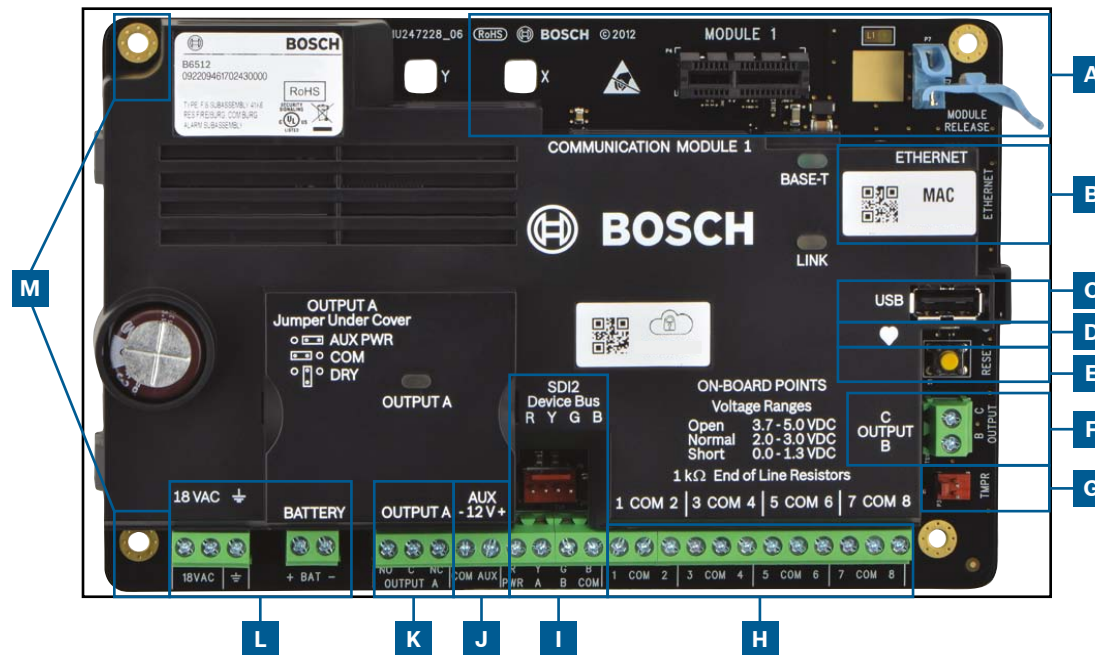

### Control panel connection location

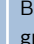
Location	Item	Description	Specification
A	MODULE 1	Plug-in comm module	Communication module options
B	ETHERNET	Ethernet port	built-in on-board Ethernet connection (10Base-T/100Base-T)
C	USB	USB port	USB connector (for firmware updates and RPS connection)
D		Heartbeat LED	Slow=normal, rapid=service mode
E	Reset	Reset switch	Hold five seconds to enter or exit service mode
F	B C	Outputs B(2) C(3)	Open collector, 50mA, active low
G	TMPR	Tamper	Optional tamper switch connector (ICP-EZTS)
H	1 COM 2 to 7 COM 8	Alarm inputs	End Of Line (EOL) resistor supervised alarm inputs
I	R Y G B	SDI2 bus	SDI2 device bus
J	COM AUX	Aux power	12 VDC, 800mA
K	NO C NC	Output A(1)	Programmable relay output
L	+ BAT - 18 VAC, 	Battery, Earth ground, 18 VAC	Primary/Secondary power and Earth Ground connections
M	Mounting	Mounting holes	Mounting holes for control panel

### For additional training:

#### Bosch YouTube channel:

1. Scan QR code.
2. Scroll down.
3. Locate and select your region for additional videos.

#### B Series Installer's Site:



### Installation sequence:

Scan and follow these videos in sequential order to the steps listed below.



### Step 1 Mounting the control panel M

#### Bosch tips:

- ▶ Mount the enclosure prior to mounting the control panel.
- ▶ Mount control panel into enclosure with hardware provided.

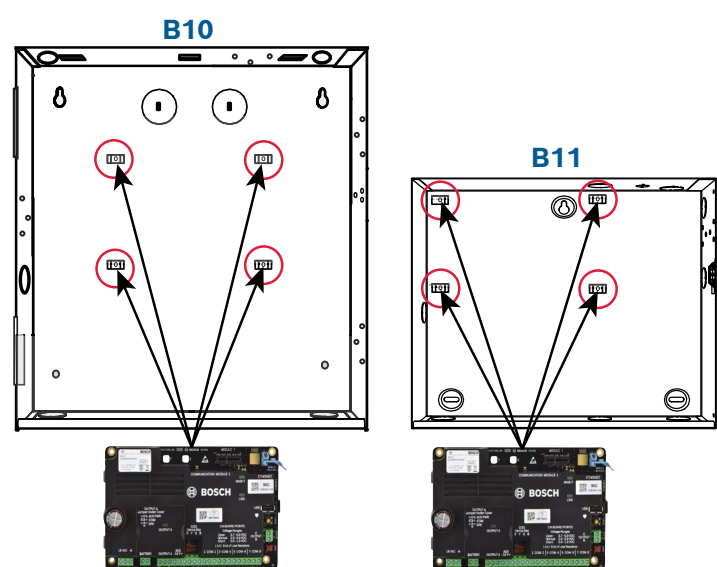

### Step 2 Installing a communication module A

#### Bosch tips:

- ▶ Insert leg of module into slot marked "x."
- ▶ **Cellular:** Place antenna on top of enclosure and run cable inside, then connect to module.
- ▶ **PSTN:** Connect module to a D166 (RJ31x) jack using a D161/D162 cable.

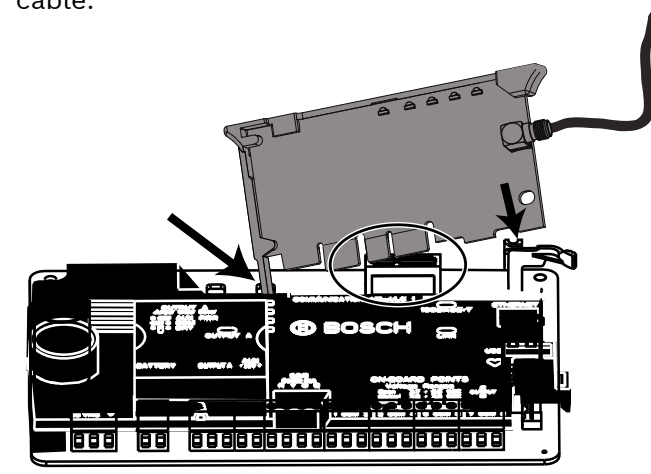

### Step 3 Installing a keypad I

#### Bosch tips:

- ▶ When installing a compatible Bosch keypad, refer to keypad installation guide for specific wiring diagrams. Basic keypad wiring is shown below.
- ▶ When installing more than one keypad, refer to keypad installation guide for unique address settings.

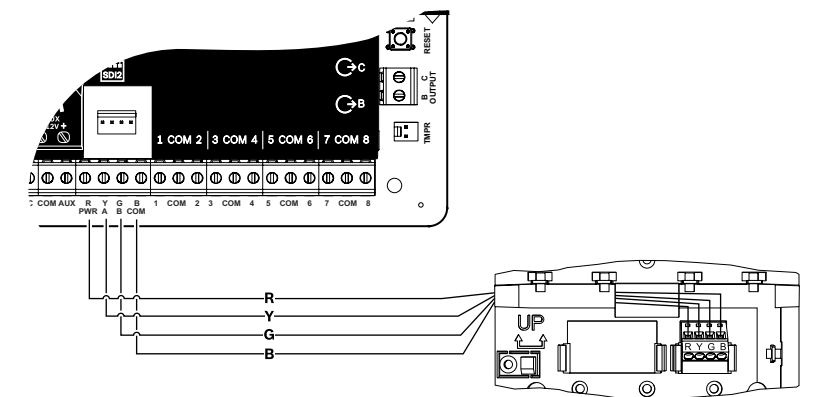

### Step 4 Installing expansion modules I

#### Bosch tips:

- ▶ If installing more than one device that is similar, refer to the module's installation guide for address settings (for example, two of the same device).
- ▶ If installing a RADION B810 wireless receiver, use address 1 only.

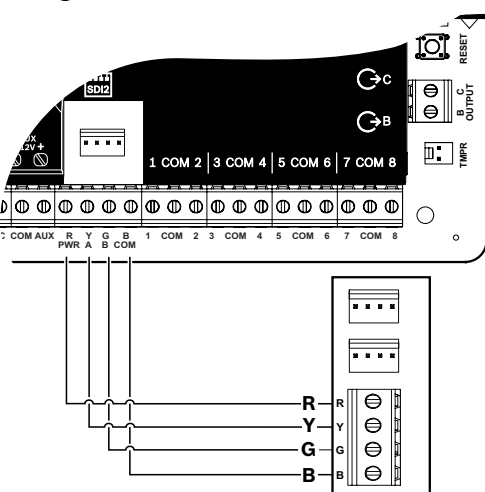

### Step 5 Installing wired inputs H

#### Bosch tips:

- ▶ If using a dual EOL, 2K EOL, or no EOL, refer to control panel installation guide for control panel settings.
- ▶ If using 2-wired powered devices, use a B201 or D125B.

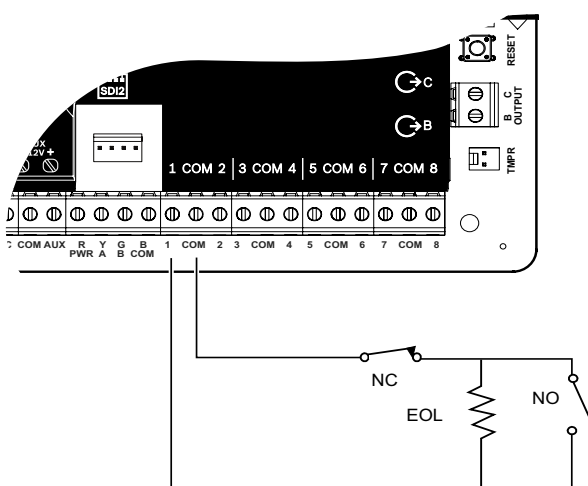

**NOTE:** Not all modules are available in all regions.

### Step 6 Installing a bell or siren J K

#### Bosch tips:

- ▶ Output A can supply up to 1 A at 12 VDC when sourced from a control panel (jumper in AUX PWR position).
- ▶ Output A can support up to 3 amps at 12 VDC when using a separate power supply (jumper in DRY position).
- ▶ Output B and C are open collectors and are limited to 50 mA at 12 VDC.

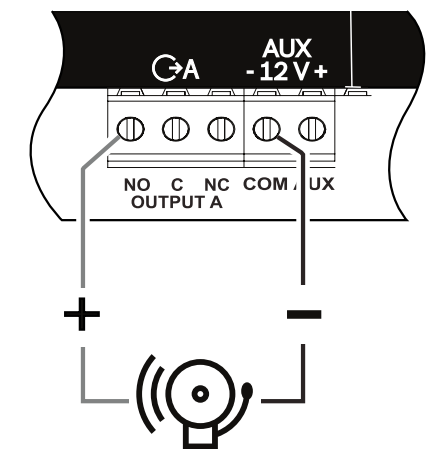

### Step 7 Powering the control panel L

#### Bosch tips:

- ▶ Connect wires to control panel before applying battery or AC power.
- ▶ Connect earth ground to a cold water pipe (copper) or other solid connection to ground.

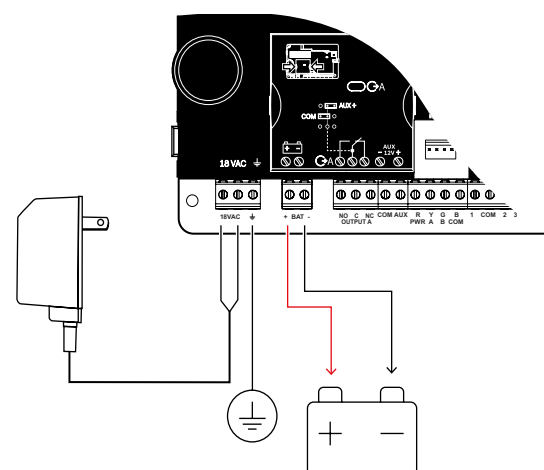

### Step 8 Create panel accounts using RPS B C

#### Bosch tips:

- ▶ If configuring using the Installer Services Portal, go to **Step 11**.
- ▶ Install Remote Programming Software (RPS) v6.06 or later. You can download RPS from the RPS product page.
- ▶ Follow the RPS Account Assistant instructions to create new control panel accounts. The Account Assistant helps you create a new panel account.
- ▶ If RPS is not available, keypad programming is an option. Refer to keypad installation instructions.

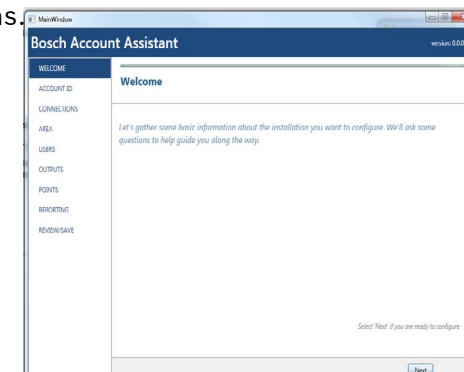

### Step 9 Connecting the control panel using RPS B C

#### Bosch tips:

- ▶ Connect a computer with RPS installed. Direct RPS connections can be done through a USB connection or Ethernet connection.
- ▶ The Account Assistant automatically launches when you create a new account.
- ▶ For USB direct connection, use a B99 USB cable.

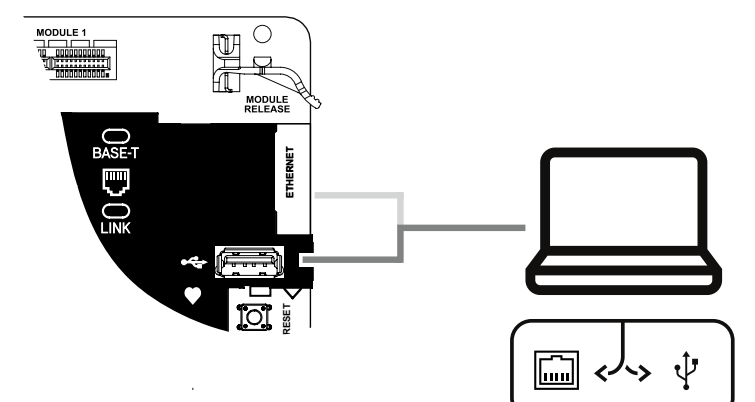

# B Series Control Panel

## Installer Quick Start Guide

### Step 10 Configure and send to control panel using RPS

**Bosch tips:**

- ▶ Program your configuration information using Account Assistant.
- 1. Press **close Account Assistant, and connect to control panel.** This opens the **Panel Communication** window.
- 2. Press **Connect** and send configuration programming to control panel.

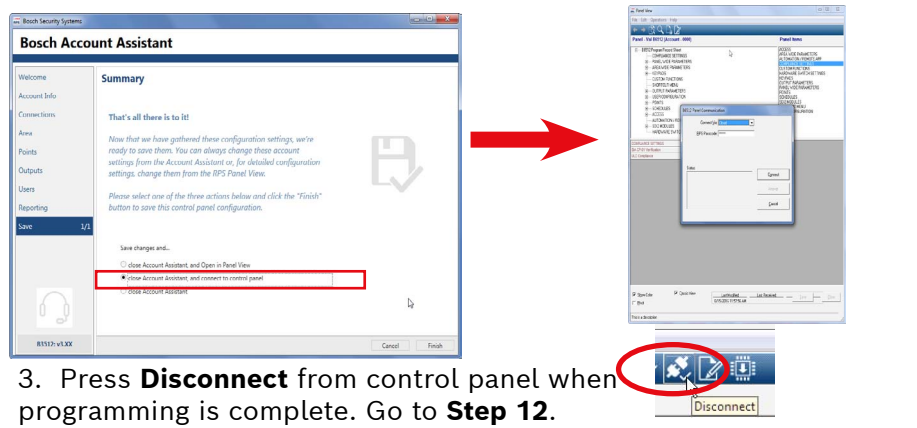

- 3. Press **Disconnect** from control panel when programming is complete. Go to **Step 12.**

### Step 11a Accessing the Installer Service Portal and create panel account

**Bosch tips:**

**Using the Installer Services Portal:** (Not in all regions)

- ▶ Before you can use Installer Services Portal you must register for services at: <https://sp.boschsecurity.com>.
- ▶ Make sure the control panel is connected to the network.
- 1. Log into the Installer Services Portal.
- 2. Click on **New** and select **Device** to create a panel account.
- 3. Add panel account information.
- 4. Activate CloudID. ISP searches database for registered ID.
- 5. Select **Activate**.
- 6. Click **Add Panel**.

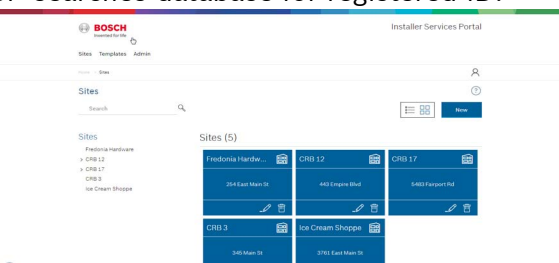

### Step 11b Connect and send using the Installer Service Portal

**Bosch tips:**

**Using the Installer Services Portal:**

- ▶ Search or select device to connect to a control panel. Type in panel account name in the Search field to locate new account.
- 1. Select the panel account.
- 2. Click **Connect**.
- 3. Click **Configuration**. Program your configuration information.
- 4. Click the 3 vertical dots and select **Push Pending Changes to Panel** to send configuration.
- 5. Click **Disconnect** when configuration is complete.

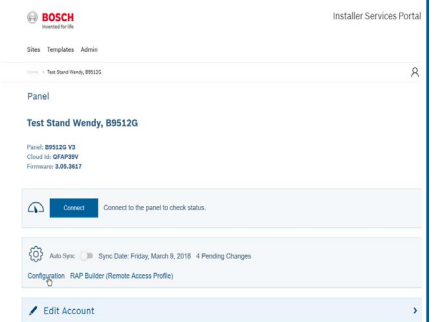

## B Series control panel accessories (partial list)

**Note:** Not all products and features are available in all regions. Consult your Bosch representative or product datasheets for details.

#### Control panel

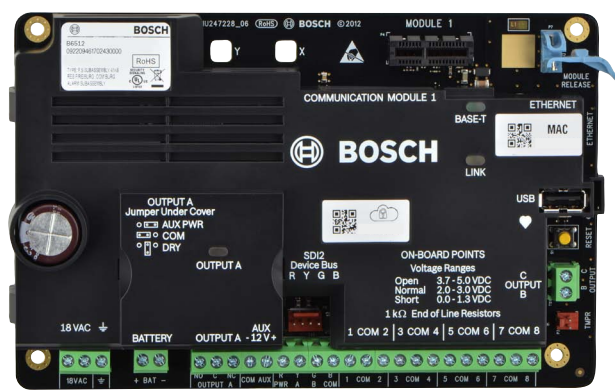

#### Power

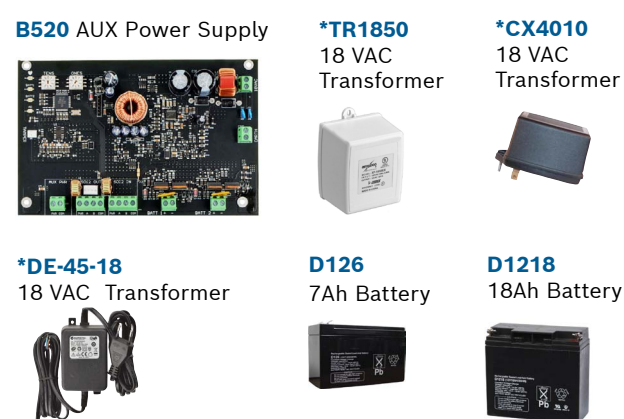

D135A Low-Battery Disconnect Module

\*Country specific, variants will apply

#### Communicators

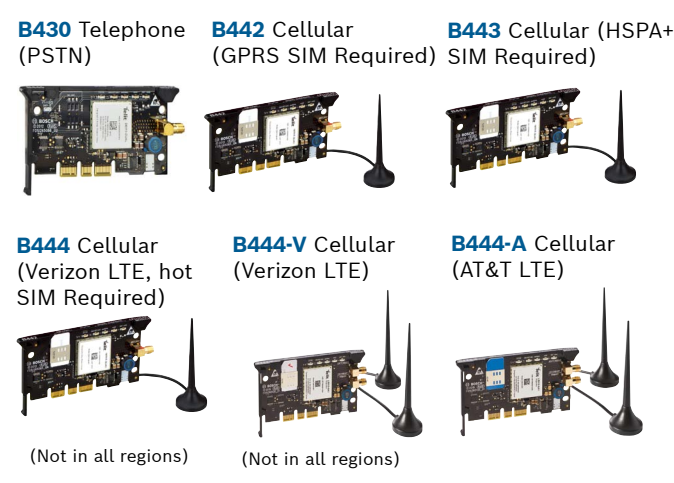

(Not in all regions)

(Not in all regions)

B450 Remote Cellular Interface



#### RADION wireless devices

-A versions of RADION devices are used in North and South America. Non -A versions are used in Europe, Africa, and Australia.

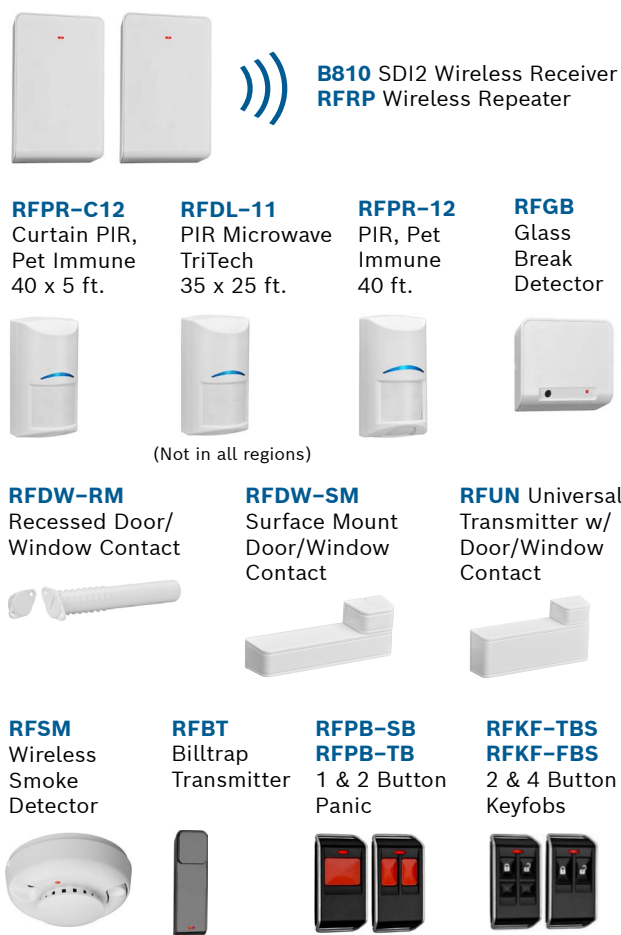

#### Keypads



(Not in all regions)

(Not in all regions)

#### RFID tags (for Readers & B942 Keypads)



#### IP camera integration

Any Bosch IP camera



#### Enclosures & accessories



#### Residential fire

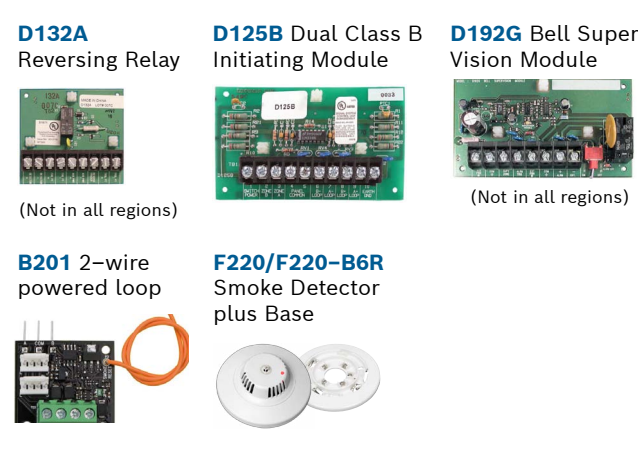

(Not in all regions)

(Not in all regions)

#### Access modules



#### I/O expansion modules

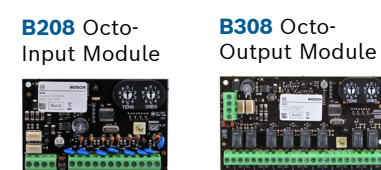

#### \*Home automation

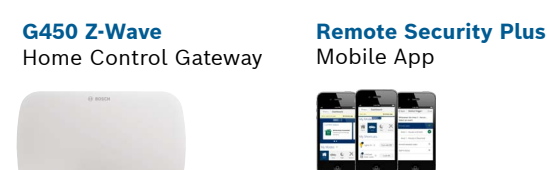

\*Home automation may not be available in all regions. Consult your Bosch representative for details.

#### Wired motion detectors

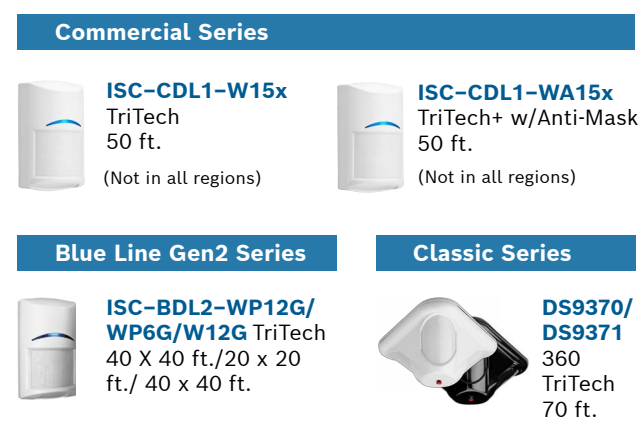

### Step 12 Test the system

After system installation and control panel programming, you must perform a complete system test. A complete system test includes testing the control panel, all devices, and communication destinations for proper operation.

**Bosch tips:**

- ▶ Perform a Walk Test
  1. Select **Actions**.
  2. Select **Test**.
  3. Select **Walk Test**.
  4. Choose a test to run.
- ▶ Send a test report



## FAQs

**What is my default code?**

User Code: **123456**  
Installer Code: **123**

**How do I use Output B and C?**

Outputs B and C are Open Collector Outputs. Wiring can be found in control panel installation manual, section heading **Open Collector Outputs**.

**How do you remotely turn on and turn off the control panel?**

This can be done through the use of the Remote Security Control App.

**How do I connect directly to the control panel with Ethernet?**

By default, the control panel is set up to auto detect and negotiate a connection to RPS when an ethernet cable is connected between them.

**What do I need to be able to send personal notifications?**

SMS (Text) messages require the use of a cellular module and emails can be sent by either an Ethernet or Cellular connection.

**How do I enter "Service Mode"?**

Press and hold the yellow reset button on the control panel for 5 seconds (repeat to exit).

## Where can I go for additional information?

[www.boschsecurity.com](http://www.boschsecurity.com)

Bosch Security Systems B.V.  
Torenallee 49  
5617 BA Eindhoven  
Netherlands

## 6 | Audible tones

The keypad has a built-in speaker that produces several distinct warning tones. The keypad backlight illuminates when it emits an audible tone.

Tone	Description
Fire alarm	When an area is in fire alarm, the keypad emits a pulsed, high-pitched bell tone.
Gas alarm	When a gas point activates, the keypad emits a unique high pitched tone.
User alarm	When a user alarm (such as panic and medical alarms) occurs, the tone sounds for the programmed amount of time.
Burglary alarm	When an area is in alarm, the keypad emits a steady, high pitched bell tone.
Entry delay	The keypad emits an intermittent beep tone during entry delay periods to remind the user to disarm the area.
Exit delay	The keypad emits an intermittent beep tone during exit delay.
Invalid button buzz	When an invalid button, or sequence of buttons, is pressed, the keypad emits a flat buzz tone.
Keypress	The keypad emits a muted beep tone as each button is pressed to indicate that the entry was accepted.
Trouble	When a trouble event occurs, such as a service alert, the keypad emits a two-tone warble until you enter a programmed passcode with the appropriate authority.
Watch point fault	A single clean tweedle tone alerts the user anytime a watch point is faulted.

Table 6.1: Keypad audible tones

## 7 | Supervision

The control panel supervises all keypads on the SDI2 bus. If a supervised keypad fails to respond to the control panel, the control panel declares a Missing Keypad Trouble. When the control panel can again communicate with the keypad, it restores the Missing Keypad Trouble. During a Missing Keypad Trouble, any connected keypad that maintained contact with the control panel shows the Missing Keypad Trouble as its idle text, and shows the missing keypad's address. The communicating keypads also sound a trouble tone. Users can silence the trouble tone. If no other troubles exist, the tone silences when the missing keypad restores.

## 8 | Show the firmware version

Showing the keypad firmware version:

1. Remove the keypad from the base to remove power to the keypad. Refer to *Figures 2.1* and *2.2*.
2. Return the keypad to the base to restore power. The keypad shows the model number, keypad address, and firmware version for 10 seconds.



### NOTICE!

You can also view a keypad's firmware version in RPS.

## 9 | Keypad cleaning

Use a soft cloth and non-abrasive cleaning solution to clean your keypad (for example, microfiber cloth and eyeglass cleaner). Spray the cleaner onto the cloth. Do not spray cleaners directly onto the keypad.

## 10 | Certifications

Region	Certification
US	UL 365 - Police Station Connected Burglar Alarm Units and Systems
	UL 609 - Local Burglar Alarm Units and Systems
	UL 985 - Household Fire Warning System Units
	UL 1023 - Household Burglar-Alarm System Units
	UL 1076 - Proprietary Burglar Alarm Units and Systems
	UL 1610 - Central Station Burglar Alarm Units
	CSFM - California Office of The State Fire Marshal
	FCC Part 15 Class B
CA	Canada CAN/ULC S303 - Local Burglar Alarm Units and Systems
	CAN/ULC S304 - Signal Receiving Centre and Premise Alarm Control Units
	ULC-ORD C1023 - Household Burglar Alarm System Units
	ULC-ORD C1076 - Proprietary Burglar Alarm Units and Systems
	ICES-003 - Digital Apparatus

## 11 | Specifications

Dimensions	6.2 in x 4.7 in x 1 in (158 mm x 120 mm x 26 mm)
Voltage (input)	12 VDC nominal
Current	35 mA in standby mode 80 mA in alarm mode
Operating temperature	0°C to +50°C (+32°F to +122°F)
Relative humidity	5% to 93% at +32°C (+90°F) non-condensing
Terminal wire size	12 AWG to 22 AWG (2 mm to 65 mm)
SDI2 wiring	Maximum distance - wire size (unshielded wire only): 1000 ft (305 m) - 22 AWG (0.65 mm)
Compatibility	B9512G/B9512G-E B8512G/B8512G-E B6512 B5512 B4512 B3512 D9412GV4 version 2.0 and higher D7412GV4 version 2.0 and higher (Refer to the control panel installation document for number of supported devices.)

### Copyright

This document is the intellectual property of Bosch Security Systems, Inc. and is protected by copyright. All rights reserved.

### Trademarks

All hardware and software product names used in this document are likely to be registered trademarks and must be treated accordingly.

### Bosch Security Systems, Inc. product manufacturing dates

Use the serial number located on the product label and refer to the Bosch Security Systems, Inc. website at <http://www.boschsecurity.com/datecodes/>.



## ATM Style Alphanumeric Keypad (SDI2) B930



en Installation Guide

**Bosch Security Systems, Inc.**  
130 Perinton Parkway  
Fairport, NY 14450  
USA  
[www.boschsecurity.com](http://www.boschsecurity.com)



## 1 | Overview

B930 keypads are SDI2 bus compatible devices. Each keypad has user adjustable options such as volume and display brightness, and an LCD display that shows five-line system messages.

B930 keypads connect to the SDI2 bus on the control panel using terminal wiring. You can connect more than one keypad to the control panel by wiring them in parallel.

You can program, diagnose, and troubleshoot the system from the control panel keypad as well as remotely through Remote Programming Software (RPS).

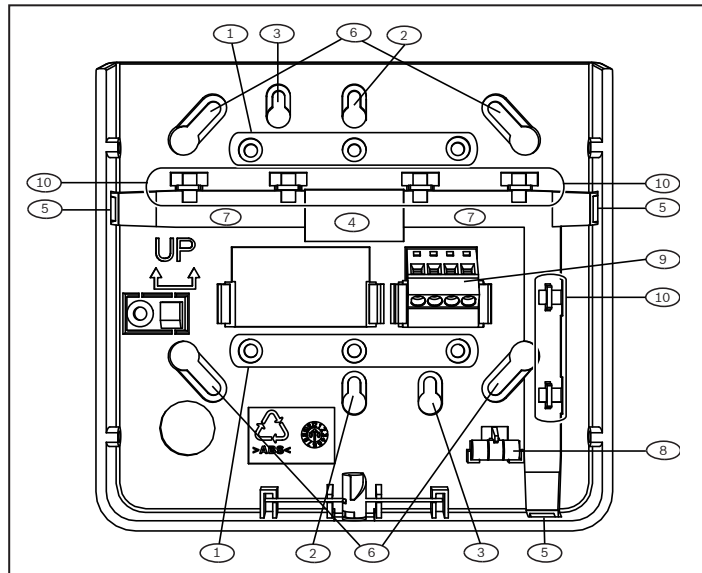

Figure 1.1: Keypad base overview

### Callout – Description

1 – Wall mount holes
2 – Single gang box holes
3 – Double gang box holes
4 – Wire opening
5 – Surface mount wire openings
6 – Gang box holes (3-4 in)
7 – Surface mount wire channel
8 – Bubble level
9 – SDI2 wiring terminal block
10 – Wire tie posts

## 2 | SDI2 address switches

Two switches determine the address for the keypad. The control panel uses the address for communications. Use a slotted screwdriver to set the switches.

## 2.1 | Access the address switches

1. Unlock the keypad by turning the lock counter-clockwise. Refer to *Figure 2.1*.
2. Hold the keypad by the base in one hand. With the other hand, gently push down on the keypad to remove it from the base. Refer to *Figure 2.2*.
3. Look at the back of the keypad, and locate the switches. Refer to *Figure 2.3*.

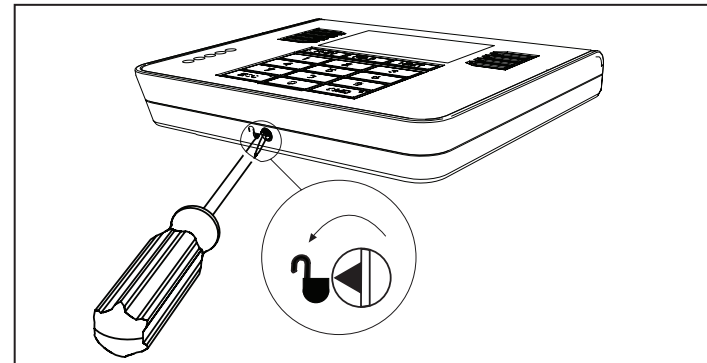

Figure 2.1: Unlocking the keypad

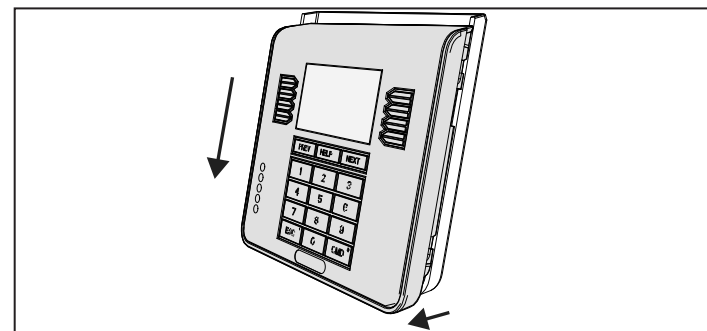

Figure 2.2: Removing the keypad from the base

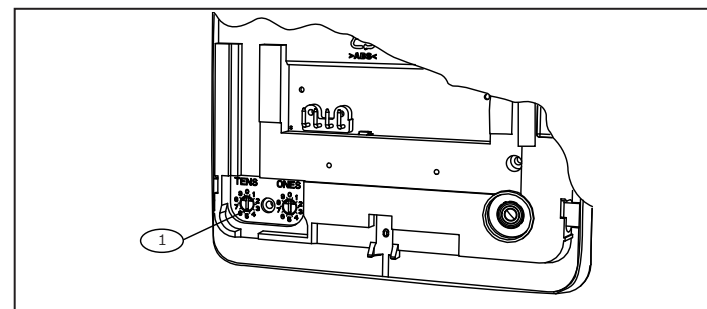

Figure 2.3: Switches location

### Callout – Description

1 – Address switches
----------------------

## 2.2 | Set the address switches

Set the address switches per the control panel configuration. If multiple SDI2 keypads reside on the same system, each SDI2 keypad must have a unique address. For single-digit addresses 1 through 9, set the tens switch to 0. *Figure 2.4* shows the address switch setting for address 1.

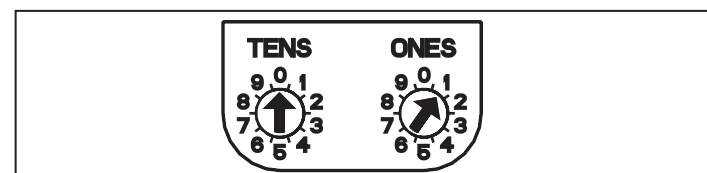

Figure 2.4: Address switches

## 3 | Installation

After you set the address switches for the proper address, mount the keypad base, wire to the control panel, and attach the keypad to the base.



### Caution!

Remove all power (AC and battery) before making any connections. Failure to do so might result in personal injury and/or equipment damage.

## 3.1 | Mount the keypad

You can surface mount the keypad, or mount it to standard electrical boxes, including single gang boxes.

Mounting the keypad:

1. Use the base as a template to mark the desired mounting surface. Refer to *Figure 1.1* for mounting hole and wiring locations.
2. Pull the wiring through the desired wire opening in the base.
3. Use the appropriate mounting hardware (supplied) to mount the base to the desired mounting surface. Refer to *Figure 1.1* for mounting hole and wiring locations.

## 3.2 | Wire to the control panel

When you wire the keypad to a control panel, use the control panel terminals labeled R, Y, G, B (PWR, A, B, COM). Connect them to the keypad terminals labeled R, Y, G, B. Refer to *Figure 3.1*.

You can connect keypads to the SDI2 data bus by parallel wire run from the control panel to each keypad, wire from keypad to keypad, or a combination of the two techniques. Refer to *Figure 3.2*.

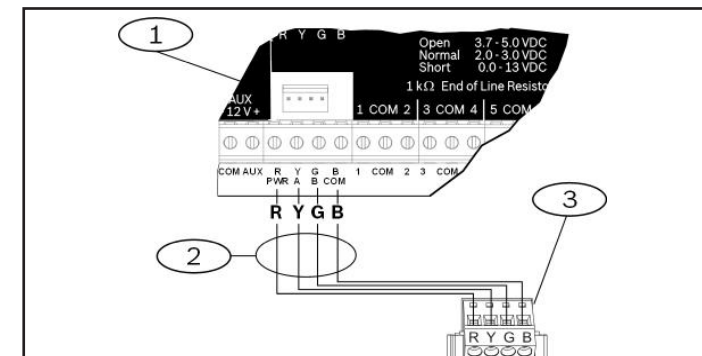

Figure 3.1: Wiring the keypad to the SDI2 bus connection (B5512 shown)

### Callout – Description

1 – Control panel
2 – Terminal wiring
3 – Keypad's SDI2 wiring terminal block

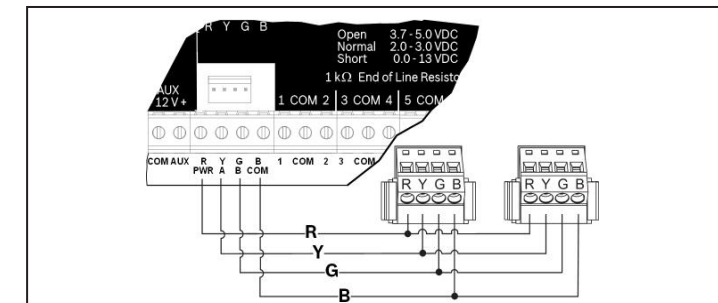

Figure 3.2: Installing multiple keypads using the SDI2 terminals

Reconnect the keypad to the base by sliding the keypad onto the base (reverse of *Step 2*). The keypad automatically locks onto the base. Apply power to the system.

## 4 | Display

You can adjust the keypad's display brightness level, and you can turn the keypad's nightlight feature on or off.

Adjusting the keypad display brightness:

1. Press [MENU] to open the Main menu.
2. Use [NEXT] to go to the Press 5 for Settings Menu option, or simply press [5].
3. Use [NEXT] to go to the Press 4 for Keypad Config option, or simply press [4].
4. Press [1] to adjust the brightness.
5. Use [PREV] or [NEXT] to adjust the brightness level. The changes apply immediately.
6. Press [ESC] to exit the menu.

Turning the keypad nightlight on or off (control panel version 2.01 or higher):

1. Press [MENU] to open the Main menu.
2. Use [NEXT] to go to the Press 5 for Settings Menu option, or simply press [5].
3. Use [NEXT] to go to the Press 4 for Keypad Config option, or simply press [4].
4. Use [NEXT] to go to the Press 4 for Nightlight option, or simply press [4].
5. Use [PREV] or [NEXT] to toggle between the Yes and No options.
6. Press [ENTER] while viewing the desired option to save the programming.
7. Press [ESC] to exit the menu.

## 5 | Status indicators

You can diagnose and troubleshoot the system using the keypad's status indicators. Refer to *Table 5.1*.

Status indicator	Function
✓	Ready to turn on (arm)
🔒	Turned on (armed)
⚠️	System trouble
GAS	Gas alarm
🔌	AC power present

Table 5.1: Keypad status indicators