



## AVA2.1 & AVA3.1 - Compact Mini-AVRs

The AVA2.1 and AVA3.1 mini audio receivers are designed for custom installation specialists and were designed based on their feedback. In addition to being highly flexible receivers that can be placed in nearly any imaginable space, both models include a fully integrated, highly efficient Class-D amplifier with digital inputs, 110-240V 50/60Hz universal power supply for installation nearly anywhere on the planet, built-in Bluetooth 5.0, ARC HDMI, dedicated subwoofer output with gain control, and an IR remote control and external receiver. The most important feature is the HDMI input allowing for instant use with any TV through HDMI's CEC functionality, eliminating the need to teach IR commands for volume control.

Both the AVA2.1 and AVA3.1 are ultra-compact (1.7" x 5.8" x 7.9") audio receivers designed for installation in nearly any space, no matter how compact.

### What's in the Box

- AVA2.1 or AVA3.1
- Learning Remote
- Power Cord
- Wall-Mount Bracket
- Infrared Receiver with IR Receiver Eye
- Operation Guide



Fully integrated highly efficient Class-D amplifier with 50 watts per channel, optimized for high quality audio performance.



Input for Audio Return Channel from TV HDMI Port eliminates the need for a set-top box.



2.1 or 3.1 speaker / subwoofer output match existing soundbars or speaker setups.



Analog and digital audio inputs provide flexibility in connecting additional audio sources.



Built-in Bluetooth 5.0 allows to listen to any content from a phone, tablet, or computer.



Learning remote conveniently controls AVA, TV, and connected audio sources.



Super compact size 1.7" x 5.8" x 7.9". Ideal for any small behind the TV box, on-TV, on-wall, on-shelf, computer desktop, credenza, or similar locations.

## Mounting Options



The compact, low-profile design of the AVA-Series amplifiers allows them to be installed out of view, minimizing any intrusion into the customers' living space. Please keep in mind that the AVA-Series amplifiers support Bluetooth Audio so that any audio content from a phone, tablet, or computer can be easily played.

### Table-Top Mounting

The AVA-Series amplifiers may be installed on a table-top or shelf.

### Wall Mounting

The AVA-Series amplifiers may be mounted on any wall or other surface using the included wall-mount bracket. Make sure to use suitable wall-anchors or secure the bracket to any wall stud.

### In-Wall Box Mounting

Many of today's TV accessories, including the AVA-Series amplifiers, are designed to be installed in in-wall mounting boxes hidden behind a television.

## Application Example

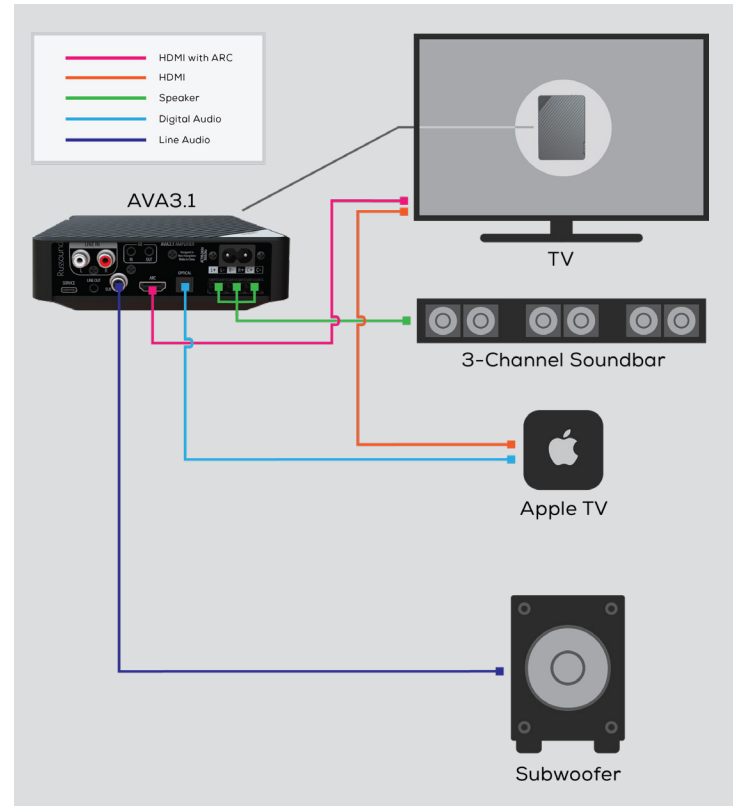

## Ports



- 1 HDMI with ARC (Audio Return Channel)
- 2 Optical Audio Input
- 3 Line Audio Input
- 4 Speaker Output  
AVR2.1: 2 Channels (Left, Right)  
AVR3.1: 3 Channels (Left, Right, Center)
- 5 Subwoofer Output
- 6 Line Audio Output
- 7 Infrared In and Out for use with the included IR Receiver with IR Receiver Eye
- 8 Power Input 110-240V 50/60Hz
- 9 Mini USB for firmware updates

## Specifications

	AVA2.1	AVA3.1
Number of Channels	2.1	3.1
Power Output - 4Ω	50W /Channel, 1kHz	50W /Channel, 1kHz
Power Output - 8Ω	25W /Channel, 1kHz	25W /Channel, 1kHz
Freq Response	20Hz to 20kHz +/-3dB at 1W output into 4 or 8 Ohms	20Hz to 20kHz +/-3dB at 1W output into 4 or 8 Ohms
Input Sensitivity (8Ω)	620 mV for 80W @ 1kHz	1000 mV for 45W @ 1kHz
Input Impedance	>22k ohms Line Input	>22k ohms Line Input
Signal to Noise Ratio , 4Ω	>94dB A-weighted	>93dB A-weighted
Signal to Noise Ratio , 8Ω	>96dB A-weighted	>97dB A-weighted
Inputs	HDMI (ARC), Line In (RCA), Optical, Bluetooth	HDMI (ARC), Line In (RCA), Optical, Bluetooth
Bluetooth	5	5
Bluetooth Range	10 Meters	10 Meters
Remote Control	Included	Included
IR Input/Output	3.5mm	3.5mm
IR Sensor Included	Yes	Yes
Speaker Connectors	Detachable Screw-down, up to 14AWG	Detachable Screw-down, up to 14AWG
Line Out	3.5mm Stereo	3.5mm Stereo
Subwoofer Out	RCA	RCA
Operating Temperature	32°F to 104°F (0°C to 40°C)	32°F to 104°F (0°C to 40°C)
Altitude	0 to 9,843' (3,000m)	0 to 9,843' (3,000m)
Power Requirements - North American Model	115-120VAC, 60Hz (150W Max)	115-120VAC, 60Hz (150W Max)
Power Requirements - International Model (-i)	220-240VAC, 50Hz (150W Max)	220-240VAC, 50Hz (150W Max)
Power Connector	IEC C8	IEC C8
Standby Power Consumption	0.45W	0.45W
Product Dimensions	5.8" (W) x 1.4" (H) x 7.9" (D) (14.7 x 3.7 x 20.2 cm)	5.8" (W) x 1.4" (H) x 7.9" (D) (14.7 x 3.7 x 20.2 cm)
Product Weight	1.5 lbs (0.7 kg)	1.5 lbs (0.7 kg)
Shipping Dimensions	10.7" (W) x 3.3" (H) x 12.7" (D) (27.2 x 8.3 x 32.2 cm)	10.7" (W) x 3.3" (H) x 12.7" (D) (27.2 x 8.3 x 32.2 cm)
Shipping Weight	2.4 lbs (1.1 kg)	2.4 lbs (1.1 kg)
Limited Warranty	2 Years	2 Years



WE'RE IN THE BUSINESS TO HELP OUR DEALERS

## RCI Program

- Prevents unauthorized internet reselling
- Units ship in lock-down mode
- Russound Certified Installer credentials required to activate and install
- Installers must accept agreement that they will not resell online
- Featured on all new MCA-Series Controllers and MBX-Series Products
- 15,000+ Installers Worldwide
- Award-winning tech support



## Integrator Support

- Dealer Locator on our site so end users can find knowledgeable dealers
- RCI Products sold through distribution, not direct
- Profitable margins
- Training webinars and tech tip videos
- Surveys & outreach to identify customers' needs



## Dealer Website

- The tool kit every partner needs. All in one place!
- Password-protected, dealer-only information available
- Current Promos & Dealer Price Sheet
- Training & Tech Tips including alerts when new YouTube videos are posted
- Recent Email Blast Announcements
- Dealer Version of Product Pages
  - o Firmware Updates
  - o Training Files

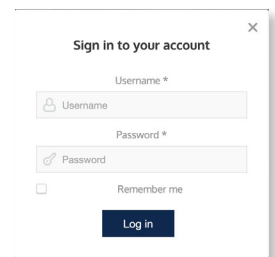

## Online Training Modules

- The training modules on our site are intended for users and prospective users to develop a basic understanding of Russound's products, functionality and operation.
- Available Modules:  
MIXAMP-60 and VoicePlay

