

NEC

WMK-3298T



32" - 98"
(82 - 249 cm)



210 lb
(95 kg)

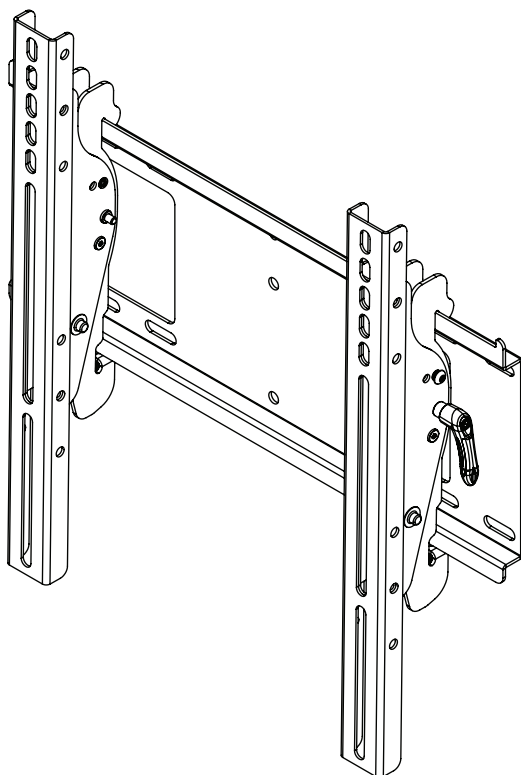

⚠ WARNING

ENG - This product is designed to be installed on wood stud, solid concrete or cinder block walls. Hardware is included for wood stud, solid concrete and cinder block installation. Before installing make sure the supporting surface will support the combined load of the equipment and hardware. Screws must be tightly secured. Do not overtighten screws or damage can occur and product may fail. Never exceed the Maximum Load Capacity. Always use an assistant or mechanical lifting equipment to safely lift and position equipment. This product is intended for indoor use only. Use of this product outdoors could lead to product failure or personal injury. Be careful not to pinch fingers when operating the mount. For support please call customer care at 1-800-865-2112.

ENG Symbols



ENG **WARNING**



ENG Skip to step.



ENG Screws must get at least three full turns and fit snug.



ENG Display center.

ENG Tools Needed for Assembly.

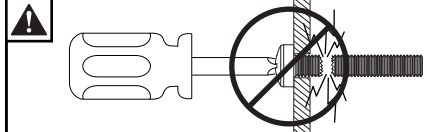
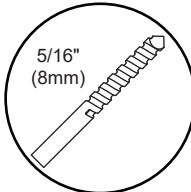
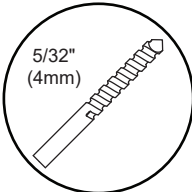
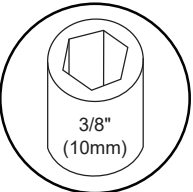
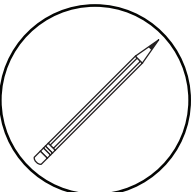
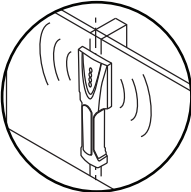
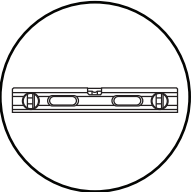
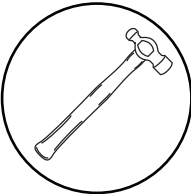
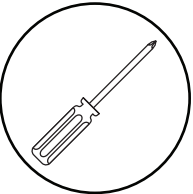

ENG Do not overtighten screws.



ENG To properly tighten screws: Tighten until screw head makes contact, then tighten another 1/2 turn. Do not overtighten screws.

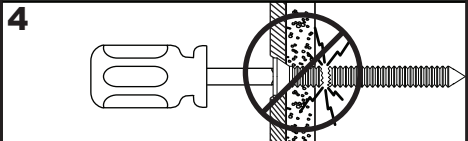
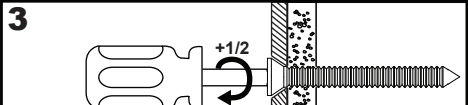
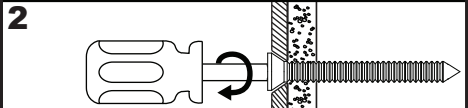
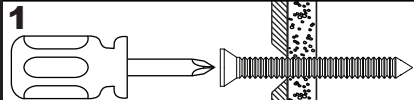

[ENG] Parts (Before beginning, make sure you have all parts shown below).

Parts List

Description	Qty	Part #
A wall plate	1	203-1037
B left tilt bracket	1	203-1039
C right tilt bracket	1	203-1038
D #14 x 2.5 wood screw	6	5S1-015-C03
E concrete anchor	6	590-0320
F 4mm allen wrench	1	560-9646
G M6 x 12mm socket pin screw	4	520-1050
H M6 x 16mm socket pin screw	4	520-1132
I multi washer	4	580-1036
J M8 x 15mm socket pin screw	4	520-1068
K M5 x 6mm socket pin serrated	8	510-1114
L extension brackets	2	203-1036
M 18 x 1mm security allen pin	1	560-1727
N M4 x 16mm socket pin	4	510-1087

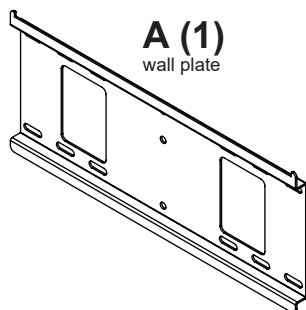

B (1)
left tilt bracket



C (1)
right tilt bracket



F (1)

4mm allen
wrench

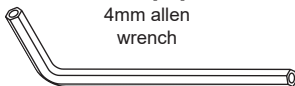

M (1)

18 x 1mm allen wrench

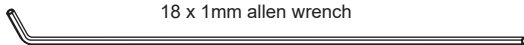

K (8)

M5 x 6mm



N (4)

M4 x 16mm



L (2)

extension
bracket



I (4)

multi washer

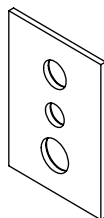

G (4)

M6 x 12mm

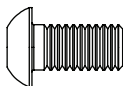

J (4)

M8 x 15mm

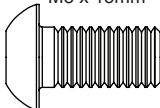

H (4)

M6 x 16mm

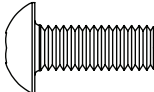

D (6)

#14 x 2-1/2" wood screw

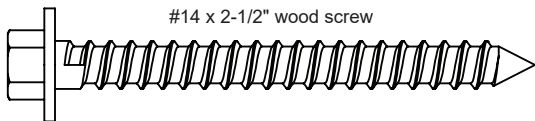

E (6)

8mm concrete anchor

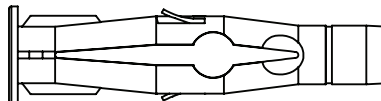

1

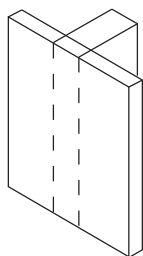

ENG Wood stud wall.

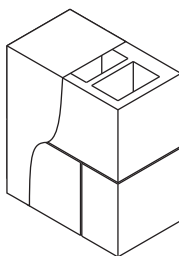

ENG Concrete/Cinder block.



1a



1b

1a

▲ WARNING

ENG - When installing Peerless wall mounts on a wood stud wall covered with gypsum board (drywall), verify that the wood studs are a minimum of 2" x 4" nominal size. Do not install over gypsum board thicker than 5/8".

1a-1

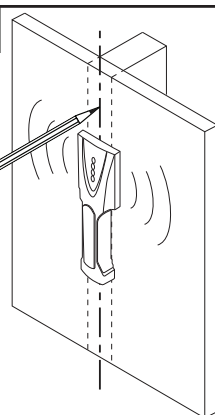
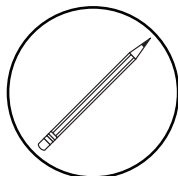
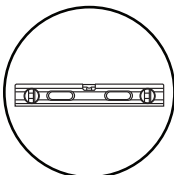
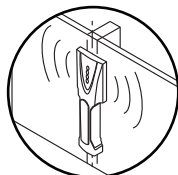

ENG Use stud finder to locate and mark stud center lines.

1a-2

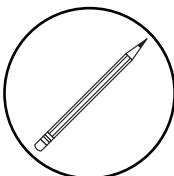
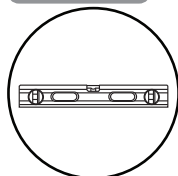

ENG Level wallplate. Mark mounting holes on stud center lines.

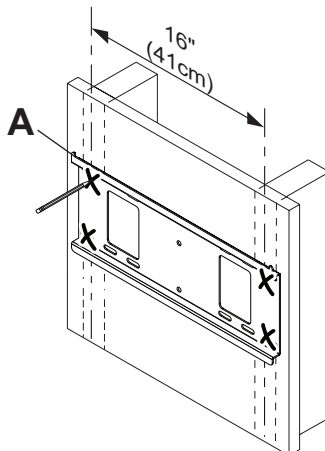

1a-3

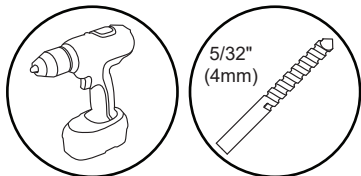

ENG Drill mounting holes into supporting surface (2.5" (64mm) minimum depth required).

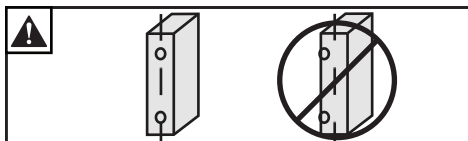
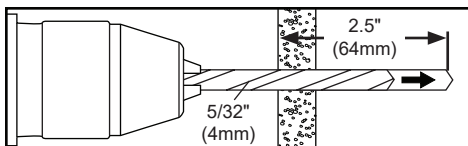

ENG Mounting hole must center on stud.

1a-4

ENG Level wallplate. Install using wood screws provided.

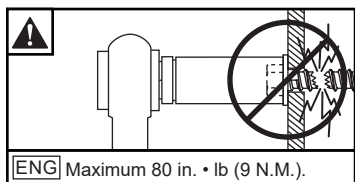

ENG Maximum 80 in. • lb (9 N.M.).

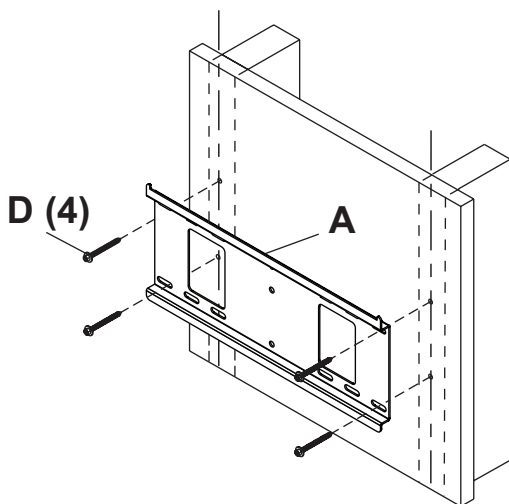
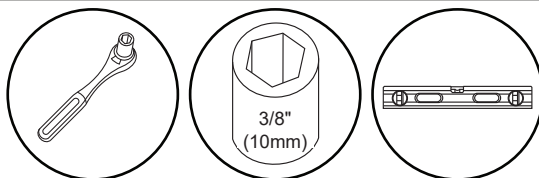

1b

⚠ WARNING

ENG - When installing Peerless wall mounts on a concrete wall, the wall must be at least 8" thick with a minimum compressive strength of 2000 psi. When installing Peerless wall mounts on a cinder block wall, the cinder blocks must meet ASTM C-90 specifications and have a minimum nominal width of 8". Do not drill into mortar joints! Be sure to mount in a solid part of the block, generally 1" (25 mm) minimum from the side of the block. It is suggested that a standard electric drill on slow setting is used to drill the hole instead of a hammer drill to avoid breaking out the back of the hole when entering a void or cavity. Never attach concrete expansion anchors to concrete or cinder block covered with plaster, drywall or other finishing material.

1b-1

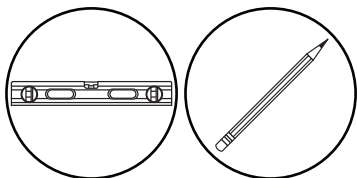

ENG Level wallplate. Mark mounting holes.

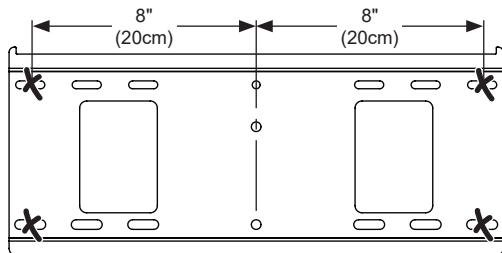
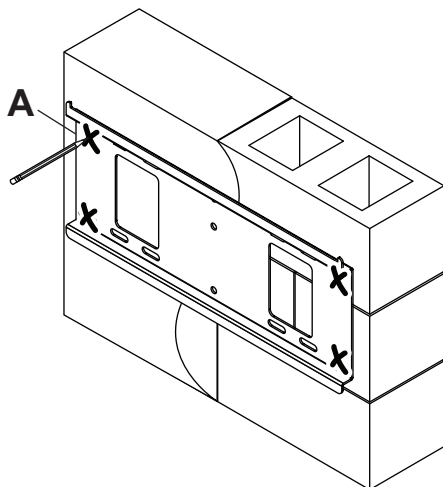

1b-2

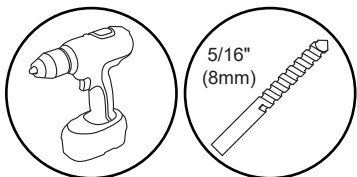

ENG Drill mounting holes into supporting surface (2.5" (64mm) minimum depth required).

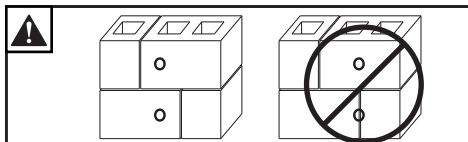
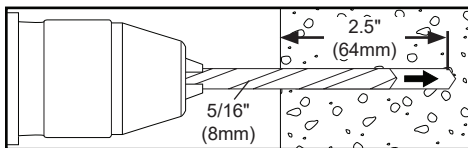

ENG Do not drill into mortar joints.

1b-3

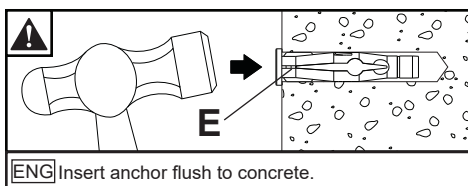
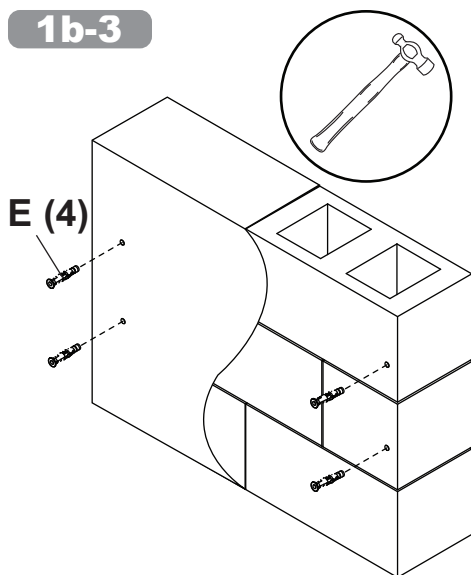

1b-4

ENG Level wallplate. Install using concrete anchors and wood screws provided.

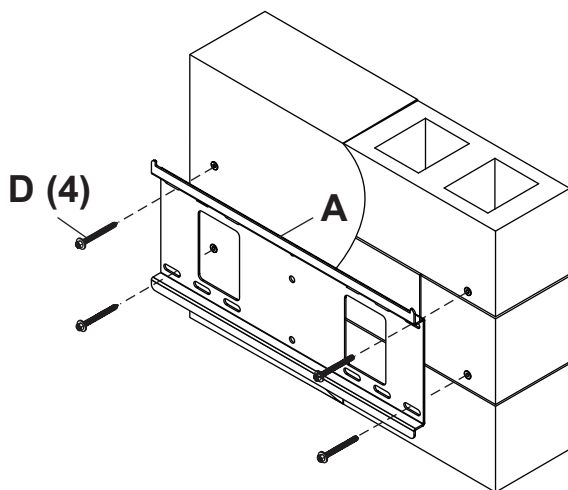
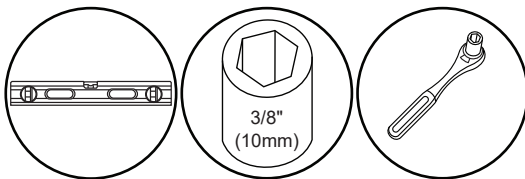
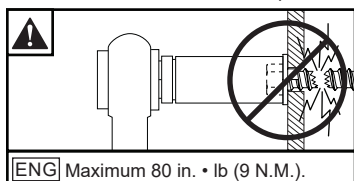

ENG Use chart to determine orientation, vesa pattern and hardware for your display.

Display Model #	Orientation	Vesa	Mounting Hardware
E327	landscape	100x100	M4 x 16
E437Q	landscape	200x200	M6 x 12
E507Q	landscape	400x200	M6 x 16
E557Q	landscape	400x200	M6 x 16
E657Q	landscape	400x200	M6 x 16
IB554Q-2.1	landscape	300x300	M6 x 12
IB654Q-2.1	landscape	400x400	M8 x 15
IB754Q-2.1	landscape	400x400	M8 x 15
IB864Q-2.1	landscape	400x400	M8 x 15
C431	landscape/portrait	300x300	M6 x 12
C501	landscape/portrait	300x300	M6 x 12
C551	landscape/portrait	300x300	M6 x 12
C651Q/V654Q	landscape/portrait	400x400	M8 x 15
C751Q/V754Q	landscape/portrait	400x400	M8 x 15
C861Q/V864Q	landscape/portrait	400x400	M8 x 15
C981Q/V864Q	landscape/portrait	400x400	M8 x 15
P404/V404	landscape/portrait	300x300	M6 x 12
P484/V484	landscape/portrait	300x300	M6 x 12
P554/V554	landscape/portrait	300x300	M6 x 12
V323-3	landscape/portrait	200x200	M6 x 12
V554Q	landscape/portrait	300x300	M6 x 12

3

VESA 300 X 300:
VESA 400 X 400:

ENG With extension brackets.

VESA 100 X 100:
VESA 200 X 200:
VESA 400 X 200:

ENG Without extension brackets.

3a

3b

3a

F

L (2)

C

B

K (8)

3a-1

ENG Center adaptor brackets vertically on back of screen.

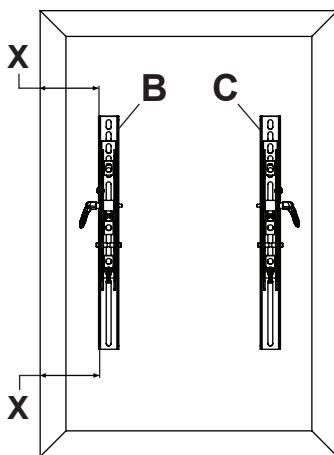
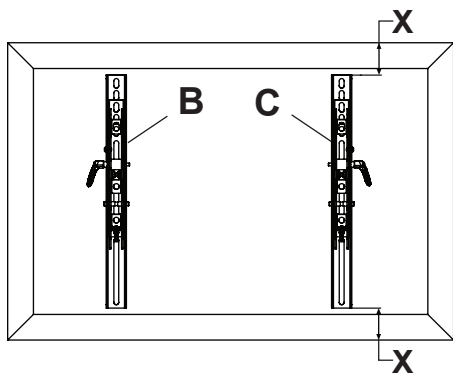

3a-2

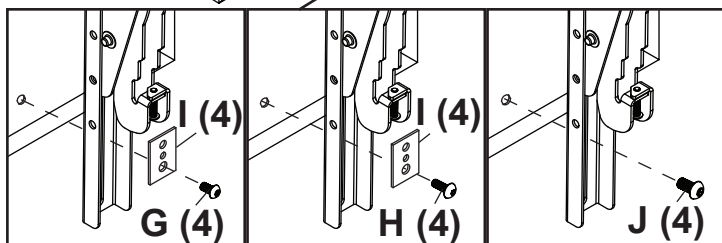
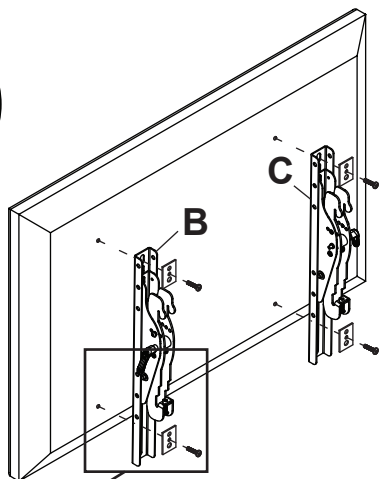
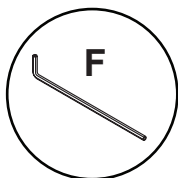

EE437Q, IB554Q-2.1,
C431, C501, C551, P404/
V404, P484/V484, P554/
V554, V323-3, V554Q

E507Q, E557Q, E657Q

IB654Q-2.1, IB754Q-2.1,
IB864Q-2.1, C651Q/V654Q,
C751Q/V754Q, C861Q/
V864Q, C981Q/V864Q

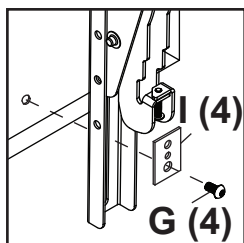

C431, C501, C551,
P404/V404, P484/
V484, P554/V554,
V323-3, V554Q

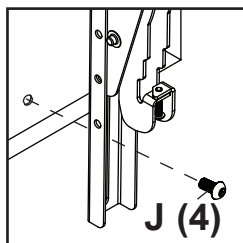
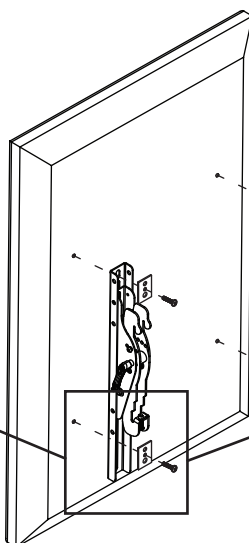

C651Q/V654Q,
C751Q/V754Q,
C861Q/V864Q,
C981Q/V864Q



3b

ENG Center adaptor brackets vertically on back of screen.

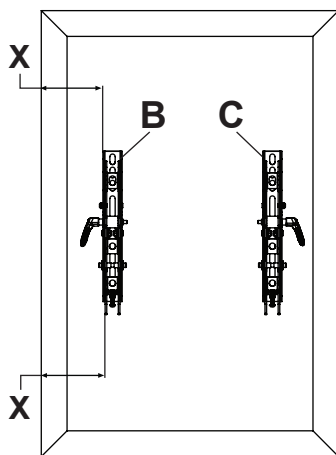
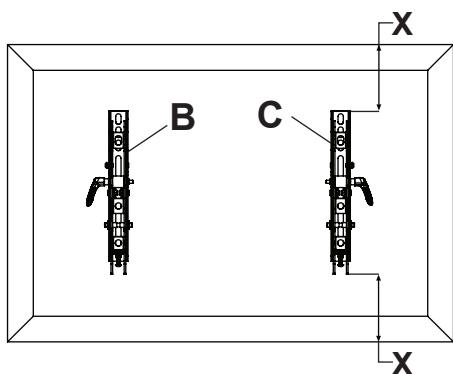

3b-1

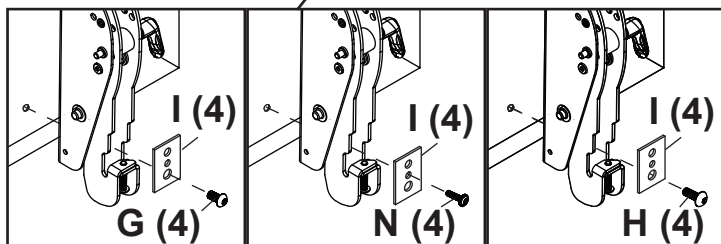
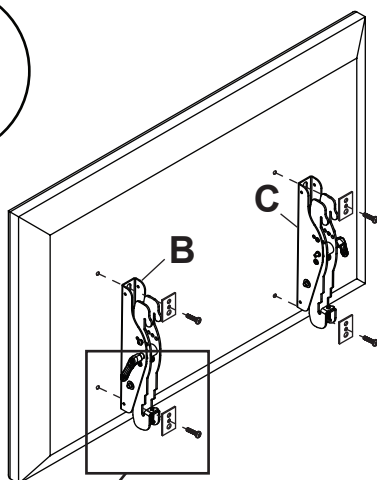
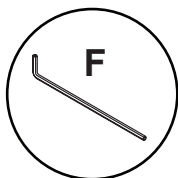

EE437Q, V323-3

E327

E507Q, E557Q, E657Q

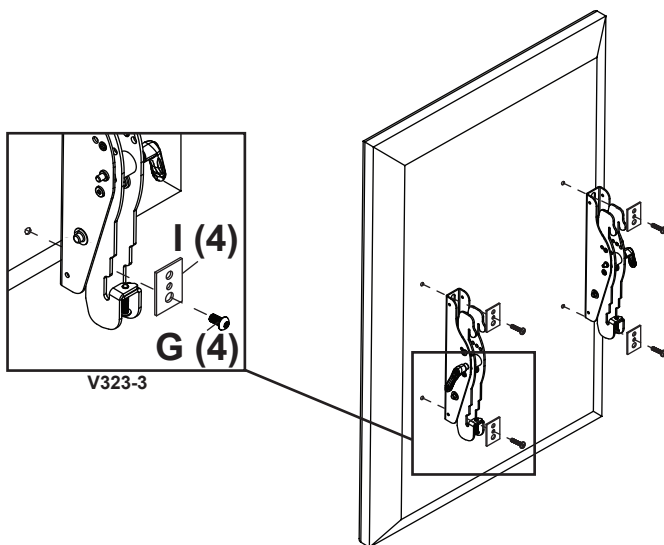

V323-3

4

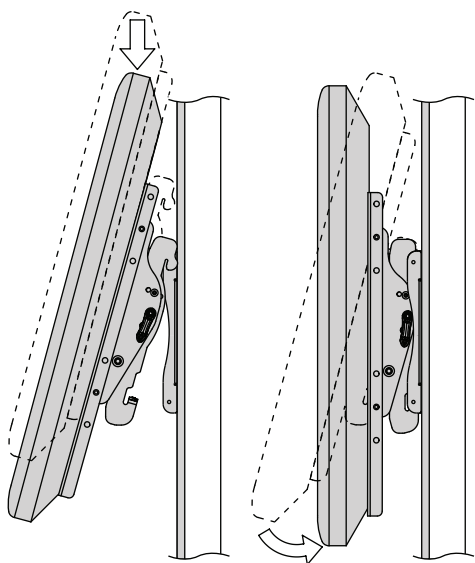

5

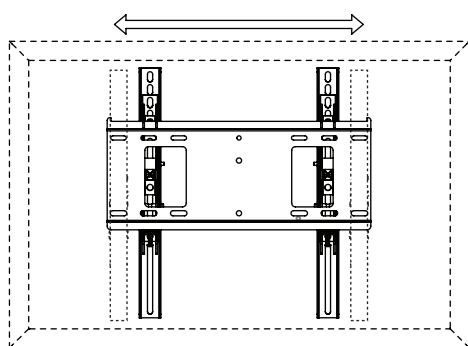

6

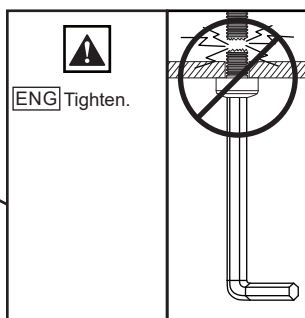
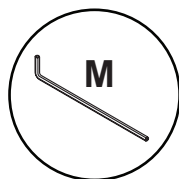
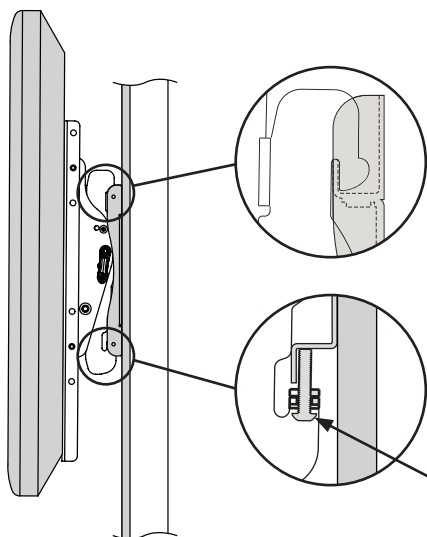

7

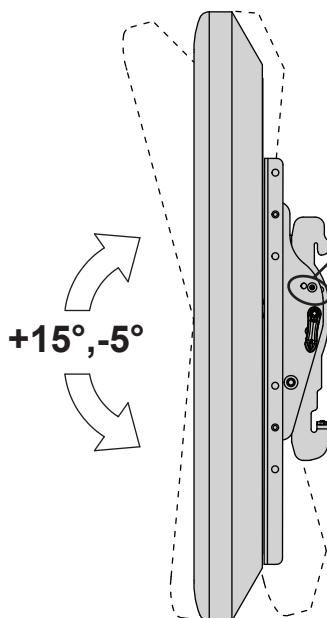
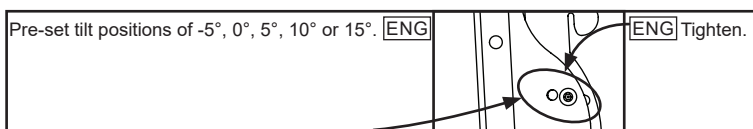
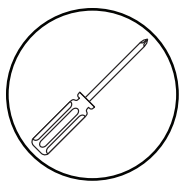

ENG	Warranty	ESP	Garantía	FRN	Garantie	DEU	Garantie	NEL	Garantie
ITL	Garanzia	ČES	Záruka	SLK	Záruka	POR	Garantia	TÜR	Garanti

www.peerless-av.com/warranty

NEC

Peerless-AV

2300 White Oak Circle
Aurora, IL 60502
Email: tech@peerlessmounts.com
Ph: (800) 865-2112
Fax: (800) 359-6500
www.peerless-av.com

© 2020, Peerless Industries, Inc.

Peerless-AV Europe

Unit 3 Watford Interchange,
Colonial Way, Watford, Herts,
WD24 4WP, United Kingdom
Customer Care
44 (0) 1923 200 100
www.peerless-av.com

© 2020, Peerless Industries, Inc.

Peerless-AV América Latina

Av. de las Industrias 413
Parque Industrial Escobedo
General Escobedo N.L., México 66062
Servicio al Cliente
01-800-849-65-77
www.peerless-av.com

© 2020, Peerless Industries, Inc.