

# 3G ULTRA 717 Wallplate Transmitter

VBS-HDIP-717WP2

Just Add  
**Power**

## HDMI, VGA, and All Lossless Audio Supported



The 3G Ultra 717WP2 Wallplate Transmitter fits into a 2-gang construction box and provides HDMI, VGA, and line audio inputs to any Just Add Power video distribution system.

Including all of the 4K system wide features found within the 3G Ultra Transmitters, this device can be paired with any 3G Ultra and or 2G Omega models to distribute any source to any zone.

### Features

<b>Audio</b>	All lossless audio supported  Stereo Audio Input	<b>KVM Support</b>	Provide local and remote access to all computers on the system with a built-in keyboard, mouse and touchscreen interface at both ends of a connection
<b>Colors</b>	Black, White or Custom	<b>Scalability</b>	Fully compatible with all 3G Ultra and 2G Omega products
<b>HDCP 2.2 Support</b>	Display content with HDCP 2.2 copy/content protection on any HDMI screen in system		
<b>Image Pull</b>	Preview an image from any source or display, in any web browser or control system, at up to 10 fps		

# 3G ULTRA 717 Wallplate Transmitter

VBS-HDIP-717WP2

Just Add  
**Power**

**Front of Device:**

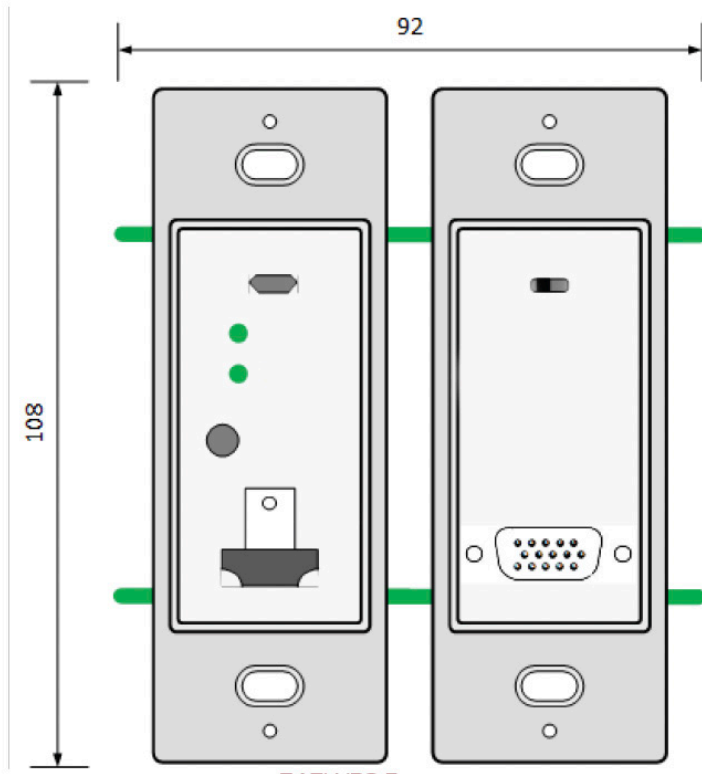

**Side of Device:**

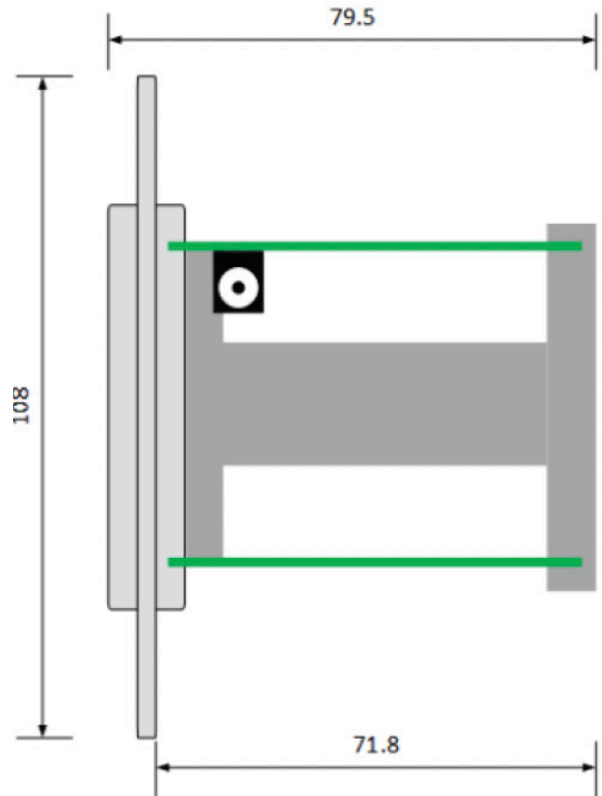

All measurements in millimeters (mm)

## Specifications

<b>Bandwidth</b>	180-500 Mbps	<b>POE</b>	10 watts maximum
<b>Compliance</b>	HDCP 2.2 RoHS/FCC/CE	<b>Ports</b>	Gigabit Ethernet HDMI In VGA In 3.5mm Line-in Micro-USB 2.0 5.5mm/2.1mm barrel
<b>Dimensions &amp; Weight</b>	108 x 92 x 79.5 mm 4.3" x 3.6" x 3.1" inch 0.09kg / 0.2 lb	<b>Power Supply (not included)</b>	~4.7-23V 5.5mm/2.1mm, Positive tip
<b>Encryption</b>	Hardware-Based AES 256-bit Encryption of network video signal		
<b>Operating Temp</b>	0-60 °C / 32-140 °F		

Specifications

Encoding/Decoding

Video Codec	AGIC-G1 Proprietary Visually Lossless Video Codec
Audio Codec	Proprietary I2S Lossless Audio Codec
Bit Rates	300 to 850 Mbps
Latency	Ultra-low latency 16ms @ 1080p60 & 720p60 33ms @ 4K30
Streaming Protocols	IP, UDP, TCP, ICMP, IGMP
Copy Protection	HDCP 2.2, AES-128 Encryption

Video

Maximum Resolutions	High Dynamic Range HDR10 4K30 4:4:4 HDR 8-bit 4K30 4:2:0 HDR 12-bit 1080p60 4:4:4 HDR 12-bit
Input Signal Types (Encoder)	HDMI
Output Signal Types	HDMI
Scaler (Decoder)	720p up to 4K30 with many options inbetween

Audio

Input Signal Types	HDMI, Analog Stereo
Output Signal Types	HDMI, Analog Stereo
Digital Formats	Dolby Atmos, DTS:X, Dolby TrueHD, DTS-HD, Dolby Digital, Dolby Pro Logic, DTS, LPCM up to 8 channels
Analog Formats	Stereo 2-channel up to 96 kHz

Power

Power Consumption	10 watts maximum during operation 0 watts when idle
-------------------	--------------------------------------------------------

Compliance

CE, FCC, RoHS

Communication & Control of External Devices

Ethernet	1Gb RJ-45 for control and AV
USB	USB 2.0
Serial/RS-232	Bi-directional control and monitoring
HDMI	CEC, EDID (Transmitter)
Infrared (IR)	Available with add-on

Connectors

LAN	8-pin female RJ-45 1000Base-T POE (802.3af)
HDMI Input	HDMI Type A female
HDMI Outputs (Transmitter loopout & Receiver output)	HDMI Type A female
RS232	3.5mm female
Stereo Output	3.5mm female
USB (Receiver)	USB Type-A female (x2)
USB (Transmitter)	Micro-USB female (x1)

Environmental

Cooling	Convection / no fan (no moving parts)
Temperature	0-60 C / 32-140 F
Heat Dissipation	34 BTU/hr
Acoustic Noise	0 dBA