

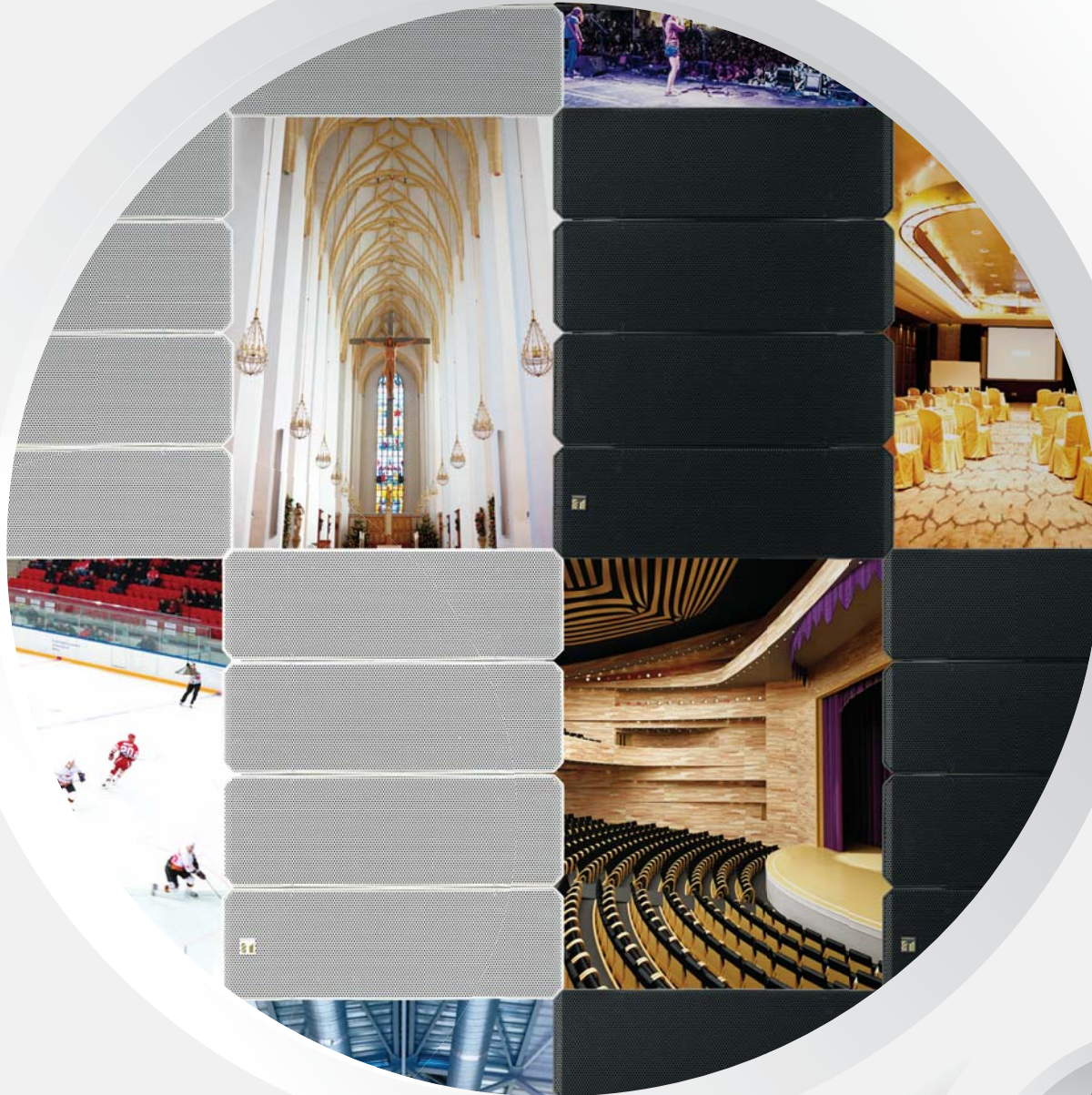

# HX-7

Variable Dispersion  
Speaker



# From a Whisper to a Scream

Introducing the all new HX-7 variable dispersion line array with SYNC-Drive™ waveguide technology. Thanks to its award winning enclosure design, employing four modules per unit, the HX-7 allows precise adjustment of sound dispersion angles of 0 - 15 - 30 and 45 degrees.

Offering pristine clarity in a wide range of applications from sports venues, auditoriums, concert hall and challenging houses of worship. With the HX-7 you're getting affordable quality and stellar performance. What you get is all that can be heard, from a whisper to a scream, TOA has it covered.



## Application examples



Stadiums



Houses of worship



Arenas/Indoor sports facilities



Auditoriums

## Meets the need for powerful audio

- Power handling: 750W Continuous Program@8 ohms
- Sensitivity (1W,1m): 100 dB



- 2 x 5.5" LF speakers.
- Waveguide loaded 1" HF compression driver.



- Design consists of four integrated speaker "cells" that can be adjusted to optimize the vertical dispersion angle.

## Increases coverage and enhances intelligibility

- Built-in isophasic wavefront control horn ensures precise HF control and superior reproduction of HF sounds.

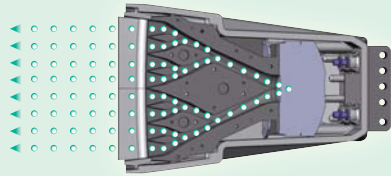

High frequencies compression driver

- Newly added 0° mode facilitates the most effective line array set-up.

\* 60° mode is also available with optional HY-60D brackets.

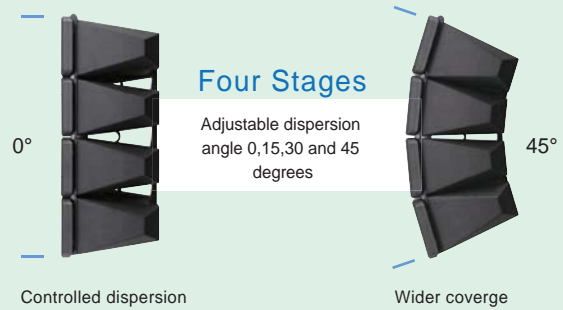

## Offers ease of installation

- Easily adjustable vertical dispersion angle.

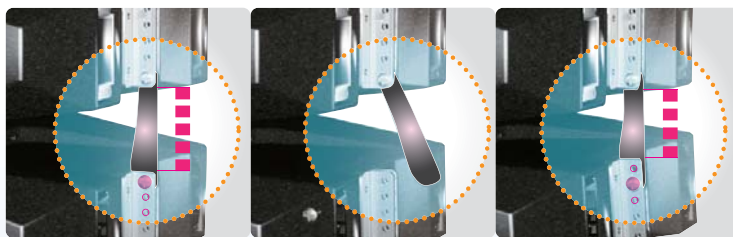

0° mode

15° mode

## Multi unit configuration

- Maximum two speaker units can be stacked.



## Lineup of HX-7 Series

- High / mid-range unit
- Low-range unit



HX-7B/HX-7B-WP



HX-7W/HX-7W-WP



FB-150B



FB-150W

\* "-WP" is weather-proof type.

## More compact version - HX-5 Series

- Power handling: 600W Continuous Program@8 ohms
- Sensitivity (1W,1m): 96 dB @60°mode to 99 dB@15°mode
- Components: 4 x 4.72" cone-type LF drivers and 12 x 1" balanced dome tweeters
- Dimensions(WxHxD): 408 x 546 x 342 mm (16.1" x 21.5" x 13.5")



HX-5B/HX-5B-WP



HX-5W/HX-5W-WP

## Specifications

Speaker	HX-7B / HX-7W
Enclosure	Bass-reflex type
Power Handling Capacity	Continuous pink noise: 250 W (IEC60268-5: 350 W) Continuous program: 750 W
Rated Impedance	8 Ω
Sensitivity	100 dB (1 W, 1 m)
Frequency Response	75 Hz - 20 kHz
Crossover Frequency	1.7 kHz
Directivity Angle	Horizontal: 100° Vertical: Depending on directivity angle mode
Speaker Component	Low frequency: 13 cm (5.5") cone-type x 8 High frequency: Wave front control horn with compression driver x 4
Input Terminal	Speakon NL4MP x 2 and M4 screw terminal, distance between barriers: 9 mm (0.35")
Finish	Enclosure: Polypropylene, black or white (HX-7B/W) Punched net: Surface-treated steel plate, black or white (HX-7B/W), paint Hanging bracket: Steel plate, t3.0, black or white (HX-7B/W), paint
Dimensions	497 (W) x 664 (H) x 274 (D) mm (19.57" x 26.14" x 10.79")
Weight	30 kg (66.14 lb)
Accessory	Hanging bracket L, R (L and R are symmetrical to each other.) ...1 each Hanging bracket mounting bolt ...4
Option	Speaker stand adapter: HY-ST7 Matching transformer: MT-200 - (Transformer Adapter: HY-MT7 Required) Matching transformer adapter: HY-MT7  Speaker mounting bracket: HY-60DB, HY-CN7B, HY-PF7B, HY-WM7B/W, HY-VM7B/W, HY-C0801 <b>**NOTE:</b> for wall mounting bracket HY-WM7B/W, it requires HY-VM7B/W rigging bracket <b>**NOTE:</b> for ceiling mount bracket HY-C0801, it requires HY-VM7B/W rigging bracket

Speaker (Weather-proof)	HX-7B-WP / HX-7W-WP
Enclosure	Sealed type
Power Handling Capacity	Continuous pink noise: 250 W (IEC60268-5: 350 W) Continuous program: 750 W
Rated Impedance	8 Ω
Sensitivity	100 dB (1 W, 1 m)
Frequency Response	105 Hz - 20 kHz
Crossover Frequency	1.7 kHz
Directivity Angle	Horizontal: 100° Vertical: Depending on directivity angle mode
Speaker Component	Low frequency: 13 cm (5.5") cone-type x 8 High frequency: Wave front control horn with compression driver x 4
Input Terminal	M4 screw terminal, distance between barriers: 9 mm (0.35")
Water Protection	IPX4 (Install with every speaker module tilted downward from the horizontal.)
Finish	Enclosure: Polypropylene, black or white (HX-7B/W-WP) Punched net: Surface-treated steel plate, black & white (HX-7B/W-WP), rust proof coating
Dimensions	497 (W) x 664 (H) x 274 (D) mm (19.57" x 26.14" x 10.79")
Weight	30 kg (66.14 lb)
Accessory	Terminal cover ...1, Terminal cover mounting screw ...4 Rubber packing ...1
Option	Matching Transformer: MT-200 (*1) Matching Transformer Adapter: HY-MT7 Speaker mounting bracket: HY-TM7B/W-WP, HY-MS7B/W-WP, HY-60DB/W-WP, HY-CN7B/W-WP

Subwoofer	FB-150B / FB-150W
Power Handling Capacity	Continuous pink noise: 200 W Continuous program: 600 W
Impedance	8 Ω
Sensitivity	93 dB (1 W, 1 m)
Frequency Response	40 Hz - 400 Hz (-10 dB)
Speaker Component	38 cm (15") cone-type
Input Terminal	Speakon NL4MP x 2 and M5 screw terminal, distance between barriers: 12.2 mm (0.48")
Finish	Enclosure: MDF, black or white (FB-150B/W), urethane paint Punched net: Surface-treated steel plate, black & white (FB-150B/W), paint
Dimensions	505 (W) x 528 (H) x 477 (D) mm (19.88" x 20.79" x 19.17")
Weight	30 kg (66.14 lb)
Option	Speaker rigging frame: HY-PF7B/W

**\*Note:** To set the speaker angel mode to "60" mode," 3 pieces of the optional HY-60DB Speaker Angle Brackets are required.

## TOA Canada Corporation

Tel: 1-800-263-7639; Fax: 1-800-463-3569  
sales@toacanada.com • www.TOAcanda.com

Specifications are subject to change without notice. (1610) 833-61-100-17-00

## Optional Accessories

### Speaker Connection Bracket



### Angle Adjustment Bar



### Rigging Frame



### Rigging Bracket



### Wall Mounting Bracket



### Rigging Bracket



### Wall Mounting Bracket



### Matching Transformer Adapter

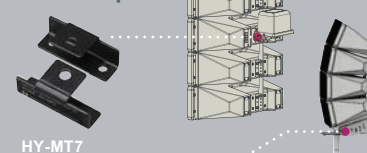

### Speaker Stand Adapter

