

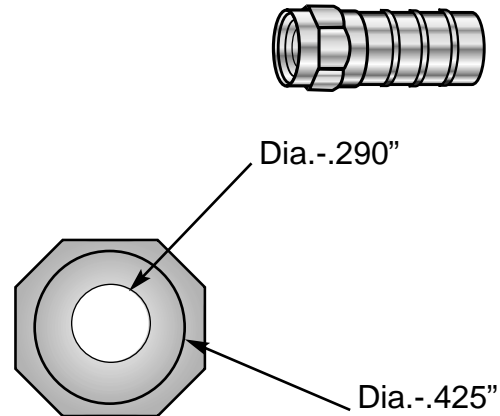

CN-F56TFE

RG6/U PLENUM "F" TYPE CONNECTOR

Rev. 1. 5/05

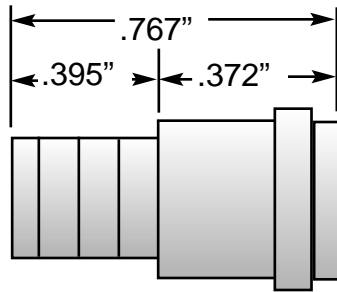

NOT TO SCALE

Step 1:

Strip 1/2" of the jacket to expose the braid shield.

**Step 2:**

Bend the exposed shield wire back over the outer jacket. Do not disturb the foil shield beneath the shield.

**Step 3:**

Strip core back to expose conductor 1/4".

**Step 4:**

Slide the shank of the "F" connector over the foil shield and under the braid shield. Push the connector onto the cable, until the shoulder of the connector is firmly seated against the braid shield. Crimp connector with proper tool as recommended by your connector manufacturer.

CRIMP TOOL-
STRIP TOOL-TL-111
TL-120CABLES:
256350, 25841**WEST PENN WIRE**2833 WEST CHESTNUT STEET
WASHINGTON, PA 15301
800-245-4964
www.westpenn-cdt.com
info@westpenn-cdt.com