

Access & Power Integration

## Altronix/Mercury Wired Kits

### Models Include:

#### 4 Door Kits with Fused Outputs:

### T1M1LCK1

Accommodates one (1) Intelligent Dual Reader Controller and one (1) Dual Reader Interface Modules.

#### 2 Door Kits with Fused Outputs:

### T1M1LCK2

Accommodates one (1) Intelligent Controller and one (1) Dual Reader Interface Module.

#### 4 Door Kits with Fused Outputs:

### T1M1LCK3

Accommodates up to two (2) Dual Reader Interface Modules.

#### Each fully assembled kit includes:

- Trove1 enclosure with TM1 Altronix/Mercury backplane
- One (1) AL400ULXB2 - Power Supply/Charger
- One (1) ACM4 - Fused Access Power Controller
- One (1) PDS8 - Dual Input Fused Power Distribution Module
- One (1) VR6 - Voltage Regulator
- One (1) Rocker Switch Bracket with One (1) Rocker Switch

#### 4 Door Kits with PTC Outputs:

### T1M1LCK1D

Accommodates one (1) Intelligent Dual Reader Controller and one (1) Dual Reader Interface Module.

#### 2 Door Kits with Fused Outputs:

### T1M1LCK2D

Accommodates one (1) Intelligent Controller and one (1) Dual Reader Interface Module.

#### 4 Door Kits with Fused Outputs:

### T1M1LCK3D

Accommodates up to two (2) Dual Reader Interface Modules.

#### Each fully assembled kit includes:

- Trove1 enclosure with TM1 Altronix/Mercury backplane
- One (1) AL400ULXB2 - Power Supply/Charger
- One (1) ACM4CB - PTC Access Power Controller
- One (1) PDS8CB - Dual Input PTC Power Distribution Module
- One (1) VR6 - Voltage Regulator
- One (1) Rocker Switch Bracket with One (1) Rocker Switch

All components of these Trove kits are UL Listed sub-assemblies.

Please refer to the included corresponding Sub-Assembly Installation Guides for further information.

## Installation Guide



More than just power.™

All registered trademarks are property of their respective owners.

Rev. 020922

Installing Company: \_\_\_\_\_ Service Rep. Name: \_\_\_\_\_

Address: \_\_\_\_\_ Phone #: \_\_\_\_\_

## Overview:

Altronix Trove Plus kits are pre-wired, pre-assembled and consist of Trove1M1 enclosure/backplane with factory installed Altronix power supply/charger and sub-assemblies, wire harnesses and finger duct.

## Configuration Chart:

Altronix Model Number	115VAC 60Hz Input Current (A)	Power Supply Board Input Fuse Rating	Power Supply Board Battery Fuse Rating	Nominal DC Output Voltage		Maximum Supply Current for Main Outputs on Power Supply board and ACM4(CB) Access Power Controller's outputs	Fail-Safe/Fail-Secure or Dry Form "C" Outputs	ACM4(CB) Board Input Fuse (PTC) Rating	ACM4(CB) Board Output Fuse (PTC) Rating	PDS8(CB) Board Input Fuse (PTC) Rating	PDS8(CB) Board Output Fuse (PTC) Rating
				Power Supply 1	Power Supply 2						
				Output Range (VDC)	Output Range (VDC)						
T1M71LCK1	3.0	5A/ 250V	15A/ 32V	20.17- 26.4	20.17- 26.4	24VDC @ 3.8A	4	10A/ 250V	3A/ 250V	10A/ 250V	3A/ 250V
T1M71LCK2											
T1M71LCK3											
T1M71LCK1D											
T1M71LCK2D											
T1M71LCK3D											

## Installation Instructions:

Wiring methods shall be in accordance with the National Electrical Code/NFPA 70/ANSI, and with all local codes and authorities having jurisdiction. Product is intended for indoor use only.

1. Remove backplane from enclosure. Do not discard hardware.
2. Mark and predrill holes in the wall to line up with the top three keyholes in the enclosure. Install three upper fasteners and screws in the wall with the screw heads protruding. Place the enclosure's upper keyholes over the three upper screws; level and secure. Mark the position of the lower three holes. Remove the enclosure. Drill the lower holes and install the three fasteners. Place the enclosure's upper keyholes over the three upper screws. Install the three lower screws and make sure to tighten all screws.
3. Mount included UL Listed tamper switch (Altronix Model TS112 or equivalent) in desired location, opposite hinge. Slide the tamper switch bracket onto the edge of the enclosure approximately 2" from the right side (*Fig. 1, pg. 2*). Connect tamper switch wiring to the Access Control Panel input or the appropriate UL Listed reporting device. To activate alarm signal open the door of the enclosure.
4. Mount Mercury modules to backplane(s), refer to *page 3*.
5. Refer to the *ULXB Power Supply/Charger Installation Guide* for AL400ULXB2 and corresponding *Installation Guides* for PDS8(CB), VR6, and ACM4(CB) for further installation instructions.

Fig. 1

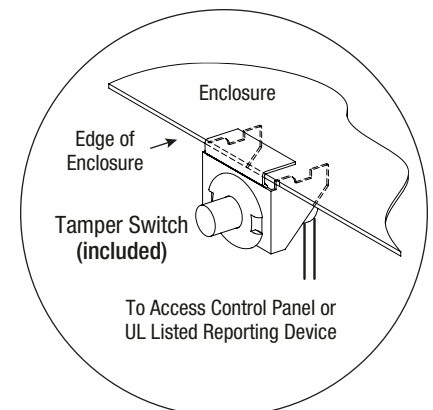

## T1M1LCK1(D): Configuration of Mercury Boards:

1. Position access controller module over corresponding spacers and depress onto snap on spacers (Fig. 3, pg. 4).
2. Mount backplane to enclosure with hardware.

### Access Controller Position Chart for the Following Models:

Mercury Access Controller	Pem Mounting
LNL-2220 / LP1502 / LP4502	(A)
LNL-1320 / MR52	(B)

Fig. 2

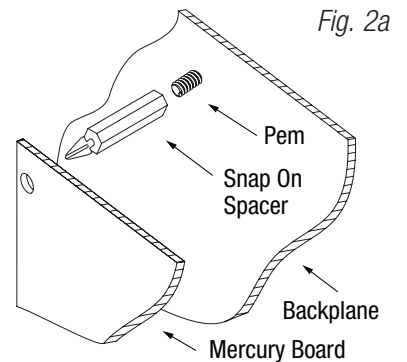
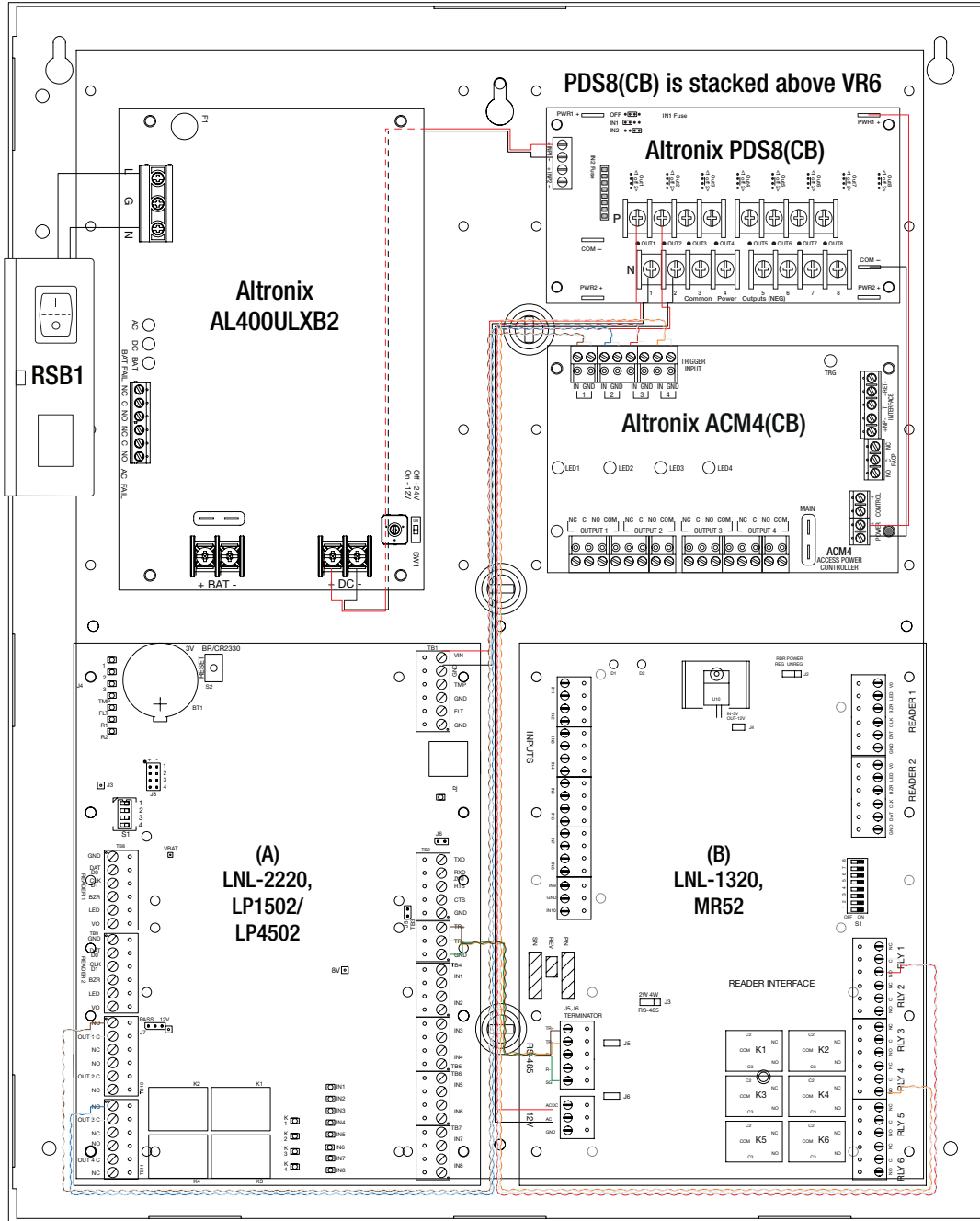

Fig. 2a

## T1M1LCK2(D): Configuration of Mercury Boards:

1. Position access controller module over corresponding spacers and depress onto snap on spacers (Fig. 3, pg. 4).
2. Mount backplane to enclosure with hardware.

### Access Controller Position Chart for the Following Models:

Mercury Access Controller	Pem Mounting
LNL-3300 / LP2500	(A)
LNL-1320 / MR52	(B)

Fig. 3

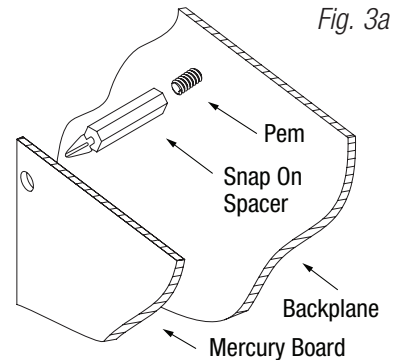
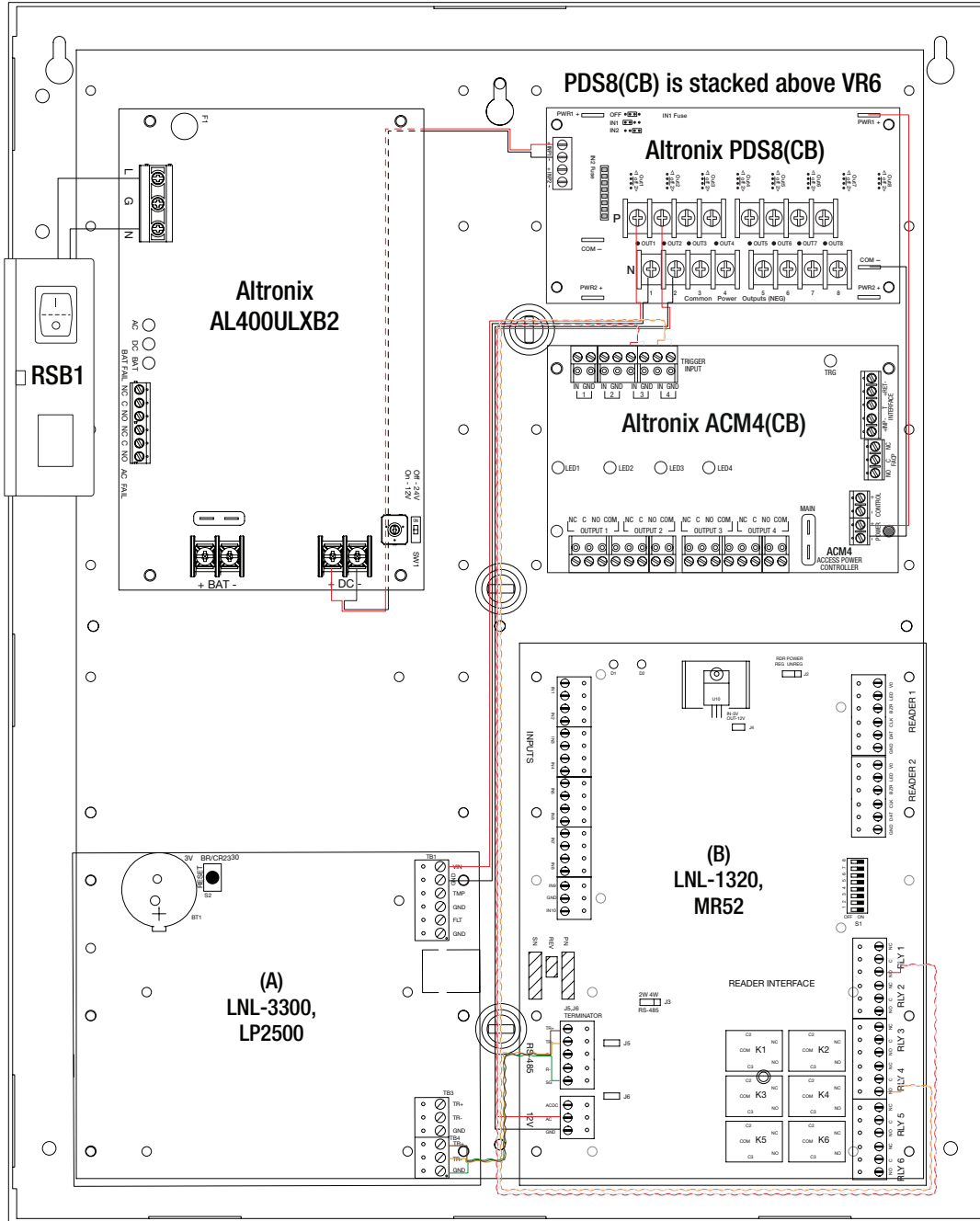

Fig. 3a

## T1M1LCK3(D): Configuration of Mercury Boards:

1. Position access controller module over corresponding spacers and depress onto snap on spacers (Fig. 3, pg. 4).
2. Mount backplane to enclosure with hardware.

### Access Controller Position Chart for the Following Models:

Mercury Access Controller	Pem Mounting
LNL-1320 / MR52	(A)
LNL-1320 / MR52	(B)

Fig. 3

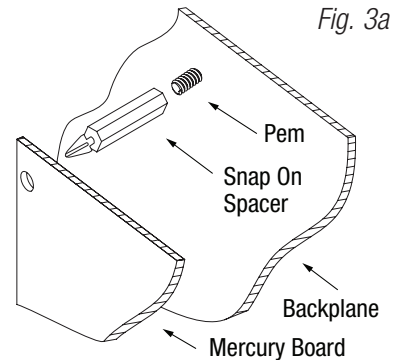
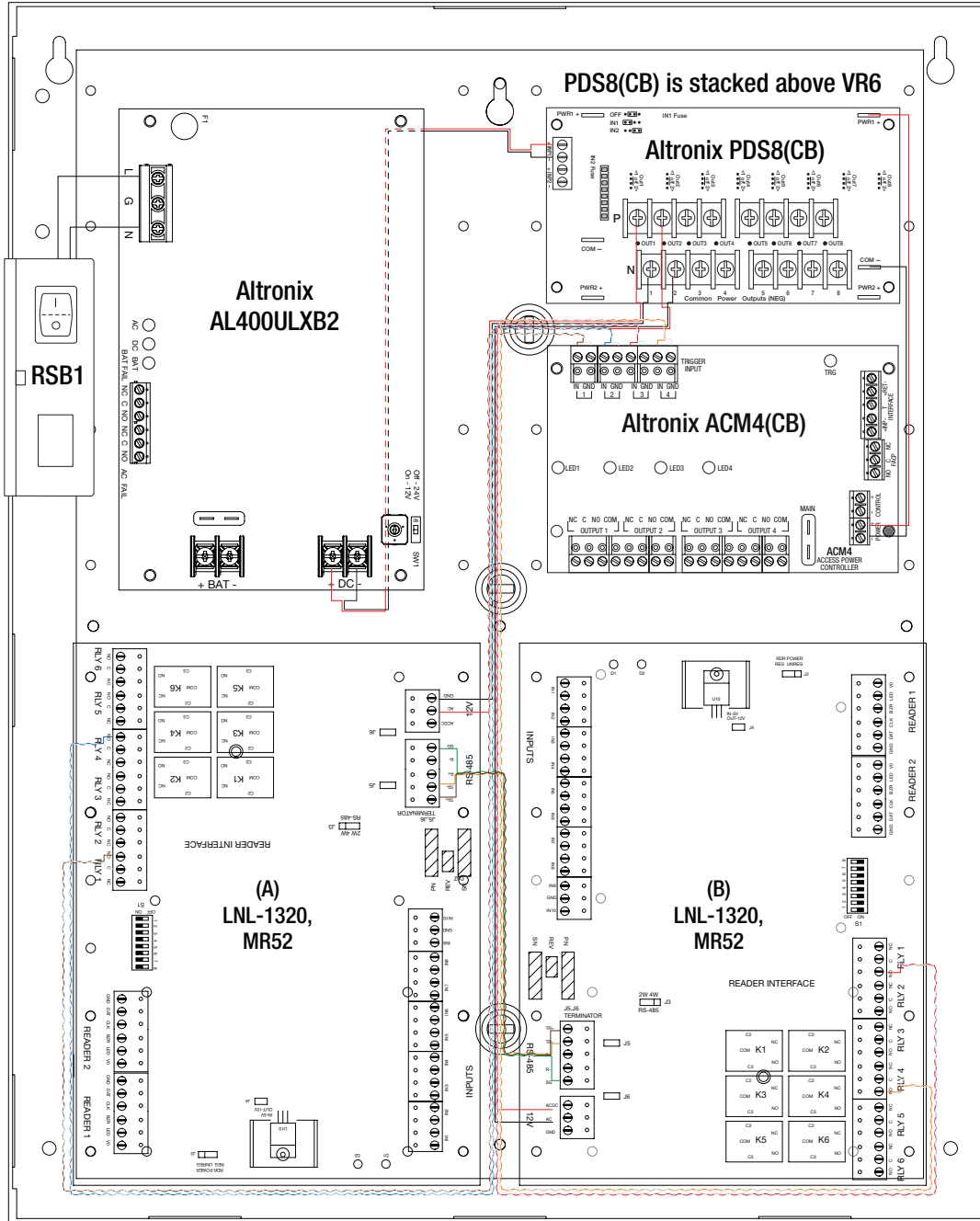

Fig. 3a

## Notes:

## Notes:

# Trove1 Enclosure Dimensions (H x W x D approximate):

18" x 14.5" x 4.625" (457mm x 368mm x 118mm)

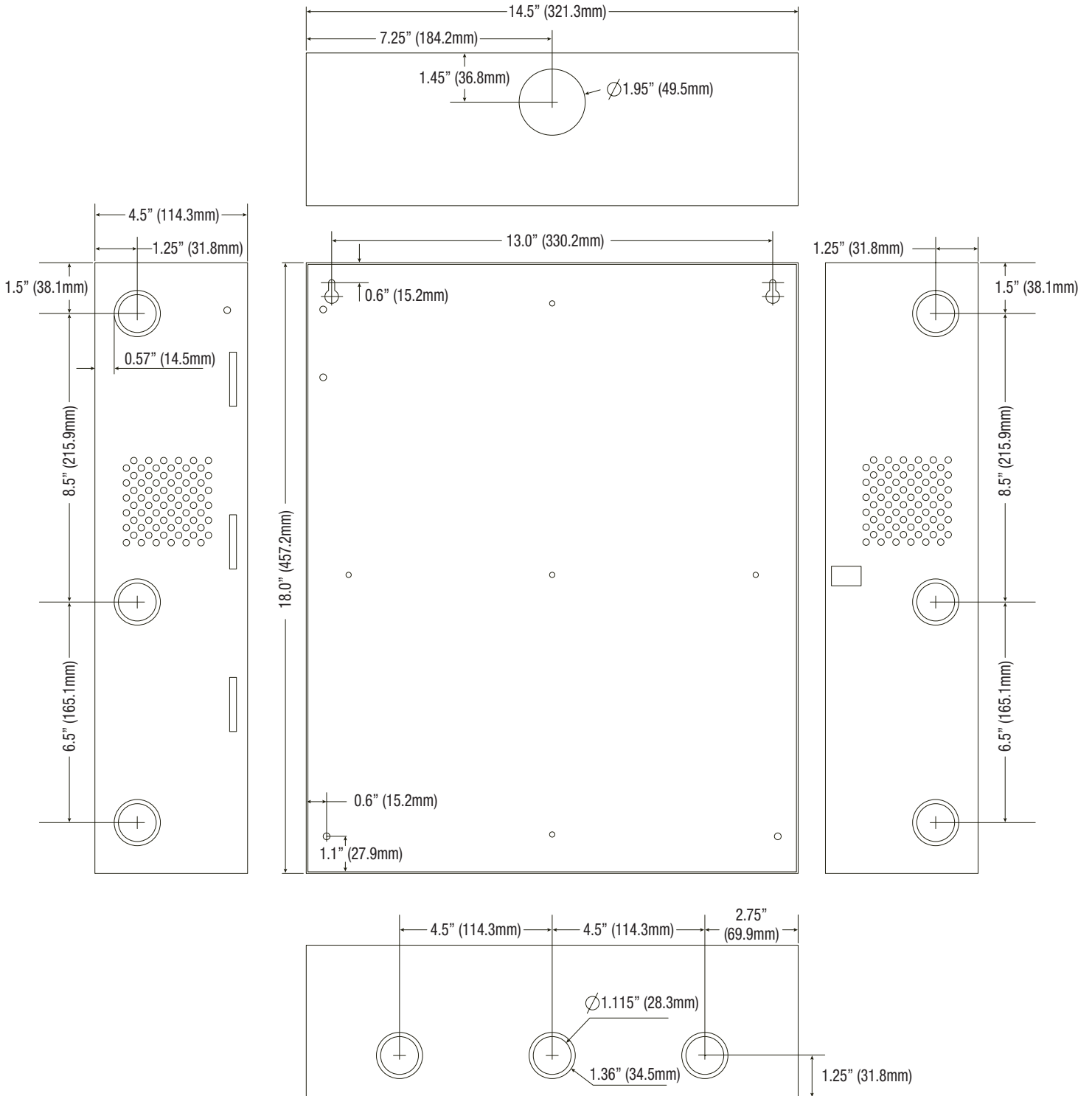

Altronix is not responsible for any typographical errors. Product specifications are subject to change without notice.

140 58th Street, Brooklyn, New York 11220 USA | phone: 718-567-8181 | fax: 718-567-9056  
 website: [www.altronix.com](http://www.altronix.com) | e-mail: [info@altronix.com](mailto:info@altronix.com) | Lifetime Warranty  
 IIT1M1LCK Series

L16V

