



BALCK BACK CAN Q-HY-BC1

DESCRIPTION:

The Q-HY-BC1 Back Can (suspension) is a metal case that can be attached to a flush-mount ceiling speaker when mounted in exposed applications. Ideal for TOA's F-122C, F-2322C, F-2352C or F-2352SC. With 4 knockouts on the side, it permits the Electrical Contractor to install the Back Can prior to the speaker installation by connecting and pulling the cables. The Back Can could also be used in exposed ceiling and can be hung from a ceiling suspension pipe.

SPECIFICATIONS:

Finish	Surface-treated steel plate, t0.8, black paint
Weight	1.5 kg
Accessory	Rubber grommet x 2

APPEARANCE:





BLACK BACK CAN Q-HY-BC1

DESCRIPTION:

The Q-HY-BC1 Back Can (suspension) is a metal case that can be attached to a flush-mount ceiling speaker when mounted in exposed applications. Ideal for TOA's F-122C, F-2322C, F-2352C or F-2352SC. With 4 knockouts on the side, it permits the Electrical Contractor to install the Back Can prior to the speaker installation by connecting and pulling the cables. The Back Can could also be used in exposed ceiling and can be hung from a ceiling suspension pipe.

SPECIFICATIONS:

Finish	Surface-treated steel plate, t0.8, black paint
Weight	1.5 kg
Accessory	Rubber grommet x 2

APPEARANCE:

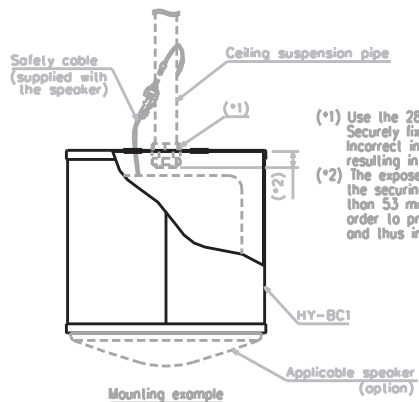
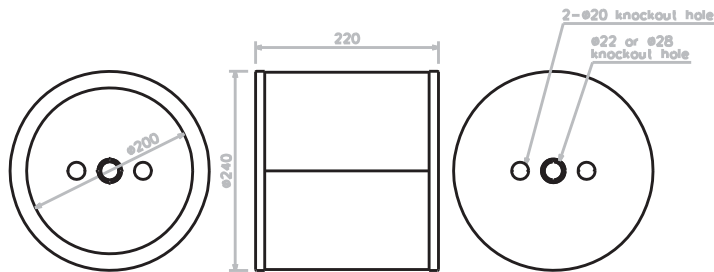

- (*) Use the 28 mm hole for the suspension pipe mounting. Securely fix to a pipe or fittings. Incorrect installation may cause the joint part to break, resulting in the fall of the Back Can.
- (*) The exposed length of the suspension pipe on which the securing nut will be tightened must be no longer than 53 mm (26 mm when the F-122CU is used) in order to prevent the bolt from contacting the speaker and thus interfering with correct installation.