



Product Data Sheet

IM Series: IM-12550B (UT-12550)

12 Volt, 55.0 Amp. Hour

Specifications

Rated Voltage	12V	
Nominal Capacity	55.0Ah	(C ₁₀ , 1.80V/cell, 20hr)
Dimension	Length	9.02 inches (229mm)
	Width	5.43 inches (138mm)
	Container Height	8.07 inches (205mm)
	Total Height	8.31 inches (211mm)
Approx Weight	35.7 lbs. (16.2kg)	
Terminal	B	
Container Material	ABS	
Rated Capacity (25°C)	57.2Ah	(20hr, 2.86A, 1.80V/cell)
	55.0Ah	(10hr, 5.50A, 1.80V/cell)
	47.3Ah	(5hr, 9.46A, 1.75V/cell)
	42.9Ah	(3hr, 14.3A, 1.75V/cell)
	33.6Ah	(1hr, 33.6A, 1.60V/cell)
Max. Discharge Current	550A (5s)	
Internal Resistance (25°C)	Approx 9mΩ	
Operating Temp. Range	Discharge	5 ~ 122°F (-15 ~ 50°C)
	Charge	-4 ~ 104°F (-20 ~ 40°C)
	Storage	5 ~ 104°F (-15 ~ 40°C)
Nominal Operating Temp. Range	77±5°F (25±3°C)	
Standby/Float Use	Initial Charging Current less than 16.5A. Voltage	
	13.5V~13.8V at 77°F (25°C) Temp. Coefficient -10mV/°F	
Temperature Effect on Capacity	104°F (40°C)	103%
	77°F (25°C)	100%
	32°F (0°C)	86%

Self Discharge

IM series batteries may be stored for up to 6 months at 77°F (25°C) and then a freshening charge is required. For higher temperatures- time interval will be shorter.



Layout

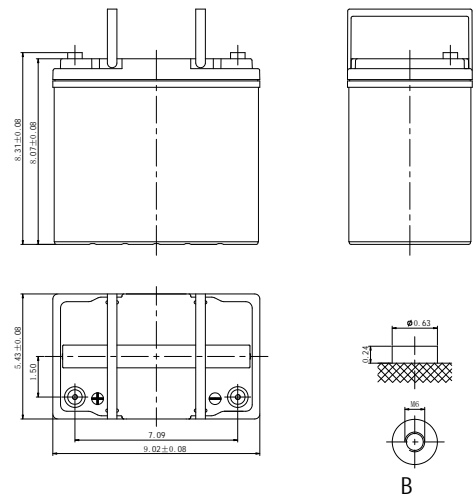

Constant Current Discharge (Amperes) at 77°F (25°C)

F.V/Time	5min	10min	15min	20min	30min	45min	1h	1.5h	2h	3h	4h	5h	6h	8h	10h	20h
1.85V/cell	94.1	74.0	62.9	52.6	41.8	31.7	25.9	19.6	16.5	13.1	10.7	8.60	7.49	6.08	5.19	2.83
1.80V/cell	126.4	94.6	76.0	62.2	49.4	36.8	29.0	21.7	18.0	14.1	11.4	9.23	8.03	6.45	5.50	2.86
1.75V/cell	142.5	103.9	83.1	66.9	51.3	38.2	30.4	22.6	18.7	14.3	11.6	9.46	8.25	6.56	5.56	2.89
1.70V/cell	156.9	113.3	88.7	70.4	53.3	39.7	31.3	23.4	19.4	14.7	11.9	9.71	8.42	6.65	5.61	2.94
1.67V/cell	173.0	122.2	94.3	74.7	56.3	40.7	32.4	24.1	20.0	15.3	12.4	9.98	8.61	6.75	5.73	2.98
1.60V/cell	190.8	132.7	100.8	79.6	59.4	42.5	33.6	25.0	20.7	15.8	12.7	10.3	8.79	6.82	5.79	3.00

CO.V - Cutoff Voltage/cell. The battery is fully charged & being discharged to COV.

Constant Power Discharge (Watts/cell) at 77°F (25°C)

F.V/Time	5min	10min	15min	20min	30min	45min	1h	1.5h	2h	3h	4h	5h	6h	8h	10h	20h
1.85V/cell	172.1	136.7	117.4	99.2	79.7	60.9	50.0	38.1	32.1	25.5	20.9	16.9	14.7	12.0	10.3	5.61
1.80V/cell	228.6	172.6	140.0	115.6	92.7	70.2	55.7	41.8	34.8	27.2	22.2	18.0	15.7	12.7	10.9	5.66
1.75V/cell	252.2	186.6	151.0	123.1	95.4	72.2	58.0	43.3	35.9	27.6	22.6	18.4	16.1	12.9	11.0	5.70
1.70V/cell	270.0	198.8	159.0	128.4	98.7	74.8	59.7	44.8	37.3	28.4	23.1	18.9	16.4	13.0	11.1	5.81
1.67V/cell	293.6	212.6	167.8	135.4	103.3	76.0	61.2	45.8	38.1	29.4	23.8	19.3	16.7	13.2	11.3	5.88
1.60V/cell	316.3	225.5	176.5	142.7	108.3	78.8	63.1	47.2	39.2	30.2	24.5	19.9	17.0	13.3	11.4	5.90

CO.V - Cutoff Voltage/cell. The battery is fully charged & being discharged to COV.



Product Data Sheet

IM Series: IM-12550B (UT-12550)

12 Volt, 55.0 Amp. Hour

Applications

- All purpose
- Uninterruptable Power Supply (UPS)
- Electric Power System (EPS)
- Emergency backup power supply
- Alarm and security system
- Communication power supply
- DC power supply
- Auto control system

General Features

- 5 years design life (77°F)
- Special exhaust structure and sealing technology, safe and reliable, flexible installation, convenient maintenance
- High purity PbCaSn raw material alloy is used for plate grids, assuring less gassing and low self-discharging rate
- High quality AGM separator extends cycle life and prevents micro short circuit

Standards

- Compliance with IEC 60896 standards, EU Battery Directive
- UL, CE Certified
- Manufactured in IATF16949, ISO45001, ISO 9001 and ISO 14001 certified production facilities



Discharge Characteristics

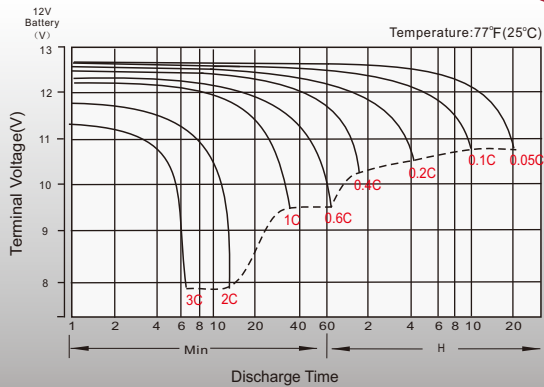

Curves represent Constant Current draw (Amp.)
 1C curve = 1 x Nominal capacity = 7.5amp. constant draw 0.05C curve = 0.05 x Nominal capacity = 0.375amp. draw

Standby/Float Charging Characteristics

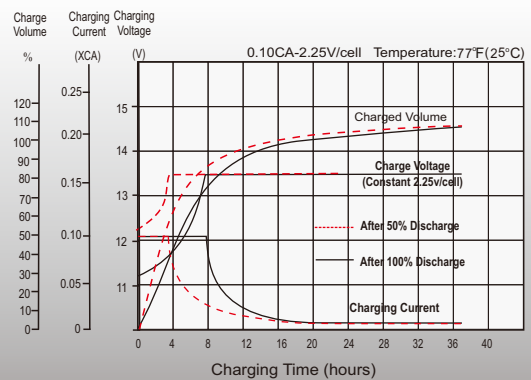

Temperature Effects on Battery Capacity

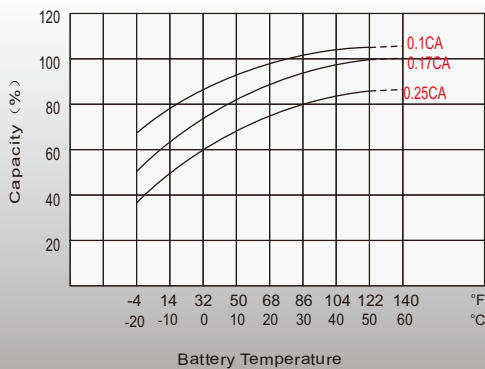

Temperature Effects on Long-Term Float Life

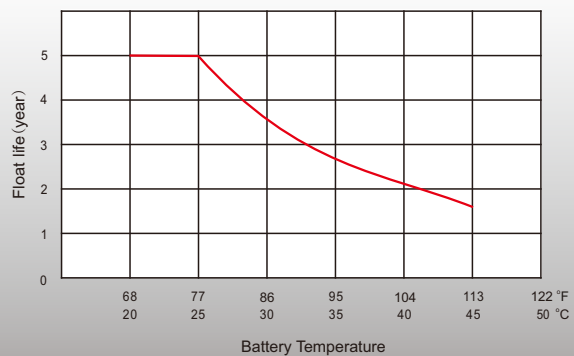

Sales Offices

Sales: 1.800.233.6261

Website: www.adiglobaldistribution.us
www.adiglobaldistribution.ca