

INSTALLATION INSTRUCTIONS



LASER WINDOW RLS-LW

1 INTRODUCTION

1-1 PRECAUTIONS

- Read this instructions carefully prior to installation.
- This instructions uses the following warning indications to provide information regarding correct usage of the product to prevent harm and damages to assets. These warning indications are described below. Ensure these precautions before reading the rest of this instructions.

Warning Failure to follow the instructions provided with this indication and improper handling may cause death or serious injury.

Caution Failure to follow the instructions provided with this indication and improper handling may cause injury and/or property damage.

Prohibition This symbol indicates prohibition. The specific prohibited action is provided in and/or around the figure.

Instruction This symbol requires an action or gives an instruction.

Caution

Use exclusively with the RLS-2020 series.



1-2 PARTS IDENTIFICATION

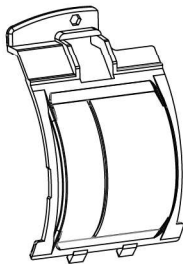

Laser Window: x1

Caution >>

Dust and moisture may affect the performance. The replacement should be done in the condition that rain and dust do not enter the unit.

2 REPLACEMENT

1 Loosen the screw on the front window and pull the front cover forward.

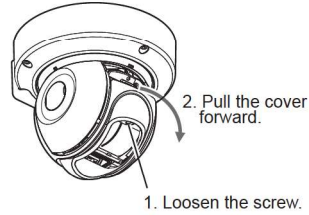

2 Rotate the front cover at opposite side of the screw upward and remove the hooks (x2).

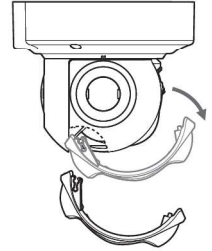

3 As shown in the figure below, use the supplied allen key to put out the hook upward in a leverage motion.

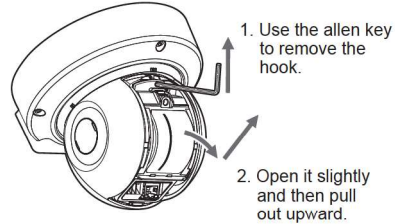

Note >>
The laser window needs to be removed when pressing the reset button or replacing it.

Caution >>
Be sure to turn OFF the power supply when mounting or removing the laser window.

Caution >>
Do not touch the laser window except its frame. Do not touch inside the main unit, e.g. mirror.

4 As shown in the figure below, insert the foot of the front window until it clicks.

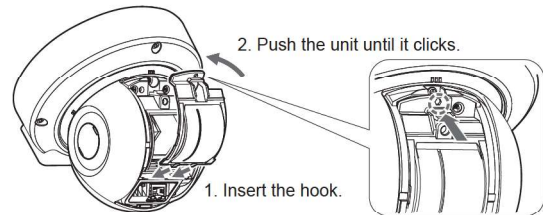

5 Snap the front cover into the main unit.

6 Tighten the screw.

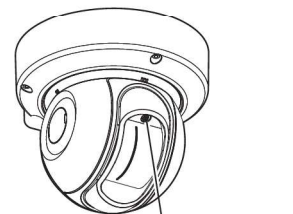
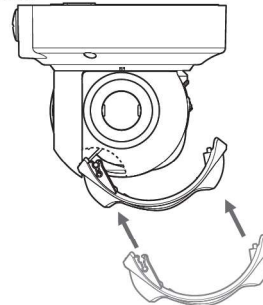

Note >>

During this replacement job, there is a possibility that the mounting angle is shifted. Confirm or re-adjust it by using Laser Area Checker(LAC-1) and REDSCAN Manager software.