

Quick Installation Guide

Accessories

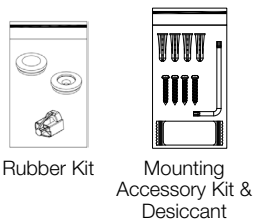

Rubber Kit

Mounting Accessory Kit & Desiccant

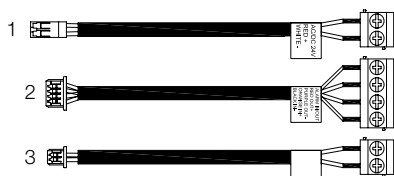

Camera Interface Cables

| | |
|---|---|
| 1 | Power |
| 2 | Alarm |
| 3 | 2 Audio Cables (Audio Line In and Audio Line Out) |

Dimensions

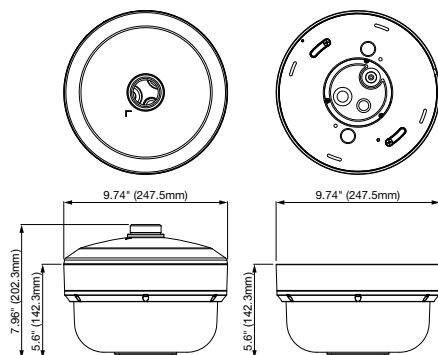

Camera Unpacking and Preparation

1. Loosen the 6 anti-drop screws on the top cover and open it.

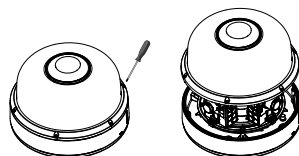

2. Remove and discard the protective EPE foam from the lens modules.

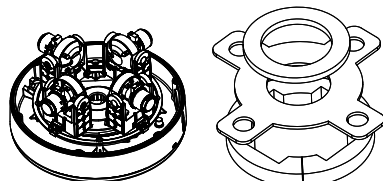

EPE Foam

3. Remove desiccant from sealed container and install in the recommended position as below.

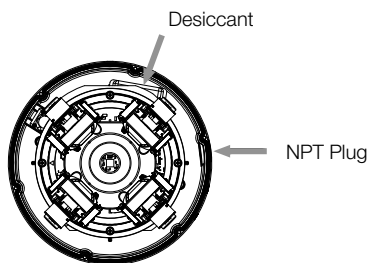

Desiccant

NPT Plug

4. Plug the spring cable back to the top cover. Then lock the 6 anti-drop screws on the top cover.

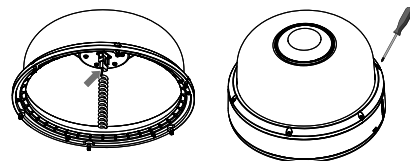

5. Loosen the anti-drop screw on the lateral side of the bottom cover.

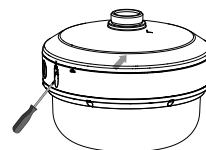

6. Rotate the cap (▼) from LOCK to OPEN in order to remove the cap.

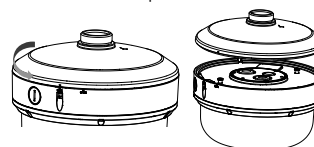

7. Loosen the 3 anti-drop screws on the bottom plate and open it.



8. Locate the network, power, audio, and alarm cable camera interfaces and make the connections. Install microSDXC card(s).

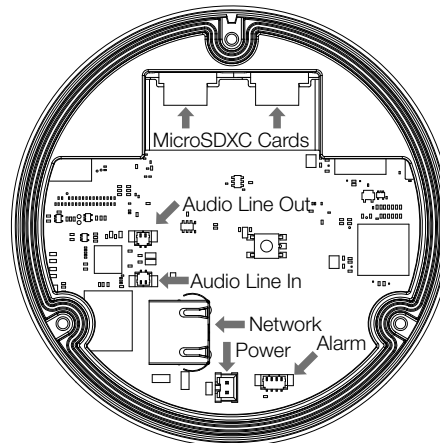

9. Prepare the network cable (and the supplied power cable, audio, and alarm cables if necessary) with the supplied grommets by using the insertion tool or terminate the RJ-45 connector to the cable after passing through the grommet or the side NPT interface.

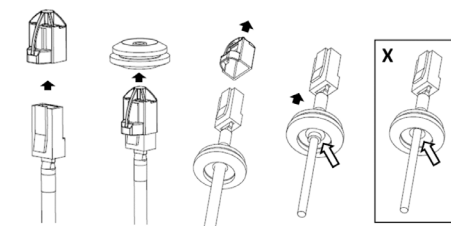

10. Place the bottom plate back to the camera and lock the 3 anti-drop screws to secure it.

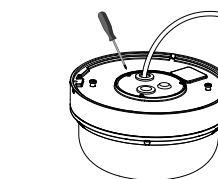

Continued on Back →

Quick Installation Guide (Continued)

Cap and Mount Hardware Installation

1. Screw the cap to the mount (such as the AV-PMJB-W or AV-WMJB-W).

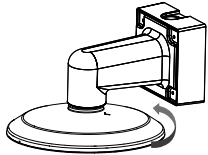

2. Feed cables through the cap and mount.
3. Fasten the safety wire on the hook.

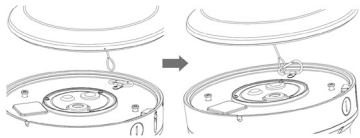

4. Connect cables from the unit to the cables from the cap/mount assembly
5. Align the pins into the slots and rotate the camera from OPEN to LOCK in order to fix the camera. The ▼ mark should be aligned with the LOCK ■ mark. Lock the anti-drop screw on the lateral side of the bottom cover to fix the camera to the cap.

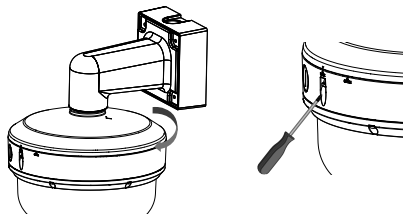

4. Make the final adjustment to the camera orientation. The AV Costar logo is the front of the camera. If a set screw is available on the mount, engage it to lock the camera in place.

Surface Mount Hardware Installation

1. Place the mounting template at the desired installation location on the ceiling and drill a hole at the ⊕ symbol marker to allow the tether screw on the surface mount plate to pass through. If cables are being routed from above, drill a hole or holes for the incoming wires and run the wires through the holes.

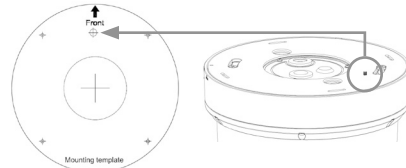

2. Loosen the 4 screws on the surface mount plate and remove it from the cap.

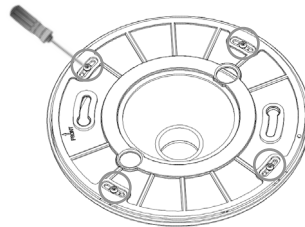

3. Drill 4 holes on the surface where indicated on the mounting template. Insert 4 screw anchors into the holes and secure the plate to the ceiling by inserting the screws in the anchors.

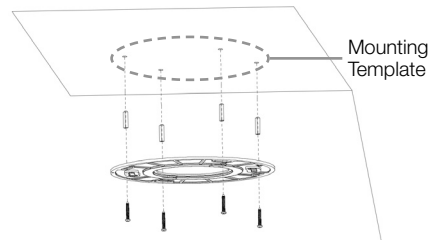

4. Fasten the safety wire on the hook.

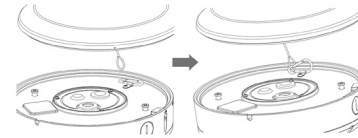

5. Connect the camera to the plate.

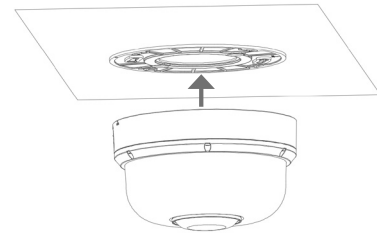

6. Please note that the OPEN ■ mark should be aligned with the screw hole on the plate. (There is only 1 screw hole on the plate for easy recognition.)

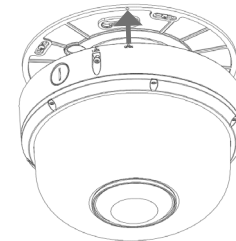

7. Twist the camera counterclockwise until it is secured firmly in place. Then fix the camera on the ceiling with the screw.

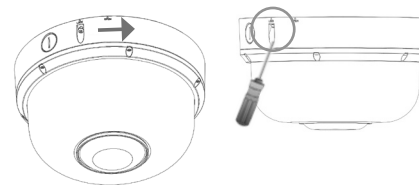

Web Browser Camera Configuration

1. Download the Costar Camera Utility using the QR Code below or by visiting <http://www.avcostar.com/downloads>



2. Install and launch the Costar Camera Utility.
3. When the Costar Camera Utility is launched, it will automatically search the network for AV Costar and CostarHD cameras on the network and over a time interval. You can also manually search cameras by clicking the "Refresh" button.
4. Search the discovered cameras for the installed camera's MAC Address.
5. Use the camera's web user interface to configure the camera by entering the camera's IP Address into a browser. If there is no DHCP server present in the network, the camera will default to the following IP Address "192.168.1.168".
6. A password must be entered before the camera can be used. To choose a password, visit the camera's webpage or use the Costar Camera Utility.