

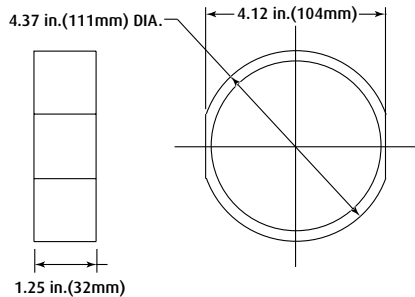

Safety Technology International, Inc.
 2306 Airport Road • Waterford, Michigan 48327-1209
 Phone: 248-673-9898 • Fax: 248-673-1246
 Toll Free: 800-888-4784 • E-mail: info@sti-usa.com
 Web: www.sti-usa.com

Safety Technology International Ltd
 Taylor House • 34 Sherwood Road • Bromsgrove
 Worcestershire • B60 3DR • England
 Tel: +44 (0)1527 520 999 • Fax: +44 (0)1527 501 999
 E-mail: info@sti-europe.com • Web: www.sti-europe.com

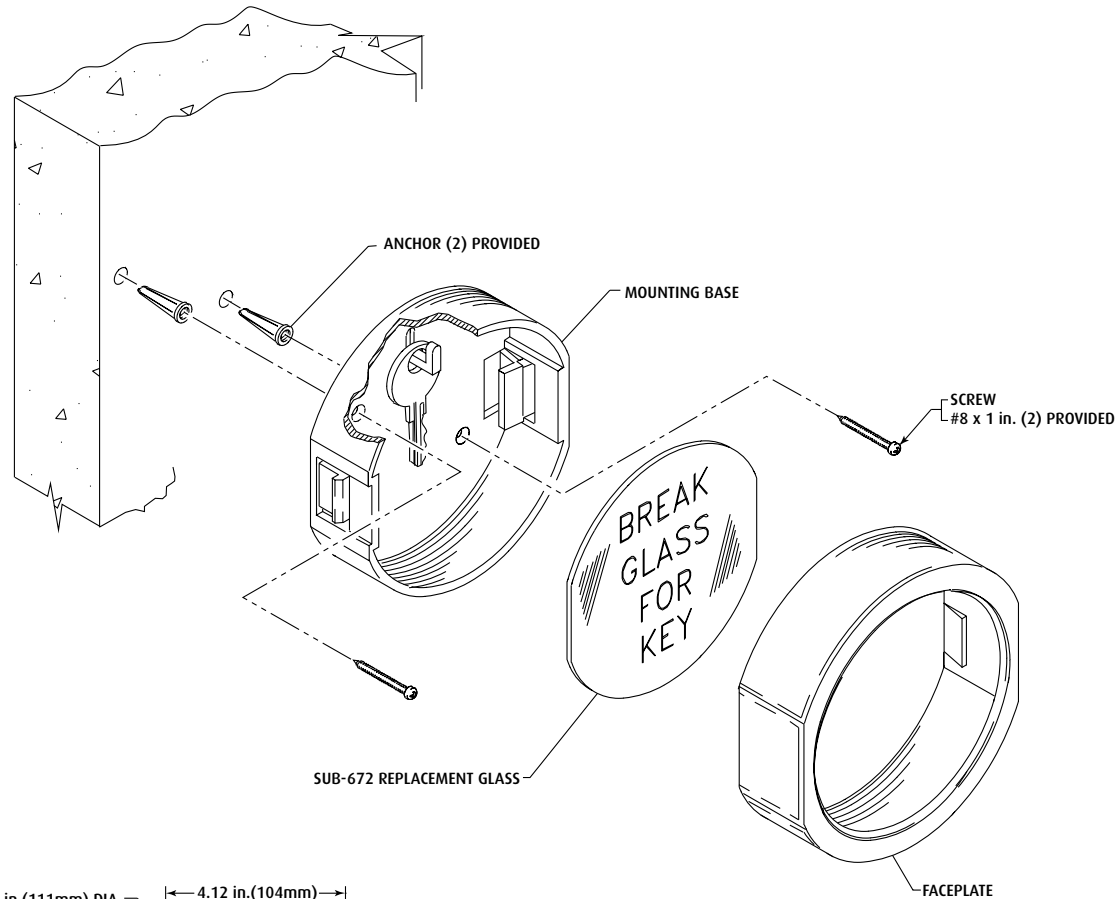

PRODUCT DIMENSIONS

INSTALLATION INSTRUCTIONS

1. Position unit on any suitable mounting surface with key hook facing upward. Mark the (2) mounting holes.
2. Drill (2) 3/16 in. diameter holes 1 in. (25mm) deep.
3. Place anchors in holes and install screws.
4. Place key on hook.
5. Snap faceplate onto mounting base, it can not be opened without breaking the glass.

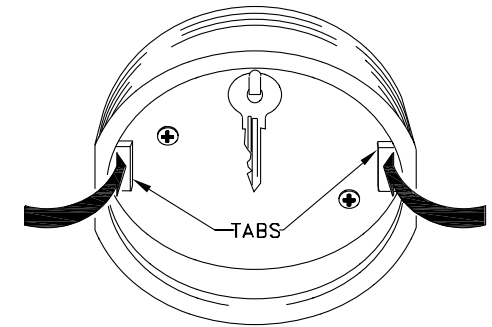

VIEW 1

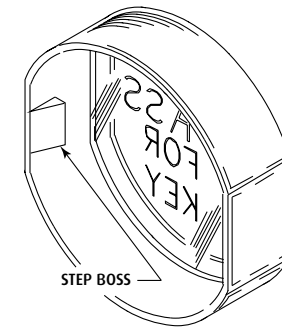

VIEW 2

GLASS REPLACEMENT INSTRUCTIONS

1. After breakage occurs carefully remove any remaining glass. Reach thru faceplate opening and depress glass retention tabs and remove face plate (view 1).
2. Insert replacement glass in face plate making sure glass is between front of housing and step boss (view 2).
2. Replace protected key and then snap faceplate onto mounting base.

Three year warranty or a one year limited warranty (from date of purchase) on most products. See website for details. Electronic warranty form at www.sti-usa.com/wc14.

INSTALLATION OF STI-6720 BREAK GLASS STOPPER®

All specifications and information shown were current as of publication and are subject to change without notice.