

BA-1W is to be used for BX-80N and BX-80NR to adjust detection area to be parallele to the mounting surface.
BA-1W allows the unit to be aligned max 30 degrees each horizontal way.
Note that SP-2 is necessary for BX-80N to be combined with BA-1W.

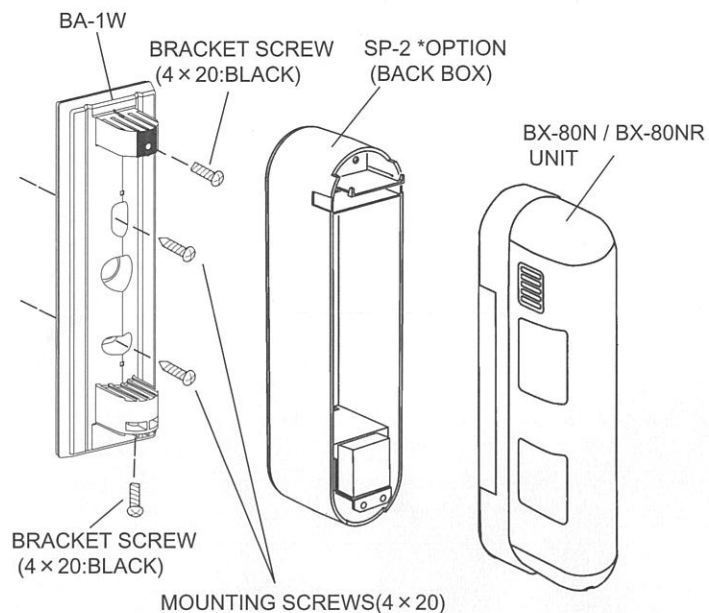

1. MOUNTING

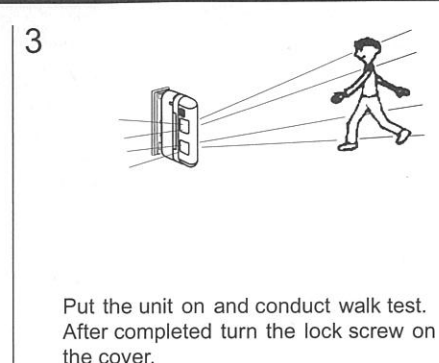
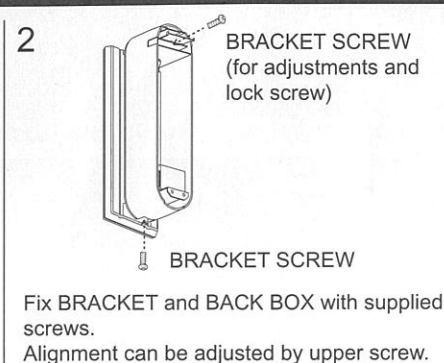
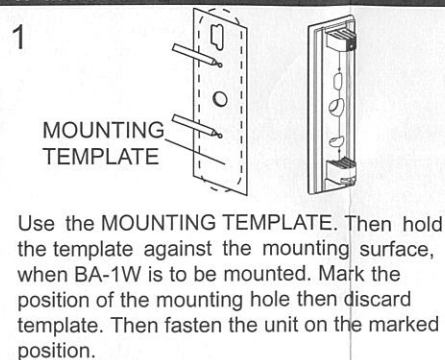

2. WALL TAMPER

Magnetic contact can be used as a wall tamper. *Use Magnetic contact on the market as it is not included on this package.
As for the fitting size, refer to Dimension of Magnetic contact.

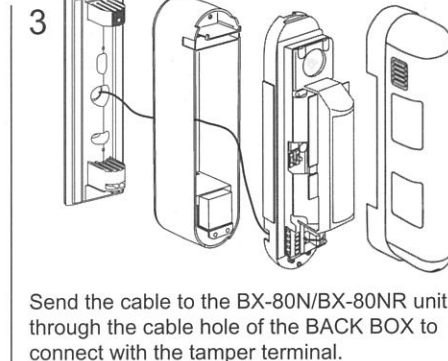
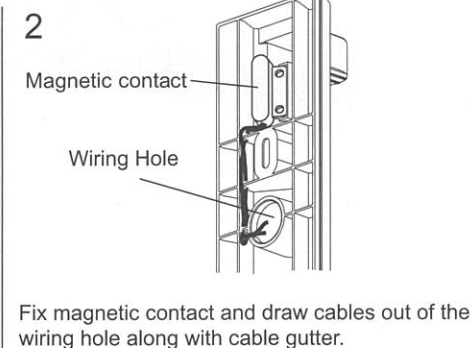
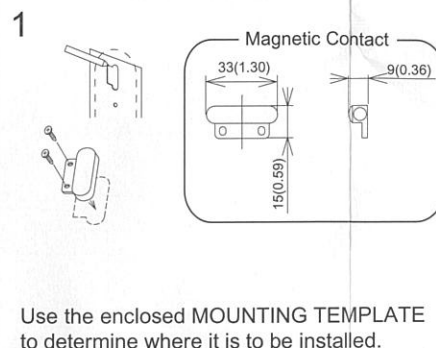

MOUNTING TEMPLATE BA-1W

