

NetWaySP4BTWPN

4-port Outdoor Hardened 802.3bt 4PPoE Switch

Altronix NetWaySP4BTWPN supports up to 90W per port (280W total power) for the latest high-powered IP devices in remote locations. It is equipped with two (2) 1Gb SFP ports to transmit data at long distances and four (4) 802.3bt compliant Ethernet ports. NetWaySP4BTWPN accommodates single/multi-mode fiber or composite cable (fiber+copper) to simultaneously deliver power and data from NetWay Spectrum head-end media converters/injectors. Embedded LINQ Technology allows to monitor, control, and report power and diagnostics from anywhere.



Key Features

- IEEE 802.3af, 802.3at, 802.3bt compliant.
- Two (2) Gigabit SFP ports.
- Four (4) 10/100/1000 Mbps Ethernet ports rated at 90W each (limited to 280W total power).
- VLAN (Virtual Local Area Networks) subnetwork allows for the grouping together of devices for improved network traffic and higher security.
- Remote network management allows for camera/device reset and diagnostic monitoring.
- Provides local and/or remote access to critical information via LAN/WAN.
- Email and Windows Dashboard Alert notifications report real-time events.
- Event log tracks history.
- CE European Conformity.
- NEMA 4/4X, IP66-11 enclosure.

Typical Composite (Fiber + Copper) Application

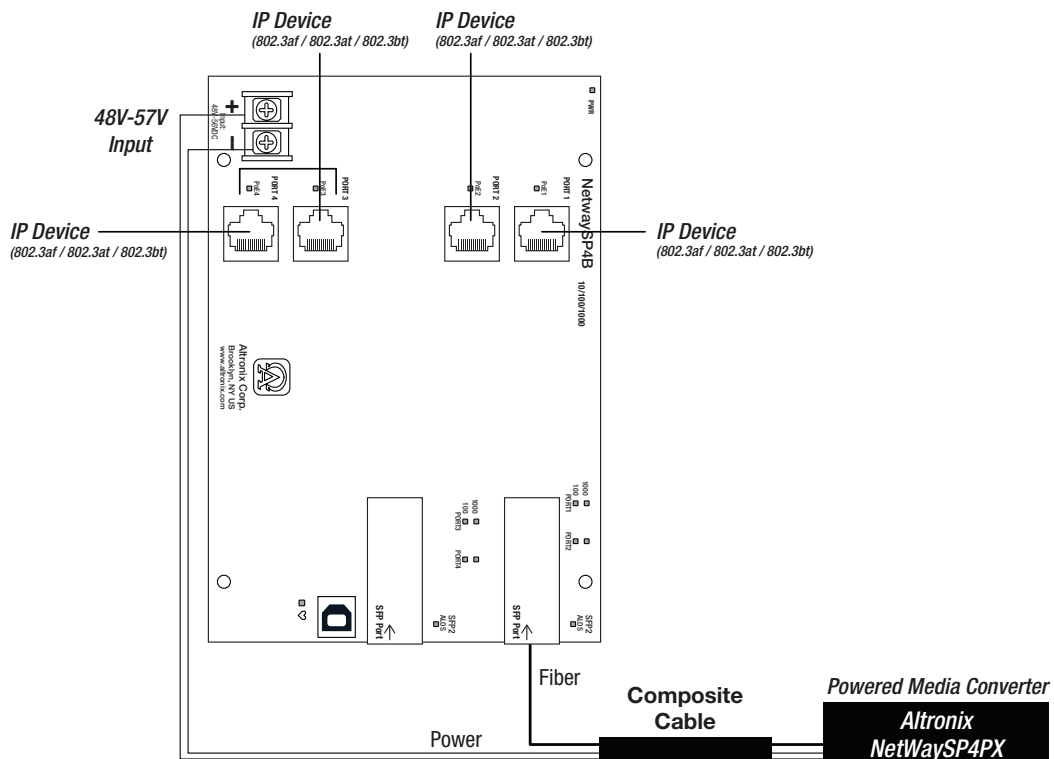

Lifetime Warranty / Made in the U.S.A.

NetWaySP4BTWPN

4-port Outdoor Hardened 802.3bt 4PPoE Switch

Specifications

Input	48V-57V (UL Listed ITE power supply)
Output	Four (4) 10/100/1000 Mbps Ethernet ports rated at 90W each (limited to 280W total power). IEEE 802.3af, 802.3at, 802.3bt compliant
SFP Ports:	Two (2) Gigabit SFP ports.
Ethernet Ports:	Four (4) 10/100/1000 Mbps ports. Connectivity: RJ45, auto-crossover. Wire type: 4-pair CAT5e or higher structured cable. Speed: 10/100/1000 Mbps, half/full duplex, auto negotiation.

Indicators (LED)

Individual PoE On LEDs for each port.
Individual IP Link status, 10/100 Base-T/active LEDs for each port.
ALOS LED indicates fiber connection for SFP port.
Heartbeat LED indicates proper operation of the unit.

VLAN:

Multiple management VLAN assignment.
802.1Q Tagged VLAN.
Up to 10 VLAN groups. ID Range 2-4095.

LINQ Technology:

Remote network management allows for camera/device reset and diagnostic monitoring.
Provides local and/or remote access to critical information via LAN/WAN.
Email and Windows Dashboard Alert notifications report real-time events.
Event log tracks history.

Physical and Environmental

Enclosure Dimensions (H x W x D approx.):
13.31" x 11.31" x 5.59" (338.1mm x 287.3mm x 142mm).
NEMA 4/4X, IP66-11 Rated enclosure for outdoor use.

Product Weight / Shipping (approx.)

Product Weight: 9.5 lbs. (4.3 kg).
Shipping Weight: 10.9 lbs. (4.9 kg).

Temperature

Operating: -40°C to 75°C (-40°F to 167°F)
Storage: -40°C to 85°C (-40°F to 185°F)
Relative Humidity: 85% +/-5%.
Operating Altitude: -304.8 to 2,000m.

Power Sourcing Equipment and Accessories (order separately)



4-port Ethernet to Fiber Media Converter for applications utilizing composite (power + copper) or conventional cabling

NetWaySP4PX - Ethernet to Fiber Media Converter with Integral Power Supply/Charger

Unit provides power up to 120W per port (480W total power). Four (4) 1Gb SFP ports.

SFP Modules - Hot pluggable Transceivers

- P1MM** Multi-Mode SFP Module for distances up to 550m.
- P1SM10** Single-Mode SFP Module for distances up to 10km.
- P1AB2K** Single Strand SFP Module for distances up to 2km.
- P1GCE** Copper SFP Module for distances up to 100m.

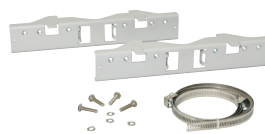

PMK1 - Pole Mount Kit

Designed to simplify installation of outdoor units (WP1, WP3 and WP4).
It accommodates 2" - 8" (diameter) poles.

Lifetime Warranty / Made in the U.S.A.