

eBridge200WPM

Outdoor Managed Two Port Transceiver

Description

Altronix eBridge200WPM PoE Ethernet transceiver/media converter transmits data and power over Coax or CAT5 cable over distances that are 3 to 5 times greater than standard Ethernet. Upgrading existing Coax analog camera infrastructure to IP cameras is greatly simplified as well. eBridge200WPM can support up to two PoE (IEEE 802.3af) or PoE+ (IEEE 802.3at) cameras/devices or a single Type 3 4PPoE (IEEE 802.3bt) device. eBridge200WPM offers built-in IP management which allows for remote camera reset, monitoring and reporting via various IP protocols. There is no need to install remote AC mains power, since these devices are simply powered from the low voltage PoE midspan/endspan equipment, such as Altronix NetWay midspans or eBridge100SPR. Model **eBridge200WPMH** features enclosure with three (3) 5/8" wiring inlets and includes NEMA rated wire glands.



eBridge200WPM

Key Features

- Up to 60W total power.
- Passes 100Mbps up to 300m via Coax or 500m via CAT5e.
- Eliminates the costs and labor associated with installing new network cabling.
- Retrofit digital IP cameras in an analog CCTV installation.
- Auto detection and protection of legacy non-PoE cameras/devices.
- Works with Megapixel, HD720, HD1080 & VGA (SD) cameras.
- Extends Network link distance in an industrial environment.
- Upgrades deployed CCTV Coax to a digital network for Retail, Casinos, Airports, Schools, Hospitals, etc.
- Lightweight molded fiberglass reinforced polyester enclosure is corrosion resistant, non-conductive and does not contain halogens.
- UL Listed in the U.S. and Canada.
- CE Approved.
- Lifetime Warranty

Compatible Receivers:



eBridgePlus PCRM Receivers:

Transmit IP video/data over coax up to 300m @ 100Mbps.
Supports PoE (IEEE 802.3af) or PoE+ (IEEE 802.3at).
UL/cUL Listed (UL60950-1). CE and C-Tick Approved.



eBridge100SPR

IP and PoE/PoE+/Hi-PoE Receiver

Transmits data at 100Mbps and provides power in a PoE (IEEE 802.3af), PoE+ (IEEE 802.3at) or Type 3 4PPoE (IEEE 802.3bt) compliant format.
UL/cUL Listed (UL60950-1). CE Approved.



Pace PRM Series Receivers

Up to Sixteen (16) Port IP and PoE+ Receivers

Transmit IP video/data over CAT5e up to 500m @ 100Mbps.
Support PoE (IEEE 802.3af) or PoE+ (IEEE 802.3at).
UL/cUL Listed (UL60950-1). CE and C-Tick Approved.

eBridge200WPM

Outdoor Managed Two Port Transceiver

Specifications

Input Options

30W: Midspan or Endspan;
 Pace1PRM, 4PRM, 8PRM, or 16PRM;
 eBridge100RM, 400PCRM, 800PCRM, or 1600PCRM.
 60W: Pace1PRD, eBridge100SPR, or NetWay1D.

Power Output:

2 ports PoE+ (30W) per port or 1 port Type 3 4PPoE (60W).
 Total output power: 60W.

Coax

Throughput rated at 100Mbps at distances up to 300m.
 Speed: 10/100BaseT, half/full duplex, auto negotiation.
 Connectivity: BNC, RG-59/U or similar.

Ethernet

Throughput rated at 100Mbps at distances up to 500m.
 Device distance (eBridge200WPM to camera/device): 100m max.
 Speed: 10/100BaseT, half/full duplex, auto negotiation.
 Connectivity: RJ45, auto crossover.

Indicators (LED)

LED 1: PoE active on Spare.
 LED 2: PoE active on Signal.
 Yellow and Green LEDs
 (by RJ45 jack): IP Link status, 10/100Base-T/active.

Agency Listings

UL/cUL UL 60950-1
 (Information Technology Equipment).
 CE European Conformity.

Physical and Environmental

Dimensions (H x W x D)

9.5" x 7.32" x 4.92" (241.3mm x 185.9mm x 125mm).

Weight (approx.)

Product Weight 2.2 lbs. (1.0 kg).
 Shipping Weight 3.2 lbs. (1.45 kg).

Temperature

Operating
 60W over CAT5: -40°C to 75°C (-40°F to 167°F).
 60W over Coax: -40°C to 65°C (-40°F to 149°F).
 45W over Coax: -40°C to 75°C (-40°F to 167°F).

Storage -40°C to 75°C (-40° to 167°F).

Relative Humidity 85% +/-5%.

Operating Altitude: -304.8 to 2,000m.

Accessories

PMK1 Pole Mount Kit (order separately)

PMK1 pole mount kit is designed to simplify installation of outdoor units.
 It accommodates 2" - 8" (diameter) poles.

Kit includes:

- Two (2) powder coated steel mount brackets.
- Four (4) stainless steel bolts.
- Four (4) stainless steel lock washers.
- Two (2) wormgear quick release straps.

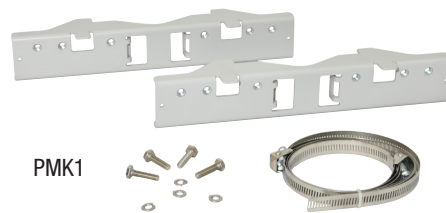

PMK1