



# August Smart Keypad

## Installation Guide

## Inside the Box



August Smart Keypad



Mounting Plate

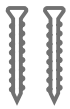

Two (2) 3/4" Screws

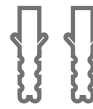

Two (2) Anchors

## What you need



Drill w/ drill bit set

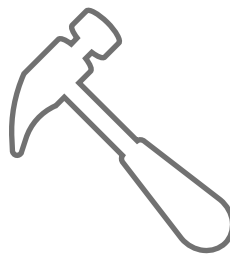

Hammer



Ballpoint Pen



Phillips Screwdriver



Level

# 1. Determine your drill bit size

SURFACE	INSTALLATION TYPE	DRILL BIT NEEDED
Brick		
Cement Siding	Screw + Anchor	Masonry Bit - 3/16"
Concrete *		
Drywall	Screw + Anchor	Standard Bit - 3/16"
Stucco **		
Wood	Screw Only	Standard Bit - 3/32"
(Other Siding)		

\* Concrete can be challenging for drilling. If you are not experienced with drilling into your particular type of concrete, you may want to consider a professional installation.

\*\* Depends on the subsurface. Test drill a very small pilot hole to determine the surface to which you are ultimately fastening. Hard subsurfaces may require a masonry drill bit. If your test hole seems unstable, you may need to use the screw + anchor method.

# 2. Remove the keypad's back panel

Depress the tab on the back of the keypad to remove the back panel.

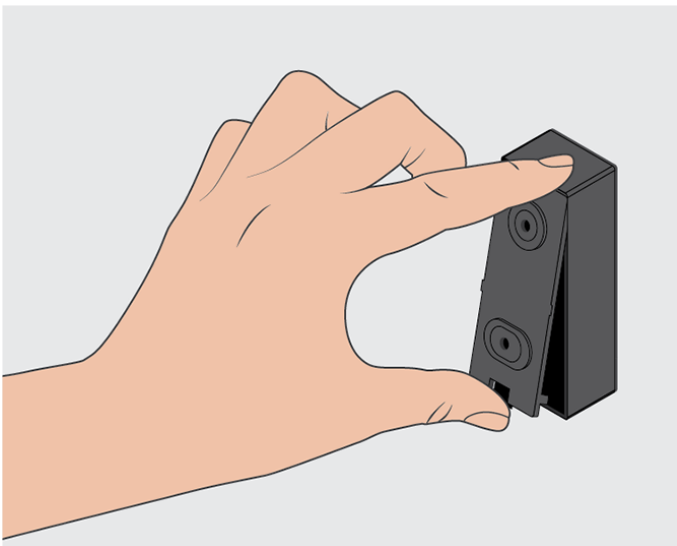

### 3. Mark holes in wall for drilling

Use your level to position the back panel on the wall. Take your ballpoint pen or one of the included screws and poke it firmly through the center of each of the two rubber feet. Then mark the holes. **Do not drill through the rubber feet.**

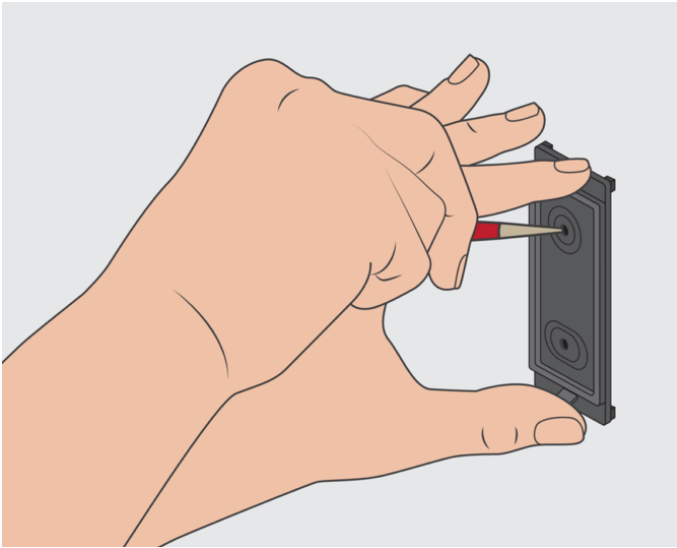

### 4. Drill the holes

Use the drill bit size and type indicated in the drill bit chart. Drill holes in the two spots you marked with your pen.

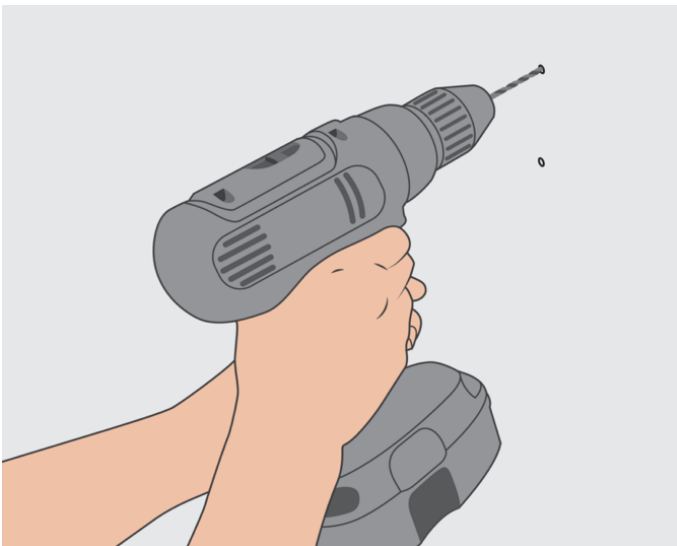

## 5. Add adhesive to the back of the keypad

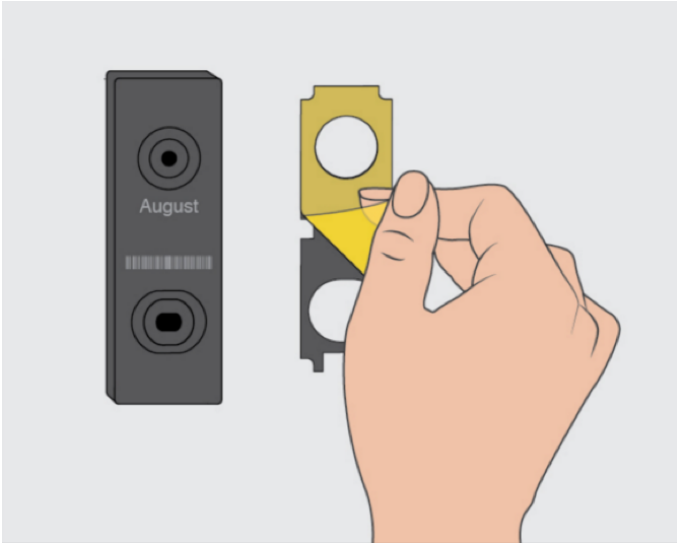

Peel off one side of the adhesive covering. Carefully place the adhesive on the rear side of the back panel.

## 6. Attach back panel to the wall

Firmly affix the back panel to the wall using the adhesive. Then take the two screws and screw them into the wall through the holes you created in the back panel.

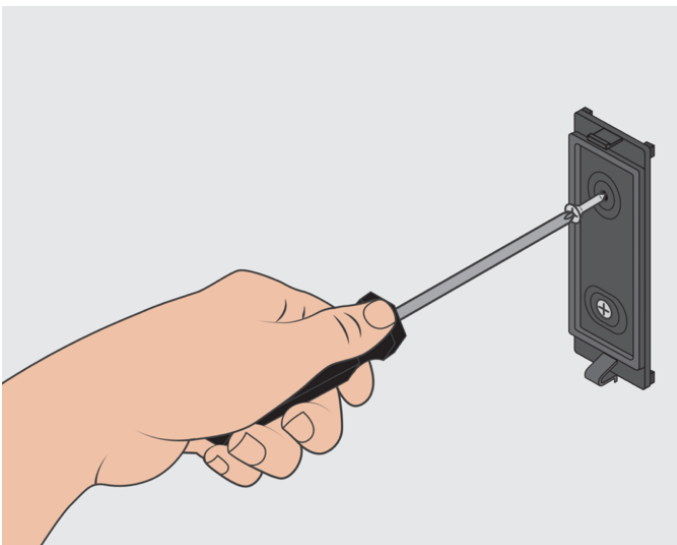

## 7. Attach keypad to the back panel

Remove the battery tab from the inside of the keypad. Hook the top of the keypad onto the top of the back panel, rocking it down to the bottom until you hear a click.

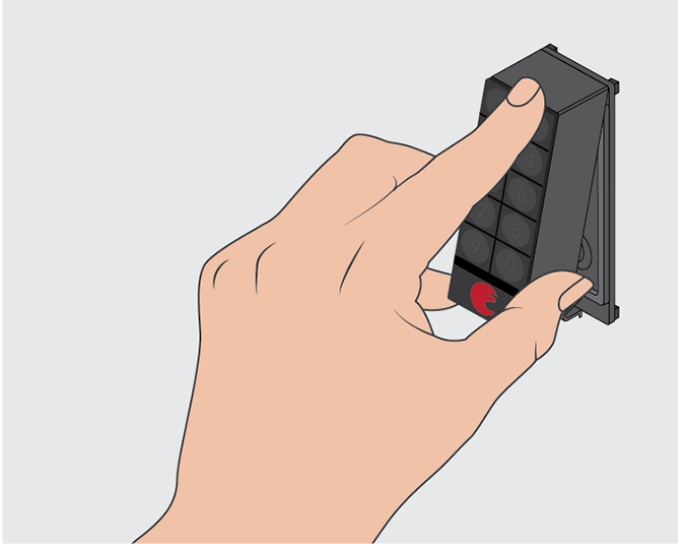

## 8. Set up keypad with the August app

In the August app, go to the lock settings screen, select “Add a Smart Keypad,” and follow the instructions.

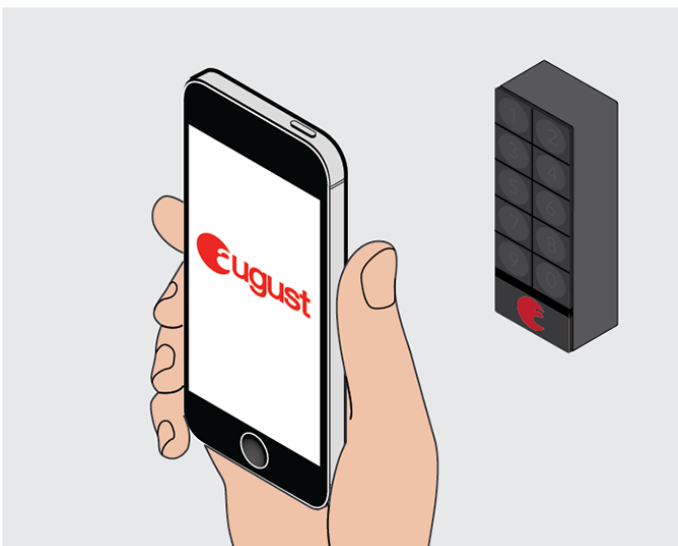

# Help

Call 844-AUGUST1 (284-8781)  
or visit: [august.com/support](https://www.august.com/support) for answers.

