

MEGAPIX®

IP Cameras







5MP model	2.1MP/1080p model
DWC-MF5Wi4TWDMP	DWC-MF2Wi4TWDMP



MEGAPIX®
Provides Visual Confirmation for Your
Alarm System

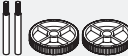

WHAT'S IN THE BOX

Quick Setup and Download guides		1 set	Moisture Absorber		1 set
Star Wrench		1	Mounting Bolt and Nuts - 2pcs		1 set
Mounting Template for Bolt and Nuts Installation		1	Screws and Plastic Anchors - 3pcs		1 set
Mounting Template for Plate Installation		1	Mounting Plate		1

NOTE:

Download all your support materials and tools in one place

1. Go to: <http://www.digital-watchdog.com/resources>

2. Search your product by entering the part number in the 'Search by Product' search bar. Results for applicable part numbers will populate automatically based on the part number you enter.

3. Click 'Search'. All supported materials, including manuals and quick start guide (QSGs) will appear in the results.



Attention: This document is intended to serve as a quick reference page for the initial setup. It is recommended that the user read the entire instruction manual for complete and proper camera usage.

STEP 1 – PREPARING TO MOUNT THE CAMERA

1. The mounting surface must withstand five times the camera weight.
2. Do not let the cables get caught in improper places or the electric line cover can be damaged. This may cause a short or fire.
3. CAUTION: These servicing instructions are for use by qualified service personnel only. To reduce the risk of electric shock do not perform any servicing other than that contained in the operating instructions unless you are qualified to do so.
4. This product is intended to be supplied by a UL Listed Power Supply Unit marked “Class 2” or “LPS” or “PS2” and rated 12 Vdc, 0.49A (DWC-MF5Wi4TWDMP) and 0.33A (DWC-MF2Wi4TWDMP) min.
5. The wired LAN hub providing power over the Ethernet (PoE) in accordance with IEEE 802-3af shall be a UL Listed device with the output evaluated as a Limited Power Source as defined in UL60950-1 or PS2 as defined in UL62368-1.
6. Unit is intended for installation in a Network Environment 0 as defined in IEC TR 62102. As such, associated Ethernet wiring shall be limited to inside the building.
7. For the installation process, remove the dome cover from the camera module by loosening the three (3) screws on the dome. Use the wrench provided with the camera.
8. Install the moisture packet in the base of the camera's lens.
 - a. Remove the moisture absorber from the packaging.
 - b. Cut the card and folder along the dotted line.
 - c. Place the moisture absorber around the camera's lens module.

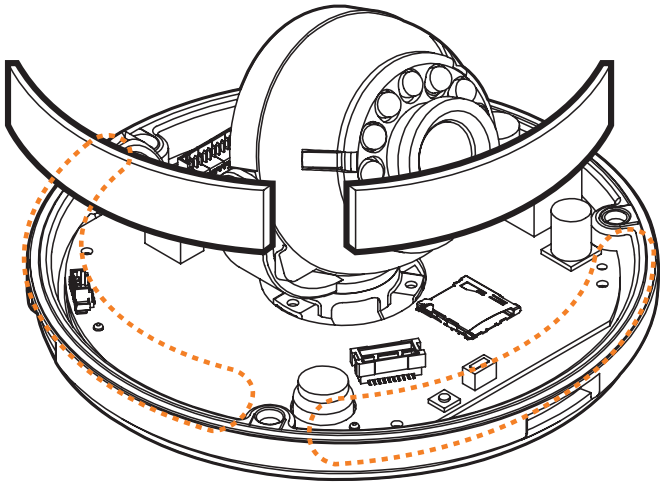

9. Remove the protective film between the dome and the camera module.
10. Remove the Poron Ring before placing the dome back on the camera. When attaching the dome back, align the line on the dome with the one on base of the camera.
11. Using the mounting template sheet or the camera itself, mark and drill the necessary holes in the wall or ceiling.

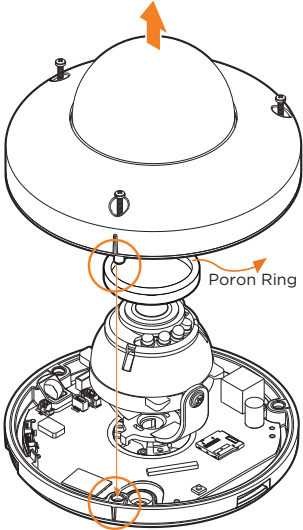

STEP 2 – POWERING THE CAMERA

Pass the wires through the mount bracket and make all necessary connections.

1. NETWORK CONNECTIONS – If you are using a PoE Switch, connect the camera using an Ethernet cable for both data and power.
2. NETWORK CONNECTIONS – If you are using a non-PoE switch, connect the camera to the switch using an Ethernet cable for data transmission and use a power adapter to power the camera.

Part number	Power Requirements	Power Consumption
DWC-MF5Wi4TWDMP	DC 12V, PoE IEEE 802.3af Class 3 (Adapter not included).	DC12V: max 5.9W PoE: max 7.2W
DWC-MF2Wi4TWDMP	DC 12V, PoE IEEE 802.3af Class 2 (Adapter not included).	DC12V: max 4.0W PoE: max 5.5W

STEP 3 - INSTALLING THE CAMERA

1. Attach the main body to the mount bracket by tightening the lock screw.
2. For soft installation surfaces, use the included metal mount plate. Fix the mount plate on the mounting surface using the included screws. Then, press the bottom case onto the mount plate. The three bezels on the case will align and snap lock onto the plate.

3. To use the camera's waterproof wiring:

- a. Install the LAN cable into **a**.
- b. **b** will be assembled to **a** with a 1/4 turn.
- c. Thread **c** tightly to **b**.

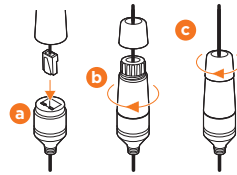

NOTE: To ensure moisture seal, make sure the o-ring is in place between **a** and **b**. In extreme environments use of an outdoor rated sealer is recommended.

NOTE: When using the waterproof cap, crimp the RJ45 connector after passing the cable through the waterproof cap.

4. Once the installation is complete, adjust the camera's tilt, panning and rotation as needed. The cameras' max angles are:
Pan: 0° ~ 360°
Tilt: 0° ~ 70°
Rotation: 0° ~ 360°
5. Assemble the dome cover over the camera body and detach the protecting film from the dome bubble.

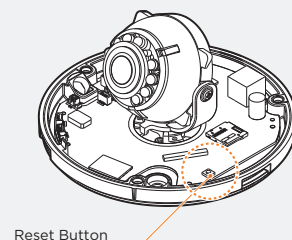
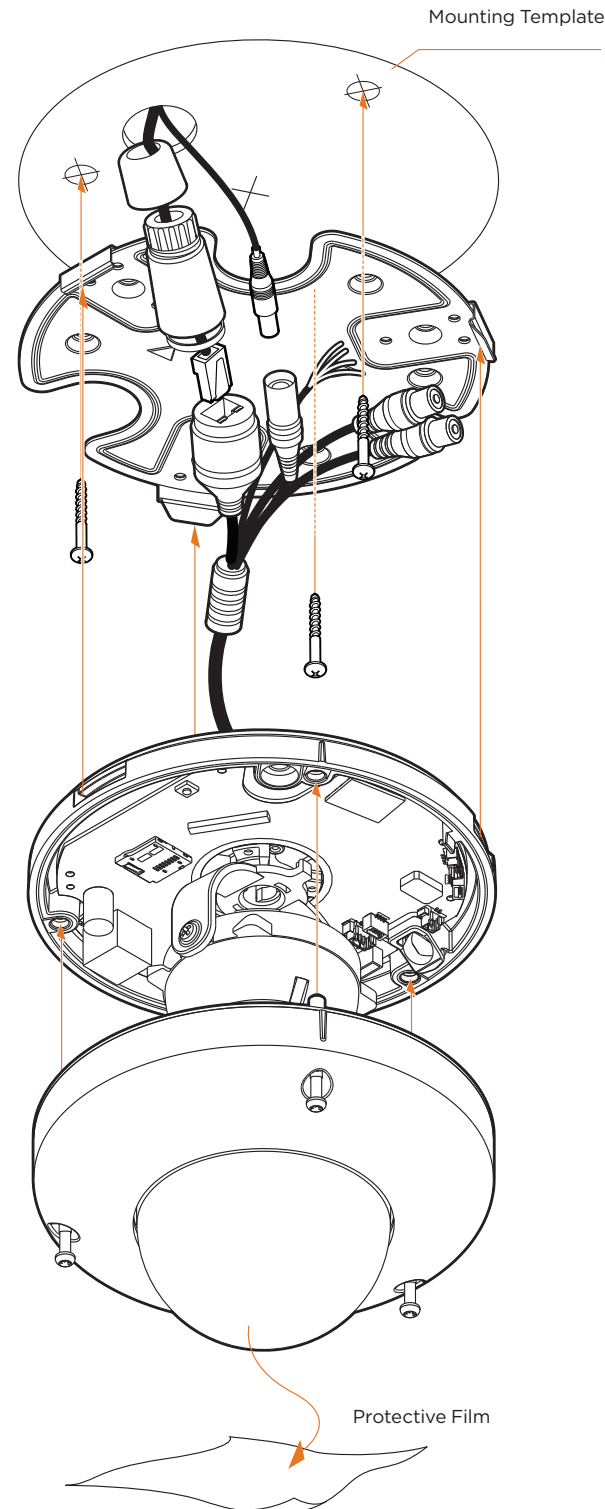

Resetting the camera: To reset the camera, use the tip of a paper clip or a pencil and press the reset button. Pressing the button for five (5) seconds will initiate a camera-wide reset of all the settings, including network settings.

STEP 3 - INSTALLING THE CAMERA (CONT.)

Installation using Mount Bolt and Screws:

1. Using the mounting template, mark and drill the holes on the mounting surface.
2. Secure the two long mounting screws to the camera's base.
3. Pass the wires through the mount bracket and make all necessary connections.
4. Mount the camera to the mounting surface by using the 2 mounting nuts. Rotate the locking discs over the screws until the camera is held tightly from the mounting surface.

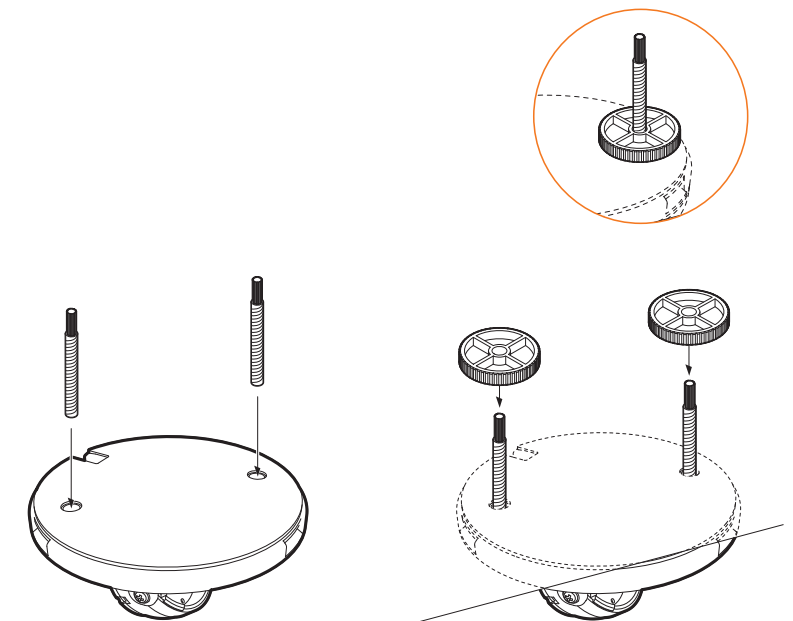

NOTE: Please refer to DMP guide for additional information on integration and camera control.