

# P2R8852E4 5MP Day & Night Fixed IR Bullet IP Camera

www.meritlilin.com



- ▶ 5 megapixel CMOS image sensor
- ▶ 5MP H.265/HEVC and H.264/AVC high-performance video compression
- ▶ Simultaneous streaming of H.265 and H.264 encoded streams
- ▶ Smart H.264/H.265 supported
- ▶ 3D noise reduction (MCTF)
- ▶ 2D WDR function
- ▶ HDR function up to 100dB
- ▶ Digital PTZ supported
- ▶ IVS supported
- ▶ Tampering / Motion / Network lost detection event function
- ▶ SMART event
- ▶ High efficiency IR LED, radiant distance up to 30m
- ▶ Day & Night (IR cut removable)
- ▶ ONVIF Profile S, Profile T and Profile G supported
- ▶ IP67 rain and dust resistant
- ▶ Vandal resistant approve

## Dimensions

74(W) × 69(H) × 189(D) mm

## Diagram of mounting holes:(unit in mm)

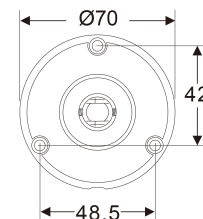
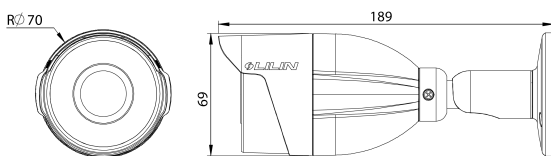

## Wind and Rain Standards

Meet international IP67 standards for dust and moisture resistant allowing you to install cameras in environments subject to wind and rain



## Impact Resistant

IK10-certified housing designed to protect the camera from destructive behavior



## Day and Night Operations via Removal of the IR-cut filter

P2R8852E4 camera was designed using a mechanical IR cut filter for increased IR sensitivity resulting in improved night time images. The removable IR-cut filter allows day and night operations even in the low lux condition providing outstanding vision



## Sense Up+

Deliver outstanding video outputs in poor light conditions without experiencing motion blur. You can see video clearly even during nighttime without sufficient lighting support



## 3D Noise Reduction

Remove noise from a signal. Suppressing noise in an image in low light conditions and able to retain quality videos at the same time



## Wide Dynamic Range (WDR)

Wide Dynamic Range (WDR) displays details of both the brightest and darkest areas. WDR can extend image visibility under high contrast lighting scenes and improve image quality

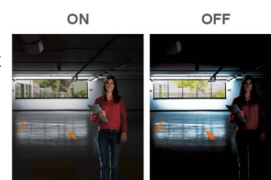

## High Dynamic Range

An High Dynamic Range (HDR) image is made by taking 3 frames of the same scene and each at different shutter speeds to display details of both the darkest and brightest areas. HDR can extend image visibility under high contrast lighting scenes and improve image quality



## Privacy Masking

Privacy Masking is a feature used to protect personal privacy by concealing private areas in the camera's field of view. Doorways and house windows for example are not subject to surveillance



## Video Security App

Available on Android and iOS – LILINViewer app provides security alarm push notification, real-time live viewing, and remote video playback



## SD Cards in Sync with NAV Software

P2R8852E4 camera with built-in Micro SD/SDHC/SDXC card slots can provide redundant video viewing and recording. You can synchronize an SD card with LILIN VMS (Video Management Software) – Navigator (NAV)



## Motion Detection

Detect motion and capture the event. Motion in the selected area will provoke an alert.



## Tamper Detection

Automatically detects camera sabotage or failure. Detects any attempts to tamper with the camera – partially or completely blocking its lens or field of view

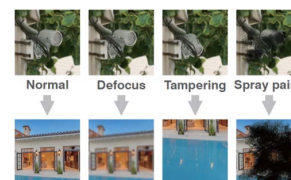

## 5MP Day & Night Fixed IR Bullet IP Camera

### Video Performance

|                   |   |
|-------------------|---|
| Model             | P2R8852E4   |
| Min. Illumination | Color : 0.01 Lux at F1.6 ; B/W : 0.004 Lux at F1.6 ; 0 Lux with IR LED ON |

### Lens / Night Vision (Infrared LED)

|                  |                               |
|------------------|-------------------------------|
| Focal Length     | 4mm                           |
| Iris             | F1.6                          |
| Iris Control     | Fixed IRIS                    |
| Angle of View    | 76.6° (H) 55.8° (V) 98.6° (D) |
| Peak Wavelength  | 850nm                         |
| Beam Spread      | 60°, 90°                      |
| Radiant Distance | 30M                           |

### Sensor

|                  |  |
|------------------|--|
| Pick Up Element  | 1/2.8" CMOS image sensor                 |
| Effective Pixels | 2616 (H) × 1964 (V) = 5,137,824 (Pixels) |

### Certifications

|                         |                  |
|-------------------------|------------------|
| CE                      | Yes, EMI CLASS B |
| FCC                     | Yes, EMI CLASS B |
| UL                      | Yes              |
| IP Rating               | IP67             |
| Vandal Resistant Rating | IK10             |

### PC Requirements

|             |  |
|-------------|--|
| CPU         | Intel® Core™ i7 or higher grade          |
| OS          | Windows 7 or above                       |
| RAM         | 8GB or above, Dedicated Graphics Card    |
| Web Browser | Microsoft® Internet Explorer® 9 or above |

### Video Streaming

|                   |  |
|-------------------|--|
| Video Compression | H.265/HEVC main profile, H.264 main and high profile, Motion JPEG  |
| Video Streaming   | RTP/HTTP, RTP/TCP, RTP/UDP, Multicast 4 configurable streams in H.265 and H.264 and Motion JPEG, configurable frame rate and bandwidth |
| Number of Streams | 4  |
| Video Bitrate     | 128Kbps – 12Mbps; Frame rate and bit rate controllable on-the-fly; VBR / CBR / GOP supported, Fixed bitrate, Smart H.264/H.265         |

### Network Security

|                  |  |
|------------------|--|
| Encryption       | Base64 HTTP encryption, HTTPS encryption, DDNS via HTTPS                     |
| Authentication   | Digest HTTP authentication, RTSP authentication, TLS, 802.1x, DDNS via HTTPS |
| Address Filter   | IP address filter, MAC address filter  |
| Access           | Multiple user access levels with password protection                         |
| User accounts    | 10 user accounts available   |
| Multi IP Address | Yes  |

### Video Resolutions (H x V)

|                    |  |
|--------------------|--|
| Resolution         | 5MP(2592 × 1944), 4MP(2304 × 1728), 3.1MP(2048 × 1536), 3MP(2304 × 1296), 2MP(1920 × 1080), 1.3MP(1280 × 960), 1MP(1280 × 720), D1(720 × 480, 720 × 576), VGA(640 × 480), CIF(352 × 240) |
| Maximum Frame Rate | Normal mode: up to 25 fps @ 2592 × 1944<br>HDR mode: up to 25 fps @ 2592 × 1944  |

### Video Functions

|                                  |  |
|----------------------------------|--|
| Scanning System                  | Progressive Scan   |
| Infrared Cut Filter              | Auto / Day (Color) / Night (Mono) / Schedule   |
| White Balance                    | ATW-NARROW / ATW-WIDE / AWC(MANUAL)  |
| Back Light Compensation          | Yes  |
| Electrical Shutter               | 1/30(1/25)s – 1/30000s   |
| Sense Up                         | Off / x2 / x4 / x8 / x16   |
| Sense Up+                        | Yes  |
| Auto Gain Control                | 60 dB Variable Gain  |
| S/N Ratio                        | More than 50dB (AGC off)   |
| 3D Noise Reduction               | Off / 1 – 32 Selectable  |
| 2D WDR                           | Off / Auto / x2 / x3 / x4 (by normal mode) Support Onvif   |
| High Dynamic Range               | Up to 100dB (by HDR mode, 2 shutter line interleave)   |
| Privacy Masking                  | Off / On (4 zones)   |
| Image Effects                    | Brightness, Contrast, Hue, Saturation, Sharpness, Mirror, Flip, Rotation, Overexposure Reduction |
| EV (Exposure Value)              | Adjustable   |
| Lens distortion correction (LDC) | Yes  |

### Integration

|                             |   |
|-----------------------------|---|
| Mobile Application          | Integrated to LILIN mobile app (LILIN Viewer) iPhone, iPad, Android support   |
| Video Management            | ONVIF Profile S / ONVIF Profile T / ONVIF Profile G / IVS events, LILIN Navigator Enterprise 2.0 support, Third party VMS through LILIN HTTP API  |
| SD Card Recording           | Support Micro SD/SDHC/SDXC card for circular recording (card is not included)   |
| SD Card Compatible List     | Micron -<br>32GB,64GB,128GB,256GB,512GB, 1TB (SDXC, U1, C10)<br>Transcend -<br>4GB SD,8GB SDHC,32GB SDHC C10,128GB SDXC C10<br>SanDisk -<br>8GB SDHC, 32GB, 64GB, 128GB SDHC C10<br>Kingston -<br>64GB SDXC C10 |
| Maintenance                 | Firmware update via HTTP and IP Scan; Firmware available at website   |
| IVS Basic 1.0               | Motion Detection, Tampering Detection, Advanced Motion Detection, Traffic Light Detection, Tripwire Detection, Object Counting  |
| IVS Advanced 2.1 (Optional) | Unattended Object Detection, Missing Object Detection, Crowd Detection, Loitering Detection, Face Detection   |
| IVS Advanced 2.2 (Optional) | Detection Zone for Car and Human  |
| Event Triggers              | Motion / Tamper / Network lost detection / SmartEvent   |
| Event actions               | FTP / SMTP / HTTP post / SD card / SAMBA / SNMP Trap / Push Service notification  |
| Languages                   | English, Traditional Chinese, Simplified Chinese, Spanish, Italian, Turkish, Russian, Korean, French, Arabic, Hungarian, Japanese   |

### Network

|                            |   |
|----------------------------|---|
| Ethernet                   | 10/100 Mbps Base-T (Tx), RJ-45  |
| ePTZ & Digital Zoom        | Yes, ROI (Region of Interest)   |
| OSD                        | Position configurable text overlay for date, time, camera ID, event status and watermark with customizable user demand data   |
| CPU, Memory                | Embedded SoC ARM Cortex-A9, 816MHz, 512MB DDR3L, 256MB flash memory   |
| OS                         | Embedded Linux 3.10   |
| Network Protocols          | IPv4, IPv6, TCP, UDP, HTTP, HTTPS, SMTP, MQTT, QoS, SNMP V1/V2/V3, SNMP Trap and heart beat, NTP, DDNS, UPnP, FTP, ARP, DHCP, PPPoE, DNS, RTSP, RTCP, Telnet, ICMP, IGMP, ONVIF Profile S, ONVIF Profile T, ONVIF Profile G, SDDP, Bonjour, 802.1x, SSL/TLS |
| Max number of online users | 10 simultaneous users   |
| Video Display              | LILIN Universal ActiveX, LILIN Java Applet  |
| Watermark                  | BMP logo  |
| Log                        | Event & operation log & IVS event log   |
| Schedule                   | Support holiday list  |
| Network Storage            | NAS (Support SAMBA/CIFS)  |

| Power and Environment |   |
|-----------------------|---|
| Starting Temperature  | -10°C – +50°C (14°F – 122°F)              |
| Operating Temperature | -40°C – +50°C (-40°F – 122°F)             |
| Storage Temperature   | -25°C – +60°C (-13°F – 140°F)             |
| Humidity              | 0% – 90% RH                               |
| Power Supply          | DC12V ±10% / PoE (IEEE 802.3af compliant) |
| Power Consumption     | DC12V, 7.9W / PoE, 10.2W                  |

| Mechanical      |                           |
|-----------------|---------------------------|
| Dimension       | 74(W) × 69(H) × 189(D) mm |
| Weight          | 555g                      |
| Casing Material | Aluminum alloy            |
| Window          | Ø58 Heat Resistant Glass  |

Copyright © Merit LILIN 2021 | All rights reserved | Product specifications and availability are subject to change without notice