

ATTENTION	Disconnect power before servicing
ATENCIÓN	Desconecte la corriente antes de abrir el producto
ATTENTION	Débranchez l'alimentation avant de toute intervention sur le produit

SLM500
SLM700

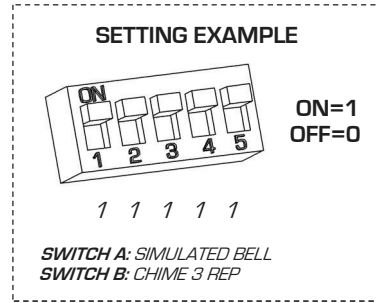

INSTALLATION AND APPLICATION INSTRUCTIONS
INSTRUCCIONES DE INSTALACIÓN Y EMPLEO - INSTRUCTIONS D' INSTALLATION ET D' UTILISATION

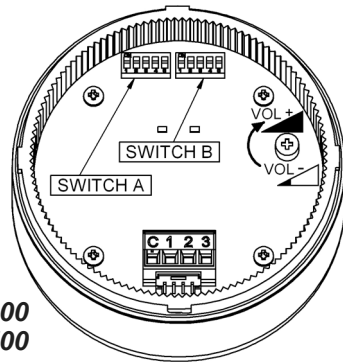

E162485
AUD. AND VIS. APPLIANCE
ENCLOSURE TYPE 3R
FOR INDOOR/OUTDOOR

SLM500
SLM700

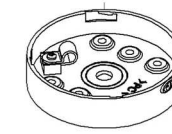
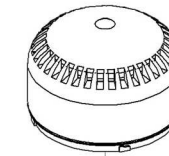

SLMBS-012-024

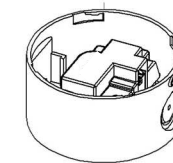

SLMBD-012-024
SLMBD-PNP-012-024
SLMBD-120-240

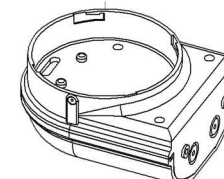

SLMBW-012-024
SLMBW-PNP-012-024
SLMBW-120-240

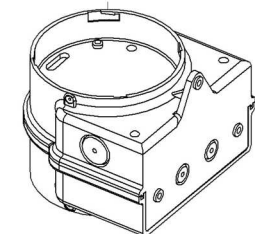

SLMBT-012-024
SLMBT-PNP-012-024
SLMBT-120-240



SLMBP-012-024
SLMBP-PNP-012-024
SLMBP-120-240

A

SWITCH A SOUNDS						
No.	STONE	STONE TYPE	F(Hz)	TIMES	DESCRIPTION	DIP SWITCH
1	BI-TONE		600 - 700	0.5s/0.5s	STANDARD	0 0 0 0 0
2	MULTI-TONE		1000 - 1700	CICLE 0.25s	STANDARD	1 0 0 0 0
3	MODULATED		1000 - 1700	CICLE 0.8s	STANDARD	0 1 0 0 0
4	BI-TONE		440 - 560	565s/565s	STANDARD - EVACUATION	1 1 0 0 0
5	LINEAR		300	-	GENERAL PURPOSE	0 0 1 0 0
6	LINEAR		660	-	SWEDISH (ALL CLEAR)	1 0 1 0 0
7	LINEAR		750	-	GENERAL PURPOSE	0 1 1 0 0
8	LINEAR		2850	-	GENERAL PURPOSE	1 1 1 0 0
9	SWEEP		500 - 1200	3.5s ON/0.5s OFF	NETHERLANDS-NEN2575:2000	0 0 0 0 1
10	SWEEP		500 - 1200	0.5s ON/0.5s OFF X 3 1.5s OFF	AUSTRALIA AS1670	1 0 0 1 0
11	SWEEP		800 - 970	0.5s ON/0.5s OFF X 3 1.5s OFF	ISO 8201	0 1 0 1 0
12	INTERMITTENT		420	0.625s ON/0.625s OFF	AUSTRALIA AS1670 ALERT TONE	1 1 0 1 0
13	INTERMITTENT		660	0.15s ON/0.15s OFF	SWEDISH (AIR RAID)	0 0 1 1 0
14	INTERMITTENT		660	1.8s ON/1.8s OFF	SWEDISH (LOCAL WARNING)	1 0 1 1 0
15	INTERMITTENT		660	0.5s ON/0.5s OFF	SWEDISH GENERAL PURPOSE	0 1 1 1 0
16	INTERMITTENT		720	0.7s ON/0.3s OFF	GENERAL PURPOSE	1 1 1 1 0
17	INTERMITTENT		750	0.33s ON/0.5s OFF	GENERAL PURPOSE	0 0 0 0 1
18	INTERMITTENT		800	0.25s ON/1s OFF	GENERAL PURPOSE	1 0 0 0 1
19	INTERMITTENT		970 - 800	0.35s/0.35s/0.35s OFF X 3 1.5s OFF	ISO 8201	0 1 0 0 1
20	INTERMITTENT		970	0.5s ON/0.5s OFF X 3 1.5s OFF	ISO 8201 LOW TONE	1 1 0 0 1
21	INTERMITTENT		970	0.25s ON/0.25s OFF	GENERAL PURPOSE	0 0 1 0 1
22	INTERMITTENT		2850	1s ON/1s OFF	GENERAL PURPOSE	1 0 1 0 1
23	INTERMITTENT		2850	0.25s ON/0.25s OFF	GENERAL PURPOSE	0 1 1 0 1
24	BI-TONE		600 - 700	0.5s/0.5s	GENERAL PURPOSE	1 1 1 0 1
25	BI-TONE		800 - 970	0.25s/0.25s	BS5839-1:2002	0 0 0 1 1
26	BI-TONE		800 - 970	0.8s/0.8s	GENERAL PURPOSE	1 0 0 1 1
27	BI-TONE		1000 - 2000	1s/1s	GENERAL PURPOSE	0 1 0 1 1
28	CHIME 1 SINGLE		700 - 600	0.4s/0.7s	SINGLE SHOT DING DONG	1 1 0 1 1
29	CHIME 1 REPEATING		700 - 600	0.4s/0.7s OFF	REPEATING DING DONG	0 0 1 1 1
30	CHIME 1 REPEATING		700 - 600	0.25s/0.4s OFF	REPEATING DING DONG	1 0 1 1 1
31	HOOTER REPEATING		-	3s ON/2s OFF	GENERAL PURPOSE	0 1 1 1 1
32	SIMULATED BELL		1850	0.1s (modulated 0.03s)	GENERAL PURPOSE	1 1 1 1 1

SWITCH B SOUNDS						
No.	STONE	STONE TYPE	F(Hz)	TIMES	DESCRIPTION	DIP SWITCH
1	INTERMITTENT		490	0.5s ON/1s OFF	GENERAL PURPOSE - WARNING	0 0 0 0 0
2	BI-TONE		480 - 610	0.5s/0.5s	GENERAL PURPOSE - EVACUATION 1	1 0 0 0 0
3	LINEAR		610	-	GENERAL PURPOSE - EVACUATION 2	0 1 0 0 0
4	LINEAR		500	-	GENERAL PURPOSE	1 1 0 0 0
5	LINEAR		970	-	BS5839-1:2002	0 0 1 0 0
6	SWEEP		500 - 1200	CICLE 3.75s/0.25s OFF	AS2220	1 0 1 0 0
7	SWEEP		1400 - 1600	CICLE 1.5s	NF 48-265	0 1 1 0 0
8	SWEEP		800 - 970	CICLE 1.5s	BS5839-1:2002	1 1 1 0 0
9	SWEEP		1200 - 500	CICLE 1s	DIN 33 404	0 0 0 1 0
10	INTERMITTENT		544	0.625s ON/0.625s OFF	GENERAL PURPOSE	1 0 0 1 0
11	INTERMITTENT		660	6.5s ON/13s OFF	SWEDISH (PRE-MESS)	0 1 0 1 0
12	INTERMITTENT		970	1s ON/1s OFF	APOLLO FIRE SYSTEM BS5839	1 1 0 1 0
13	INTERMITTENT		2850	0.5s ON/0.5s OFF X 3 1.5s OFF	ISO 8201 HIGH TONE	0 0 1 1 0
14	BI-TONE		970 - 630	0.5s/0.5s	APOLLO FIRE SYSTEM BS5839	1 0 1 1 0
15	BI-TONE		554 - 440	0.1s/0.4s	FRANCE - AFNOR NF S 32 001	0 1 1 1 0
16	BI-TONE		440 - 554	0.5s/0.5s	GENERAL PURPOSE	1 1 1 1 0
17	BI-TONE		510 - 610	0.5s/0.5s	GENERAL PURPOSE	0 0 0 0 1
18	BI-TONE		510 - 610	1s/1s	GENERAL PURPOSE	1 0 0 0 1
19	BI-TONE		600 - 700	1s/1s	GENERAL PURPOSE	0 1 0 0 1
20	BI-TONE		550 - 1000	0.5s/0.5s	GENERAL PURPOSE	1 1 0 0 1
21	BI-TONE		550 - 1000	1s/1s	GENERAL PURPOSE	0 0 1 0 1
22	BI-TONE		800 - 1000	0.5s/0.5s	GENERAL PURPOSE	1 0 1 0 1
23	BI-TONE		800 - 1000	1s/1s	GENERAL PURPOSE	0 1 1 0 1
24	BI-TONE		1000 - 2000	0.5s/0.5s	GENERAL PURPOSE	1 1 1 0 1
25	BI-TONE		2400 - 2850	0.265s/0.265s	GENERAL PURPOSE	0 0 0 1 1
26	BI-TONE		2400 - 2850	0.465s/0.465s	GENERAL PURPOSE	1 0 0 1 1
27	BI-TONE		640 - 970	0.5s/0.5s	GENERAL PURPOSE	0 1 0 1 1
28	BI-TONE		490 - 610	0.25s/0.25s	GENERAL PURPOSE	1 1 0 1 1
29	CHIME 2 SINGLE		554 - 440	0.35s/0.7s	SINGLE SHOT DING DONG	0 0 1 1 1
30	CHIME 2 REP		554 - 440	0.35s/0.7s/0.5s OFF	REPEATING DING DONG	1 0 1 1 1
31	CHIME 3 SINGLE		1300 - 944	0.5s/1s	SINGLE SHOT DING DONG	0 1 1 1 1
32	CHIME 3 REP		1300 - 944	0.5s/1s/0.5s OFF	REPEATING DING DONG	1 1 1 1 1

B

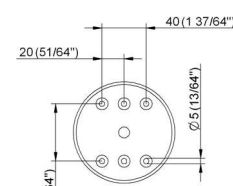

SLM500 + SLMBS
SLM700 + SLMBS

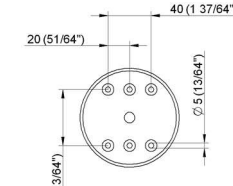

SLM500 + SLMBD
SLM700 + SLMBD

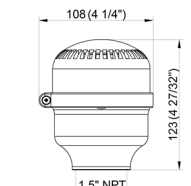

SLM500 + SLMBP
SLM700 + SLMBP

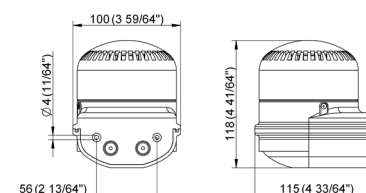

SLM500 + SLMBW
SLM700 + SLMBW

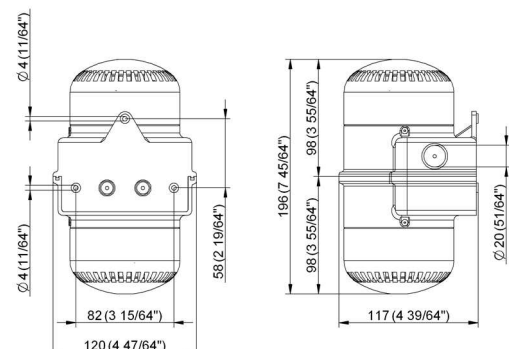

SLM500 + SLMBT
SLM700 + SLMBT

SLM700

V ~	12-24
V ~	12-24
mA	240 280
dB(A)1m	87-105

SLM500

V ~	12-24
V ~	12-24
mA	380 460
dB(A)1m	87-105

SLM700

V ~	120-240
mA	60 35
dB(A)1m	87-105

SLM500

V ~	120-240
mA	100 60
dB(A)1m	87-105

All dims in mm unless otherwise noted
Todas las dimensiones son en mm, salvo que sea indicado de otra manera
Toutes les dimensions sont en mm, sauf indication contraire

FUSE WIRE PROTECTION	On the power supply line the rating of the supply fuse must be according to the voltage
FUSIBLE DE PROTECCIÓN	En la línea de alimentación emplear fusibles de seguridad adecuados al voltaje
FUSIBLE DE PROTECTION	Sur la ligne d'alimentation utiliser des fusibles retardés dimensionnés selon la tension

TO BE INSTALLED BY QUALIFIED PERSONNEL ONLY
LA INSTALACIÓN SÓLO DEBE SER REALIZADA POR PERSONAL CUALIFICADO - L'INSTALLATION DOIT ETRE EFFECTUEE PAR PERSONNEL QUALIFIE

NOT TO BE DISPOSED OF AS COMMON WASTE - NO ELIMINAR COMO DESECHO URBANO - NE PAS ELIMINER COMME DECHET URBAIN

ATTENTION	The possibility exists that rapid flashing lights, under certain circumstances, might induce photosensitive epilepsy
ATENCIÓN	Existe la posibilidad que luces de intermitencia rápida, en determinadas circunstancias, podrían inducir epilepsia fotosensible
ATTENTION	Il est possible que des feux clignotants rapides, dans certaines circonstances, peuvent induire épilepsie photosensible

- | | | | |
|--|---|--|---|
| ⚠
C + 2 has priority over C + 1
C + 2 tiene prioridad en C + 1
C + 2 est prioritaire sur C + 1 | C + 3 has priority over C + 2 and C + 1
C + 3 tiene prioridad en C + 2 y C + 1
C + 3 est prioritaire sur C + 2 et C + 1 | C + 5 has priority over C + 4
C + 5 tiene prioridad en C + 4
C + 5 est prioritaire sur C + 4 | C + 6 has priority over C + 5 and C + 4
C + 6 tiene prioridad en C + 5 y C + 4
C + 6 est prioritaire sur C + 5 et C + 4 |
|--|---|--|---|

WIRING/CABLEADO/CÂBLAGE BASES LT (12-24V DC/AC)

SLMBS-012-024 / SLMBD-012-024 / SLMBW-012-024 / SLMBT-012-024 / SLMBP-012-024	12-24V DC/AC	
<p>① </p> <p>② </p> <p>C + 1 (only SLM500 version): LED flashing light C + 1 (únicamente para la versión SLM500): Luz intermitente de LED C + 1 (seulement pour version SLM500): Lumière à LED clignotante</p> <p>C + 2: LED flashing light (SLM500 version) + SWITCH A sound C + 2: Luz intermitente de LED (versión SLM500) + Sonido SWITCH A C + 2: Lumière à LED clignotante (version SLM500) + son SWITCH A</p> <p>C + 3: LED steady light (SLM500 version) + SWITCH B sound C + 3: Luz fija de LED (versión SLM500) + Sonido SWITCH B C + 3: Lumière à LED fixe (version SLM500) + son SWITCH B</p>	<p>③ </p>	

WIRING/CABLEADO/CÂBLAGE BASES LT PNP (12-24V DC) and BASES HT (120-240V AC)

SLMBD-PNP-012-024 / SLMBW-PNP-012-024 / SLMBP-PNP-012-024	12-24V DC
SLMBD-120-240 / SLMBW-120-240 / SLMBP-120-240	120-240V AC

<p>① </p>	<p>② </p>	<p>② </p>	<p>② </p>
-----------	-----------	-----------	-----------

<p>③ </p>	<p>③ </p>	<p>③ </p>
-----------	-----------	-----------

<p>④ LT PNP</p>	<p>C + 1</p> <p>(only SLM500 version): LED flashing light (únicamente para la versión SLM500): Luz intermitente de LED (seulement pour version SLM500): Lumière à LED clignotante</p> <p>C + 2</p> <p>LED flashing light (SLM500 version) + SWITCH A sound Luz intermitente de LED (versión SLM500) + Sonido SWITCH A Lumière à LED clignotante (version SLM500) + son SWITCH A</p> <p>C + 3</p> <p>LED steady light (SLM500 version) + SWITCH B sound Luz fija de LED (versión SLM500) + Sonido SWITCH B Lumière à LED fixe (version SLM500) + son SWITCH B</p>
------------------------	---

<p>⑤ </p>	<p>⑤ </p>	<p>⑤ </p>
-----------	-----------	-----------

SLMBT-PNP-012-024	12-24V DC		
SLMBT-120-240	120-240V AC		
<p>① </p>	<p>② </p>	<p>③ </p>	<p>④ </p>

<p>⑤ LT PNP: UPPER POS.</p> <p>C + 1</p> <p>(only SLM500 version): LED flashing light (únicamente para la versión SLM500): Luz intermitente de LED (seulement pour version SLM500): Lumière à LED clignotante</p> <p>C + 2</p> <p>LED flashing light (SLM500 version) + SWITCH A sound Luz intermitente de LED (versión SLM500) + Sonido SWITCH A Lumière à LED clignotante (version SLM500) + son SWITCH A</p>	<p>⑤ HT: UPPER POS.</p> <p>C + 3</p> <p>LED steady light (SLM500 version) + SWITCH B sound Luz fija de LED (versión SLM500) + Sonido SWITCH B Lumière à LED fixe (version SLM500) + son SWITCH B</p>	<p>⑤ LT PNP: LOWER POS.</p> <p>C + 4</p> <p>(only SLM500 version): LED flashing light (únicamente para la versión SLM500): Luz intermitente de LED (seulement pour version SLM500): Lumière à LED clignotante</p> <p>C + 5</p> <p>LED flashing light (SLM500 version) + SWITCH A sound Luz intermitente de LED (versión SLM500) + Sonido SWITCH A Lumière à LED clignotante (version SLM500) + son SWITCH A</p>	<p>⑤ HT: LOWER POS.</p> <p>C + 6</p> <p>LED steady light (SLM500 version) + SWITCH B sound Luz fija de LED (versión SLM500) + Sonido SWITCH B Lumière à LED fixe (version SLM500) + son SWITCH B</p>
--	--	--	--

⑥

DOMES TIGHTENING/APRIETE DE LA CÚPULA/SERRAGE DU DÔME

<p>① </p>	<p>② </p>	<p>① </p>	<p>② </p>
(SLM500/SLM700) + SLMBS		(SLM500/SLM700) + SLMBD	

<p>① </p>	<p>② </p>	<p>③ </p>	<p>④ </p>
(SLM500/SLM700) + SLMBP			

<p>① </p>	<p>② </p>	<p>③ </p>
(SLM500/SLM700) + SLMBT		