

PASSIVE INFRARED DETECTOR W/PET IMMUNITY

PASSIVE INFRARED DETECTOR W/PET IMMUNITY & TAMPER

RX-40PI

RX-40PT



FEATURES

- 40ft. X 40ft. (12m X 12m) Wide Angle
 - QUAD Zone Logic
 - Patented Multi-focus Lens
 - Improved Sealed Optics
 - Temperature Compensation Logic
 - Pet Immunity
- (See Section 4 for Special Instructions)
※RX-40PT is not UL listed.

EASY INSTALLATION

- Easy Wiring Knockout
- Wiring Guide
- Spare Terminal [RX-40PT Only]
- Wide Wiring Space

FUNCTIONS

- Selectable Pulse Count (2 or 4)
- LED ON/OFF
- Tamper Switch [RX-40PT Only]

OPTION

- FL-60N Long Range Curtain Lens (60ft/18m)
- FA-3 Wall & Ceiling Mount Bracket (Horizontally $\pm 45^\circ$ & Vertically 0° to -15°)

1. INSTALLATION HINTS



2. DESCRIPTION AND OPERATION

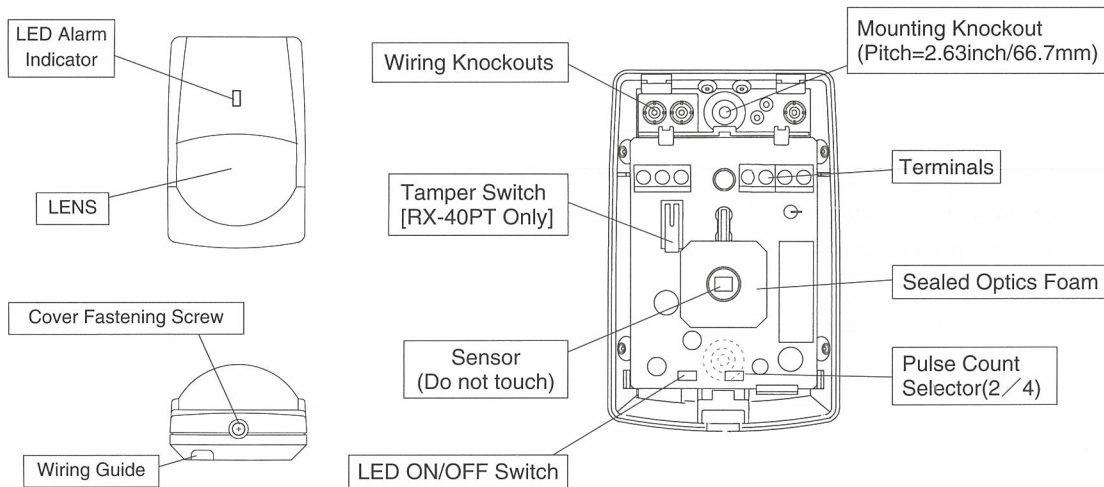

LED ON/OFF

Use the pin switch for LED ON/OFF.



PULSE COUNT

Use the pin switch for Pulse Count Selection (2 or 4)



EASY WIRING KNOCKOUTS

Press firmly with a screwdriver to open. Enlarge the hole according to size of wire.



3. DETECTION AREA

WIDE ANGLE

TOP VIEW

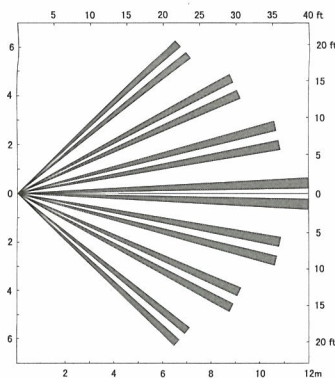

SIDE VIEW

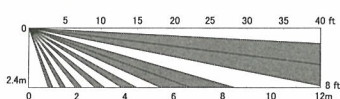

LONG RANGE (OPTIONAL LENS : FL-60N)

IMPORTANT

When selecting the long range detection pattern, always set pulse count selector to "2".

TOP VIEW

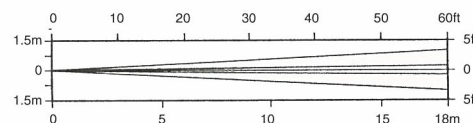

SIDE VIEW

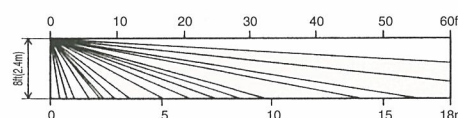

PATTERN AREA SELECTION

Use the optional lens FL-60N for long range area.

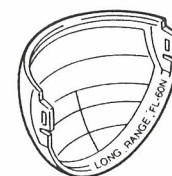

FL-60N
Engraved
"LONG RANGE"

HOW TO REMOVE & FIT LENS

To remove, press both lens hooks to outside and push to the front.

To fit, press the lens into cover from the front.



COVER INSIDE

4. SPECIAL INSTRUCTIONS FOR PET IMMUNITY

- Pet immunity is most effective on the following sized animals:
Rodents=0 to 4 inches high
Cats and small to medium sized dogs=0 to 16 inches high at normal room temperature.
- Installation Instructions
 - Mount between 7 and 8 ft. (For better immunity, especially for medium sized dogs, mount as close to 8ft. as possible.)
 - Do not angle detector towards the ground or use the angle bracket. Mount flat on the wall or in the corner.
 - For best pet immunity, limit the detectors field of view to 30 ft. maximum in any direction.
 - For rodents
If any shelves within 15 ft. of the detector have a height that comes within 2.5 ft. below the mounting height of the detector and rodents can access these areas, pet immunity will be reduced. Please select mounting location of detectors carefully to avoid this situation.
 - For cats and dogs (16 inches in height or less at normal room temperature)
When a dog jumps up on desks, the detector may detect it. Adjust detection area to avoid such places.
 - For cats
If there are cats, any shelves in the detection area will reduce pet immunity.
 - FL-60N Long Range Curtain Lens
When pet immunity is required, optional Long Range Curtain Lens cannot be used. Pet immunity can only be achieved with Wide Angle Lens.
 - Pulse Count 4 is not required for Pet Immunity applications. Use 4 pulse only in harsh environment.

※Pet immunity function has not been evaluated by UL since there are no established UL requirements for small animals immunity.

5. WIRING

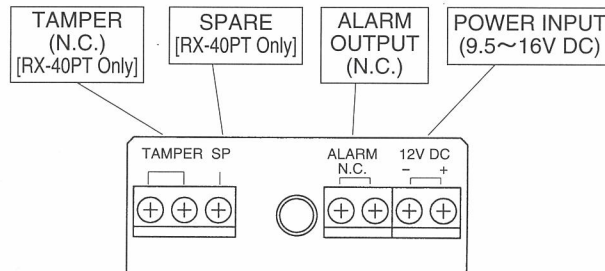

Power wires should not exceed the following lengths.

WIRE GAUGE	12V DC	14V DC
AWG22(0.33mm ²)	1700'(520m)	3700'(1130m)
AWG20(0.52mm ²)	2690'(820m)	5830'(1780m)
AWG18(0.83mm ²)	4290'(1310m)	9350'(2850m)

When using two or more units on one wire, the maximum length is obtained by dividing the maximum wire length listed above by the number of units used.

※UL requires RX-40PI to be connected to a UL listed power supply capable of providing a nominal input of 12VDC, 11mA (max.) (at 12VDC) and battery standby time of 4 hours.

※The equipment shall be installed in accordance with the National Electrical Code, NFPA 70.

6. TROUBLE SHOOTING AND MAINTENANCE

PROBLEM	PROBABLE CAUSE	REMEDY
LED does not light.	Incorrect power supply voltage. (disconnection, low voltage) Incorrect detection area. Incorrect polarity to detector. LED switch is OFF.	Correct the voltage supply to 9.5~16V DC. See Section 3. Switch positive and negative at terminal. Turn on the Switch. (See Section 2)
LED lights even though no person is within area.	Moving object within area. (curtain, wall hanging, etc.) Rapid temperature changes within area. (heater, air-conditioner, etc.)	Remove object from detection area, or change location of detector. Remove the source from area, or change location of detector.
LED lights but signal is not sent.	Relay contact is stuck or damaged due to overloading Faulty wiring.	Check load of output. The unit needs repair or replacement Wire correctly.

7. SPECIFICATIONS

MODEL	RX-40PI/RX-40PT
Detection method	Passive Infrared
Coverage	WIDE : 40ft×40ft (12m×12m) 85° wide
Detection zones	WIDE : 78 zones
Mounting Height	5~8ft (1.5~2.4m)
Sensitivity	3.6° F (2°C) at 2ft/sec (0.6m/sec)
Detection speed	1~5ft/sec (0.3~1.5m/sec)
LED Alarm indicator	Switch-able ON/OFF
Alarm period	Approx. 2.5 sec
Alarm output	N.C., 28V DC 0.2A max.
Tamper switch [RX-40PT Only]	N.C., Open when cover is removed. 28VDC 0.1A max.
Pulse Count	Approx. 20 sec 2 or 4
Warm up period	Approx. 30 sec
Power input	9.5~16VDC
Current draw	8mA(normal), 11mA(max.) at 12VDC
Weight	2.5 oz (70g)
Operating temperature	-4° F ~ +122° F (-20°C ~ +50°C)
Environmental humidity	95% max
RF interference	NO Alarm 20V/m

FL-60N (Optional Lens for Long Range Curtain Pattern)

Coverage	LONG : 60ft×6ft (18m×1.8m) Long Range
Detection zones	LONG : 20 zones

Dimensions

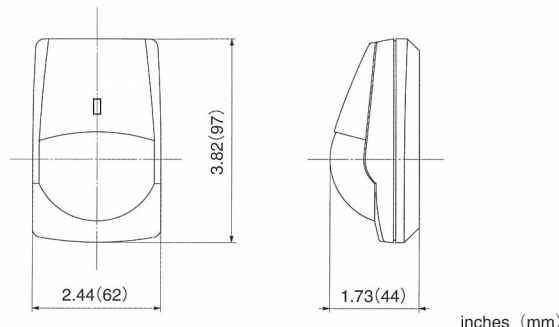

※Specifications and design are subject to change without prior notice.

Manufacturer:

OPTEX CO., LTD
5-8-12 Ogoto, Otsu, Shiga, 520-0101 JAPAN

Authorised representative in Europe:

OPTEX (EUROPE) LTD. / EMEA HEADQUARTERS
Marandaz House 1 Cordwallis Park, Clivemont Road, Maidenhead, Berkshire, SL6 7BU U.K.

Note >>

This unit is designed to detect movement of an intruder and activate an alarm control panel. Being only a part of a complete system, we can not accept responsibility for any damages or other consequences resulting from an intrusion.



OPTEX

OPTEX INC. (U.S.)
URL: <http://www.optexamerica.com>

OPTEX DO BRASIL LTDA.
(Brazil)
URL: <http://www.optex.net.br/es/sec>

OPTEX (EUROPE) LTD.
/ EMEA HQ (U.K.)
URL: <http://www.optex-europe.com>

OPTEX CO., LTD. (JAPAN)
URL: <http://www.optex.net>

OPTEX TECHNOLOGIES B.V.
(The Netherlands)
URL: <http://www.optex.eu>

OPTEX SECURITY SAS (France)
URL: <http://www.optex-security.com>

OPTEX SECURITY Sp.z o.o.
(Poland)
URL: <http://www.optex.com.pl>

OPTEX PINNACLE INDIA,
PVT., LTD. (India)
URL: <http://www.optex.net/in/en/sec>

OPTEX KOREA CO.,LTD. (Korea)
URL: <http://www.optexkorea.com>

OPTEX (DONGGUAN) CO.,LTD.
SHANGHAI OFFICE (China)
URL: <http://www.optexchina.com>