

# CAT 6 Solid/Stranded 8P8C RJ-45 Shielded Modular Plug

## PRODUCT SPECIFICATION

### Package includes:

- A. CAT 6 8P8C Shielded Modular Plug, 100 pcs
- B. Loading Bar, 100 pcs

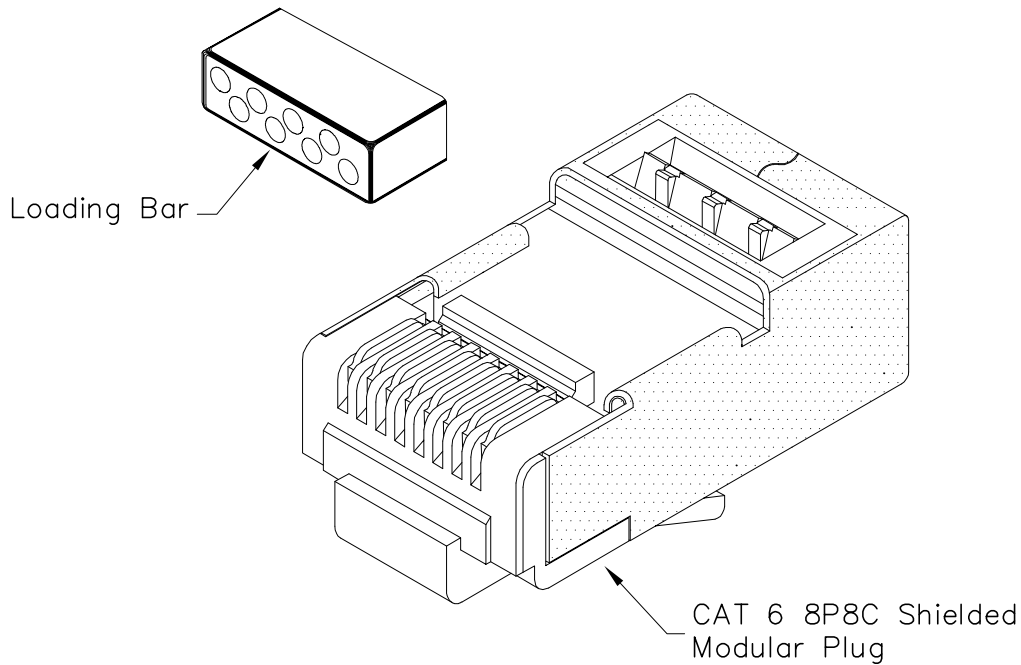

### Features and Benefits:

- Designed for CAT 6, 8-position 8-conductor, solid or stranded wires
- Ideal for customization of cords for voice or high speed data applications
- Accepts 24~23 AWG solid or stranded
- Used with ICACSCT864 and ICACSCT845 crimping tools
- UL recognized

### PLUG, CAT 6, SOLID/STRANDED, SHIELDED, 100PK

ITEM NO. ICMP8P8C6S  
DWG NO. PSMP8P8C6S

REV. A  
PAGE NO. 1



CUSTOMER CARE / TECHNICAL SUPPORT \* CSR@ICC.COM / 888-ASK-4-ICC (275-4422) \* 14700 Alondra Blvd., La Mirada, CA 90638 \* www.icc.com

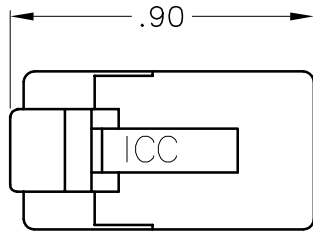
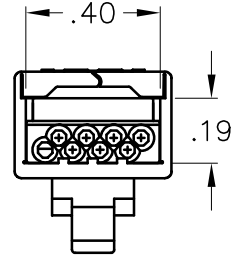
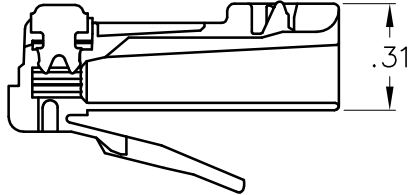
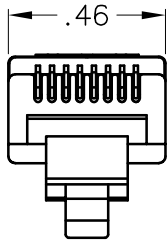
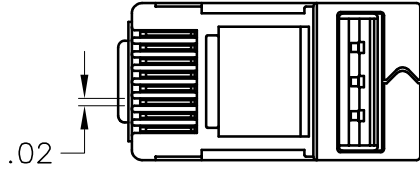

LOADING BAR

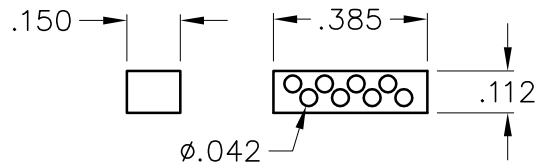

**NOTE: UNLESS OTHERWISE SPECIFIED**

1. ELECTRICAL:
  - A. CURRENT/VOLTAGE RATING: 1.5 AMPS / 30 VAC 42 VDC
  - B. CONTACT RESISTANCE: 10 MILLIOHMS MAX.
2. PERFORMANCE:
  - A. MEETS OR EXCEEDS CATEGORY 6 EIA/TIA 568 A-B.2
  - B. INSERTION/EXTRACTION LIFE: 1000 CYCLES
  - C. ROHS COMPLIANT
3. OPERATION TEMPERATURE: -40°C ~ +85°C
4. MATERIAL & FINISH:
  - A. HOUSING: POLYCARBONATE, UL 94V-0
  - B. CONTACT: PHOSPHOR BRONZE, .012 THICK
  - C. GOLD PLATING: STANDARD PLATING IS 1.27 MICRON/50 MICRO INCH GOLD OVER 100 MICRO INCH NICKEL
  - D. SHIELD:
    - MATERIAL: .012 THICK CDA-260, 1/4 HARD BRASS
    - PLATING: 100-150 MICRO-INCH TIN PLATED, 100% TIN
  - E. LOADING BAR:
    - COLOR: BLACK
    - MAXIMUM STRANDED/SOLID CONDUCTOR DIAMETER: 0.042"

**PLUG, CAT 6, SOLID/STRANDED, SHIELDED, 100PK**

ITEM NO.	ICMP8P8C6S	REV.	A
DWG NO.	PSMP8P8C6S	PAGE NO.	2



CUSTOMER CARE / TECHNICAL SUPPORT \* CSR@ICC.COM / 888-ASK-4-ICC (275-4422) \* 14700 Alondra Blvd., La Mirada, CA 90638 \* www.icc.com