

# 12-Splice Small Tray Kit, 5.00" x 5.50"

---

## Package Includes

- A. Splice Tray, Base (1)
- B. Splice Tray, Cover (1)
- C. Fusion Splice Holder (2)
- D. Fusion Splice Holder w/Adhesive (2)
- E. Assembly Screw , M3 x 0.5 x 6.0mm (4)
- F. Cable Tie, 3" (10)
- G. Nut, M5 x 0.8 (2)
- H. Installation Instructions (1)



## Features and Benefits

- Supports 12 fibers with fusion sleeves
- Recommended for holding and protecting individual multimode/singlemode fusion splices
- The Splice Tray mounts inside ICFORE rack mount and ICFODE wall mount enclosures and comes with a cover to protect your splices
- Available in black

# Specifications

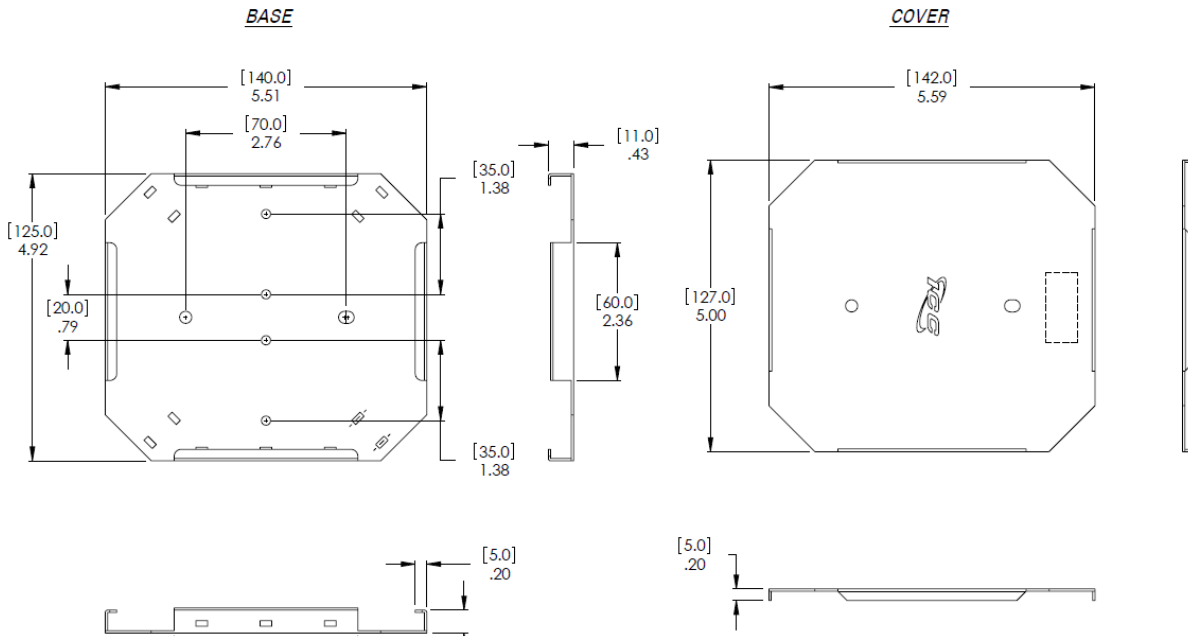

**NOTE: UNLESS OTHERWISE SPECIFIED**

**MATERIAL FUSION SPLICE HOLDER:**

- A. ABS, UL 94V-0, WHITE
- B. ADHESIVE, 1.3MM THICK, WHITE (DOUBLE SIDED TAPE)

**MATERIAL BASE & COVER:**

- A. BASE & COVER: 20 GA ALUM
- B. FINISH: BLACK POWDER COAT

For warranty information, go online to [icc.com/warranty](http://icc.com/warranty).

Part No: ICFOSKFM12 Rev: A

Part No.: ICFOSKFM12

Rev: A

Page 2 of 2

| 888-ASK-4ICC | [icc.com](http://icc.com) | [csr@icc.com](mailto:csr@icc.com) |

