

 Paxton



ins-20605

Net2 desktop reader USB



1

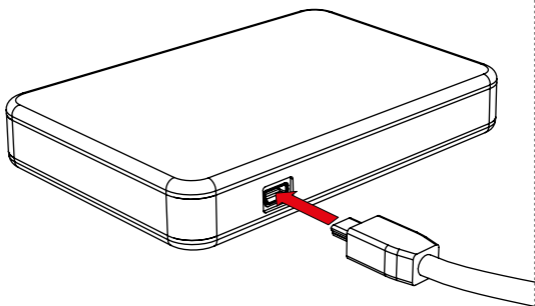

2

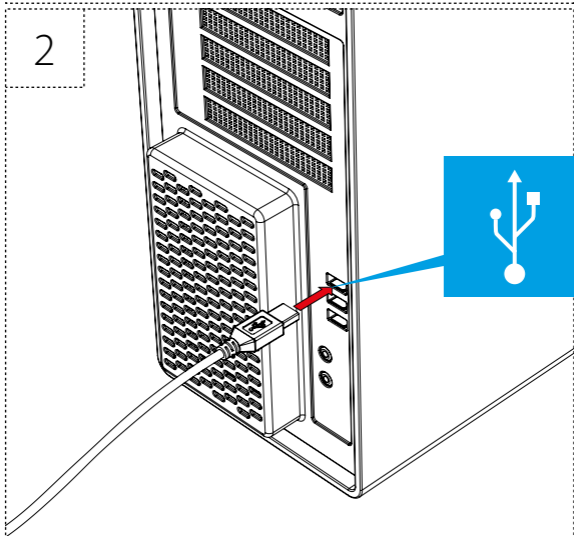

3

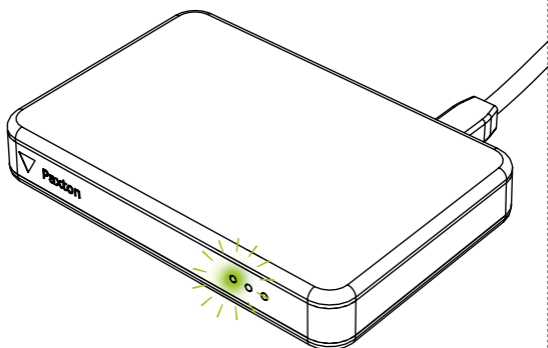

4

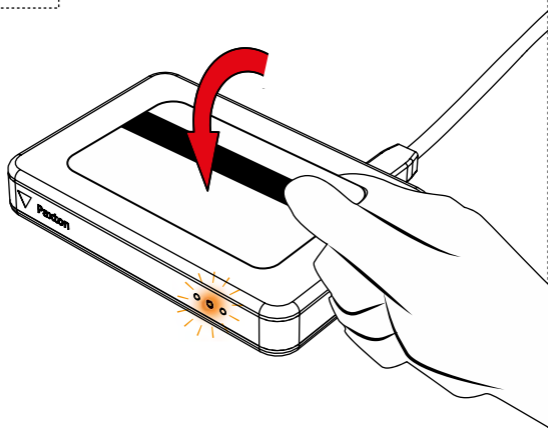

Desktop Reader

The desktop reader is designed to sit next to the PC. It is used for adding tokens to a Net2 system and also for identifying lost cards. Additional workstations can also have desktop readers.

With the Net2 software running, any new token presented above the desktop reader will cause the new user wizard to appear with the appropriate card number displayed.

The users details can then be entered and the token issued. If the token is already known to the system, the relevant user's record will appear

Installation guidelines

This unit is for indoor use only

- Plug the reader into a convenient USB port on the PC with the supplied USB cable
- Stop and then restart the Net2 server program. The device will now be available to the Net2 program
- This unit requires Net2 v3.09 or later software. Support for Mifare cards requires v4.17 or later.
- Call Technical Support if you require a software upgrade.

Power supply

- The power for the unit is supplied via the USB cable. No additional supply is required
- Wiring methods shall be in accordance with the National Electrical Code (ANSI/NFPA70), local codes, and the authorities having jurisdiction.

Maintenance

- Following the completed installation of this equipment, no further maintenance or testing is required.
- It is advisable to ensure that any third party backup power supplies or recovery procedures are checked regularly to ensure that the operation of the Paxton system is not compromised.

514-326

Current	$\leq 100\text{mA}$
Voltage	4.75V DC - 5.25V DC
Waterproof	
Operating temperature	-40°C - +66°C -40°F - +131°F



☎ +44 (0)1273 811011
 ✉ support@paxton.co.uk
 📞 paxton.support



☎ 877.438.7298
 ✉ supportUS@paxton-access.com
 📞 usapaxton.support



☎ +31 (0)76 3333 999
 ✉ support@paxton-benelux.com
 📞 paxton.benelux.support



☎ +32 (0) 78485147
 ✉ support@paxton-benelux.com
 📞 paxton.benelux.support



☎ +49 (0) 251 2080 6900
 ✉ verkauf@paxton-gmbh.de
 📞 paxton.gmbh.support



☎ +33 (0)1 57 32 93 56
 ✉ support@paxtonaccess.fr
 📞 paxton.support



☎ +27 (0) 21 4276691
 ✉ support@paxtonaccess.co.za
 📞 paxton.support



☎ 8000 3570 3783
 ✉ support@paxtonaccess.ae
 📞 paxton.support



☎ +52 55 5351 3667
 ✉ soporte@paxton-access.com
 📞 paxton.soporte



☎ +57 1508 8198
 ✉ soporte@paxton-access.com
 📞 paxton.soporte



☎ +44 (0)1273 811011
 ✉ support@paxton.co.uk
 📞 paxton.support

The declaration of conformity is available on request. Contact details are provided at:

<http://paxton.info/596>

Paxton Access Ltd hereby declares that this product is in conformity with all the essential requirements of the Directive 2014/53/EU.

<http://paxton.info/4867>

These products are not suitable for retail sale. All warranties are invalid if these products are not installed by a competent person.

North America:- Product compliance and limitations

This device complies with Industry Canada licence-exempt RSS standard(s). Operation is subject to the following two conditions: (1) this device may not cause interference, and (2) this device must accept any interference, including interference that may cause undesired operation of the device.

FCC Compliance

This device complies with Part 15 of the FCC Rules. Operation is subject to the following two conditions:

(1) this device may not cause harmful interference, and (2) this device must accept any interference received, including interference that may cause undesired operation. Changes or modifications not expressly approved by the party responsible for compliance could void the user's authority to operate the equipment.

Conformité et limitations du produit

Ce dispositif est conforme au(x) standards RSS de l'industrie Canadienne sans-licence. Le fonctionnement est soumis aux deux conditions suivantes : (1) ce dispositif ne doit pas créer d'interférences nuisibles et (2) ce dispositif doit accepter toute interférence reçue, y compris des interférences qui peuvent causer un fonctionnement non souhaité.

Conformité FCC

Ce dispositif est conforme à la section 15 du règlement de la FCC. Le fonctionnement est soumis aux deux conditions suivantes : (1) ce dispositif ne doit pas créer d'interférences nuisibles et (2) ce dispositif doit accepter toute interférence reçue, y compris des interférences qui peuvent causer un fonctionnement non souhaité. Tout changement ou modification non agréé par la partie responsable de la mise en conformité peut entraîner une interdiction d'utilisation de l'équipement.



<http://paxton.info/1606>

 Made in the UK

