

EasyPoE Box Series

NEMA-Rated Indoor/Outdoor Cabinet with Integrated PoE Switch

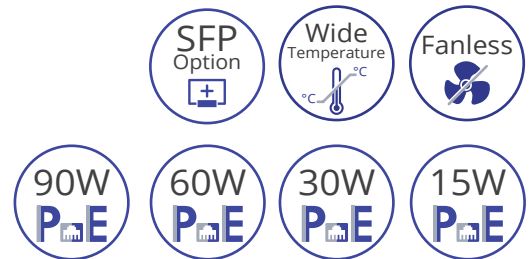

Product Highlights

➔ NEMA-Rated Indoor/Outdoor Design for Non-Ventilated & Harsh Environments

- Wide operating temperature -40 to 70°C (-40 to 158°F)
- Fanless design
- Weather-resistant, anti-corrosion, and vandal-resistant design

➔ Time/Cost Saving Features

- Integrated splicing tray for safe fiber connection storage
- Adapter for wall and pole mounting
- Preinstalled bulkheads for cable connections and DIN-rail for additional devices/accessories

➔ Smart PoE and Power

- Futureproof with 90W/port and backward compatibility with all PoE protocols (60W/30W/15W)
- PoE watchdog monitors status of connected PoE devices
- Built-in power supply and surge protection with auxiliary DC power output

➔ Support

- Complimentary Technical Support
- Free Firmware Upgrades

Overview

EtherWAN's EasyPoE Box series, in collaboration with Phoenix Contact, is an integrated solution that combines a managed PoE switch, splice tray, power supply, and a DIN-rail for accessories, all in a single, secure, NEMA-rated cabinet enclosure. Equipped with up to 4 gigabit PoE ports that provide from 15W up to 90W output per port using the latest IEEE 802.3bt technology and 2 uplink ports, the smart camera box series provides the power, time-saving design, and convenience to support a wide variety of applications including surveillance, LED lighting, and other networking applications.

Ordering Information

Model

EASYPOEBOX4F	4-Port 10/100/1000BASE-T PoE + 2-Port 100/1000BASE SFP Managed Ethernet Switch
EASYPOEBOX4C	4-Port 10/100/1000BASE-T PoE + 2-Port 10/100/1000BASE-T Managed Ethernet Switch
EASYPOEBOX2F	2-Port 10/100/1000BASE-T PoE + 2-Port 100/1000BASE SFP Managed Ethernet Switch
EASYPOEBOX2C	2-Port 10/100/1000BASE-T PoE + 2-Port 10/100/1000BASE-T Managed Ethernet Switch

Software Features

Interface	+
CLI and Web Browser SNMP v2/v3	
Management	+
Firmware upgrade	
Configuration backup	
DHCP Client	
RMON (Remote Monitoring)	
Port Mirroring	
SNTP (Simple Network Time Protocol) synchronization	
LLDP (Link Layer Discovery Protocol)	
IPv4/IPv6	
Security	+
MAC address filtering	
Enable/Disable port	
System logging	
IEEE 802.1x LAN Access Control	
Remote authentication through RADIUS	
SSH for CLI and Telnet security	
SSL and HTTPS for Web security	
Multi-user login and privileged access management	
Port security	

Layer 2 Features	+
Auto-negotiation for port speed and duplex mode	Flow Control IEEE 802.3x full duplex mode Back-pressure half duplex mode
Redundant Protocol	IEEE 802.1w Rapid Spanning Tree Protocol (RSTP)
VLANs	IEEE 802.1Q Tag VLANs (Up to 32 VLANs)

Hardware Specifications

Interface +	
Ethernet Port	10/100/1000BASE-T PoE: 2 or 4 ports 10/100/1000BASE-T: 0 or 2 ports 100/1000BASE SFP: 0 or 2 ports
LED Indicators	Per Unit: Power (Green), Aux Power (Green) Per Port: Link/Activity (Green: 10/100M, Orange: 1000M; On: connection established, Flashing: data transmission in progress) Per Port: PoE (Green: Auto Mode, Orange: Force Mode)
Mode Button	Exiting without changes Resetting to the factory settings Operating with a static IP address Setting DHCP mode Setting BootP Setting unmanaged mode
Technology +	
Standards	IEEE 802.3 10BASE-T IEEE 802.3u 100BASE-TX/100BASE-FX IEEE 802.3ab 1000BASE-T IEEE 802.3x full duplex and flow control IEEE 802.1p QoS IEEE 802.1Q Tag VLANs IEEE 802.1w RSTP IEEE 802.1ab LLDP IEEE 802.3af/at/bt Power over Ethernet IEEE 802.1x Port-based Network Access Control
Forward/Filtering Rate	14,880pps for 10Mbps 148,880pps for 100Mbps 1,488,000pps for 1000Mbps
Processing Type	Store-and-Forward Auto-Negotiation Half-duplex back-pressure full-duplex flow control Auto MDI/MDIX
Address Table Size	8K
Power +	
Input	100-240VAC, -15% - +10% (single-phase)
Output	24VDC, 300mA (typical)
PoE Power Output	Ports 1-3: Up to 90W/port Port 4: Up to 30W
PoE Power Budget	165W (155W if power output used)
Physical +	
Casing Material	Polycarbonate (PC)
IP Rating	IP65
NEMA Rating	NEMA 4/4X
Impact Protection	IK10
Dimensions	11.2 x 4.8 x 14.3in (W x D x H) 284 x 121 x 364mm (W x D x H)
Weight	9.5lbs (4.3Kg)
Installation Type	Wall or Pole Mounting

Environmental +	
Operating Temp.	-40 to 70°C (-40 to 167°F)
Storage Temp.	-40 to 85°C (-40 to 185°F)
Relative Humidity	10% to 95% (non-condensing)
MTBF	805,920 hours
Regulatory +	
ISO	Manufactured in ISO 9001 facility
EMI	FCC Part 15B Class A VCCI Class A ICES-003 EN 61000-6-4
EMS	EN 61000-6-2 EN 61000-6-3 EN 61000-4-2 (ESD) EN 61000-4-3 (Radiated RFI) EN 61000-4-4 (Burst) EN 61000-4-5 (Surge) EN 61000-4-6 (Induced RFI)
Safety	UL 61010
Vibration	IEC 60068-2-6
Shock	IEC 60068-2-27
Warranty +	
Length	5 Years
Details	www.etherwan.com/support/warranty-policy
What's Included +	
Device	Smart Camera Box
Installation	Mounting Adapter
Documentation	Quick Install Guide

Dimensions

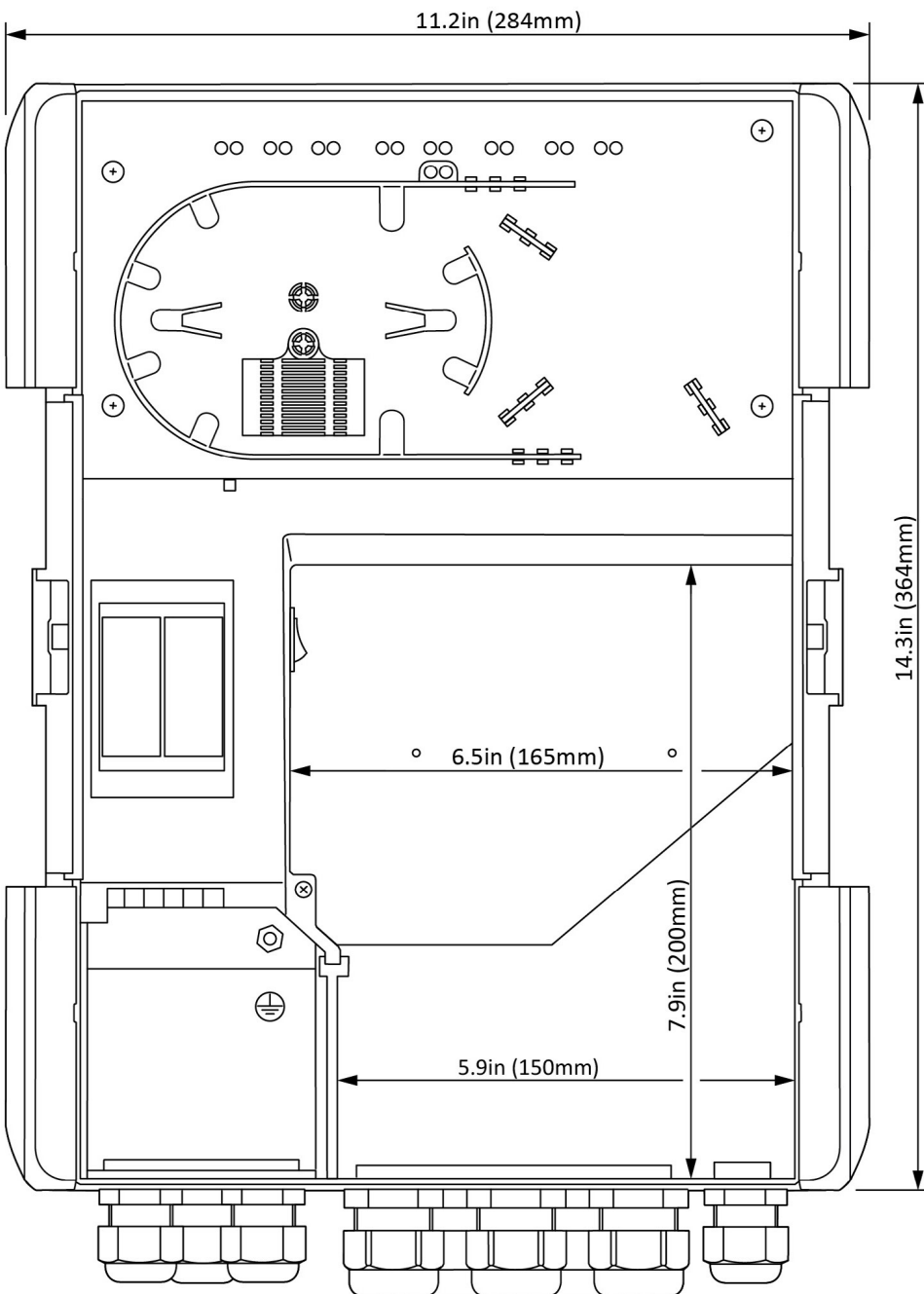
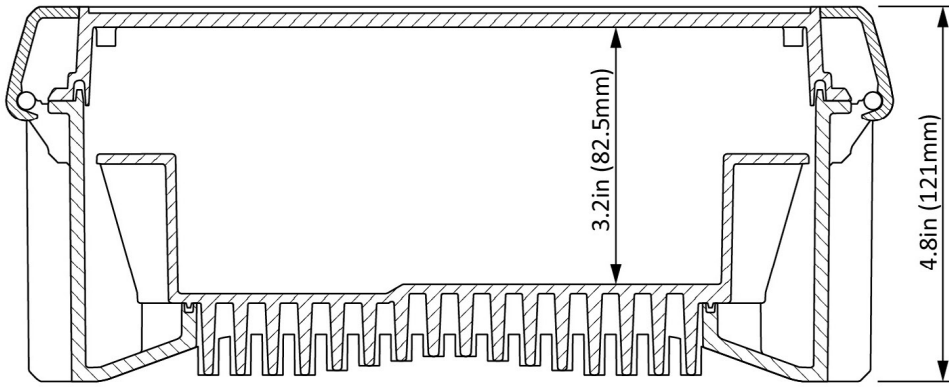

Accessories

Model

EASYPOEBOXLOCK	Door lock with locking tab
EASYPOEBOXMCS	Mast clamps for masts (51-127mm)
EASYPOEBOXMCL	Mast clamps for masts (102-254mm)