

Overview

The LVC-IV module contains a 3-screw terminal block for a low-voltage wall switch, an IR receiver jack, a built-in RF receiver, two-RJ25 ports for RS232 /RS485, a low-voltage relay port with cable and a user-serviceable 3.5 Amp fuse. **Compatible components for each are listed below.**

Uses

**IR (Infrared)
Remote Control**

**RJ25 Ports for
RS-232/RS-485
Communication**

Low-Voltage Wall Switch

“Dry” Contact Closure

**RF (Radio Frequency)
Remote Control**

3rd Party Control
*Control systems employing “dry”
contacts or Serial Communication.*

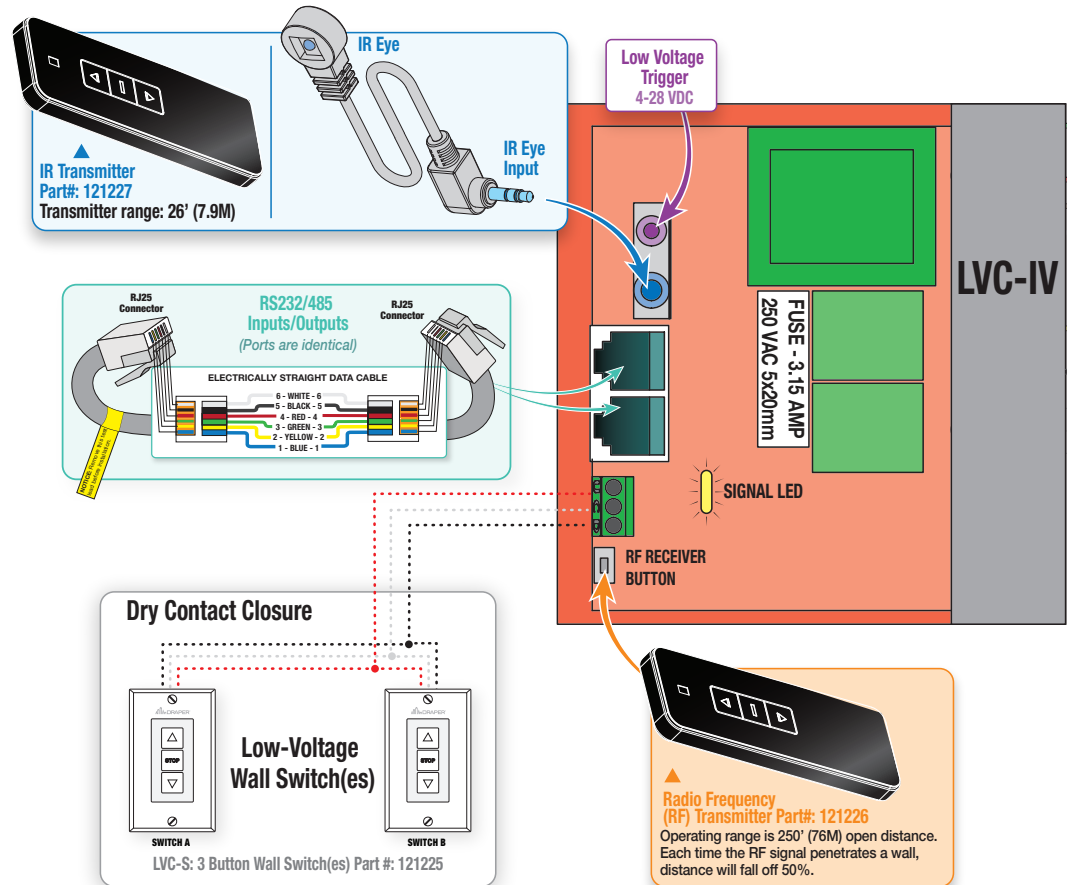

The 120V LVC-IV also used as a Single-Pole, Double-Throw dry closure to control equipment by the same means listed above.

COMPATIBLE COMPONENTS		PART NO.
IRT / R	Infrared Remote Control (Connects to IR Port)	121228
WRT / R	Radio Frequency Remote (antenna built in)	121226
LVC-S	Low-Voltage Wall Switch.	121225
	Low-Voltage Wall Switch w/ Locking Cover	121232
KS-1	Power Supply Key Switch.	121017
SP-KSM	3-position Momentary Key Switch (Please Note: 'Stop' won't work)	121022
Auxillary Control	Control systems employing “dry” contacts or Serial Communication.	By Others

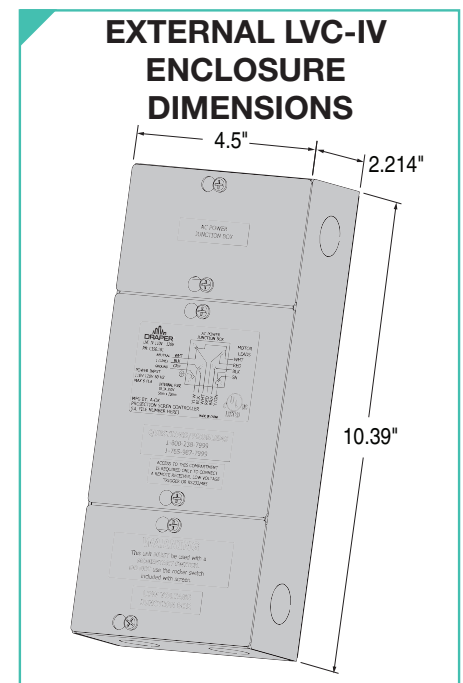

CONTACTS:	Emulates Single-Pole, Double-Throw. Maintained for approx. 3 minutes.
RATING:	Input: 110-120 VAC +/- 10%, 50/60 Hz Output: 110-120 VAC, 3.15 Amps, 50/60 Hz. Fused with 250 VAC, 3.15 Amps UL & c-UL recognized