



EN ENGLISH



## P-REX

**Illuminated  
Request-to-Exit  
Push Button**

Stainless steel request to exit device with momentary switch and illuminated push button.

*The installer's choice*  
**cdvi.ca**

**PREX**

## Illuminated Request-to-Exit Push Button (Momentary)

illuminated Vandal and water resistant request-to-exit push button.

- **NO and NC contact outputs.**
- **Momentary switch**
- **Includes with two plates, single gang or mullion size.**
- **Blue LED rating: 15mA @ 12 Vcc**
- **Switch rating : 12 Vcc @ 5A, 24 Vcc @ 5A 110 Vca @ 5A or 220 Vca @ 3A**
- **Rugged Stainless steel plates and button**
- **UL, CE & ROHS certified.**
- **IP65**
- **Also available with a latch switch: PREX-L**

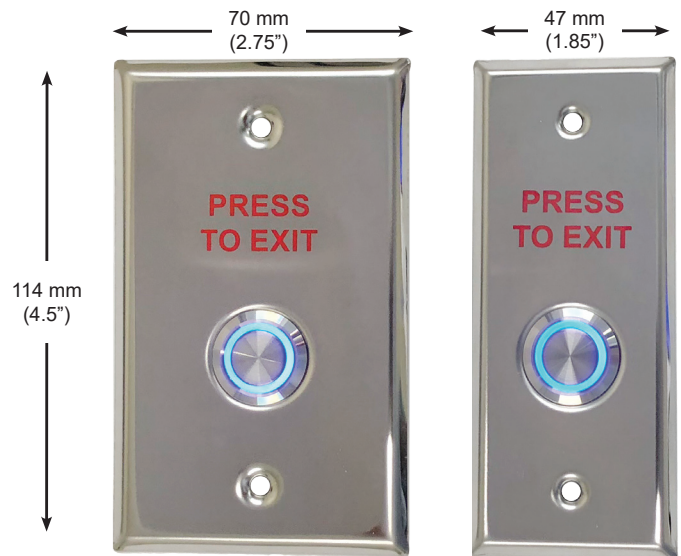

DEEE &amp; RoHS



IP65



CE Certification



-25°C (-13°F) to +55°C (131°F)

HIGH RESISTANCE  
TO VANDALISM**WIRING DIAGRAM**