

Indoor/Outdoor Wiegand Proximity Readers



DGLP WLC



DGLP FN WLC



DGLI WLC



DGLI F WLC

INSTALLATION MANUAL



PRODUCT OVERVIEW:

The DGLP WLC and DGLI WLC are two Wiegand Proximity readers, available as standard size and narrow style (DGLP FN WLC et DGLI F WLC). Both readers are sealed with epoxy, therefore they are suitable for external use and have high resistance to vandalism.

-25°C to +70°C

53

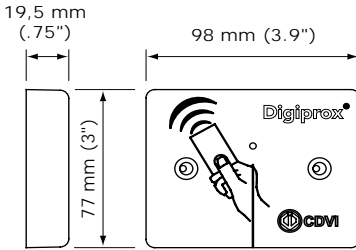

DGLI WLC

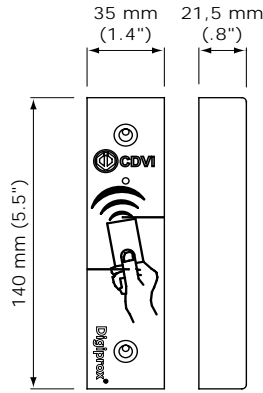

DGLI F WLC

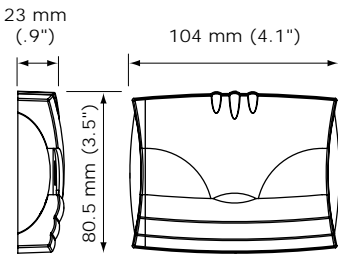

DGLP WLC

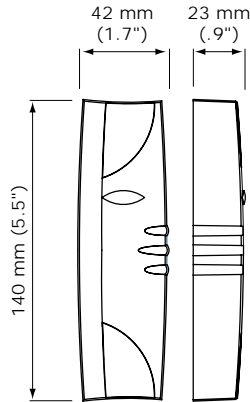

DGLP FN WLC

FEATURES:

- Indoor / outdoor application
- Selectable Wiegand output, 26, 30 or 44-bits
- LED and built-in buzzer (internal or external mode)
- Potted electronics
- Input voltage: 12V DC
- Consumption: 100mA

RECOMMENDATIONS:

Recommended cables

4 twisted pairs 0.6 MM.

Suggested power supplies

These power supplies are recommended with these Wiegand readers:

- ARD12
- BS60

Optional

Single gang box mounting plate for the DGLP FN WLC reader (Ref: MPLATE).







Important

To protect the device from back - emf do not forget to mount the varistor on the lock in parallel.

Environment

If the readers are mounted in a humid area or close to a sea shore, we recommend applying a varnish on the connections of the cable to avoid oxidation.

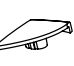
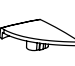
CONTENTS:

								
	Varistor	Diax [®] security tool	Diax [®] security screw	Brass anchor	Right cover	Left cover	Plastic anchor	Wood screw 3 x 40 mm
DGLI WLC & DGLI F WLC	1	1	2	2	-	-	-	-
DGLP WLC & DGLP F WLC	1	-	-	-	2	2	2	2



MOUNTING INSTRUCTIONS:

Ref : DGLP WLC and DGLI WLC

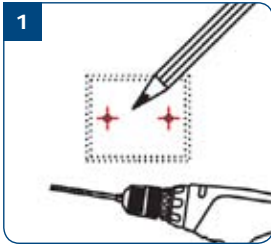

Measure and mark the center lines to determine the reader position. Drill the fixing screw holes (Diameter: 4MM for the mounting plate and 6MM for the reader). Drill the wiring access area.

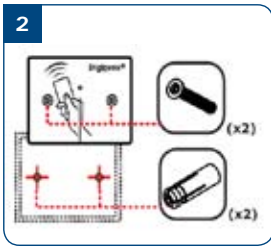

DGLI WLC

Insert the brass anchors in the mounting holes, connect the cable to the terminal block, then fasten the reader with the DIAX® screws using the DIAX® spanner. Make sure that the varistor is connected on the lock (refer to page 2 «Recommendations»).

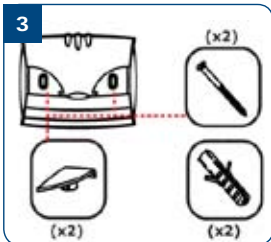

DGLP WLC

Insert the plastic anchors in the mounting holes, connect the cable to the terminal block, Then fasten the reader with the wooden screws Leave an area to access the cable to make the wiring). Put the covers on top of the reader. Make sure that the varistor is connected on the lock (refer to page 2 «Recommendations»).

Ref : DGLP FN WLC and DGLI F WLC

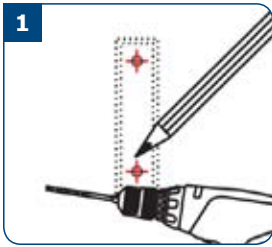

Measure and mark the center lines to determine the reader position. Drill the fixing screw holes (Diameter: 4MM for the mounting plate and 6MM for the reader). Drill the wiring access area.

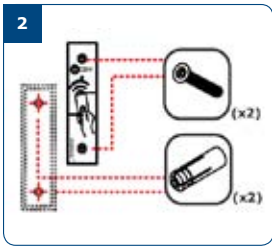

DGLI F WLC

Insert the brass anchors in the mounting holes, connect the cable to the connectors, then fasten the reader with the DIAX® screws using the DIAX® spanner. Make sure that the varistor is connected on the lock (refer to page 2 «Recommendations»).

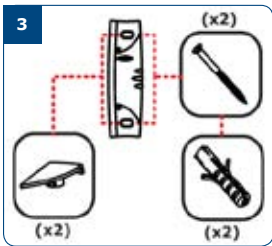

DGLP FN WLC

Insert the plastic anchors in the mounting holes, connect the cable to the terminal block, then fasten the reader with the wooden screws. Put the covers on top of the reader. Make sure that the varistor is connected on the lock (refer to page 2 «Recommendations»).

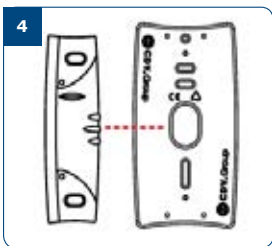

Optional (MPLATE)

Single gang box mounting plate for the DGLP FN WLC mullion polycarbonate proximity reader.



JUMPER SETTING AND WIRING DIAGRAM:

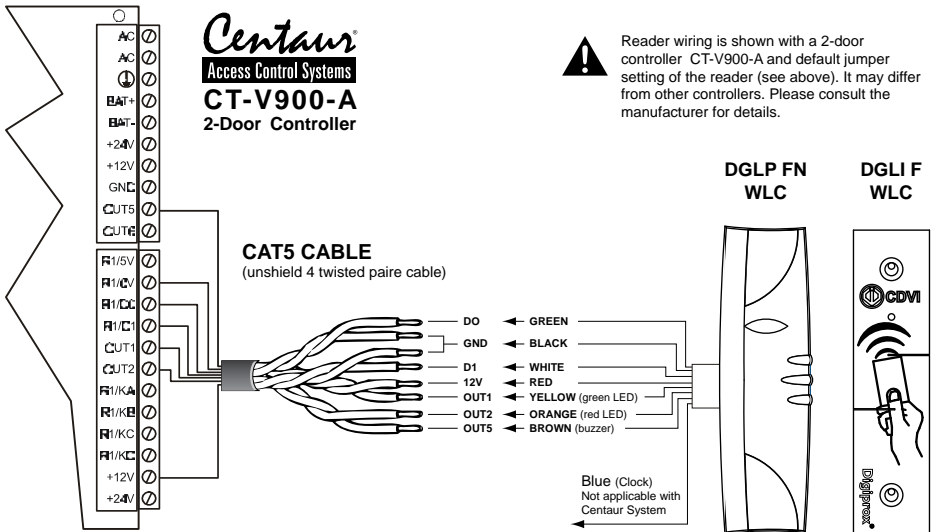
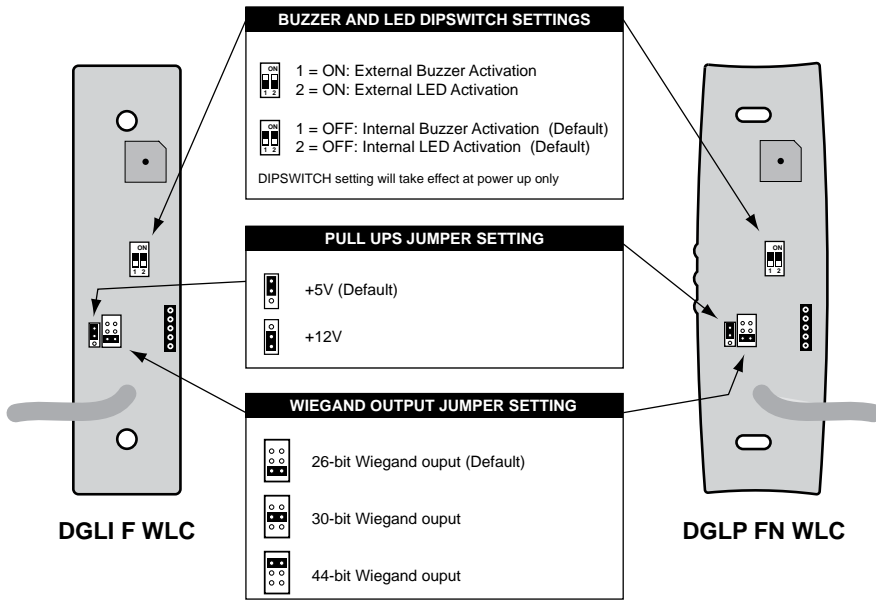

BUZZER AND LED DIPSWITCH SETTINGS

1 = ON: External Buzzer Activation
 2 = ON: External LED Activation

1 = OFF: Internal Buzzer Activation (Default)
 2 = OFF: Internal LED Activation (Default)

DIPSWITCH setting will take effect at power up only

PULL UPS JUMPER SETTING

+5V (Default)

+12V

WIEGAND OUTPUT JUMPER SETTING

26-bit Wiegand output (Default)

30-bit Wiegand output

44-bit Wiegand output

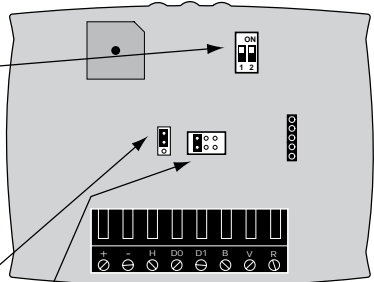

**DGLP WLC
or
DGLI WLC**

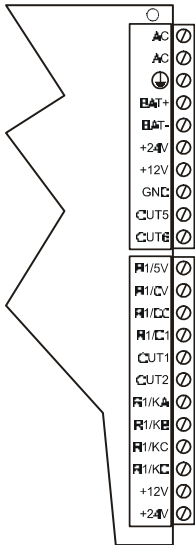
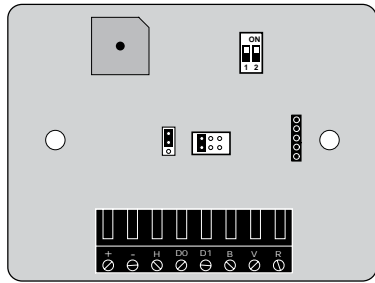

Centaur
Access Control Systems
CT-V900-A
2-Door Controller



Reader wiring is shown with a 2-door controller CT-V900-A and default jumper setting of the reader (see above). It may differ from other controllers. Please consult the manufacturer for details.

DGLI WLC

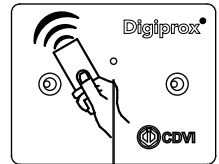

or

DGLP WLC

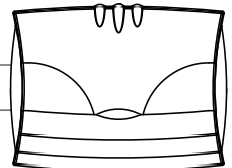

CAT5 CABLE
(unshield 4 twisted pair cable)

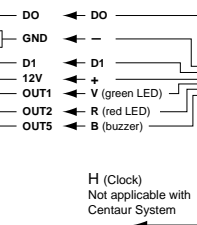

Manufacturing Access Control since 1985



CDVI (Headquarters/Siège social)
FRANCE
Tel: +33 (0)1 48 91 01 02
Fax: +33 (0)1 48 91 21 21

CDV AMERICAS
CANADA
Tel: +1 (450) 682 7945
Fax: +1 (450) 682 9590

CDV BENELUX
BELGIUM
Tel: +32 (0)5 662 02 50
Fax: +32 (0)5 662 02 55

CDV CH
SWITZERLAND
Tel: +41 (0)21 882 18 41
Fax: +41 (0)21 882 18 42

CDV CHINA
CHINA
Tel: +86 (0)10 87664065
Fax: +86 (0)10 87664165

CDV IBÉRICA
SPAIN
Tel: +34 936 916 551
Fax: +34 935 801 278

CDV ITALIA
ITALIA
Tel: +39 0331 97 38 08
Fax: +39 0331 97 39 70

CDV MAROC
MOROCCO
Tel: +212 (0)22 48 09 40
Fax: +212 (0)22 48 34 69

CDV SWEDEN
SWEDEN
Tel: +46 (0)33 20 55 50
Fax: +46 (0)33 20 55 51

CDV UK Ltd
UNITED KINGDOM
Tel: +44 (0)1628 531300
Fax: +44 (0)1628 531003

DIGIT
FRANCE
Tel: +33 (0)1 41 71 06 85
Fax: +33 (0)1 41 71 06 86

LA GACHE ELECTRIQUE
FRANCE
Tel: +33 (0)3 88 77 32 82
Fax: +33 (0)3 88 77 85 02

PROCOFI
FRANCE
Tel: +33 (0)1 41 83 04 90
Fax: +33 (0)1 41 83 04 91

TECHNO EM
FRANCE
Tel: +33 (0)4 42 96 58 73
Fax: +33 (0)4 42 96 45 77

www.cdvgroup.com